

YOURS AND
YOURS **ALONE.**

PROJECT
CRESCENDO
WAKAD



ZRICKS.COM



YOUR **ABODE** AWAITS.

The first glimmer of dawn sneaks into your luxurious residence, gently awaking you. You step onto your private terrace and feel the gentle caress of the breeze as it fills your living spaces with a delightful freshness. Making them feel even more spacious, if that were possible.

From your vantage point, you gaze upon the urban diaspora spread out beneath you, slowly waking up to another day. Soon it will be abuzz with the liveliness of a city. You smile, knowing that the chaos and din will fade long before they reach the privacy of your quiet abode.

ZRICKS

THE LESSER THE DISTANCE, THE BETTER YOUR ACCESS.

When everything you want is close to you, life feels just right. Scenic roads get you to work and back in no time, especially if your office is located at the nearby Infotech and Biotechnology Park in Hinjewadi. And when you're in the mood for a quick getaway, there's nothing quite like living close to the Mumbai-Pune Expressway, so your weekend plans always pan out. What's more, you'll find that the advantages of this great location don't stop there, with its proximity to key areas like Aundh, University Road and Shivajinagar, nothing will ever be too far away.

 Mumbai-Bangalore Highway – **2 mins**

 Hinjewadi – **5 mins**

 Mumbai-Pune Expressway – **10 mins**

 University Circle – **11 mins**

 Kothrud – **25 mins**

 Shivaji Nagar – **25 mins**

 Swargate – **30 mins**

 Boat Club Road – **30 mins**

 Pune Station – **32 mins**

 Koregaon Park – **35 mins**

 Kalyani Nagar – **40 mins**

 Pune Airport – **45 mins**

 Aundh – **45 mins**

 Nagar Road – **45 mins**

 Lonavala – **48 mins**

 Mumbai – **2 hours**

ZRICKS



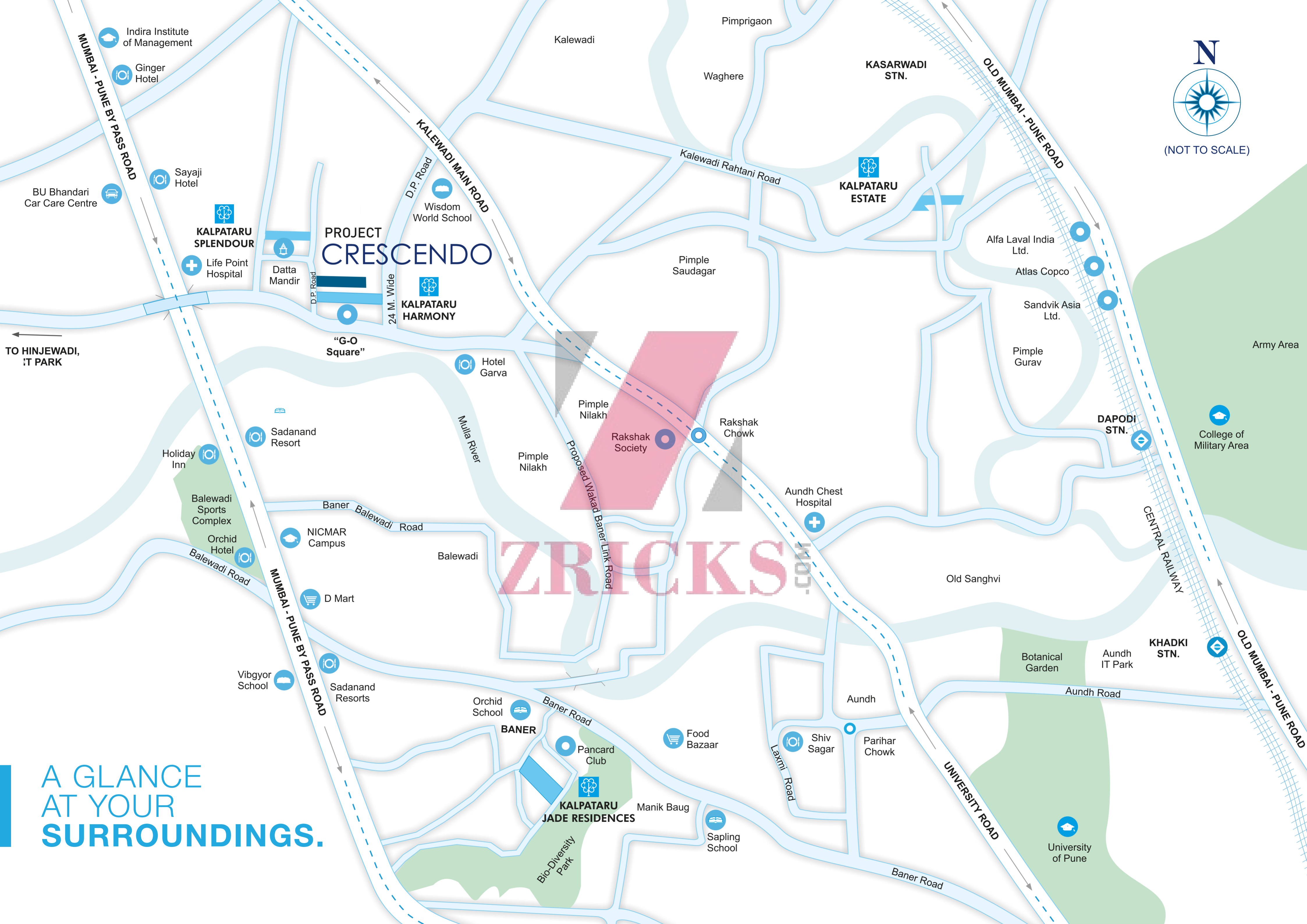

(NOT TO SCALE)

PROJECT CRESCENDO

ZRICKS.COM

KALPATARU HARMONY

KALPATARU SPLENDOUR

KALPATARU ESTATE

KALPATARU JADE RESIDENCES

A GLANCE AT YOUR SURROUNDINGS.

BU Bhandari Car Care Centre

Indira Institute of Management

Ginger Hotel

Sayaji Hotel

Life Point Hospital

Datta Mandir

Wisdom World School

Pimple Saudagar

KASARWADI STN.

Alfa Laval India Ltd.

Atlas Copco

Sandvik Asia Ltd.

Pimple Gurav

Army Area

College of Military Area

DAPODI STN.

Hotel Garva

Pimple Nilakh

Rakshak Chowk

Rakshak Society

Aundh Chest Hospital

Holiday Inn

Sadanand Resort

Balewadi Sports Complex

Orchid Hotel

NICMAR Campus

D Mart

Balewadi

Old Sanghvi

KHADKI STN.

Botanical Garden

Aundh IT Park

Vibgyor School

Sadanand Resorts

Orchid School

BANER

Pancard Club

Food Bazaar

Shiv Sagar

Parihar Chowk

Manik Baug

Sapling School

UNIVERSITY ROAD

University of Pune

Bio-Diversity Park

Baner Road

MUMBAI - PUNE BY PASS ROAD

KALEWADI MAIN ROAD

OLD MUMBAI - PUNE ROAD

CENTRAL RAILWAY

OLD MUMBAI - PUNE ROAD

MUMBAI - PUNE BY PASS ROAD

"G-O Square"

24 M. Wide

Proposed Wakad Baner Link Road

Baner Balewadi Road

Balewadi Road

Baner Road

Aundh Road

Kalewadi Rahtani Road

Mulla River

TO HINJEWADI, IT PARK

JUST AROUND THE CORNER FROM EVERYTHING.

Not far from the quiet and private living spaces at Project Crescendo, is an abundance of choice when it comes to educational institutions, hospitals, shopping, dining and entertainment, all within a 5 kms. radius.



HOTELS

- Oxford Golf and Country Club
- Lemon Tree Hotel, Hinjewadi
- Holiday Inn, Hinjewadi
- Courtyard by Marriott, Hinjewadi
- The Orchid, Balewadi



SHOPPING & ENTERTAINMENT

- D Mart
- Pimpri Central
- Premier Plaza Mall
- CityOne Mall
- Omega Mall (Proposed)
- Phoenix Market City (Proposed)



SCHOOLS & COLLEGES

- The Good Samaritan School
- Pumpkin Patch
- The Shiishyaa School
- Blossom Public School
- Indira Kids
- Akshara International School
- Wisdom World School
- Indira Group of Institutes
- Dr. D.Y. Patil Institute of Management
- Dr. D.Y. Patil Institute of Hotel Management & Catering Technology



HOSPITALS

- Lifepoint Multi-speciality Hospital
- Aditya Birla Memorial Hospital



ZRICKS

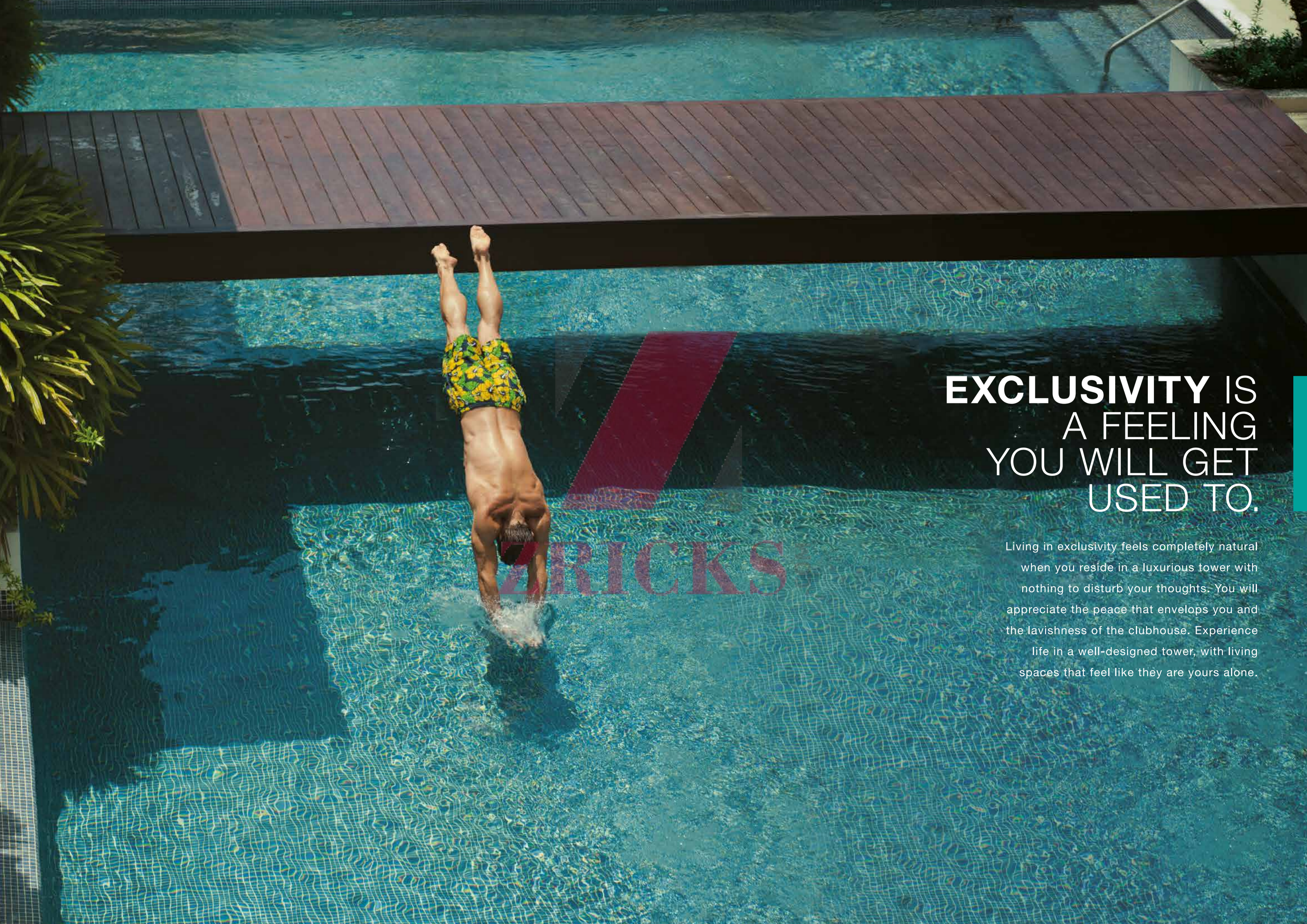

EXCLUSIVITY IS A FEELING YOU WILL GET USED TO.

Living in exclusivity feels completely natural when you reside in a luxurious tower with nothing to disturb your thoughts. You will appreciate the peace that envelops you and the lavishness of the clubhouse. Experience life in a well-designed tower, with living spaces that feel like they are yours alone.

THE SUNSHINE, THE BREEZE AND YOUR WAY OF LIFE.

Right from the architecture to the landscaping, careful touches ensure that natural light and air play important roles in the design. Each residence is open on 3 sides and has a large double-height terrace, so the living spaces are well ventilated. Even the multi-level car parking areas are well lit with natural sunlight that permeates through special light wells. Everything is designed to encourage a bright, fresh and cheerful way of life.

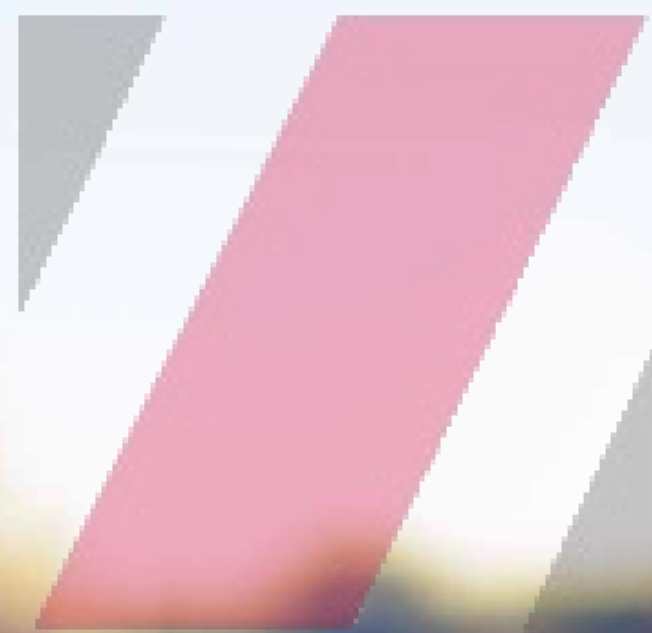

ZRICKS RESIDENCES





TRICKS

**A DISTINGUISHED
ADDRESS
TO CALL
YOUR OWN.**

Living in a tower has its own distinct aura of privilege that is only accentuated by the project's excellent location and the unique design of the tower itself. This prestige is reflected in the unique entryway, with its canopy of trees lining both sides of the avenue.



TRICKS

YOU CAN ADMIRE THE OUTDOORS OR EXPERIENCE IT.

When your evenings are spent strolling through beautiful, landscaped greenery, every day will seem like a walk in the park. Saunter your way to better health along the reflexology path or leave behind the stress of the day at the rejuvenating yoga deck. Where there's nature, there's a place that's fun for everyone – with family gardens and barbecue areas to help you relax, while your kids experience the joys of growing up alongside landscaped greenery and enjoy a host of outdoor activities. And, as you spend your days in this lush paradise, you'll find that there's nothing more relaxing than a little time away from it all.

A serene spa room with a massage table, candles, and traditional decor. The room features wood-paneled walls, a massage table with a white sheet and two rolled-up red towels, and a wooden cabinet with several lit candles. A large, stylized 'Z' logo is overlaid on the image. The text 'TURN A LEISURELY DAY INTO AN UNFORGETTABLE ONE.' is written in white, bold, uppercase letters on the left side of the image. The word 'ZRIKKS' is written in a large, red, stylized font across the middle of the image.

TURN A LEISURELY DAY INTO AN UNFORGETTABLE ONE.

One can get used to a life of luxury with so many options to unwind. There are spaces to sit back and relax, but the clubhouse is the place to truly let go of the stress. A refreshing evening at the spa or the outdoor Jacuzzi, followed by a gentle massage, can put anyone in a pleasant mood. You'll always feel at ease and let your worries float away, with just a dip in the swimming pool.

WHERE THE **POSH** AND THE **PERSONAL** MEET.

Personal spaces are important in today's world, so privacy is built into the very design of the towers. None of the residences face each other; they face outwards in a unique fan-shaped design. Not only that, the entrance to each residence is planned in such a way that it is not visible from the common lobby. These thoughtful touches ensure that all the residents will have their own private space.

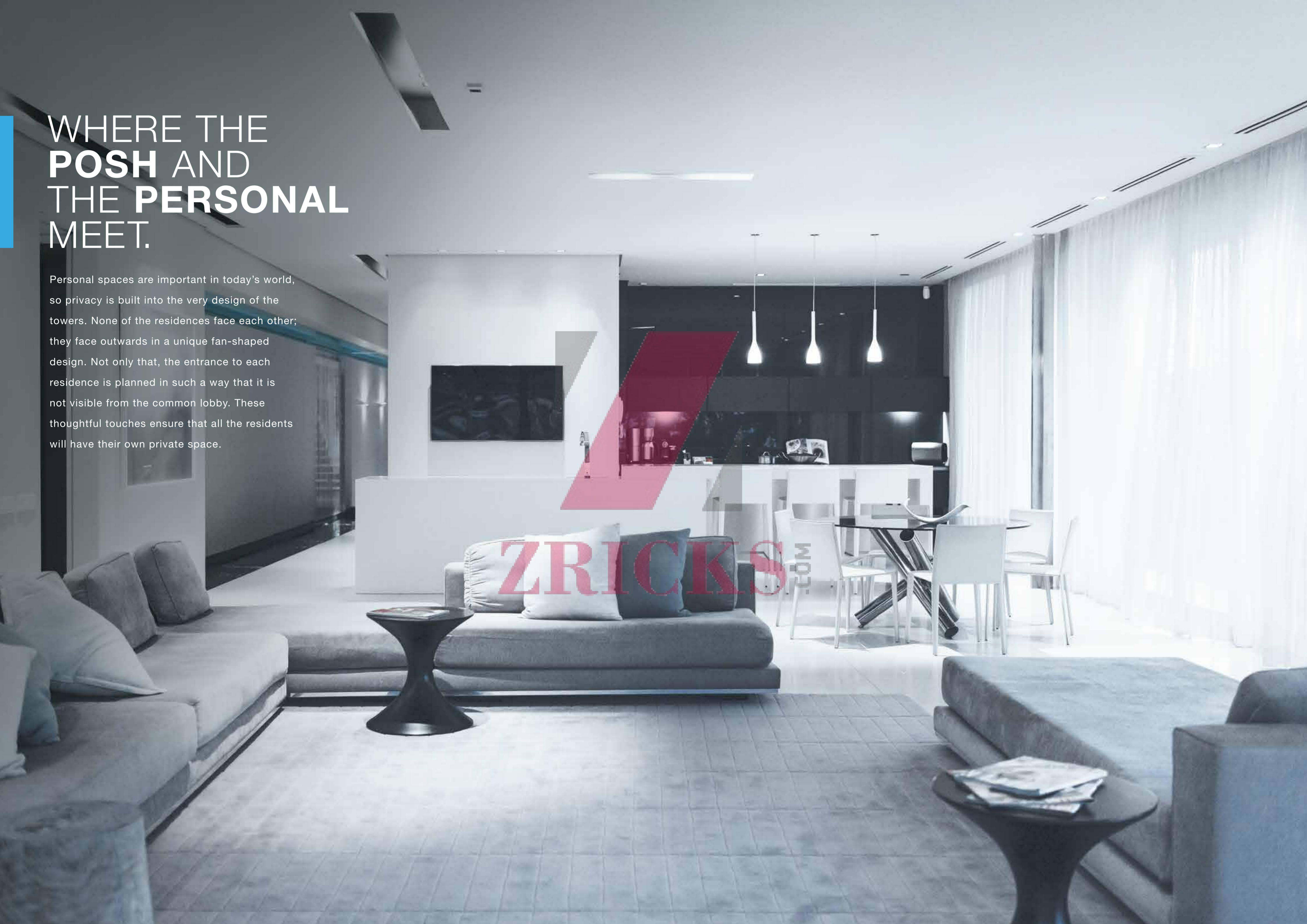



AS DELIGHTFUL AS THE AROMAS IT INSPIRES.

A modern kitchen is not just about convenience, it's about style and personality. An evocative space that inspires, your kitchen is ideally crafted with an integrated modular design that helps bring your culinary skills to life. The polished granite platform and plush granite floors make your kitchen an exquisite space to be in, while smart storage options make easy work of your daily chores. Needless to say, with a kitchen so divine, the meals you prepare will truly be heavenly.

ZRICKS

A FRESH START TO EVERY DAY.

The luxurious bathroom, with its flawless anti-skid tiles and designer dado, creates an elegant, private space that offers you the perfect way to start each day. Daily routines will forever be a breeze, with superior sanitary ware and CP fittings that shower you with luxury from the moment you enter.

ZRICKS.COM

YOUR ASSURANCE IS WELL-FOUNDED.

It's easy to live a life that's free of worry when you reside here. With state-of-the-art security systems at every turn, you'll find yourself less stressed out about the safety of your loved ones and more involved in their fun. Your home is always protected, with an advanced 4-tier security system, including video door phones and an intrusion alarm system to help safeguard your family and bolster the levels of security around you, so your concerns about safety are a thing of the past.



ZRICKS.COM

MASTER PLAN

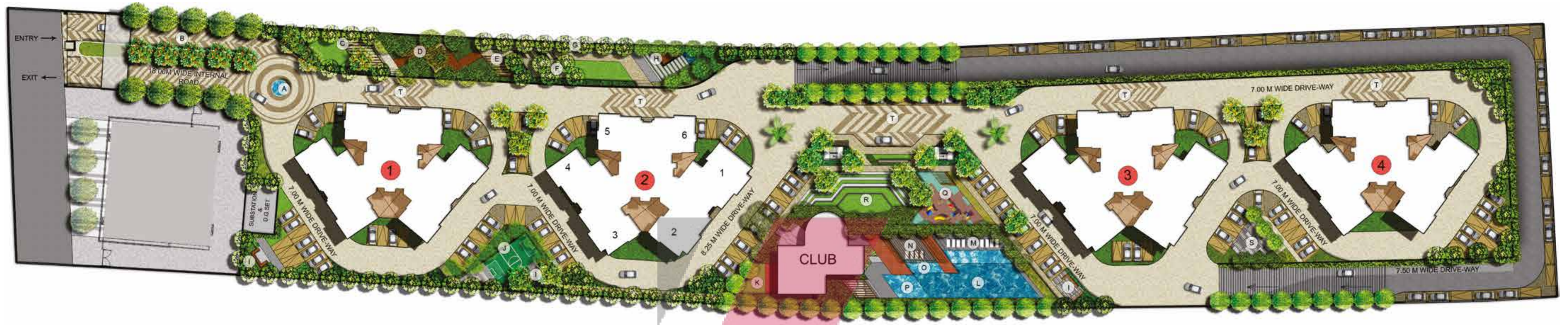

INDICATIVE COMPLEX LAYOUT

LEGEND

- | | |
|----------------------------------|----------------------------|
| A. Entrance feature | K. Outdoor party lawn area |
| B. Tree-lined avenue | L. Swimming pool |
| C. Family garden & barbecue area | M. Pool terrace |
| D. Boardwalk with tree clump | N. Swimming pool pavillion |
| E. Trellis | O. Jacuzzi |
| F. Outdoor fitness station | P. Kids' pool |
| G. Reflexology path | Q. Kids' play area |
| H. Yoga deck | R. Amphitheatre |
| I. Seating area | S. Seating area |
| J. Multi-sports court | T. Building drop-off area |

ZRICKS.COM



KEY PLAN

THE CONVENIENCES OF LIFE.



APARTMENT

- Two-sided laminated entrance door with digital lock & synchronised lighting
- All internal doors are flush with laminate finish on both sides
- Vitrified tiles in the living room, dining passages and bedrooms
- Anti-skid tiles in the terrace and dry balconies
- Air-conditioner provided in the master bedroom for 2 BHK apartments
- Air-conditioners provided in the master bedroom and the children's bedroom for 3 BHK apartments
- Anodized/powder-coated aluminium sliding windows with mosquito net
- Internal walls finished with plastic paint
- Adequate electrical points
- Provision for telephone & cable point in the living room & bedroom
- Provision for internet point in all the rooms



COMPLEX AMENITIES

- Landscaped gardens adorning the site
- Multi-sports court
- Kids' play area
- Entrance feature
- Family garden and barbecue area
- Outdoor seating area at various spots across the site
- Amphitheatre
- Outdoor party lawn area
- Outdoor fitness station
- Boardwalk with tree clump
- Reflexology path
- Yoga deck



KITCHEN

- Modular kitchen with hob & chimney
- Granite flooring in the kitchen
- Granite platform with a stainless steel sink & drain board
- Additional granite service platform
- Tiled dado above the platform up to 2 ft. high
- Gas leak detector in the kitchen
- Provision for water purifier



BATHROOM

- Anti-skid tiles in all the bathrooms
- Designer dado tiles up to door height
- Storage water heater provided in the master toilet and the children's toilet of 3 BHK apartments and in the master toilet of 2 BHK apartments
- Half-glass shower partitions in the master bathroom
- Solar water supply provided in common washrooms of both 2 & 3 BHK apartments
- Superior quality sanitary ware and CP fittings with a wall hung W.C.
- Wash basin mixer in all toilets
- Exhaust fan



CLUBHOUSE

- Clubhouse with a grand entrance lobby & reception lounge
- Gymnasium
- Indoor games room
- Multi-purpose hall with outdoor party lawn area
- Swimming pool with a pool deck and pavilion
- Outdoor Jacuzzi
- Kids' pool with an additional deck for parental supervision
- Spa & massage rooms



GENERAL AMENITIES

- Three-sides-open apartment design increasing natural light & ventilation
- Grand double-height terraces with M.S. railing
- Decorative entrance lobby
- High-speed elevators including one stretcher elevator
- Anti-termite treatment to the foundation
- Rainwater harvesting system
- Sewage water recycling plant (S.W.R.P.)
- Security cabin
- Garbage chute and room
- Driver's toilet in parking areas
- Mailbox room



SAFETY FEATURES

- Earthquake-resistant structure
- Generator backup for all designated common areas
- Fire-fighting system with fire escape staircases
- Fire rated elevator, staircase and apartment doors
- Refuge spaces for quick evacuation in case of fire
- Sprinklers in the apartment and elevator lobbies
- 4-tier security system
- Digital locks on the main doors
- Video door phones with an intrusion alarm system
- M.S. grills for the windows
- Concealed copper wiring with modular switches

ZRICKS.COM

Kalpataru Pinnacle, Goregaon

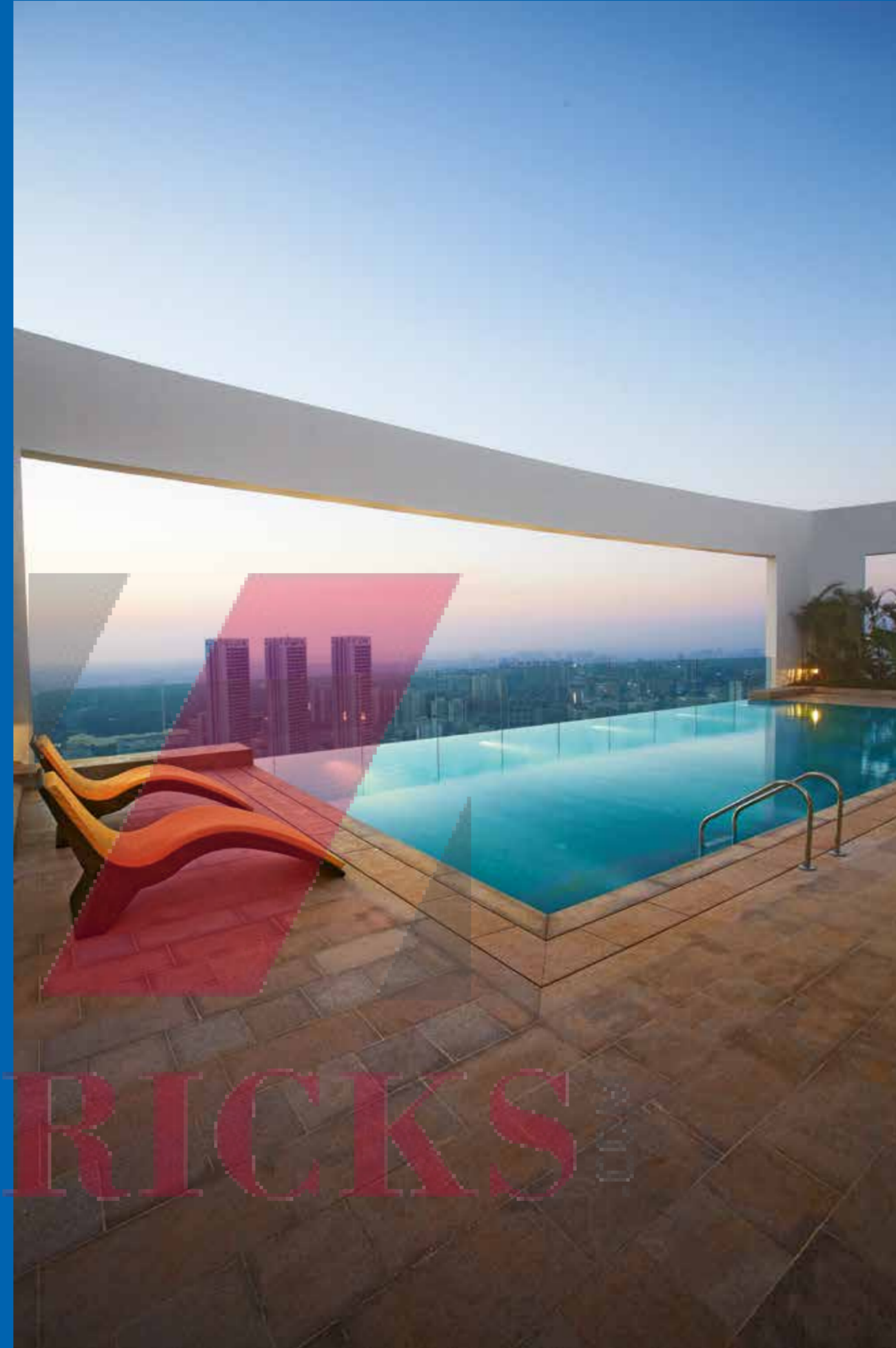

Kalpataru Horizon, Worli



Kalpataru Aura, Ghatkopar



Kalpataru Estate, Andheri

A LEGACY OF LUXURY.

With over 90 successful projects and around 16.5 million sq.ft. of developed space, Kalpataru has earned its place as one of the most trusted names in real estate. Creating luxurious living spaces comes naturally to a group that has been doing just that for over four decades. With each project, Kalpataru has always strived to create landmarks, such as Kalpataru Horizon, Kalpataru Aura, Kalpataru Pinnacle and Kalpataru Estate, many of which have made a significant mark on the skylines of Mumbai, Thane and Pune. Kalpataru continues to build upon its successes, with a conscientious approach and an unwavering faith in its philosophy. Project Crescendo is the group's latest endeavour to bring the highest quality of living to Pune, a city that is already home to many landmark Kalpataru projects.

OTHER PROPERTIES IN PUNE

Kalpataru has made its presence felt in Pune for the last 25 years with various prestigious projects spread across the city.

Kalpataru Harmony – Wakad

Kalpataru Splendour – Wakad

Kalpataru Jade Residences – Baner

Kalpataru Habitat – Koregaon Park

Kalpataru Regency – Kalyani Nagar

Kalpataru Estate – Pimple Gurav

Kalpataru Serenity – Manjri

Kalpataru Enclave – Aundh

Kalpataru Apartment – Bhawani Peth

Kalpataru Gardens – Boat Club Road

Kalpataru Arcade – M.G. Road

Kalpataru Plaza - Bhawani Peth

Kalpataru Estate, Pimple Gurav



Kalpataru Serenity, Manjri



Kalpataru Jade Residences, Baner



Kalpataru Splendour, Wakad



Kalpataru Harmony, Wakad