



ZRICKS.COM



SKYBELL

2 BHK • 3 BHK • Penthouse

Lifestyle Apartments @ Vastral



Hindva - born as an instance of brilliance - is now being one of the fastest growing construction companies of Gujarat in India. It leads with an aim of focusing on all fields of civil engineering, designed with precision and great use of technology in qualitative construction fields. The dedicated and experienced team contributes its expertise together to turn this motive into reality. Hindva arose with a tag of being a premium brand in construction & real estate industry. Likewise, it has achieved an appellation by providing the paramount services, with endless amenities and fulfilling the essential needs of its clientele in all developments, whether it is a residential living or commercial business place. Eyeing the diverse segment of the real estate industry in Surat, Hindva launched a hotel project named THE WORLD - Luxury Hotel Apartments in January 2014. Now with the launch of Digili - The Township, Hindva has leveraged the attributes of digitization in diverse aspects of the township.

The initiatives of Hindva, with well-managed service and hospitality, are deeply embedded in global culture and truly symbolize an innovative lifestyle. Hindva is led by Gujarat's well-known business empire M.K Group. Established in year 1987, the group has built its own kingdom and earned a reputation of being successful in various fields of businesses in India as well as abroad. Apart from being active in its original business of Diamonds manufacturing and its Import - Exports, the group has also ventured in the businesses of Textiles and Mining. Today, with the combination of innovation and excellence, the M.K Group remains as the most prosperous name to invest for its clientele and has earned the tag of being Socially Responsible by remaining active in communal welfare activities.

## Our Projects at Ahmedabad

Hindva's flagship brand, SHANTINIKETAN includes both commercial and residential projects with a peaceful ambience and a plethora of facilities that have grown with each iteration. Hindva Pavilion - a mall, the group's latest venture will include multi-cuisine restaurants, shopping centres, and multiplex theatre too.

With its projects, Hindva is trying to enhance the lifestyle of people of Ahmedabad by providing them luxurious spaces amidst vibrant, natural surroundings.



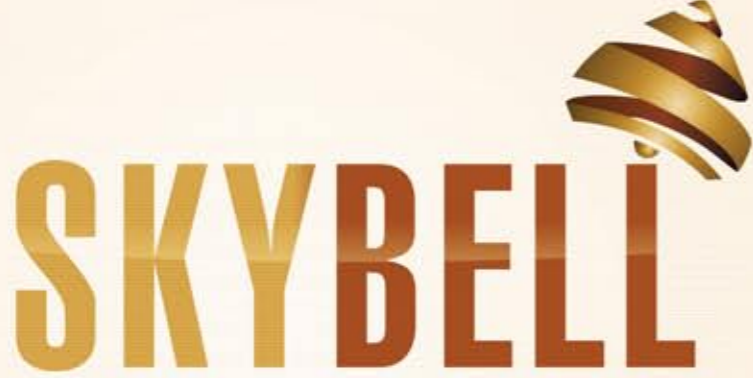

# SKYBELL

2 BHK • 3 BHK • Penthouse

Lifestyle Apartments @ Vastral

Skybell is a residential project situated in the environment-friendly haven of Ahmedabad, consisting of 9 impeccable towers with 232 luxurious homes & 10 Penthouses. Blessed with sylvan surroundings, leisure spots and a plethora of amenities, Skybell is like no other project.

Touted as the First Penthouse Project in Vastral, Skybell is the embodiment of homes that elevate lifestyles to an altogether different level.

It is a mirror of the life you wished for!



A Lifestyle, as  
Musical as your Dreams!  
**A Lifestyle, as Musical as your Dreams!**

# Virtually Sublime

## Virtually Sublime

The sturdy heights of these towers reflect on the strong base of vision on which they are erected!



Site Layout Plan



Typical Floor Plan

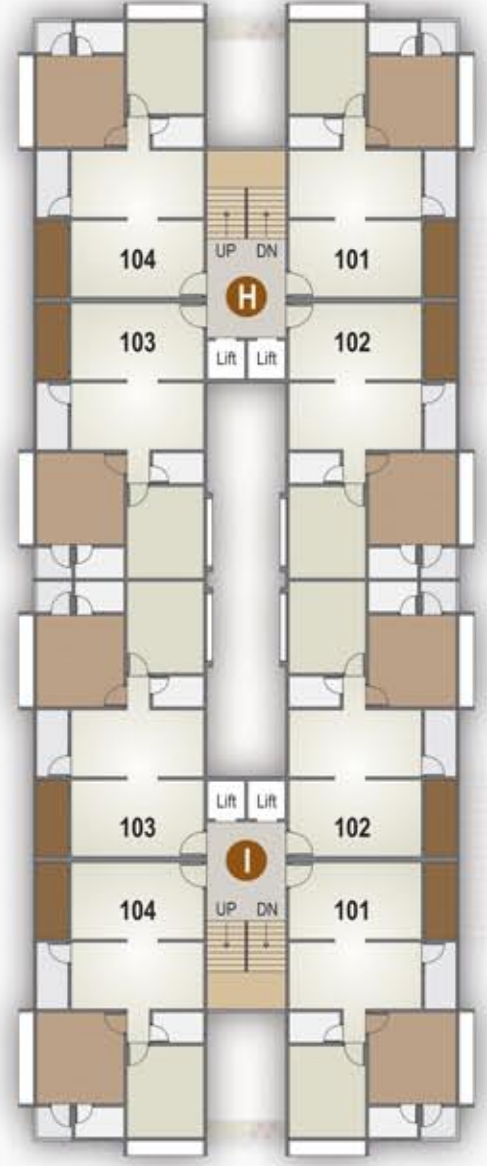
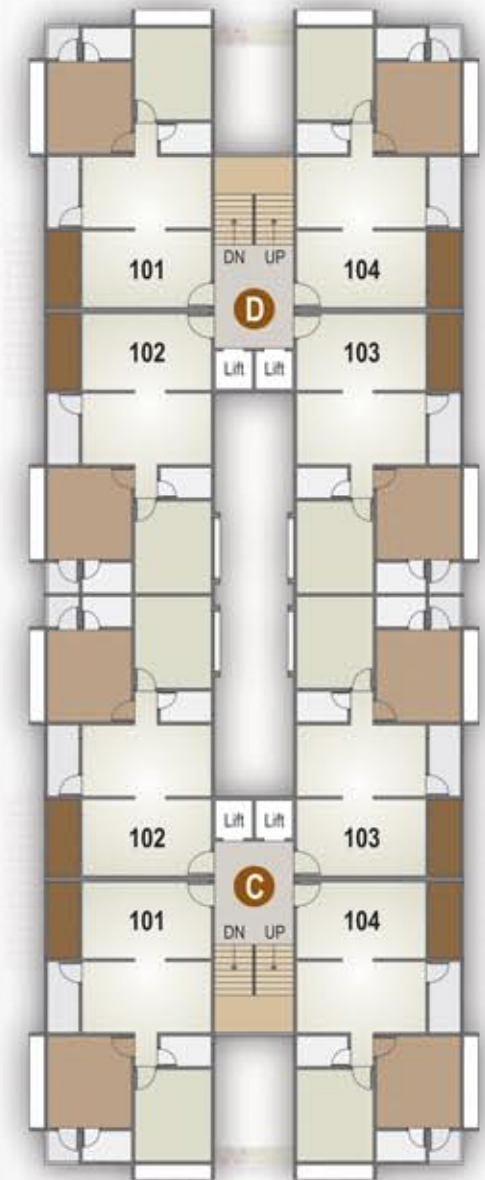
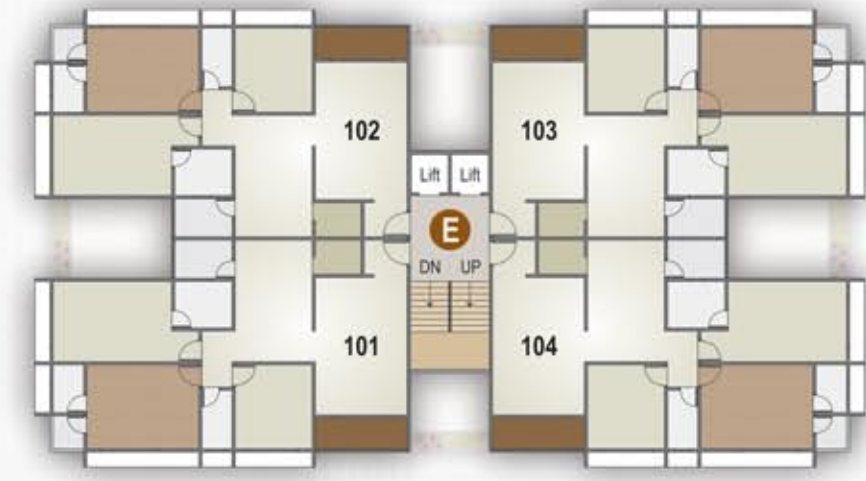
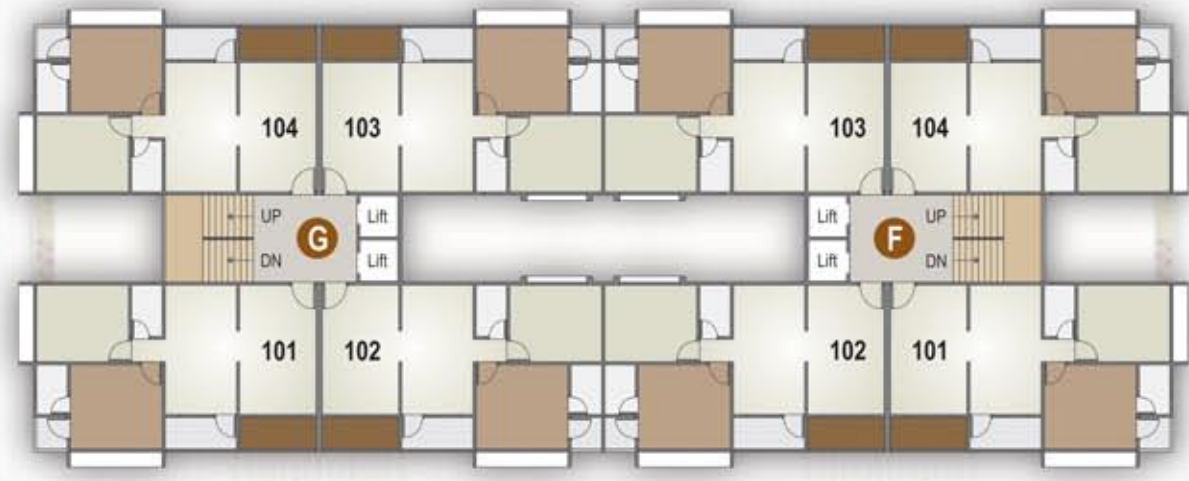

25 Ft. Wide Road

25 Ft. Wide Road

18.00 MT. WIDE ROAD



Effortlessly  
Enticing

**Effortlessly Enticing**

With a beautiful structure, and a delightful exterior to complement its green environs, Skybell underlines happiness!



Eternally  
Blissful

**Eternally Blissful**

Your home in Skybell is a reflection of an ideal life that you aspired for, bringing leisure, warmth, luxury and space in equal measure.



## Amenities

Skybell is replete with everything you wished for, right from your ideal home to the surrounding gardens, the playground, ample parking space and an indoor gaming zone.

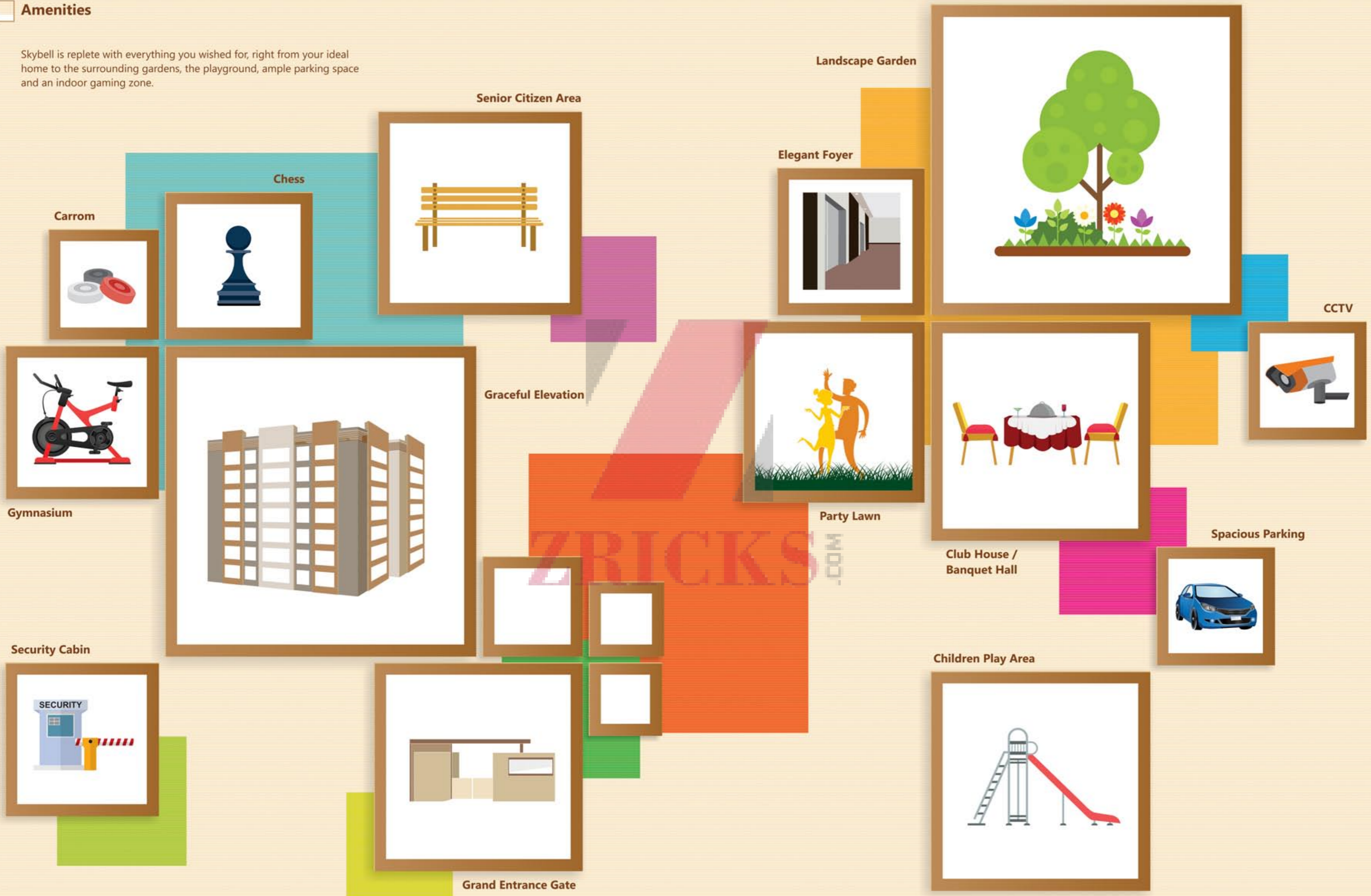

Subtly  
Elegant

**Subtly Elegant**

Skybell brings the right blend of ripe design with genuine practicality.



# Effectively Envisioned

## Effectively Envisioned

Towering among the other landmarks near to the location, Skybell does reach the sky, converting realistic dreams into reality.



# Incessantly Sensuous

## Incessantly Sensuous

A kind and cosy space is just the thing for quiet, tranquil moments that envelop our lives in leisure.



[www.Zricks.com](http://www.Zricks.com)

3 BHK Unit Plan | Block A & B

3 BHK Unit Plan | Block E

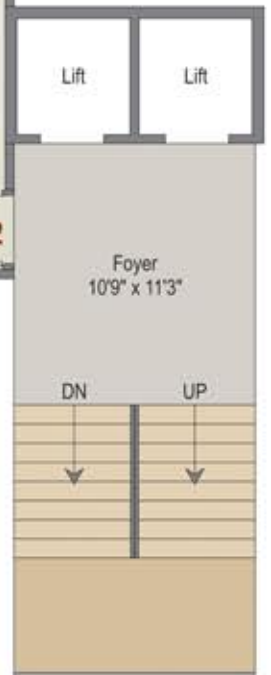
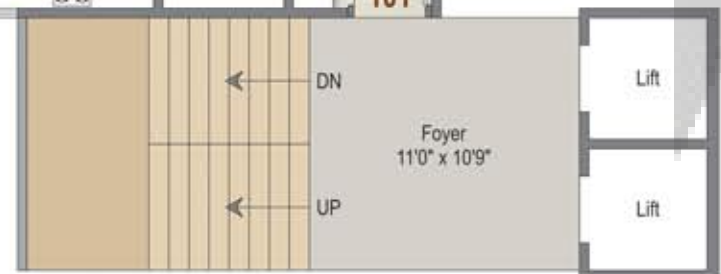

ZRICKS



2 BHK Unit Plan | Block C, D, F & G

2 BHK Unit Plan | Block H & I



ZRICKS COM



3 BHK Penthouse Plan | Block A & B



# Indigenously Charming

## Indigenously Charming

Skybell boasts of spacious Penthouses, the first of its kind in the locality, defining grace, charm and sophistication along with vibrance due to its surroundings.



2 BHK Penthouse Plan | Block C, D, F & G

ZRICKS



## Specifications

### Entrance

- Decorative Main Gate and Compound Wall

### Security

- 24 x 7 Security with CCTV Camera & Security Cabin
- Pick-up & Drop-off Zone for School Bus

### Reception, Elevator & Stairs (Common Area)

- Personal Letter Box, Name & Number plate for each Flat
- Reception area with Granite & Vitrified flooring and Seating arrangement
- 2 High-Speed Automatic Elevators of reputed brand
- Granite & Tiles Cladding on each floor, Lift Entrance & Foyer area
- Granite flooring in Stairs
- M.S. Railings in Stairs

### Power & Electrification

- Standard quality ISI Wires & Modular Switches
- MCB Distribution Panel
- Ample Electric Points
- A.C. Points in Drawing & Master Bedroom
- T.V. (DTH / Cable) Connection Points with MDU (Single Disk on each Tower) for clean & clear Terrace

### Wall Finish

- Internal Mala Plaster with Putty finish
- Waterproofing treatment on outer Walls with Double Coat Sand faced Plaster with Acrylic Sun Reflect Paint
- R.C.C. coping at sill level on all walls of building

### Structure

- Earthquake-resistant R.C.C. frame Structure

### Flooring

- 2 x 2 Nano Finished Vitrified Tiles in Drawing, Dining, Kitchen & Bedrooms
- Water proofing on Terrace with China Mosaic for heat reflection
- Kota stone flooring & Glazed Tiles up to Sill level in wash area

### Kitchen

- Platform with Granite top & SS Sink, Designer Glazed Tiles up to Lintel level
- Furnished Modular Kitchen with SS Baskets
- R.O. Point

### Doors & Windows

- Decorative Main Door with good quality fittings
- Powder Coated Aluminum Section Windows with Double Sill (Outside Marble & inside Granite Sill)

### Bathroom & Plumbing

- Designer Glazed Tiles up to Lintel level
- Premium quality Bath fittings & Sanitaryware
- All Water lines in Kitec & UPVC pipes for no joints in flooring
- Water Meters in all flats to avoid water wastage
- Geysers in all Bathrooms
- Epoxy-filled joints in flooring

### Parking

- Common Parking at Ground level & Basement level

### Internal Road

- R.C.C. Roads with Paved Blocks & Street Lights

### Water Supplies

- Common Bore-well with Underground & Overhead Water Tanks
- 24-Hour Water supply with automated Pressure Pump system

### General

- Plenty of open space with Landscaped Garden, Children Play Area, Gazebo Seating, Jogging Track & Senior Citizen Seating Area
- A.C. Community / Party Hall
- Club House with Gym, Library & Indoor Games



## Nearby Destinations

- Shantiniketan III - - - - - 200 Mtr.
- Podar International School - 200 Mtr.
- R.A.F. Campus - - - - - 200 Mtr.
- Metro Starting Point - - - - - 1 Km.
- Madhav International School - 1 Km.
- BAPS Swaminarayan Mandir - - 1 Km.
- Baroda Express Highway - - - 2 Kms.

Site Address : SKYBELL

Opp. R.A.F. Camp, S. P. Ring Road, B/h. Vrundavan Palm Bungalows, Nr. Canera Bank, Vastral, Ahmedabad.

Booking Contact : +91 99044 72491 | +91 79 6888 9995



ahmedabd@hindva.com | www.hindva.com | /Hindva | /Hindva | /Hindva

IVRS (24x7): +91 80000 11811

Terms & Conditions  
 • All rights reserved with the developers to make any changes in the project and all the members shall abide by such changes • Stamp duty, registration charges, service tax or any other charges and taxes as & when levied by government or any of its body shall be borne by purchaser/buyer/legal possession holder • This brochure is not to be treated as part of the legal document and is for an easy display of the project • Subject to Ahmedabad jurisdiction only



DIAMONDS | REAL ESTATE | HOSPITALITY | HEALTH CARE | TEXTILES | MINING | CSR

www.Zricks.com



Think **Positively** Network **Well** Exercise **Daily**  
 Live **Forever** Eat **Healthy** Work **Hard** Be **Happy**  
 Build **Faith** Worry **Less** Read **More** Stay **Strong**  
 Relax **Often** Love **Always** Volunteer **Freely**



## The Dreams... Being Transformed into Reality



Execution Growth Advancement Efforts values Imaginations Ambitions Creativity



Design - Principal Architect



Ahmedabad

Elevation



Surat

Structural Engineer



Ahmedabad

Brochure Designed by  
www.openmindindia.com