

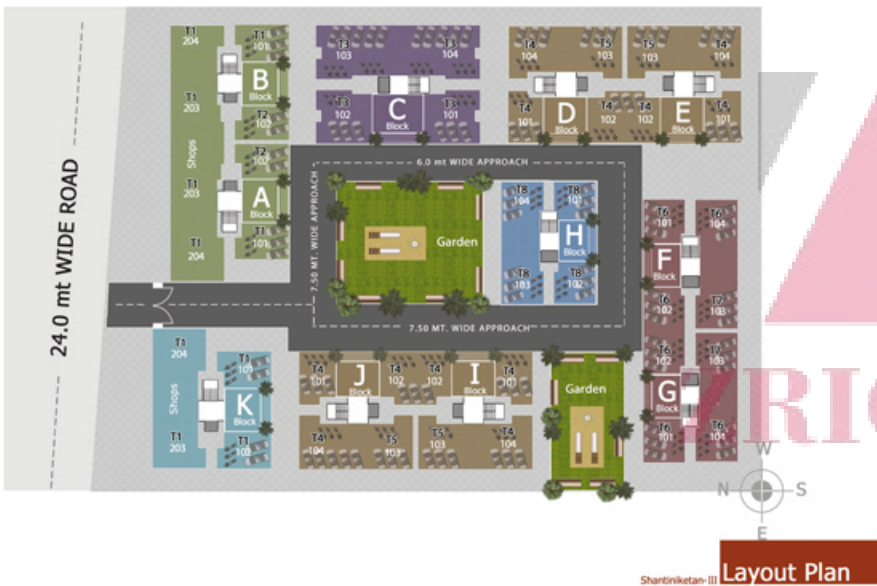

"Shantiniketan" -III



Amenities

- Gorgeous main gate with security cabin.
- Pleasant & spacious Entrance foyer.
- One lift of standard quality for each building.
- Ample parking area.
- Beautiful landscape garden & children play area with amusement equipment.
- Senior citizen seating area.
- Well equipped gymnasium.
- Indoor games like Carrom, Chess, Billiards.
- Intercom Facility.
- 24HRs. Water supply, common bore well with submersible pump.
- Underground & Overhead water tank.
- R.C.C/Paver block road with street light.

Rules & Regulations

- Only internal changes shall be allowed with prior permission & shall be charged extra in advance.
- Changes in elevation is not permitted.
- Stamp duty, registration fees & service tax shall be borne by members.
- A.E.C. , A.M.C. & other legal charges shall be borne by members.
- Irregular payments shall cause cancellation of booking.
- Developers reserve all rights to make any alteration in plan & member shall abide by such changes.
- This brochure is only for easy display & information of the project & does not form part of the legal documents.



Colour of A & B block with shops, in Layout plan. > ●

Detailed Layout Plan for A & B block. First Floor (Shops)



Detailed Layout Plan for A & B block. Ground Floor (Shops)

Shantiniketan-III
Detailed Layout Plan
Detailed Layout Plan of Ground Floor & First Floor shops for A & B Block.





Colour of Block A & B, Jn Layout Plan >

Colour of Block F & G, Jn Layout Plan >

Your location in Block.

Your location in Block.

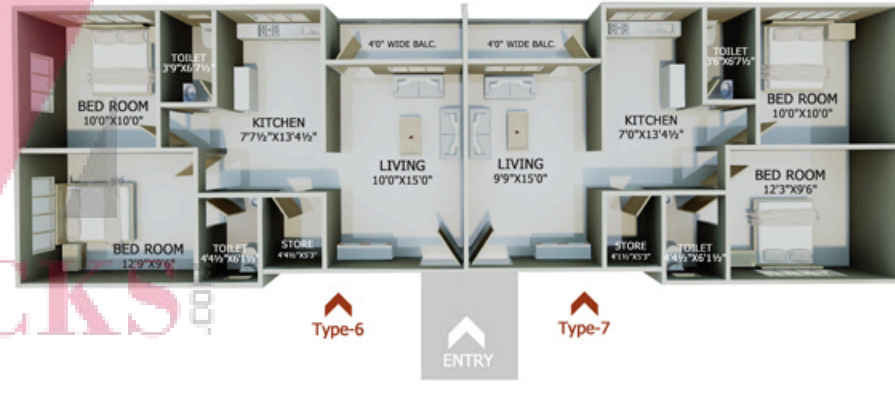
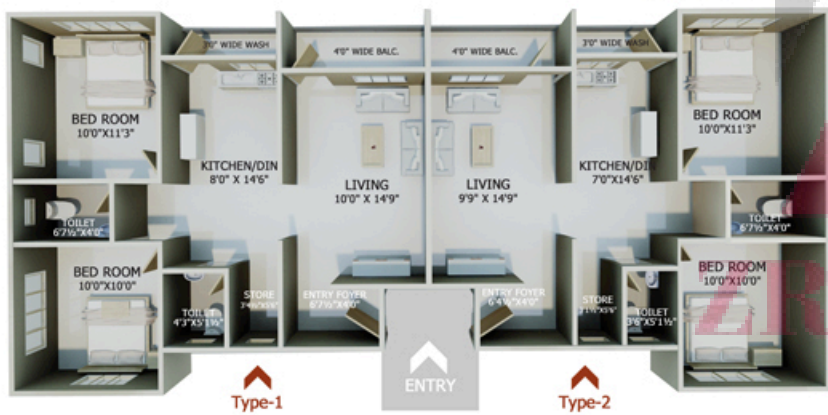

Shantiniketan-III
Floor Plan of Building block A & B | Type-1 & Type-2 Flat.

Detailed Floor Plan

Detailed Floor Plan

Shantiniketan-III
Floor Plan of Building block F & G | Type-6 & Type-7 Flat.



Shantiniketan-III

www.Zricks.com



Structure

Earthquake resistant R.C.C frame design.



Plaster

Internal plaster with putty finish & external double coat sand face plaster with acrylic water proof paint.



Kitchen

Granite platform in kitchen with S.S sink & designer glazed tiles up to lintel level on platform. Kitchen is modular kitchen with P.V.C baskets & shutters.

Toilet & Plumbing

Coloured glazed tiles dado up to lintel level & european W.C.Pan. Concealed plumbing with good quality C.P fittings & Geysers in all toilets.



Flooring

Vitrified tiles flooring in drawing, kitchen & dining + all bed rooms. On terrace china mosaic for heat reflection & water proofing.



Door & Window

Decorative main door & all other doors are flush doors with good quality fittings. Powder coated aluminum section sliding window with surrounding granite sill.

Electrification

Sufficient light-point in concealed copper wiring with modular range accessories. T.V. & telephone point in living room & master bed room. MCB provision in main distribution board.



Shantiniketan-III

Specifications

Bird's Eye View

Shantiniketan-III



Your location in block.
Type-8



Type-8



Colour of K block with shops in Layout plan >

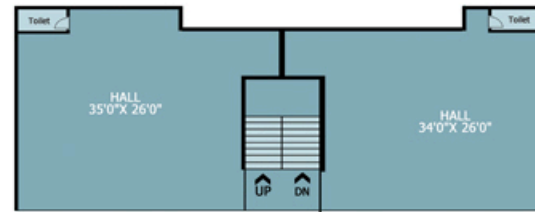

Detailed Layout Plan for K block. **First Floor (Shops)**



Detailed Layout Plan for K block. **Ground Floor (Shops)**

Shantiniketan-III
Floor Plan of Building Block H | Type-8 Flat.

Detailed
Floor Plan

Detailed
Layout Plan

Shantiniketan-III
Detailed Layout Plan of Ground Floor & First Floor shops for K Block.





Colour of block D & E, in Layout Plan. >

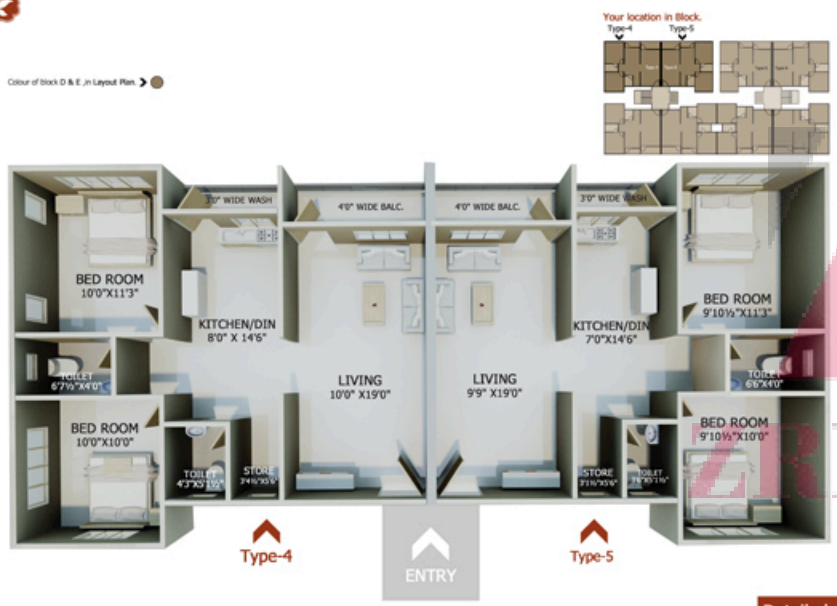

Colour of block C, in Layout Plan. >

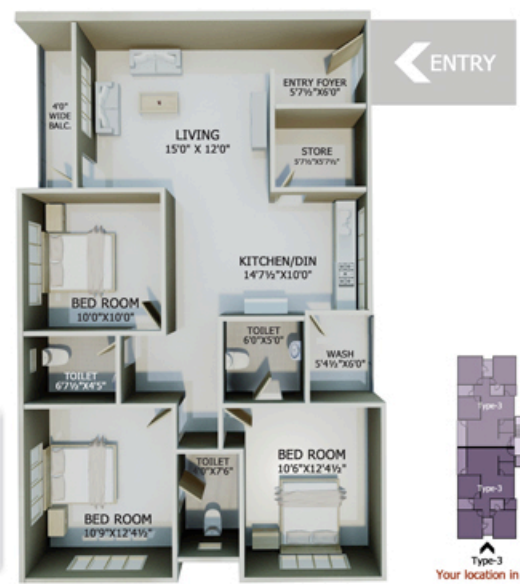

Shantiniketan-III
Floor Plan for building block D - E & I - J. | Type-4 & Type-5 Flat.

Detailed Floor Plan

Detailed Floor Plan

Shantiniketan-III
Floor Plan for building block C | Type-3 Flat.



DEVELOPERS :



HINDVA BUILDERS

+91 98251 38080

Architect

Aayojan
Haresh.J.Mahadevwala
Surat.

Booking

"Shantiniketan-III"
Opp. R.A.F. Camp
Near S.P. Ring road,
Vastrol,Ahmedabad

Contact: +91 8141426001, +91 8141426006