



PLATINUM

— *Premier* —

Note: All layout Plans, Floor Plans and Specifications are tentative and are subject to variation and modification as decided by company/relevant authorities and cannot form part of any offer or contract.

Ramprastha Realty Pvt Ltd

Registered office : C - 10, C Block Market, Vasant Vihar, New Delhi - 110057. Tel.: 011 - 46012071 - 75 / Fax: 011 - 46012076

Marketing office : C-168 Ramprastha Colony, Ghaziabad. Tel.: 0120 - 4778444 Fax: 0120 - 4104841

www.ramprastha.com

www.Zricks.com

PLATINUM

— *Premier* —

Experience life

A soulful and serene retreat which can take you far away from the madding crowd and is yet nestled in all the urban joys is where you experience life. Platinum Premier; the sensitive, concept living, luxurious community apartments within the lush green environs of Ramprastha Greens.





PLATINUM

— *Premier* —

The concept of wellbeing is connected to the concept of space. In spirit and essence the architecture of Platinum Premier is about spacious living. It's about being in harmony with nature; Large green stretches, landscaped courts, sit out spaces are in tune with apartments which are open from sides and are ideal for perfect ventilation of the core elements of life.



Live impressive

Fine living begins at the living room. Acrylic walls, Italian finished flooring; glazed doors add an international touch of class and an aura of sophistication to the opulent lobby in each apartment of Platinum Premier.





Live divine

Laminated wooden flooring when tastefully matched with soft acrylic hues on the wall, it creates an out of the world bedroom experience. Live and relive moments of perfect joy and sublime happiness at the artfully done bedrooms of Platinum Premier.





Live royal

It's impossible to imagine a luxurious apartment without a well equipped kitchen. Platinum Premier understands the fact. The modular kitchen here is highly sophisticated and offers every possible fitting which makes cooking convenient, easy and fun.





Live rejuvenated

Every day's a great day when you begin it good. Bathrooms at Platinum Premier help you begin your day on a cheerful note.

The soothing ambience, tapestry of colours and state-of-the-art sanitary fittings are exercises in modern day luxury and urban fantasies.

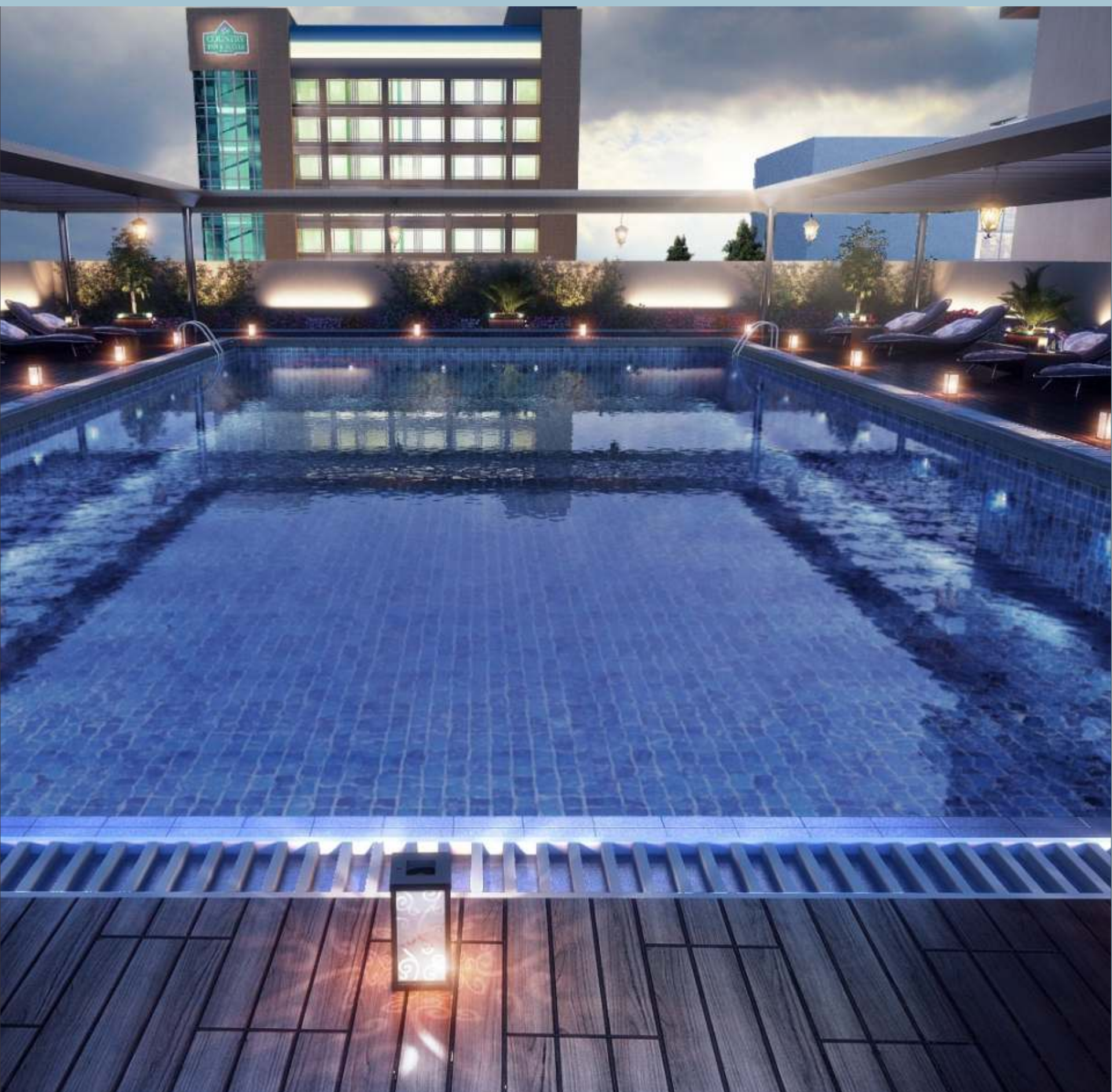

Live conscious

It's not your fabulous house which is your only wealth; it's your health which is your greatest wealth. We have given it a due thought while building Platinum Premier. A modern day club built to suit exclusive tastes, an aqua blue swimming pool, an urban gymnasium and a basket ball court looks after all your health and leisure needs so that you remain young at heart.



UNIT PLANS



SPECIFICATIONS & PAYMENT PLAN

SPECIFICATIONS					
AREAS	WALLS	FLOOR	DOORS	WINDOWS/GLAZING	OTHERS
LIVING ROOM/ DINNING ROOM/ LOBBY	Acrylic Emulsion	Imported Flooring	Hardwood door frames & UPVC Doors	UPVC Windows & Glazing	Branded Split Air Conditioners
ALL BEDROOM	Acrylic Emulsion	Laminated Wooden Flooring	Hardwood door frames & UPVC Doors	UPVC Windows & Glazing	Branded Split Air Conditioners in all rooms,wooden cupboards
KITCHEN	Designer Tiles above Kitchen Platform	Designer Anti-Skid Tiles	Hardwood door frames & UPVC Doors	UPVC Windows & Glazing	Modular kitchen, kitchen counters in marble / Granite, Stainless steel sink with drain board, Gas hob & chimney
BALCONIES/ OPEN TERRACES	Acrylic Emulsion	Anti-Skid Tiles	Hardwood door frames & UPVC Doors	UPVC Windows & Glazing	Acrylic Emulsion/Weather Proof paint
TOILET	Combination of Ceramic Tiles on all wall up to roof level	Anti-Skid Tiles	Hardwood door frames & UPVC Doors	UPVC Windows & Glazing	Shower partition in master bedroom, single lever CP fittings, wash basin with platform and wall mounted WC pan
SERVANT ROOM/ UTILITY	Oil Bound Distemper	Ceramic Tiles	Hardwood door frames & UPVC Doors	Powder coated aluminium glazing	CP fitting & white chinaware
ELECTRICALS	Modular type switches & sockets, Copper wiring (fittings like fans, lights fixtures, geysers) in all room.				
FACILITIES	High Speed Elevators; Power backup and treated water supply; Adequate basement parking, Landscaped courts with sit out spaces, Kids play area.				
	Pedestrians paths, Jogging track with several trellises enhancing outdoor landscape				
	Club: Swimming Pool, Gymnasium, Basketball Court.				
SECURITY	CCTV for Basement parking and Entrance lobby at Ground floor, Boom barriers at Entry of the complex.				



Lifestyle larger than life

Work, play, entertainment, shopping, schooling, health care, metro, brisk connectivity and all other amenities which make our lives scattered are now available under one roof not in a make belief world but at Platinum Premier. Find the world at your doorstep. True to our times, truer to commitments, nestled in nature, steeped in convenience, completely secure - Platinum Premier is your dream residence in more than just one way.



LOCATION MAP

