

**Regent Arcade**











ADAM THE LUXURY SPA  
www.spadamal.com

evok

The Home Fashion Mega Store

ebony GAUTIER  
Stylish French Living

ebony GAUTIER

Reebok

Power

Power

evok

ZBRICKS









JMD

REGENCY CITY CENTRE  
CHANGE START WITH YOU

ESSO  
SAFETY & SECURITY

KITCHEN  
WARDROBE  
WORK STATION  
1<sup>ST</sup> FLOOR

EVOK

CHIX

August  
OPENING SOON  
augustonline.in  
Contact : 9999886666

The HomeFash MegaStore  
EVOK

by Hisham  
The HomeFash MegaStore  
EVOK

design  
EVOK

VOK  
ES WITH SOUL  
Home Fashion Mega Store

EVOK

HUMAN  
LURE STORE

ebony | CAUTION

x-cite.  
Experience Electronics  
Like Never Before.

x-cite.

KFC Restaurant

KISS LICK  
DRÖOL SLURP

BEST GETS  
BETTER!

EVOK

ENTRY  
REGENCY

WELCOME  
TO  
JMD REGENCY ARCADE







ebony GAUTIER  
LIVING DINING BEDROOM



FOR  
LEASE  
RENT

Contact #  
9891929364  
9899981412  
0124-4636363

d beer factory

essence  
REVEAL THE TRUE YOU

DOORS | WARDROBES | KITCHENS | HOMEWARES

FOR  
Preferred  
REFRESHING  
point!  
Partners in progress  
RICA

LIVING | DINING | BEDROOM

LIVING INSPIRATION  
*The Furniture Boutique*

OPUS HOME FURNITURE  
*loves of furniture*

ZRICK'S

ebony GAUTIER

ebony GAUTIER



LOWER GROUND FLOOR PLAN

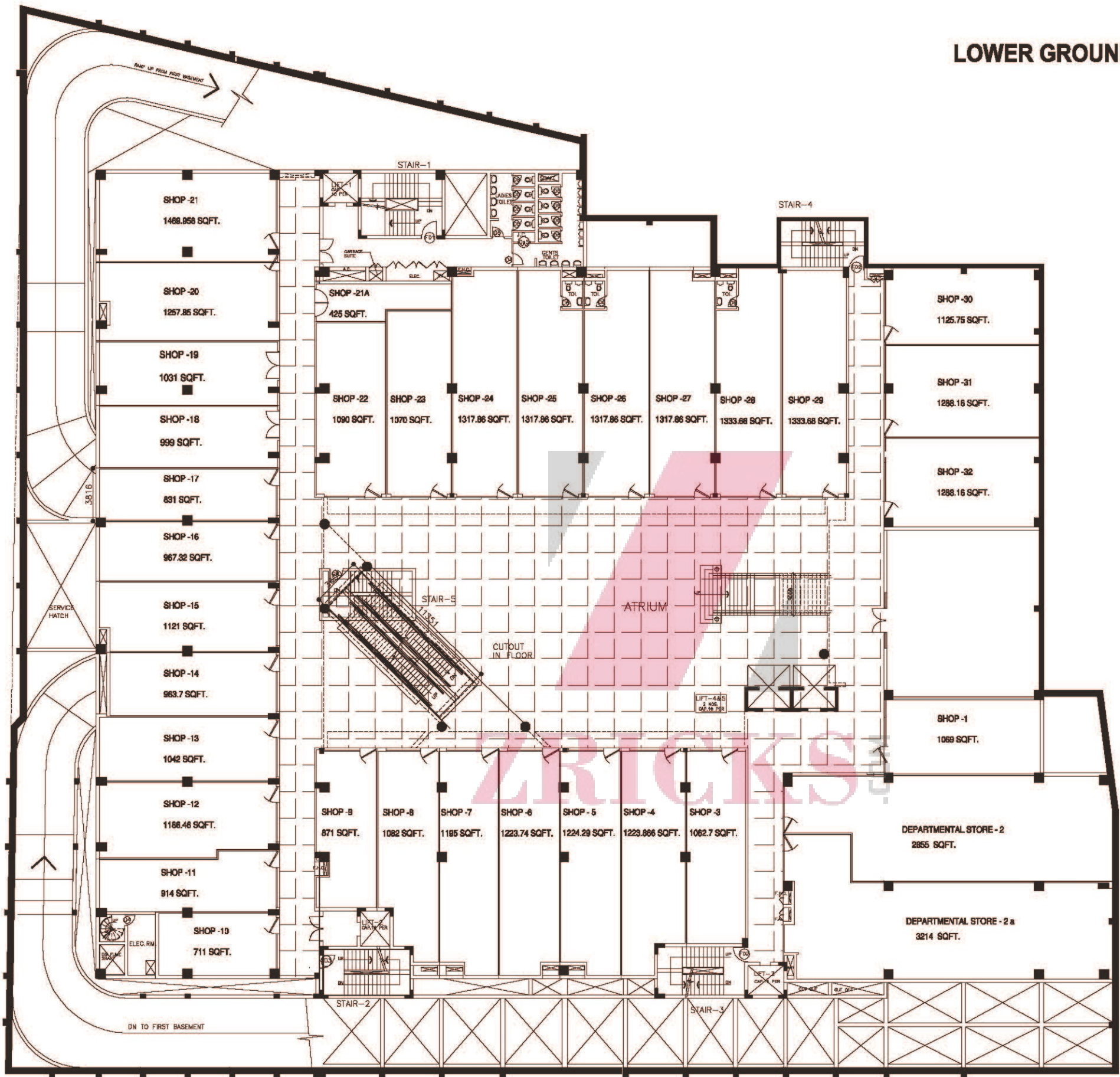

PROJECT

**REGENT ARCADE**  
COMMERCIAL COMPLEX AT MEHRAULI ROAD  
SECTOR - 28, TEHSIL & DISTT. GURGAON,

DRAWN BY : Mr. DHARMENDER

EDITED BY :

CHECKED BY :

RECIEVED BY :

TITLE

**SALE PLAN**

DRAWING NO.

DATE 4TH APRIL,09 :





UPPER GROUND FLOOR PLAN

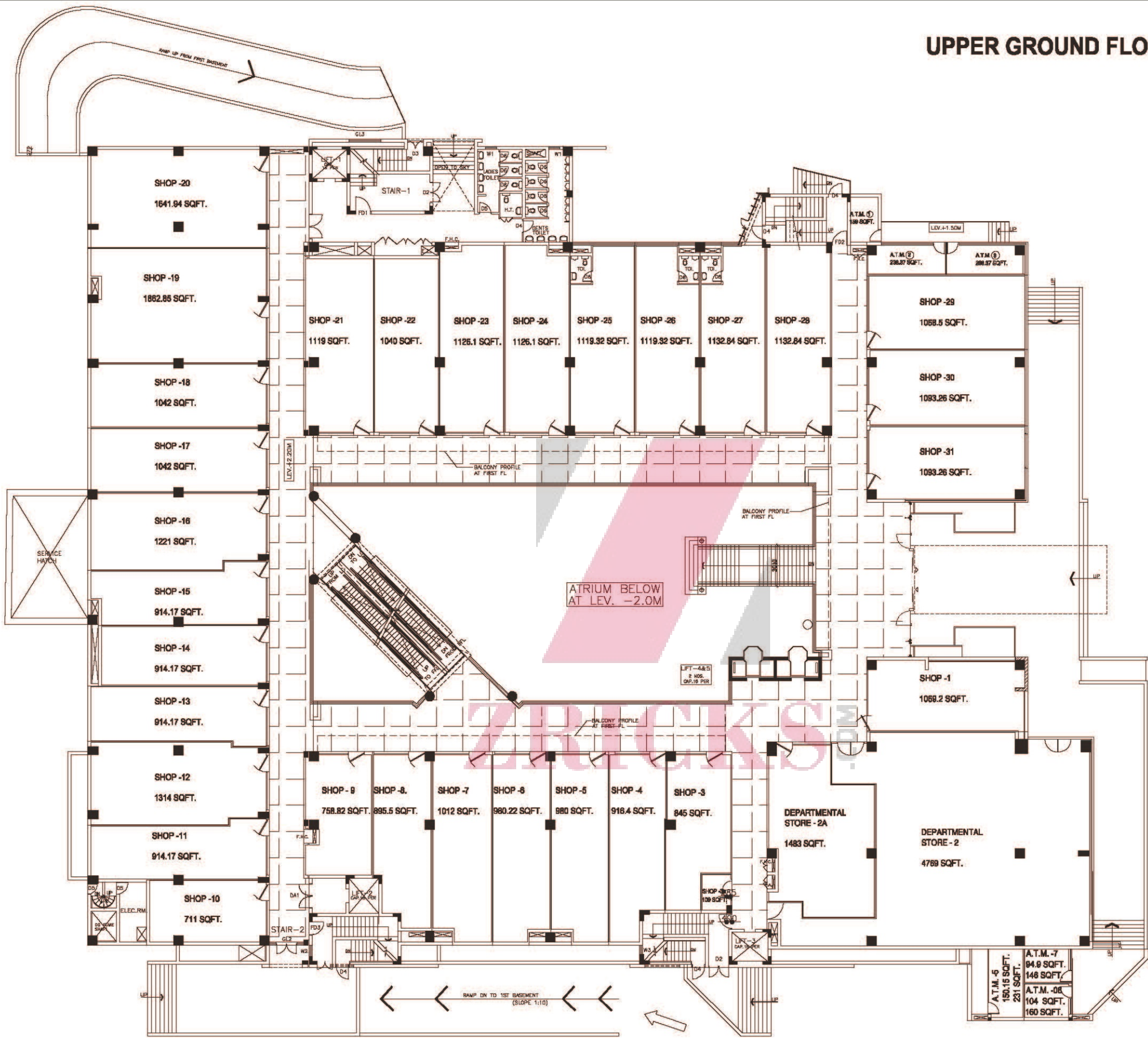

PROJECT

**REGENT ARCADE**  
COMMERCIAL COMPLEX AT MEHRAULI ROAD  
SECTOR - 28, TEHSIL & DISTT. GURGAON,

DRAWN BY : Mr. DHARMENDER

EDITED BY :

CHECKED BY :

RECIEVED BY :

TITLE

**SALE PLAN**

DRAWING NO.

DATE 4TH APRIL,08 :

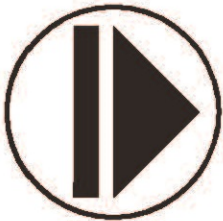



FIRST FLOOR PLAN

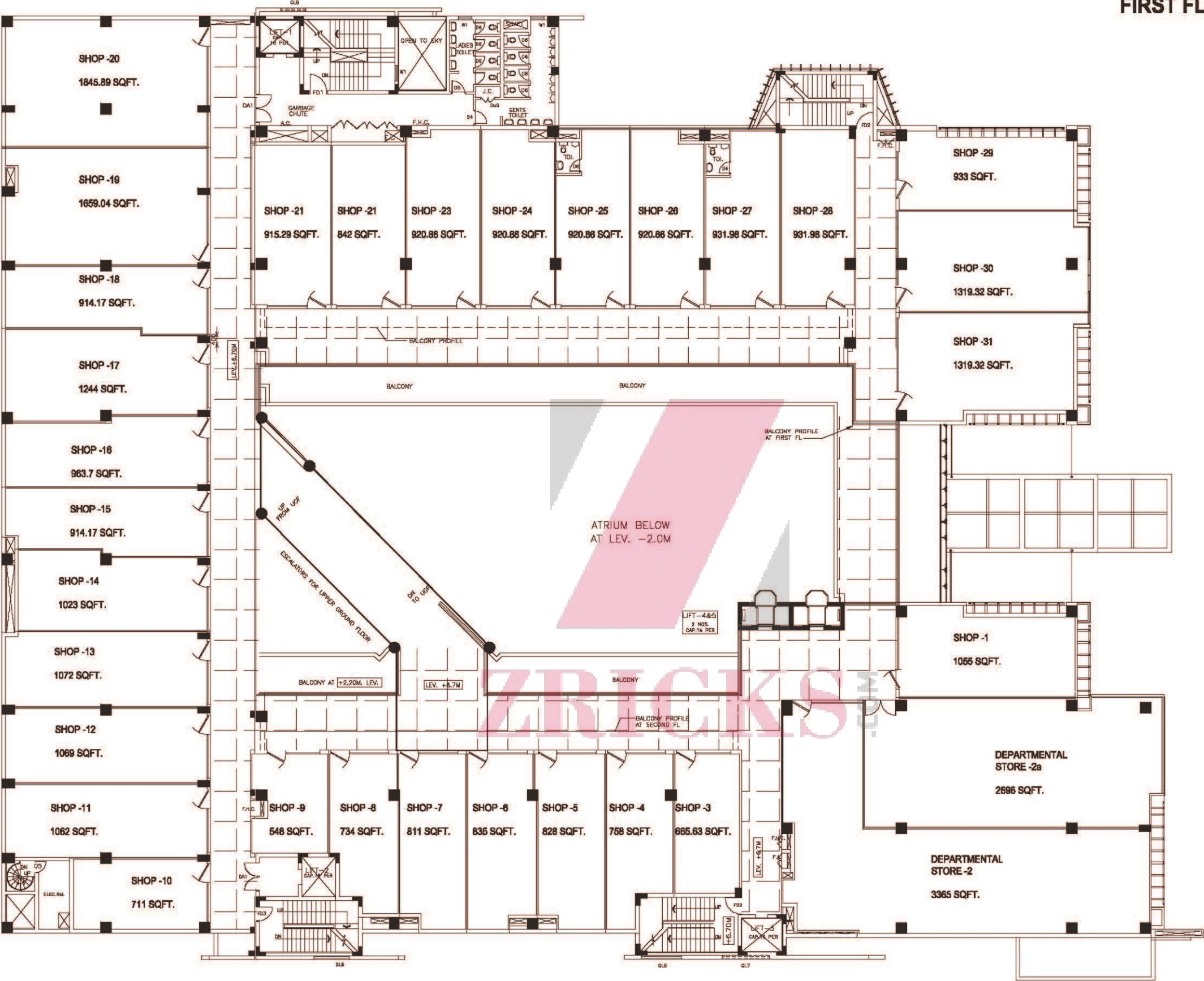

PROJECT  
**REGENT ARCADE**  
COMMERCIAL COMPLEX AT MEHRAULI ROAD  
SECTOR - 28, TEHSIL & DISTT. GURGAON,

DRAWN BY :	Mr. DHARMENDER
EDITED BY :	
CHECKED BY :	
RECIEVED BY :	

TITLE	
SALE PLAN	
DRAWING NO.	DATE 4TH APRIL,09 :

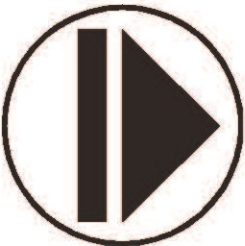



SECOND FLOOR PLAN

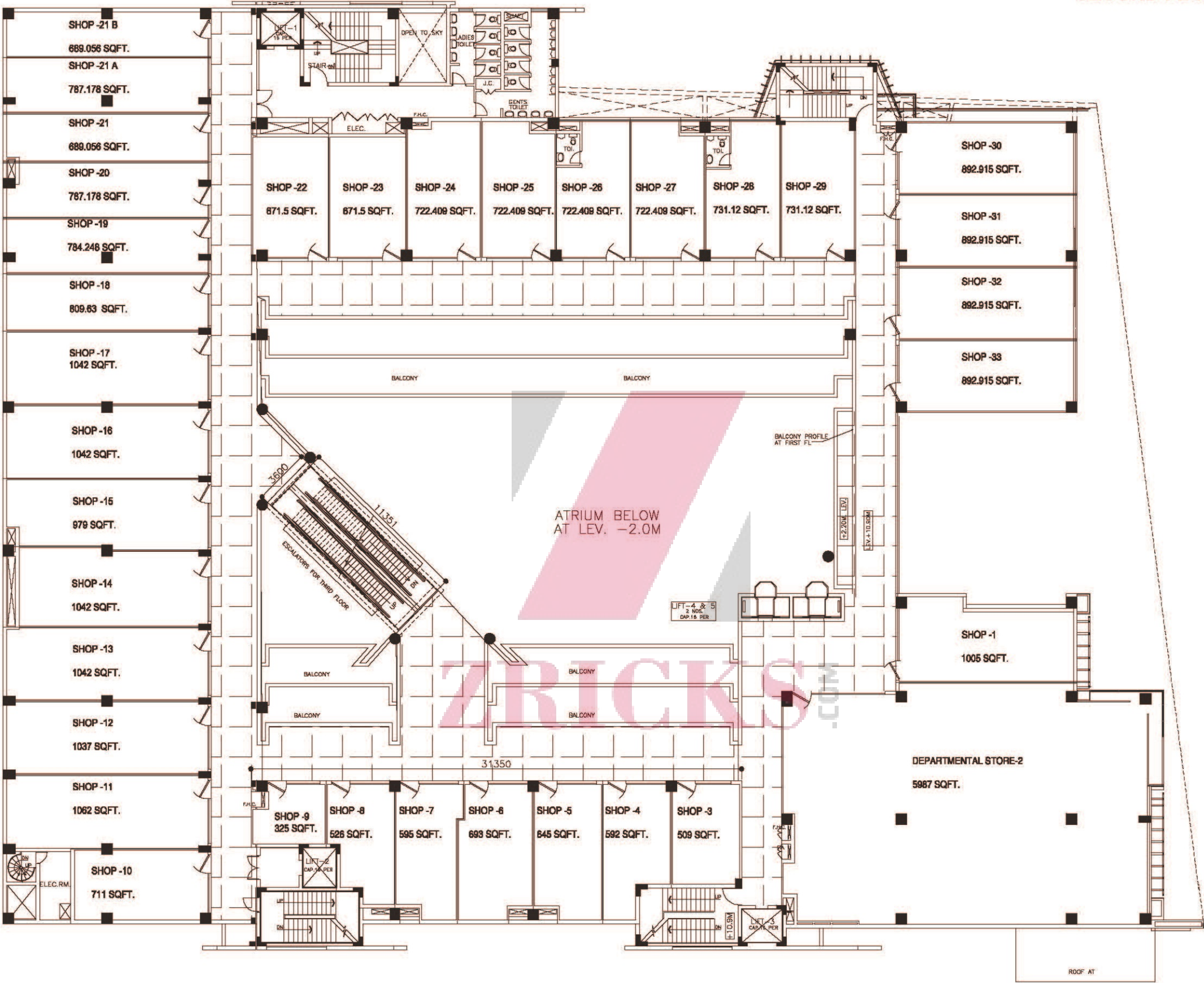

PROJECT

**REGENT ARCADE**  
COMMERCIAL COMPLEX AT MEHRAULI ROAD  
SECTOR - 28, TEHSIL & DISTT. GURGAON,

DRAWN BY : Mr. DHARMENDER

EDITED BY :

CHECKED BY :

RECIEVED BY :

TITLE

**SALE PLAN**

DRAWING NO.

DATE 4TH APRIL,09 :

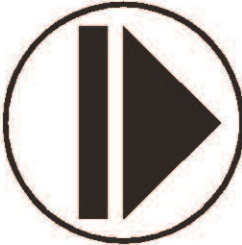



# THIRD FLOOR PLAN

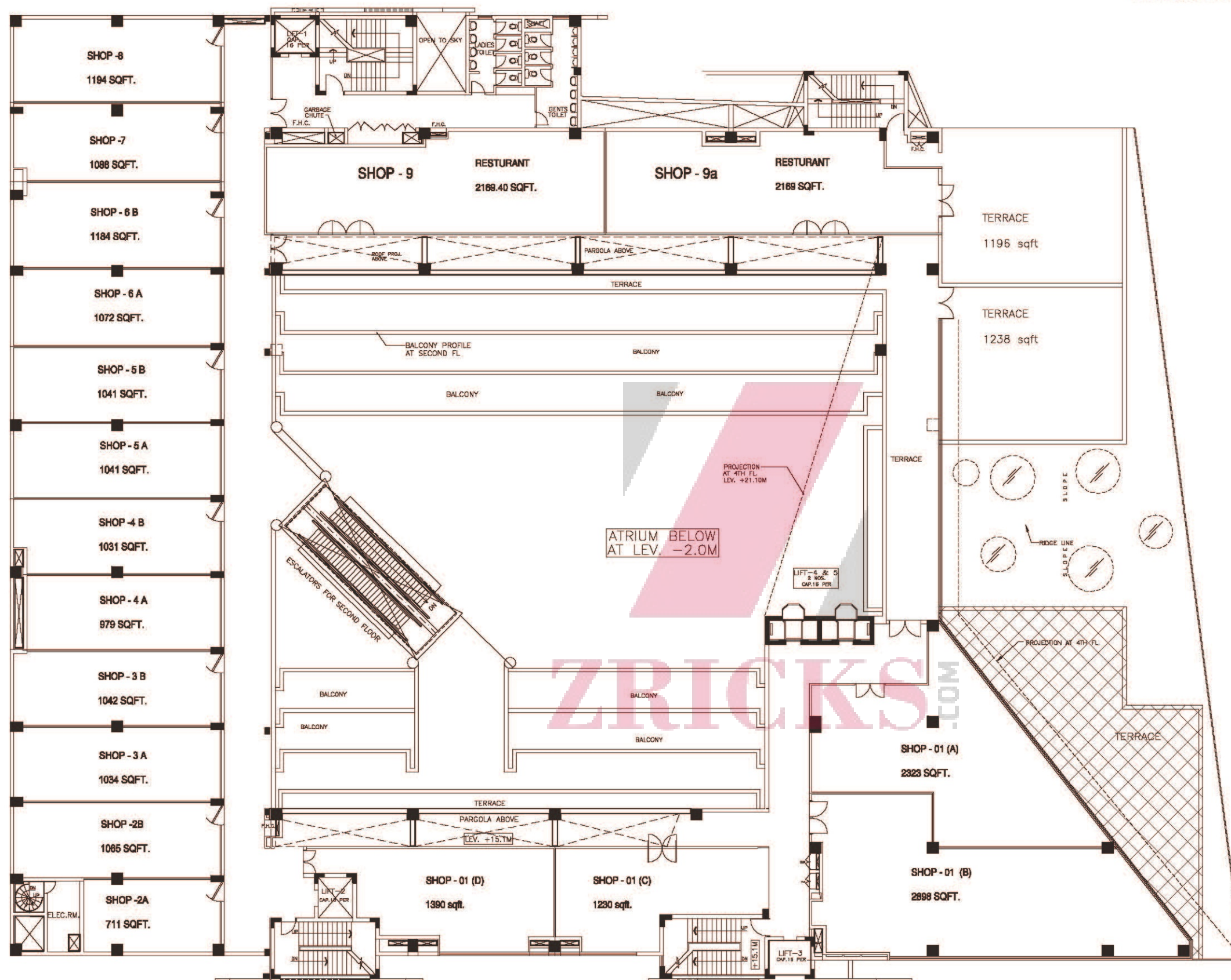

PROJECT

**REGENT ARCADE**  
COMMERCIAL COMPLEX AT MEHRAULI ROAD  
SECTOR - 28, TEHSIL & DISTT. GURGAON,

DRAWN BY :

Mr. DHARMENDER

EDITED BY :

CHECKED BY :

RECIEVED BY :

TITLE

**SALE PLAN**

DRAWING NO.

DATE 4TH APRIL,09 :

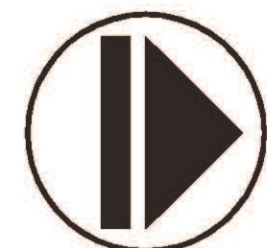



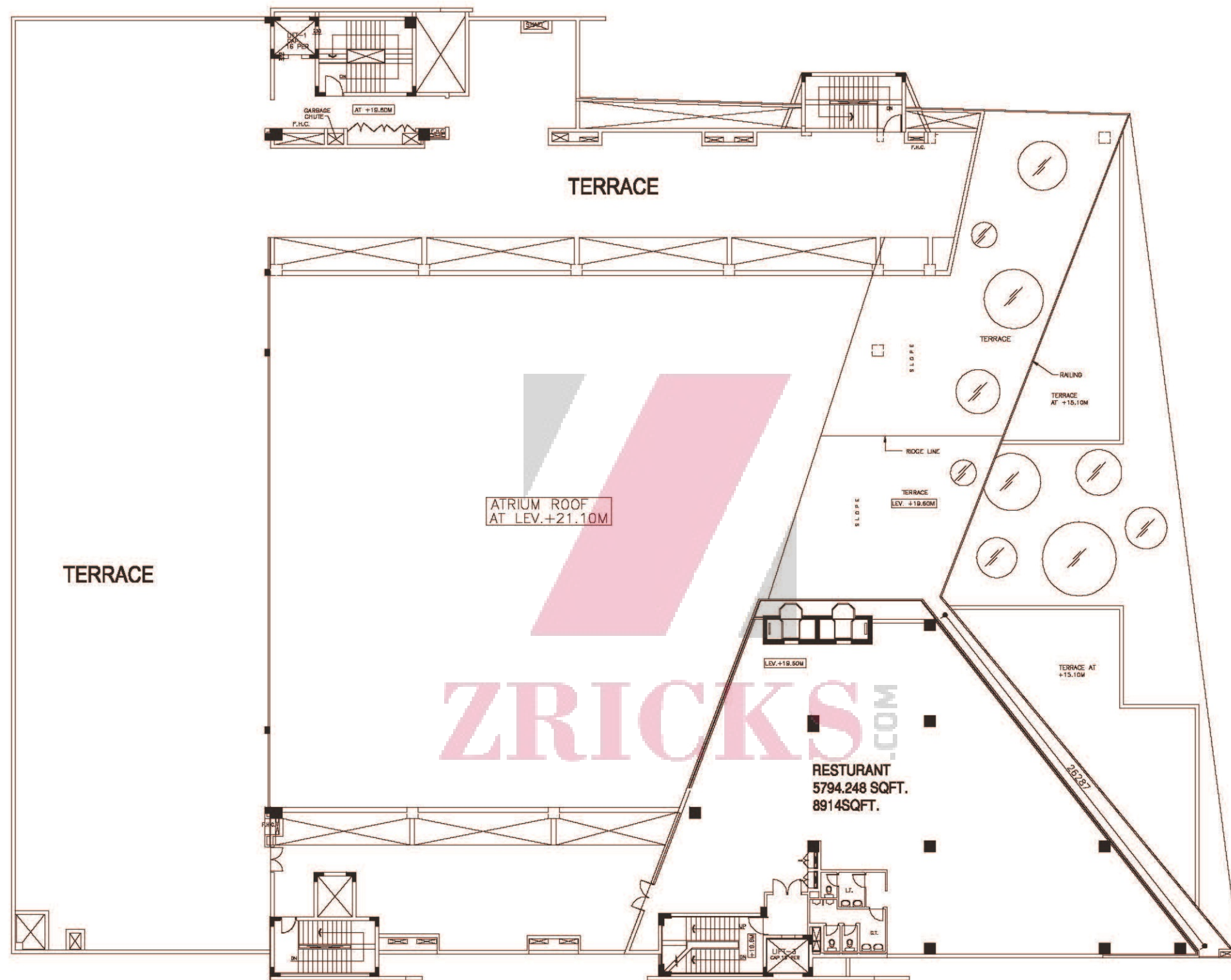

**FOURTH FLOOR PLAN**

PROJECT

**REGENT ARCADE**  
COMMERCIAL COMPLEX AT MEHRAULI ROAD  
SECTOR - 28, TEHSIL & DISTT. GURGAON,

DRAWN BY : Mr. DHARMENDER

EDITED BY :

CHECKED BY :

RECIEVED BY :

TITLE

**SALE PLAN**

DRAWING NO.

DATE 4TH APRIL,09 :

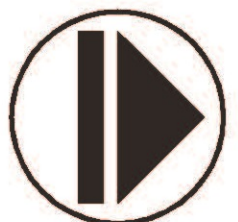



# LOCATION PLAN OF JMD PROJECTS

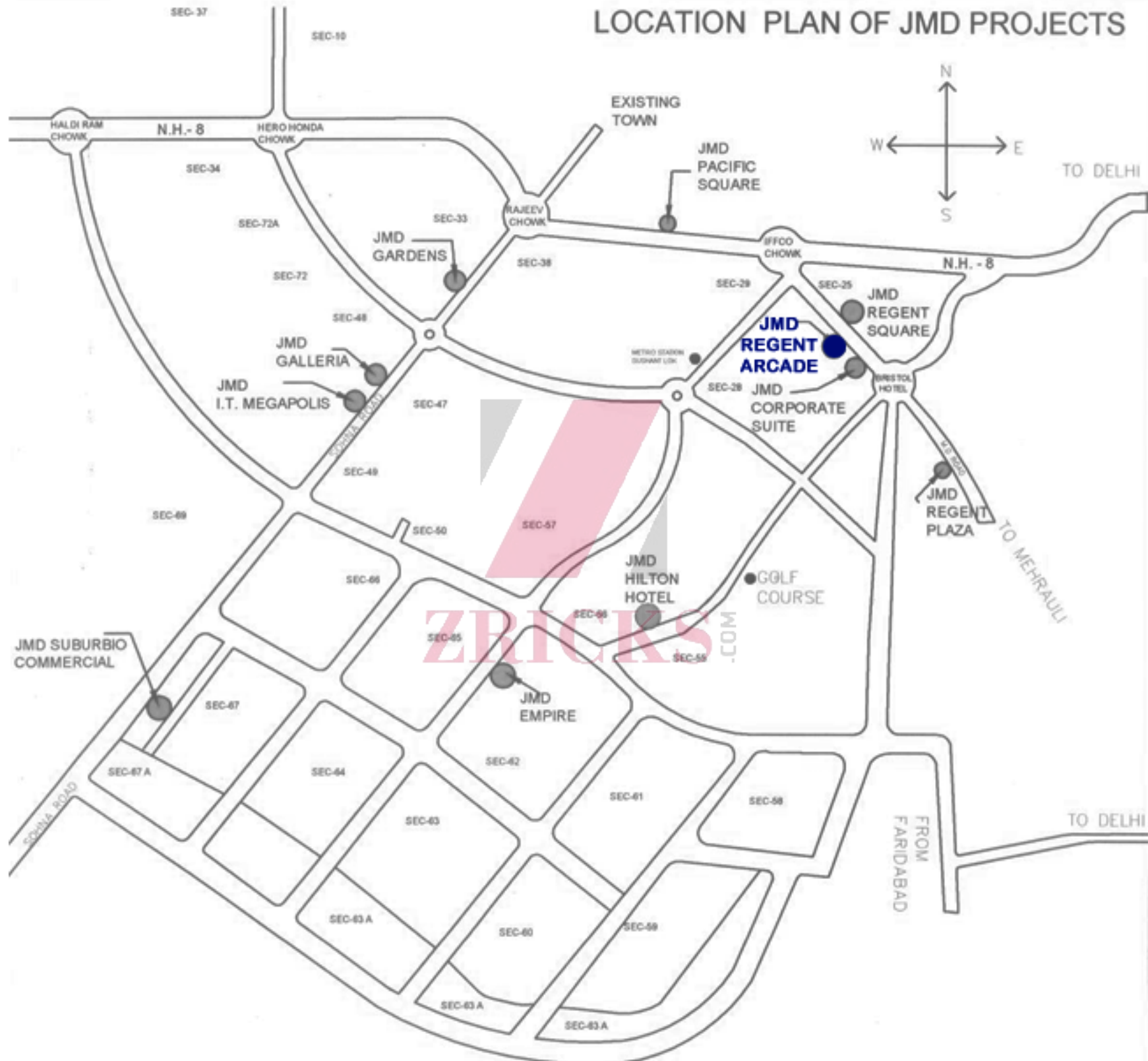



## SPECIFICATION

### BUILDING DATA

Site Area : 1.97 acres  
Total Permissible Area : 150179.08 sq.ft.  
No. of Storeys : Basement, Ground plus three

### STRUCTURE

Foundation : Complete R.C.C foundation  
Super Structure : R.C.C controlled concrete framed structure.

### ARCHITECTURE

- Colourful polished granite/ marble permanent cladding on external surfaces of showrooms.
- Polished granite/marble permanent type textured exterior finish on tower blocks.
- Decorative permanent type textured exterior finish on tower blocks.
- Anodised aluminium curtain wall with imported bronze grey tinted reflective toughened glass in floors.
- Aluminium windows/glazing with clear toughened glass for showrooms.
- Stainless steel handrail with transparent polycarbonate sheet stair railing in atrium.
- Performed aluminium lineal false ceiling in public areas.
- Mural, waterbodies, landscapes in atrium.

### AIR - CONDITIONING

- Centrally air conditioned showroom/other areas with year round environmental control .
- 100% electrical back-up for HVAC systems.
- Basements mechanically ventilated.

### ELECTRICAL

- 100% back-up with copper wiring distribution.

### FIRE PROTECTION

- Sophisticated fire protection system comprising hydrants, sprinklers, automatic fire detection and alarm system.

### ESCALATOR

- World class escalator with attractive glass balustrade.

### ELEVATORS

- Two numbers scenic elevators with glass panels and two passengers elevators for 10 persons carrying capacity each.