

supertech
Yours for Life

www.Zricks.com

Super tech Up Country

Imagine stepping out of your home and stepping on the cool sands of the beach, early in the morning. Or basking in the winter sun. Imagine going to sleep as gently splashing waves sing a lullaby. Imagine all this with premium sporting, clubbing and leisure facilities. Now no need to imagine it. Experience it all right here in Yamuna Expressway, 0 kms from Greater Noida. At Holiday Village. An address reserved for the select few. Part of a completely self-sustained development of Upcountry, a 100 acre landmark, that's nothing short of an independent country. Holiday Village at Upcountry. NCRs first beachside homes. You will have a complete European experience, with an Indian price tag being the only gentle reminder where you actually are.



Supertech Up Country- Location Map



Super tech Up Country - Mast er Plan



Super Tech Up Country - Site Plan



AREA STATEMENT	
TOTAL PLOT	437 (26.43 HA)
PLOTTED DEVELOPMENT	
1. 100 SQ.YD PLOTS (200' x 100' FT. @ 10000 SQ.YD)	280 PLOTS
2. 100 SQ.YD PLOTS (200' x 100' FT. @ 10000 SQ.YD)	124 PLOTS
3. 500 SQ.YD PLOTS (500' x 100' FT. @ 50000 SQ.YD)	132 PLOTS
VILLA DEVELOPMENT TOTAL	
1. 100 SQ.YD VILLA (TYPE - 01) (200' x 100' FT. @ 10000 SQ.YD)	150 PLOTS VILLA
2. 100 SQ.YD VILLA (TYPE - 02) (200' x 100' FT. @ 10000 SQ.YD)	100 PLOTS VILLA
3. 500 SQ.YD VILLA (TYPE - 03) (500' x 100' FT. @ 50000 SQ.YD)	27 PLOTS VILLA
4. 500 SQ.YD VILLA (TYPE - 04) (500' x 100' FT. @ 50000 SQ.YD)	18 PLOTS VILLA
ROADWAY DEVELOPMENT	
1. 200 SQ.YD ROAD	
2. 100 SQ.YD ROAD	
3. 500 SQ.YD ROAD	
4. 1000 SQ.YD ROAD + STAFF	
5. 1000 SQ.YD ROAD + LTD	



PROJECT :-
PROPOSED LAYOUT FOR "UP COUNTRY",
 For SUPERTech LTD.
 AT YAMUNA EXPRESS WAY.

COMMERCIAL
 20,337 SQ.MT

SCHOOL
 18860 SQ.MT

Safari Studios

Safari Studio apartments are a part of Supertech's pride possession, Upcountry, which is a tasteful assortment of modern day apartments, serene villas and economically luxurious studio apartments. Out of these residential features Safari Studio apartments are the ones which go according to the original theme of this celebrated township. As this township is located just by the proposed Night Safari these studio apartments are aptly named Safari Studios. These studio apartments are rightly fitted with all modern day luxurious fittings and furnishings, making living at Safari Studios a dream come true. Premium quality architecture and design make this place an eye pleasing structure.



Highlights

- Overlooking the Night Safari site
- Fully furnished studio apartments
- Decorated according to Safari theme
- Named after the upcoming Night Safari
- Premium services and facilities nearby
- Internally connected through a network of roads



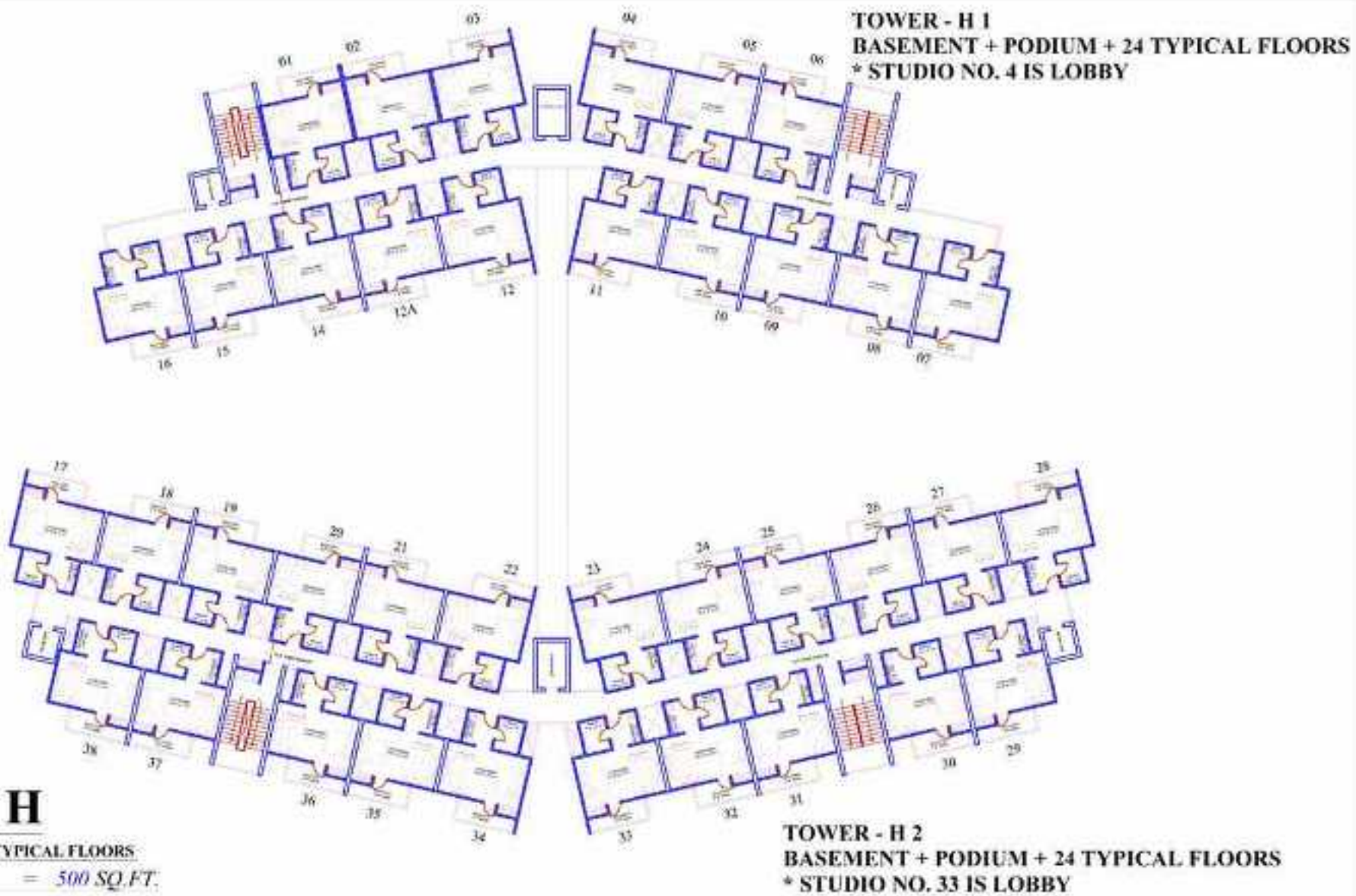

Specifications

Key Elements

- ? Aluminium encased windows and sliding doors with reflective glass
- ? Recessed lighting with full size and wooden cased mirrors
- ? Custom designed, solid wood built in wardrobe closets, with integrated luggage and shoe racks
- ? All internal areas finished with durable varnish
- ? Imported, over sized tiles throughout entire floor area (except balcony)
- ? Built-in kitchen, solid granite counter top on all counters, and with kitchen and cooking utensils
- ? Bright efficient bathroom with shower
- ? Provision for broadband internet and cable TV
- ? 2-sets of quality curtains with inner lining

Furniture & Fixtures

- ? One 3-4 seater sofa
- ? 2 living area ottoman
- ? 2 bed-side table with drawers (painted and lacquered)
- ? 1 oakwood coffee table
- ? 3 lamps
- ? 1 side table for living area (painted and lacquered)
- ? 1 desk (painted and lacquered) with lamps and chairs
- ? 1 custom TV stand with lazy susan (painted and lacquered)
- ? 1 queen size bed with headboard and recessed drawers for additional storage area
- ? Wide kitchen counter and ample cabinetsStainless steel kitchen sink
- ? 2 designer bar stools
- ? Matching porcelain toilet and vanity sinkset

Appliances & Equipment

- ? One 21" LCD colour TV
- ? 2 remote-controlled split-type air conditioners
- ? 1 refrigerator
- ? 1 electric water heater
- ? 1 dual burner LPG gas stove
- ? 1 microwave oven
- ? 1 rice cooker, plates, bowls, toaster and utensils

Other Equipment

- ? 1 fire extinguisher
- ? 1 personal electronic safe
- ? 1 door security deadlock
- ? 1 entry safety door chain
- ? 1 security peephole for entrance door

Payment Plan



Down Payment Plan 'A'

At the time of booking	10%
Within 30 days from booking	85%
On offer of possession letter	05%

Flexi Payment Plan 'B'

At the time of booking	10%
Within 60 days of booking	40%
On start of foundation work	09%
On start of basement roof slab	09%
On start of 3rd floor roof slab	09%
On start of 7th floor roof slab	09%
On start of 12th floor roof slab	09%
On offer of possession letter	05%

Construction Linked Payment Plan 'C'

At the time of booking	10%
Within 30 days from booking	10%
On start of foundation work	10%
On start of basement roof slab	08%
On start of 1st floor roof slab	08%
On start of 3rd floor roof slab	08%
On start of 6th floor roof slab	08%
On start of 9th floor roof slab	08%
On start of 12th floor roof slab	08%
On start of 16th floor roof slab	05%
On start of 20th floor roof slab	06%
On start of 23rd floor roof slab	06%
On offer of possession letter	05%

Terms and conditions

- 1 Cheques/Bank Draft to be issued in favour of SUPERTECH LIMITED Payable at New Delhi. Out station cheques shall not be accepted.
- 2 Price List as on date of Booking shall be applicable
- 3 Registration, Stamp Duty and Misl. charges shall be payable at the time of offer of possession.
- 4 Timely payments of the installments are the essence of Booking
- 5 PLCs and Other Charges shall be charged along with installments.
- 6 Service Tax , VAT & Other Govt. Levies are extra as applicable.
- 7 This Price List supersedes all previous Price Lists
- 8 Maintenance Charges, Meter connection Charges are extra and shall be collected before Possession.
- 9 Super area includes the covered area, plus the proportionate area under common corridor, passage, staircase, munties, projections, water tanks, lift wells etc.
- 10 The terms and conditions of sale stated herein are indicative and are subject to detailed terms and conditions in the Agreement to Sell/Flay Buyer Agreement and subject to change at sole discretion of the company.
- 11 All buildings plans, layouts, specifications are subject to change and modifications as decided by the company, architect or any competent authority.