

AJNARA  
**Daffodil**  
**PREMIER**  
GREEN FACING APARTMENTS

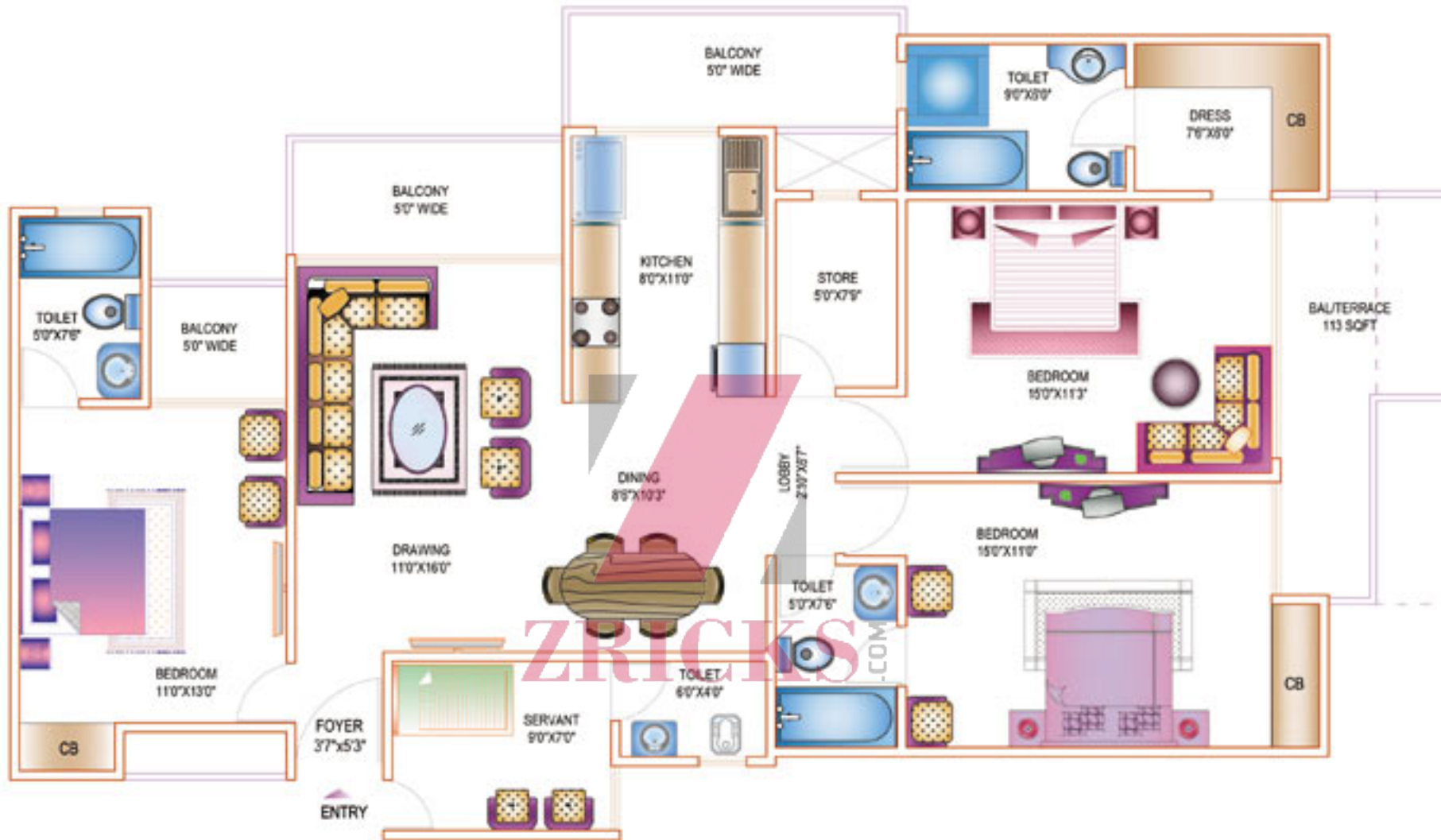



UNIT TYPE-3 BED-4 TOI+SER+DRESS+STORE

**Super area = 2095 sq.ft.**

TOWER - K (Flat Nos 1, 2, 5, 6)



3 BED + 3 TOILET + FOYER + POWDER + TERRACE + BALCONY

Super area = 1895 sq.ft.



# SITE LAYOUT PLAN

PARK



24 mtr wide road



- Layout Plan**
- 2 Bed + 2 Toilet (973 sq-ft)
  - 2 Bed + 2 Toilet + Store (1000 sq-ft)
  - 2 Bed + 2 Toilet + Study (1115 sq-ft)
  - 2 Bed + 2 Toilet + Study + Dress (1248 sq-ft)
  - 2 Bed + 2 Toilet + Study (1277 sq-ft)
  - 3 Bed + 2 Toilet (1435 sq-ft)
  - 3 Bed + 3 Toilet + Study (1576 sq-ft)
  - 3 Bed + 4 Toilet + Servant + Dress + Foyer (1725 sq-ft)
  - Studio
  - Commercial