

PRESENTING  
GR. NOIDA WEST'S  
FIRST  
HIGH-STREET  
MALL

**PREMERIA**  
GREATER NOIDA WEST



**THAT CATERS TO  
3.5 LAKH SHOPPING  
HUNGRY HOMES.**

**TAKES YOUR BUSINESS  
TO 1 MILLION PEOPLE.**

**IS CONNECTED TO  
5 EXPRESSWAYS.**

**IS LOCATED IN MIDST OF  
NCR'S BIGGEST OFFICE HUB.**

**GIVES YOU HIGH RETURNS  
FROM DAY ONE.**

Introducing Imperia Premeria, a shopping extravaganza that puts your investment right in the middle of a booming growth centre that is only 15 minutes from Sector 18 at Noida. Harness the power of a location that is zoned to be amongst India's biggest office and residential areas. Located at the heart of Greater Noida West, Premeria is a one-of-its-kind shopping destination that caters to a population of 1 million fashionable people and houses world-class brands. It connects your business to 5 different expressways to offer your customers a lifestyle beyond the ordinary. Be the first to grab the biggest investment opportunity in the region.

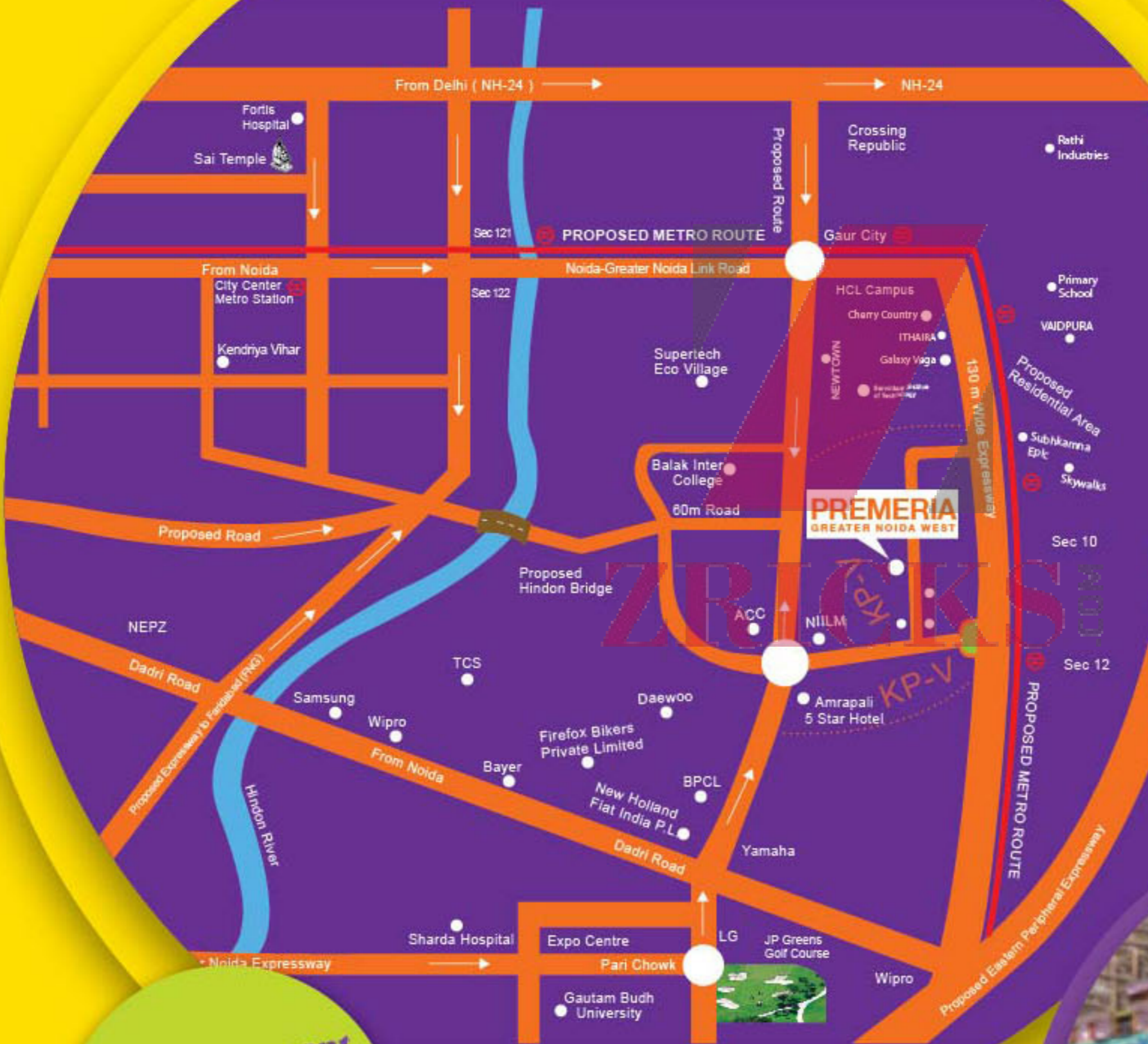

Min. Investment  
**₹9.54**  
Lakhs\*

- 9 minutes drive from the Noida City Centre
- Well connected to proposed Metro station
- 30 minutes from South Delhi
- 40 Kms from proposed airport at Taj Expressway
- Close proximity to Noida, Ghaziabad and Faridabad
- Close to F1 Racing Track & Night Safari
- Located along 150 feet wide road



ROMAN STYLE  
CENTRALLY AIR-CONDITIONED  
ATRIUM



**MULTIPLEX**  
3 Screens with 136,  
191 & 191 persons  
seating capacity



**MULTI-CUISINE  
RESTAURANT**  
Indoor and  
Outdoor seating



**ON-GROUND AND  
BASEMENT PARKING**



**RETAIL**  
200 Premium  
Outlets



**VIDEO  
SURVEILLANCE**

- External access points
- Car Park areas • Lobbies
- Passenger lift cab



**WIDE  
PEDESTRIAN  
WALKWAYS**



## RETAIL IN A NEW DIMENSION

Greater Noida, North India's newest educational and commercial nerve center, is readying itself to welcome its most premier shopping and lifestyle destination right in its centrum. Imperia presents Premeria, a new age commercial enclave that leaves no stone unturned when it comes to making your most covetous fantasies spring to life. Featuring best-in-class Retail spaces, Food court, Adventure sports and a state-of-the-art Multiplex set amidst a treasure of sumptuous embellishments, Premeria is the perfect embodiment of all the virtues that define a gold-class lifestyle. Revel in the luxury of a new age destination offering everything that the mind can imagine.





ZBRICKS.COM

## HIGHLIGHTS

- Ground +2 Floor Units with Elevators and Escalators
- 200 Premium Retail Outlets
- 3 Screens Multiplex
- Multi-cuisine Restaurant and Food Court
- Bowling Alley, Adventure Sports like Water Biking, Rock Climbing & Skating Rink
- Café • ATM • Kids' Play Area
- Roman Style Centrally Air-conditioned Atrium
- Wide Pedestrian Walkways
- Independent access to each block
- 6 meter wide roads for zero clutter traffic
- Dedicated signage areas for all units
- Interactive Fountains • Amphitheatre
- Reflection Pool • Lagoon court
- Lotus Court • Palm Avenue
- On-ground and Basement Parking
- 100% back-up for Lighting power and AC
- Video Surveillance
- Low Maintenance Retail Space



# GROUND FLOOR PLAN

- SHOPS 200-300 SQ. FT. SUPER
- SHOPS 300-400 SQ. FT. SUPER
- SHOPS 400-500 SQ. FT. SUPER
- SHOPS >500 SQ. FT. SUPER

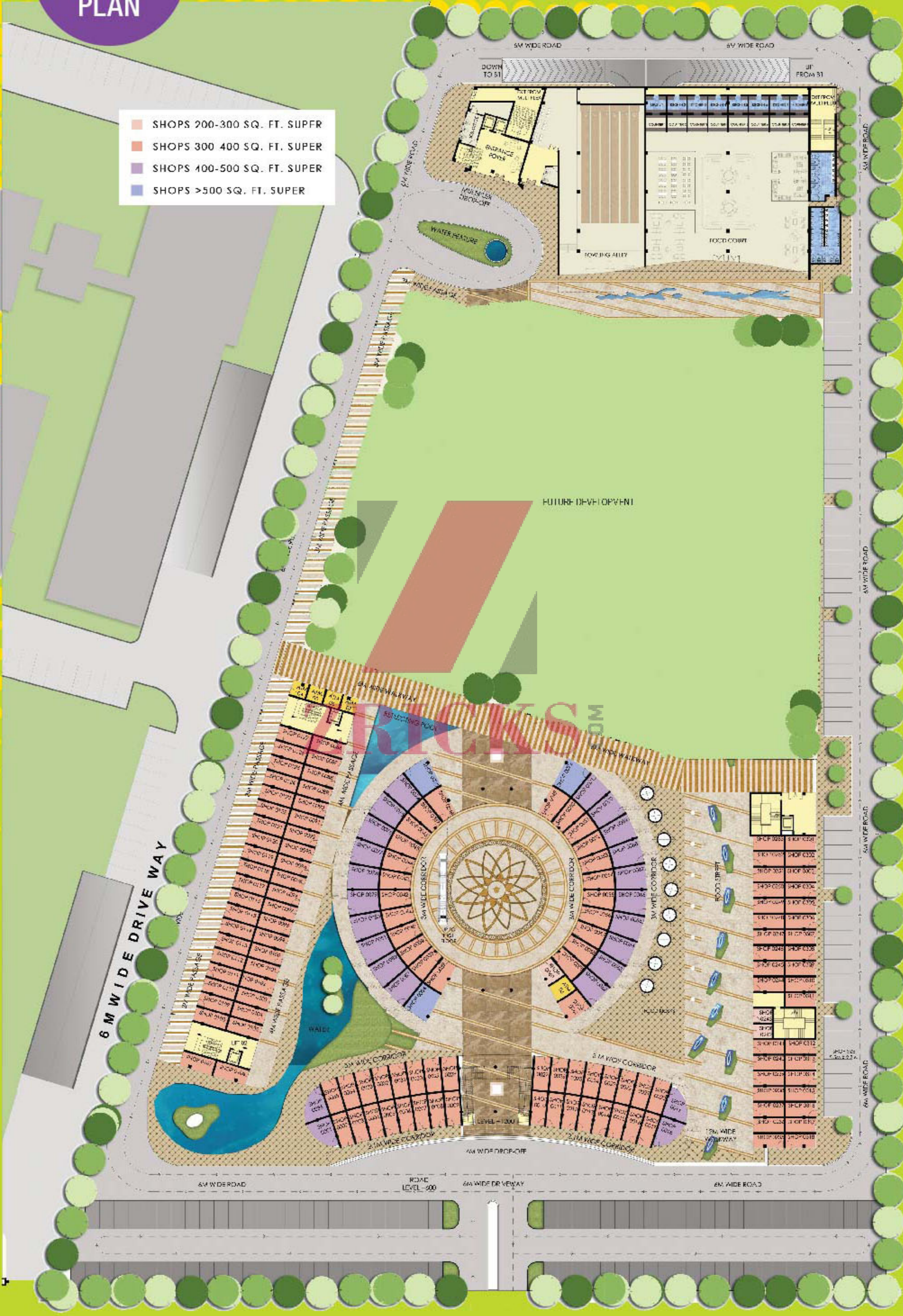

# FIRST FLOOR PLAN

- SHOPS 150-200 SQ. FT. SUPER
- SHOPS 200-300 SQ. FT. SUPER
- SHOPS 300-400 SQ. FT. SUPER
- SHOPS 700-750 SQ. FT. SUPER

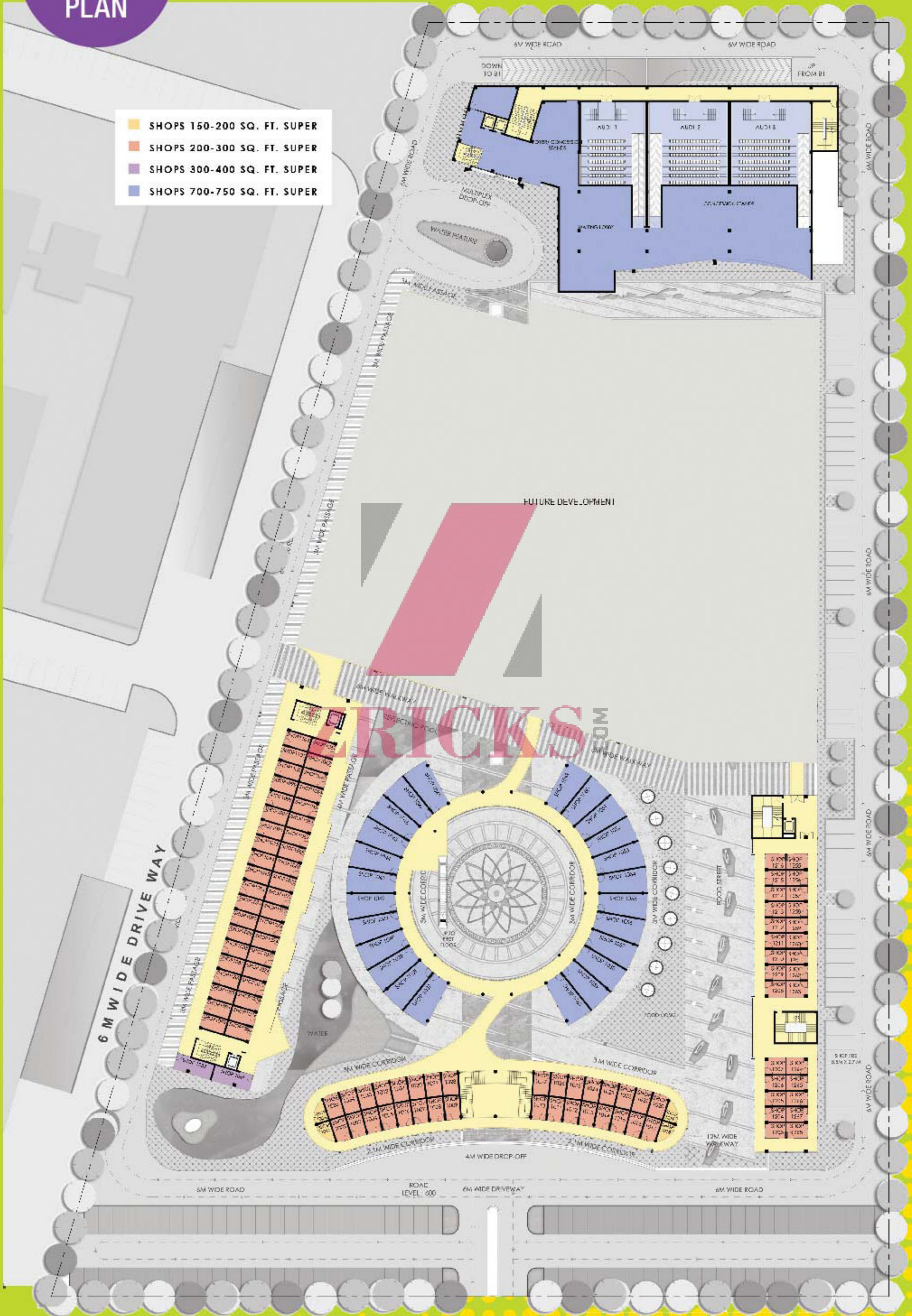

TRICKS.COM



# SECOND FLOOR PLAN

- SHOPS 200-300 SQ. FT. SUPER
- SHOPS >300 SQ. FT. SUPER

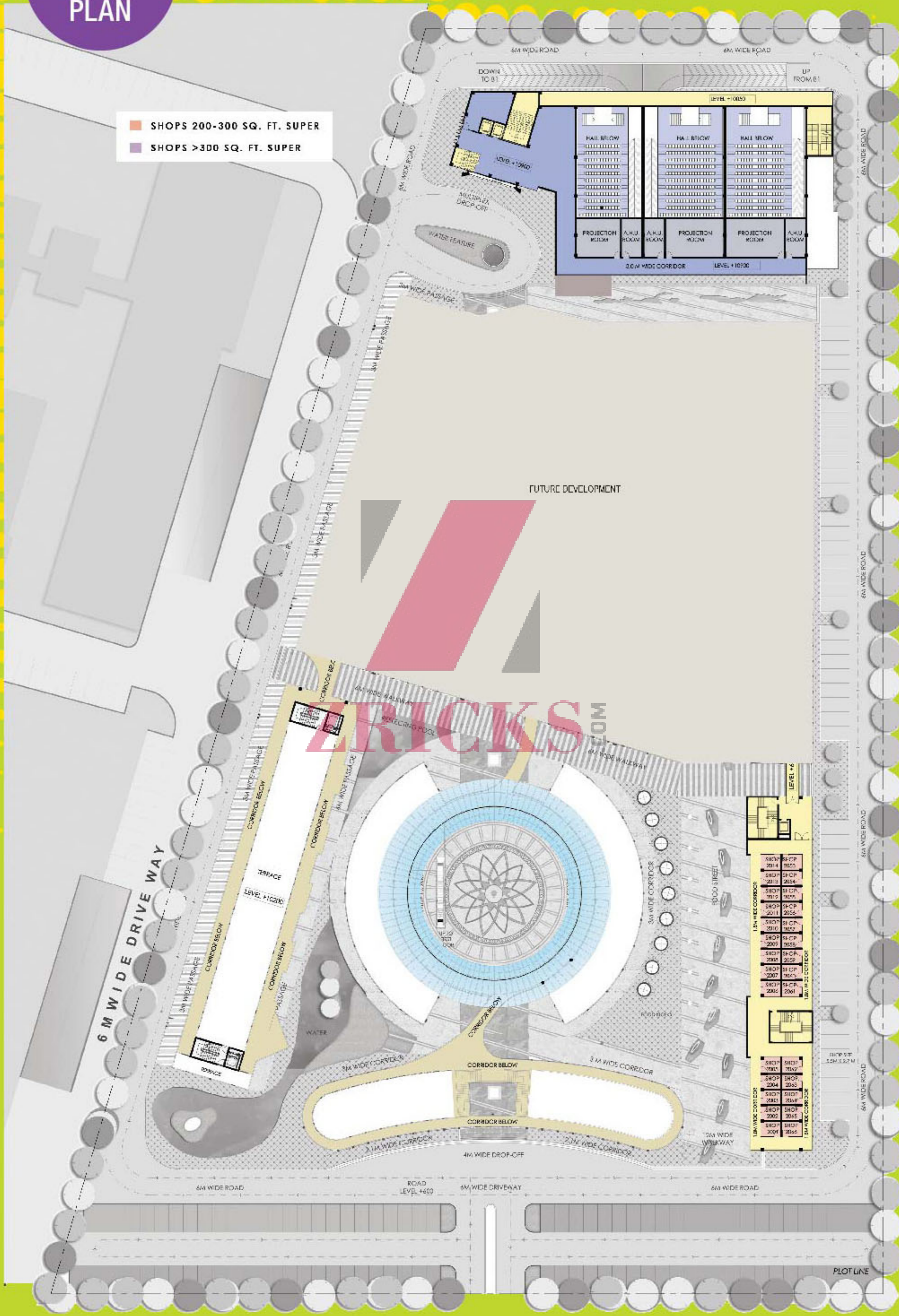

# SITE MAP





**Imperia Structures Ltd.**

Corp. Office: A-25, Mohan Co-operative Industrial Estate, New Delhi - 110044

T: (+91) 11 4646 9999 | W: [www.imperiastructures.com](http://www.imperiastructures.com) | E-mail: [response@imperiastructures.com](mailto:response@imperiastructures.com)

**Branch Office:** CDR Complex, 2nd floor, Sector-15, Noida-201301

**Site Office:** Plot No. 44-45, Knowledge Park – V, Greater Noida West

**Regional Offices :**

**Patna:** Kanak Braj Complex, 2nd Floor, Boring Road, Patna

**Lucknow:** Shalimar Square, 1st Floor, Office No. A -103, 126/31, B.N. Road, Lal Bagh, Lucknow

**Kanpur:** 203, 2nd Floor, Gopala Chamber, Opp. PPN Market, The Mall Road, Kanpur

**Ranchi:** 5th Floor, Sheetal Samundra Complex, Circular Road, Lalpur, Ranchi

**Allahabad:** 2nd Floor, Shiv Mahima Complex, MG Road, Civil Lines, Allahabad (Opp. Big Bazaar)

**Srinagar:** Exchange Road, Near BSNL, Lal Chowk, Srinagar