



ZRICKS.COM



ZRICKS.COM



GROUND FLOOR PLAN



FIRST FLOOR PLAN



TERRACE FLOOR PLAN

Palm Villa
 Luxurious EXPANDABLE Villas

LAYOUT FOR VILLA AT PALM GREENS, SECTOR-MU, GREATER NOIDA. (218.55 SQ.YDS.) SALEABLE AREA: 2110 SQ.FT.

Specification

Structure	RCC frame structure
External Finish	Long- lasting paint / gritwash or equivalent
Walls Finish	Internal wall plastered and painted with pleasing shades of oil-bound distemper
Toilet Walls	Glazed ceramic tiles upto 7' height
Toilet Flooring	Glazed ceramic tiles
Fittings	Wash basin, EWC, towel rail, hot & cold water system
Kitchen	Pre - polished granite platform with stainless steel sink. dado up to 2'-0" height above platform in ceramic glazed tiles
Windows	Powder-coated glazed aluminum windows / wooden windows / UPVC
Electrical	Copper concealed wiring, provision for lights, plug points in each bedroom, drawing / dining lounge
Flooring	Vitrified tiles except combination of udaipur green & marble in staircase
Doors	Hardwood framed & both side teak finish flush doors / skin moulded shutters

LAYOUT PLAN



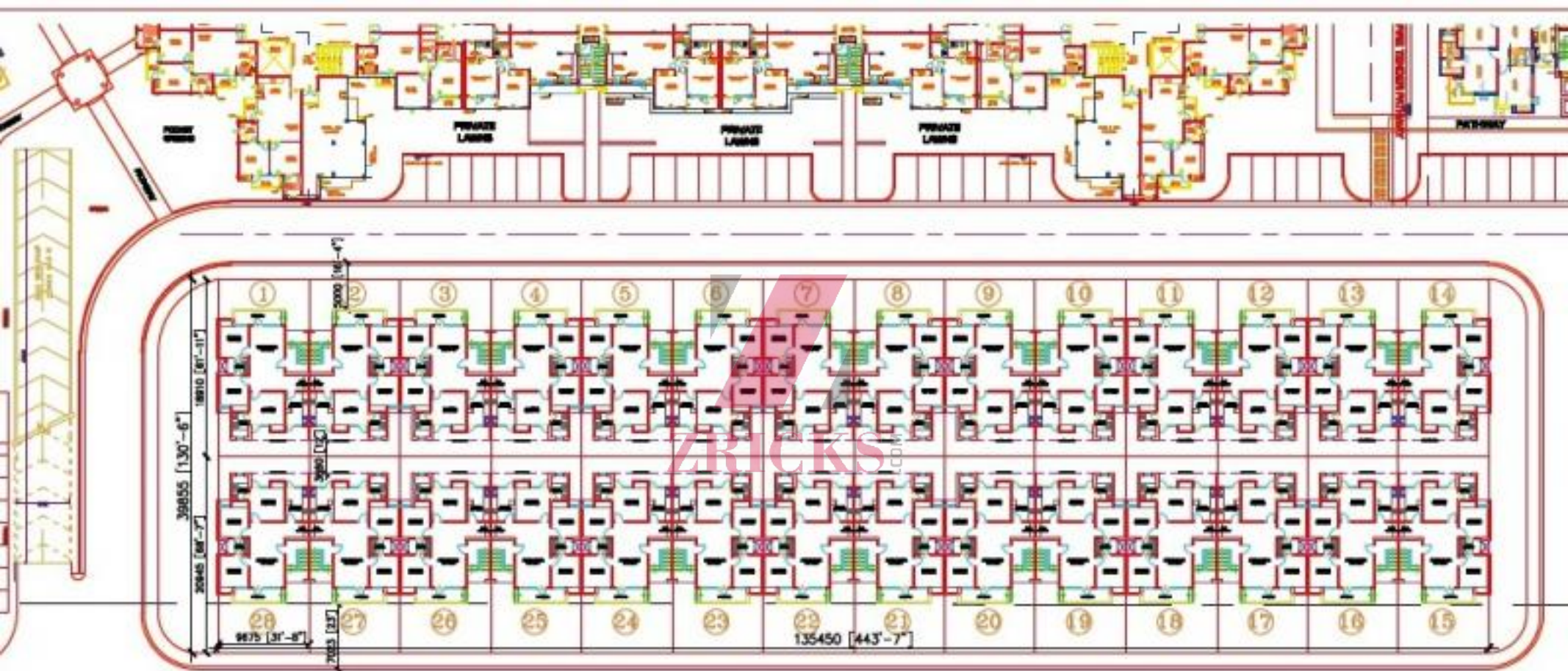

LOCATION MAP

