

# IMAGINATION EXTENDED

GC  
CENTRUM  
INDIRAPURAM

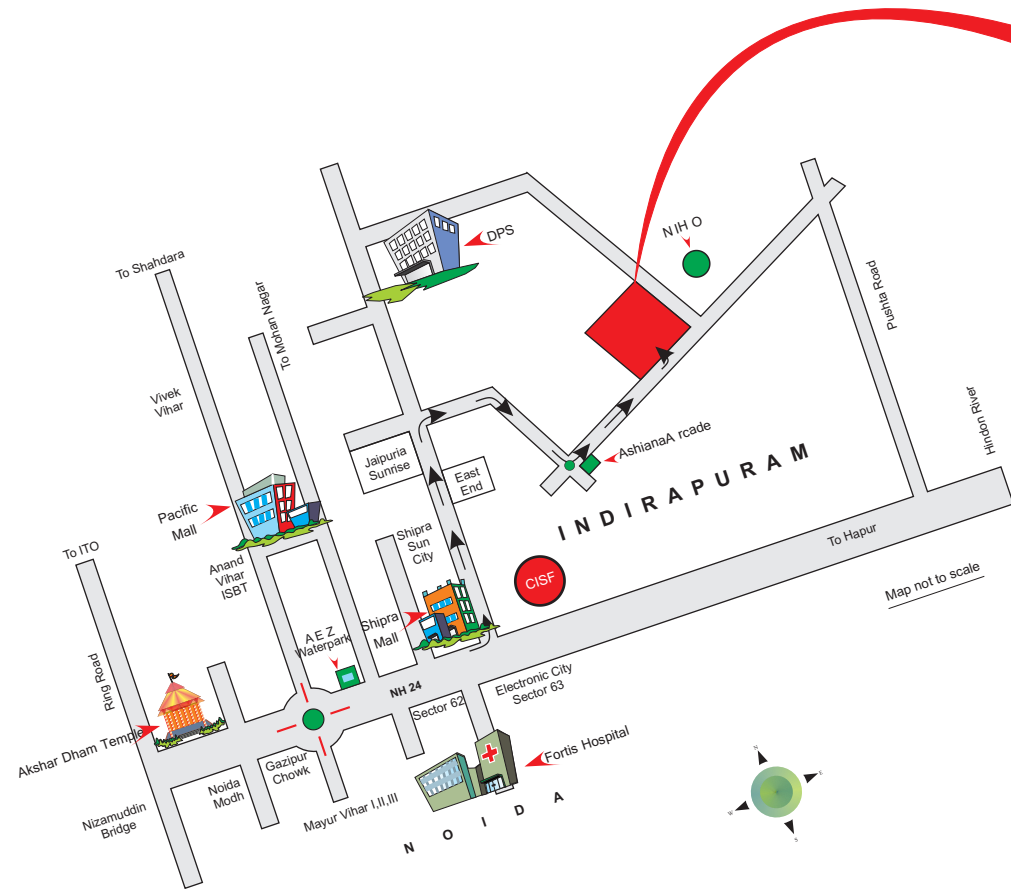

  
**Gulshan  
Homz**  
a unit of GC group

**Cop. Office :**  
4, Dayanand Vihar,  
Delhi 110092  
Tel : 91-11-22375246  
Website : [www.gcgroup.co.in](http://www.gcgroup.co.in)  
Email : [sales@gcgroup.co.in](mailto:sales@gcgroup.co.in)

**Site Office :**  
Plot No. 7,  
Ahinsa Khand-II, Indirapuram,  
Ghazidada, U.P.  
Tel. : +95120 3223735, 3223739

Call : 9873322284 / 85 / 86

ZRICKS.COM



GC  
**CENTRUM**  
INDIRAPURAM

## Imagination extended



...to a new standards in living

GC CENTRUM is located at Indirapuram, the township that truly reflects the changing skylines of Indian suburbia. The specifications and rich features of the project truly radiate with a premium aura that elevates your home with a distinction of pride and prestige.

The ideal location of the project further adds an element of convenience to your life. Well-connected to railway station, City Centre and other important landmarks, your home is just a short drive from Anand Vihar ISBT and NH-24, the highway that connects the township to the heart of the city. This highway is soon to be converted into an international standard 8-lane express highway. The place will have a total new character. Mega malls, multiplexes and retail outlets of the area have already made it one of the most desired locations for living. With the best of facilities and amenities at hand, your home at GC CENTRUM is positively the owner's pride and relatives' envy.



GC  
CENTRUM

Imagination extended  
...to flat layout

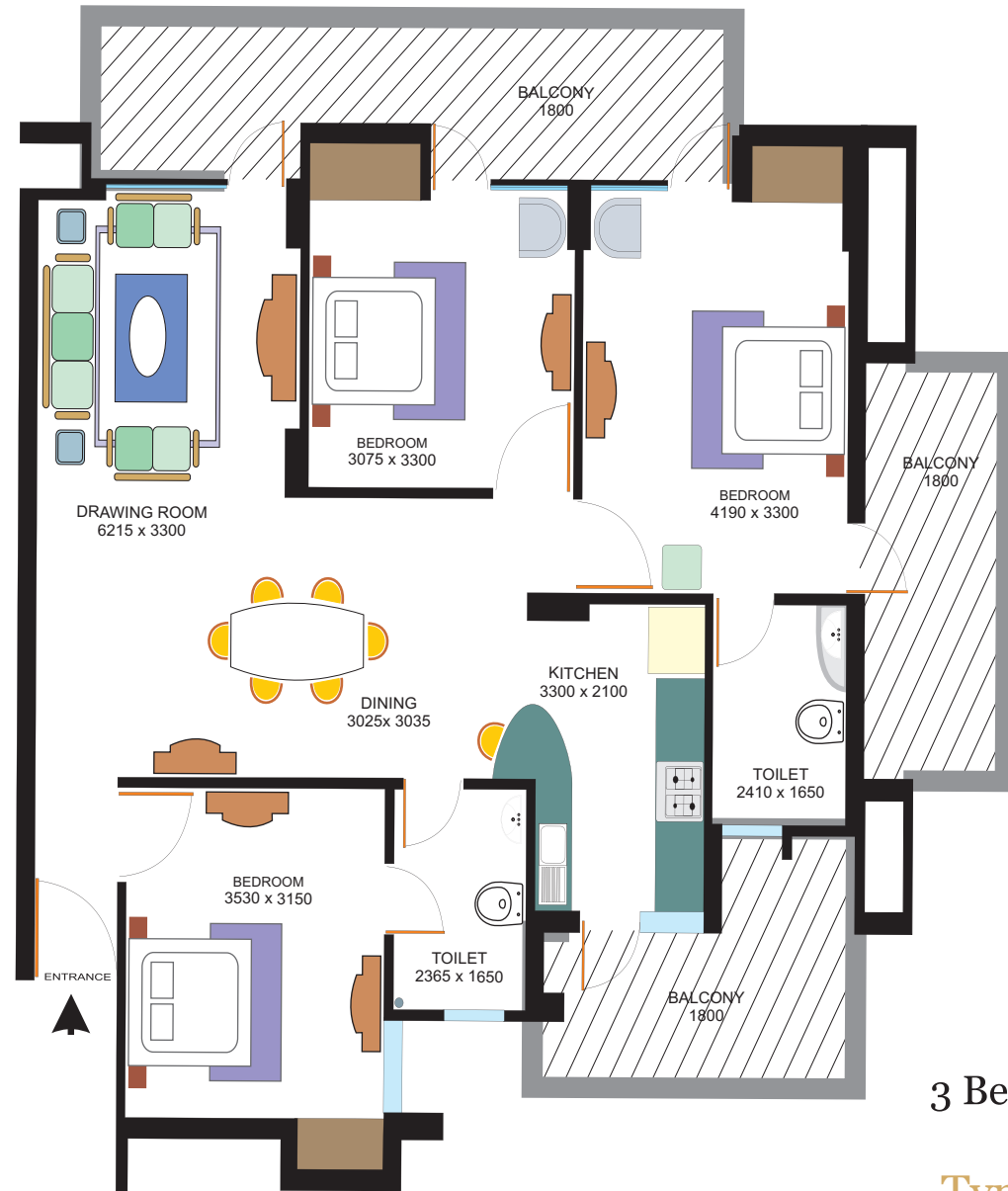

GC  
CENTRUM

3 Bedroom  
1680 sq.ft  
Type -B

Imagination Extended  
...to premium specifications



**AMENITIES :**

- Enough sunlight in all flats
- Intercom connection in each flat
- Multi level, 24 hr. Security, provision of CCTV through cable network
- Central park with planned landscaping all around
- Special kids corner
- Provision for natural gas pipeline in kitchen. Dedicated laundry and ironing setup
- Installation of fire fighting arrangements at all floors (No installation charges)
- Reserved parking in open and stilts
- Provision for rainwater harvesting
- Round the clock water supply
- A project to bring Ganga water in the vicinity is under active implementation by GDA
- Two elevators for 4 flats with 8 passengers capacity
- Firm prices at the time of booking no escalation
- Power back-up facility of 1kva for individual flat (No installation charges)
- 100% power back-up for essential services.

*Furniture, accessories and some fixtures shown in the brochure may not be part of the standard offering. The brochure does not form any basis of legal commitment. The company reserves the right to alter and change any of the given details/specifications without any notice.*



GC  
CENTRUM

**Flooring**

Vitrified Tiles in Drawing /Dining /Bedrooms and Kitchen. Laminated Wooden Flooring in Master Bedroom. Anti skid Ceramic Tiles in Toilets and Balcony.

**Door & Windows**

Decorative Skin Moulded Doors. External Doors & Windows made of UPVC.

**Wood Work**

Modular Kitchen & Cupboards.

**Kitchen**

Granite Top Working Platform. Double Bowl Stainless Steel Sink. Ceramic Glazed Tiles 2' above Working Platform.

**Toilet**

Anti skid Ceramic Floor Tiles. Ceramic Tiles up to door level on the wall.

**Inside Wall Finish**

Inside Walls with POP Punning and Plastic Paint, POP Cornice in Drawing/Dining, all Bedrooms and Toilets.

**External Facade**

Exterior in Superior Texture Finish.

**Electrical**

Copper Wiring in Concealed P.V.C. Conduits. Sufficient Light and Power Points. Provision for T.V., Telephone Points in Living Room and all Bedrooms.

**Super Structure**

Earthquake – Resistant RCC Frame Structure.