





24 M WIDE ROAD



9 M WIDE ROAD

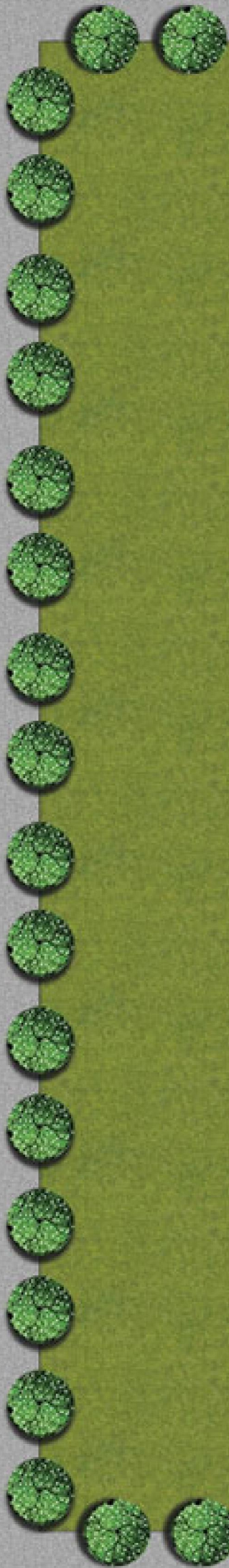

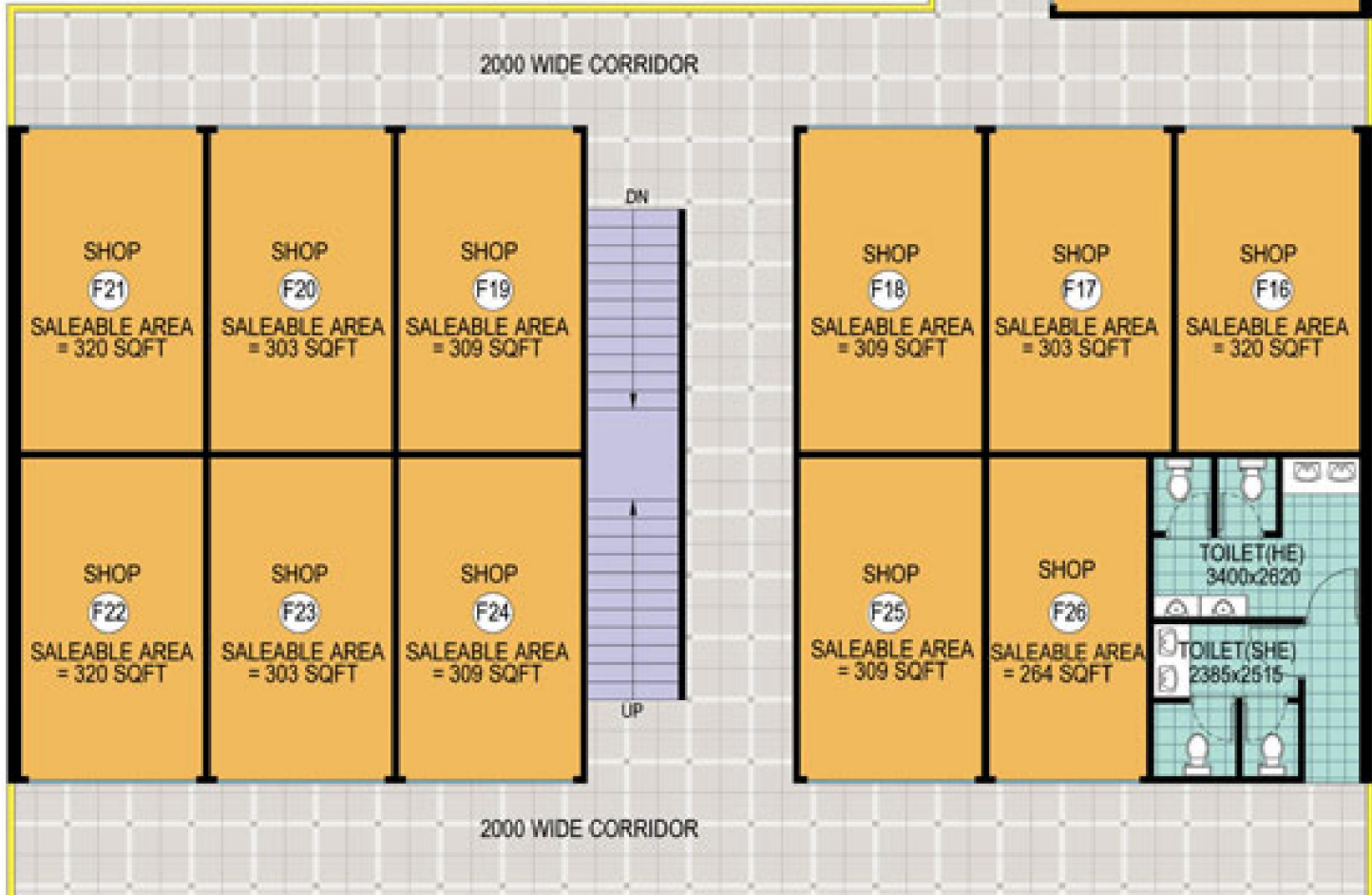
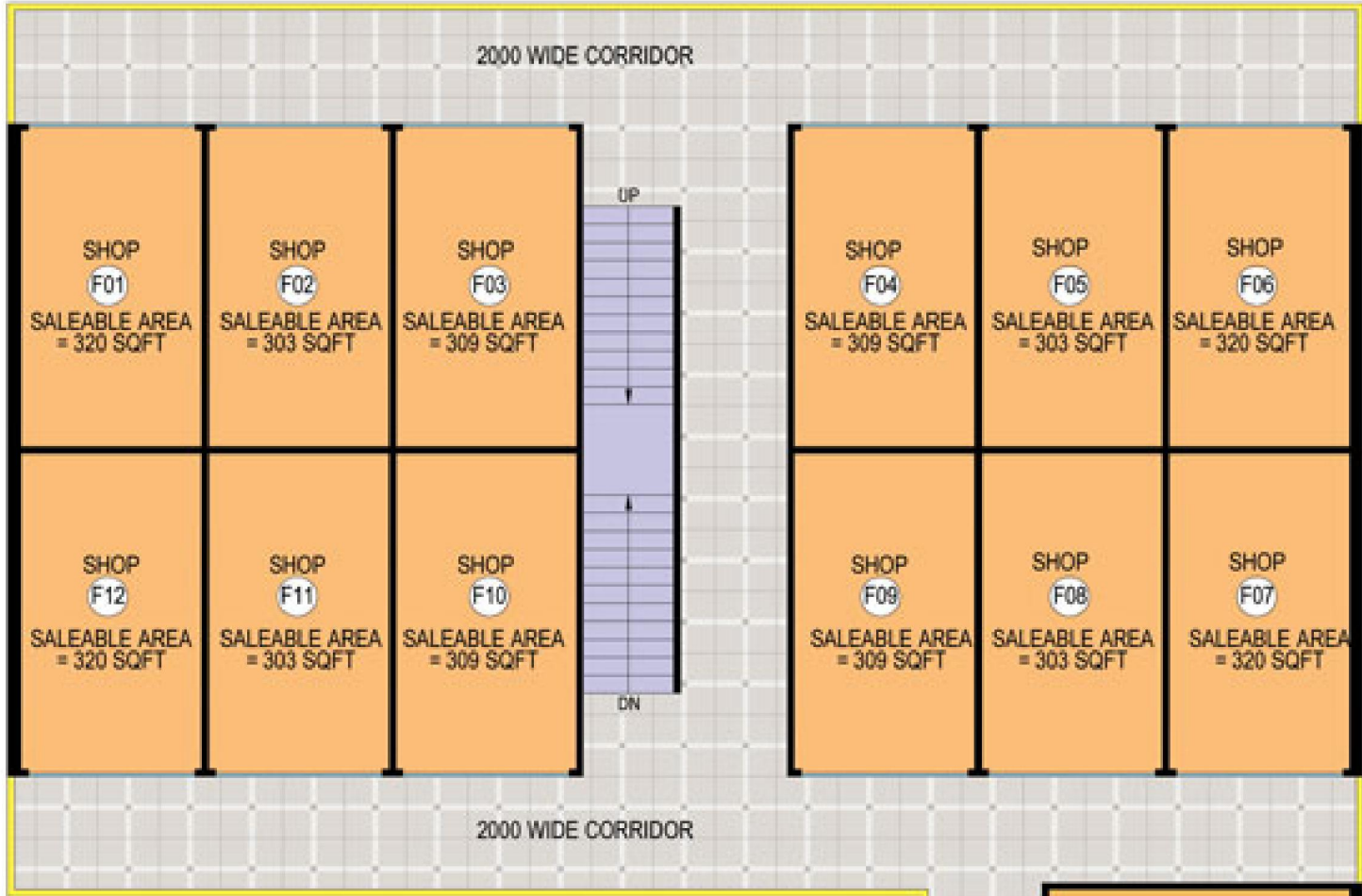



PARKING AREA

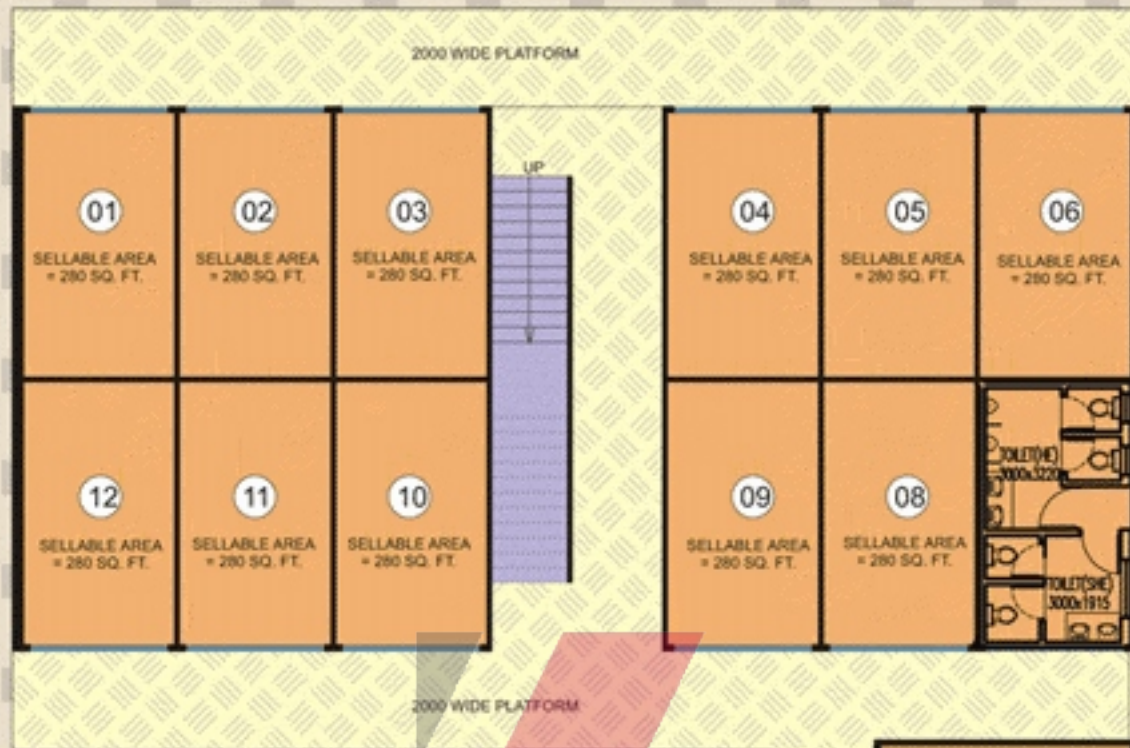

PARKING AREA

OPEN SPACE

ZRICKS

COM

PARKING AREA

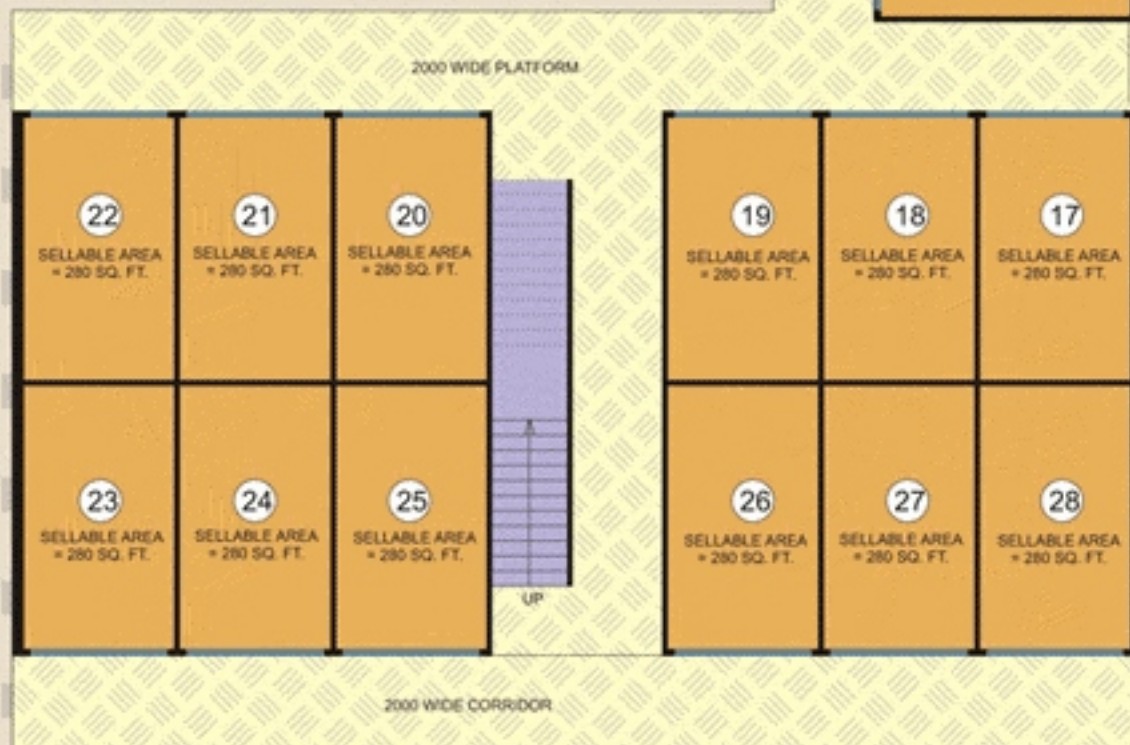

PARKING AREA

Floor	Booking Amount
Ground Floor	15% of BSP
First Floor	15% of BSP
Area	280 sq.ft.

Payment Plan

Plan A : Down Payment Plan (8% rebate on BSP or 11% assured return till possession)

At the time of booking	15% of BSP
With in 45 Days of Booking	80% of BSP
On offer of possession	5% of BSP + Additional charges + PLC + Stamp Duty + EDC & IDC + Registration charges + other charges (if any)

Plan B : Construction Linked Payment Plan

At the time of booking	20%
Within 60 days of Booking	15%
On start of excavation work	10% + 50% of PLC
On start of foundation work	10% + 50% of PLC
on Casting of Ground Floor roof	10% + 50% of EDC & IDC
On casting of First Floor roof	10% + 50% of EDC & IDC
On start of internal Plaster	10%
On start of Electrical works and external finish	10%
On offer of Possession	5%+Add. Charges+Stamp Duty+Registration Charges+ Other Charges (if any)

Additional Charges

EDC & IDC	Will be intimated as per norms
Interest free maintenance security	Will be intimated on Demand
Preferred Location	Charges (Rs./sq.ft.)
Corner	200 per sq.ft.

Note:

Prices are firm and escalation free from the respected dates of booking.

Prices indicate above are subject to revision at the discretion of the company.

Prices of ruling on the date of booking shall be applicable.

Above prices are exclusive of external development charges (EDC) and infrastructure development charges. In case, if any revision thereof or any other charges by any govt. agencies in future the same will be recovered / adjusted on pro rata -basis.

Other charges as indicated in buyer agreement shall be payable additionally.

Individual electric meter connection charges shall be extra.

Registration stamp duty and other charges as applicable would be payable by the allottees at the time of execution of sale/lease deed.

Any additional facility, if provide will be charged extra.

The above area are super built up area.

All building plan, layout specification extra are tentative.

All payment should be made by Cheque/Demand Draft drawn in favor of piyush Colonisers Ltd. Payable at Delhi/New Delhi/Faridabad.

The final allotment shall be entirely at the discretion of the company, which has the right to reject any application without any reason whatsoever.

Service Tax on BSP & all other charges shall be charged extra as per the Government norms.



