



ANGEL
JUPITER
INDIRAPURAM

2 & 3 Bedroom Apartments

WE HAVE A VISION FOR THE NEXT GENERATION LIVING



ZRICKS.COM





- GDA Approved Project • 2-3 Bedroom Apartments • Approx. 80% Open Area • Vaastu Friendly Layout
- Proposed Metro Station at walking distance • Large Balconies • Beautifully landscaped central park
- Gated complex with intercom and CCTV facility • In-house maintenance services for all common facilities
- Un-interrupted water supply • Power back-up for essential services • Ample parking space in basement

ZRICKS.COM

The Overview

Indirapuram, with its excellent infrastructure and amenities has emerged as a preferred choice for people seeking affordable living options in NCR. With excellent connectivity through NH-24, Indirapuram is considered an integral part of Delhi.

Up-to-date shopping and entertainment centres make the life more comprehensive, as every facility exists in close proximity. Apart from the pleasure options, other social amenities like hospitals, schools and colleges are also in immediate vicinity.

Angel Jupiter, coming up in Indirapuram, is going to be an answer to the needs of the cream of populace who are in pursuit of an admirable living option with the right blend of modernity, affordability and comfort.





ANGEL
JUPITER
INDIRAPURAM
2 & 3 Bedroom Apartments



The Amenities

The Club at Angel Jupiter is ready to buzz with activities. Limitless possibilities to stay fine and fit loom large.

Joggers Track, Spa, Pool, Gym, Jacuzzi, Sauna, Basketball - Badminton Court, Games Room Kids Area... have been designed for the healthy lifestyle of the urbane dwellers.

The boundless opportunities at the finger tips of the residents cater to all age groups - old, young & the not so young.

- An elite club house with swimming pool
- Landscaped gardens with water bodies
- Well laid jogging track
- Children park with swings and rides
- Steam, Sauna and Jacuzzi
- Kids splash pool
- Meditation/Yoga hall
- Well equipped gymnasium
- Badminton/Basketball court
- Table tennis/Snooker room





- Located next to DPS just off NH-24
- Ultra modern shopping and entertainment hubs in close proximity
- Well connected from ISBT Anand Vihar and Rly. Station Anand Vihar
- Metro connectivity proposed

ZRICKS

The Location

Located right opposite DPS School Indirapuram, Angel Jupiter offers fully developed infrastructure with best of amenities in immediate vicinity.

The location is merely :

- 10 min. drive from Akshardham Temple
- 7 min. from Fortis Hospital, Sec. 62, Noida
- 15 min. from Atta Market, Noida
- 10 min. from Anand Vihar ISBT, Delhi
- 2 min. from Vaishali Metro Station





3 Bedroom

+3 Toilets+STORE

Sellable Area : 1575 Sq.ft.

(Type A)



DRAWING/DINING ROOM

FLOORS : Vitrified Tiles

EXTERNAL DOORS & WINDOWS :
Powder coated aluminium glazings or equivalent

FIXTURE & FITTING : Designer Light fitting / Fan

WALL & CEILING : Oil bound distemper, one concept wall, POP Punning & Ceiling White

INTERNAL DOOR : Hard wood frame with designer panel door

MASTER BEDROOM

FLOORS : Wooden Laminated

EXTERNAL DOORS & WINDOWS :
Powder coated aluminium glazings or equivalent

FIXTURE & FITTING : Designer Light fitting / Fan & wardrobe

WALL & CEILING : Oil bound distemper, one concept wall, POP Punning & Ceiling White

INTERNAL DOOR : Hard wood frame with polished skin moulded door shutter

BEDROOM

FLOORS : Vitrified Tiles

EXTERNAL DOORS & WINDOWS :
Powder coated aluminium glazings or equivalent

FIXTURE & FITTING : Designer Light fitting / Fan

WALL & CEILING : Oil bound distemper, one concept wall, POP Punning & Ceiling White

INTERNAL DOOR : Hard wood frame with polished skin moulded door shutter

MASTER BEDROOM TOILET

FLOORS : Vitrified/ Ceramic Tiles

EXTERNAL DOORS & WINDOWS :
Powder coated aluminium glazings or equivalent

FIXTURE & FITTING : Standard white chinaware, Granite counter, CP Fittings

WALL & CEILING : Ceramic Tiles upto 7'-0"

INTERNAL DOOR : Hard wood frame with polished skin moulded door shutter



3 Bedroom

+3 Toilets+Servant

Sellable Area : 1850 Sq.ft.

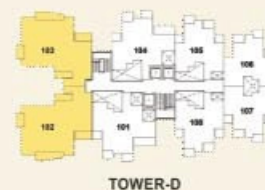



2 Bedroom

+STUDY

Sellable Area : 1285 Sq.ft.



The Specifications

BEDROOM TOILET

FLOORS : Ceramic Tiles

EXTERNAL DOORS & WINDOWS : Powder coated aluminium glazings or equivalent

FIXTURE & FITTING : Standard white chinaware & CP Fittings

WALL & CEILING : Ceramic Tiles upto 7'-0"

INTERNAL DOOR : Hard wood frame with polished skin moulded door shutter

KITCHEN

FLOORS : Vitrified Tiles

EXTERNAL DOORS & WINDOWS : Powder coated aluminium glazings or equivalent

FIXTURE & FITTING : Granite Top & Stainless Steel Sink, R.O. system

WALL & CEILING : Ceramic Tiles upto 2'-0" above counter

INTERNAL DOOR : Open Kitchen

BALCONIES

FLOORS : Ceramic Tiles

EXTERNAL DOORS & WINDOWS : Powder coated aluminium glazings or equivalent

Note : Colour & design of tiles can be changed without prior notice. All natural products such as tiles, marble stones and wood etc. may have slight variation in texture colour and behaviour and may have surface variations.

ZRICKS.COM



2 Bedroom

+2 TOILETS

Sellable Area : 1150 Sq.ft.

(Type A)



Site Plan



TOWER - A

- 2BHK+2T (TYPE-A)
- 3BHK+2T+STORE (TYPE-C)
- 3BHK+2T+STORE (TYPE-B)
- 3BHK+2T+STORE (TYPE-A)

TOWER - B

- 2BHK+2T (TYPE-B)
- 2BHK+2T+STUDY (TYPE-A)

TOWER - C

- 3BHK+2T+STORE (TYPE-A)
- 2BHK+2T (TYPE-B)
- 2BHK+2T+STUDY (TYPE-B)

TOWER - D

- 3BHK+2T+SERVANT (TYPE-A)
- 2BHK+2T+STUDY (TYPE-C)
- 2BHK+2T (TYPE-C)
- 2BHK+2T (TYPE-B)

TOWER - E

- 3BHK+3T+STUDY - 1785 SQ.FT.
- 2BHK+2T+STUDY - 1275 SQ.FT.
- 2BHK+2T - 1185 SQ.FT.

TOWER - F

- 3BHK+3T - 1615 SQ.FT.
- 2BHK+2T+STUDY - 1275 SQ.FT.
- 2BHK+2T - 1185 SQ.FT.



just

5 MINUTES
away

- FROM DELHI
- FROM GAZIABAD
- FROM NOIDA

- Located next to DPS just off NH-24
- Ultra modern shopping and entertainment hubs in close proximity
- Well connected from ISBT Anand Vihar and Rly. Station Anand Vihar
- Metro connectivity proposed

The Group

Angel Group is today one of the leading infrastructure developers, well recognised for its commitment towards quality & timely completion of its projects. The successful completion of Angel Prime Mall-Panipat, Angel Mega Mall-Kaushambi, Rishabh Platinum-Indirapuram, Angel Mercury-Indirapuram and Angel Business Square-Sahibabad are the landmarks of our dedication and devotion.

The group directors with over 4 decades of experience in various real estate and infrastructure projects have an impressive track record in diverse fields like housing complexes, commercial ventures, business parks as well as industrial set ups.

Great potential and expertise shines brilliantly through the ideologies of the group that stands tall and strong amongst all its contemporaries.

OUR PROJECTS



Angel Mega Mall - Kaushambi



Angel Prime Mall - Panipat



Angel Platinum - Indirapuram



Angel Tech Park - Sec.62, Noida



Angel Jupiter - Indirapuram



Angel Business Square - Sahibabad



Angel Mercury - Indirapuram



Angel Golf Avenue-II, Sec.75, Noida



AADINATH PROBUILD (INDIA) PVT. LTD.

Regd. Office : Angel House, 4, Jagriti Enclave, Vikas Marg Extn., Delhi - 110092

Site Office : Angel Jupiter - Main Road Indirapuram (Opposite Petrol Pump)

Ph. : 9910246667, 9910246661, 9310061685, 0120-4153265/67

Call : 8010505050 • Email : support@angelindia.in • Website : www.angelindia.in

Architects : GIAN P. MATHUR & ASSOCIATES (P) LTD. C-55, East of Kailash, New Delhi - 65 Tel. : 011-41624771, 41621129

Note : Visual representations shown in this brochure are purely conceptual. All Building Plans, Specifications, Layout Plans etc. are tentative and subject to variation & modification by the company or the competent authorities sanctioning plans. Brand names appearing in the brochure are for artwork purposes only.