



*Transform* your lifestyle from ordinary to magical..

welcome to the world of

*infinite*

happiness

ZRICKS.COM



*Experience the peaceful, infinite happiness...*



# The Project



Welcome to a classic reinvented. Welcome to Ananta Jagat.

After grand success of Green Acres Neemrana, Ashadeep Group brings you yet another tribute to fine living - Ananta Jagat at Bhiwadi. The project is surrounded by number of completed, ongoing residential and commercial projects. The project has exquisite 2/3 BHK Luxury Residential Apartments. All these are in the midst of Bhiwadi. Just like a classic, they exude sophistication, refinement and luxury. The architectural ambition of the project is to create a new iconic landmark that would function as a key catalyst as well as providing striking new facilities sprawling in 8.5 acres of land that would accommodate over six hundred families. The group housing will have all modern basic facilities & fully equipped club house.



←  
de-luxe  
living

2/3 BHK Apartments



↑  
resort like  
club house

Club House



→  
your own  
isle of green

landscaping

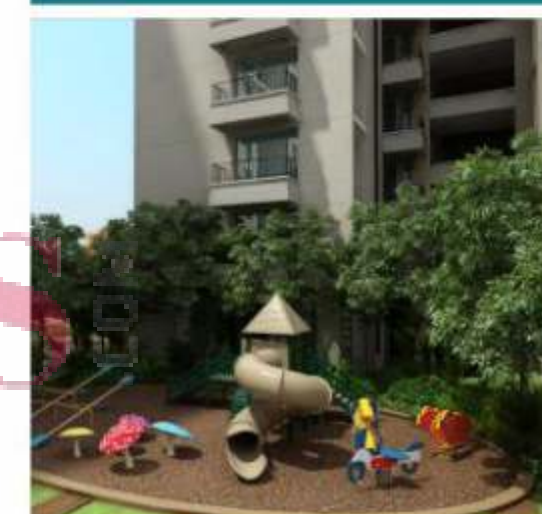

←  
family  
zone

Kids play area  
Sitting area



↑  
sports  
for health

Outdoor games



ZRICKS



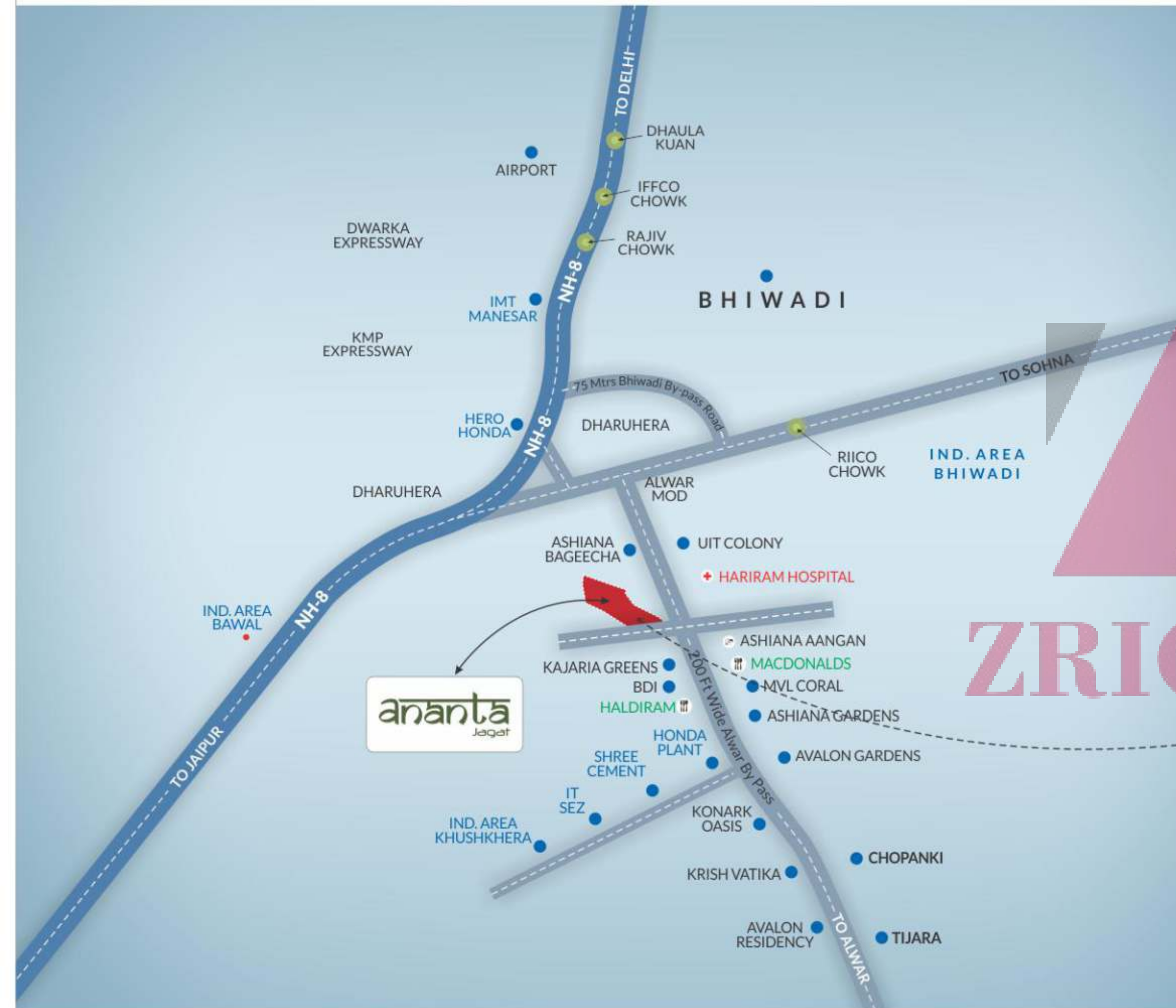

### Excellent Location

- 55 minutes drive from Delhi Airport.
- 40 minutes from Ind. Area Neemrana
- 40 minutes drive from Rajiv Chowk, Gurgaon
- 20 minutes drive from IMT Manesar.
- 15 minutes from Indl. Area Bawal
- 05 minutes drive from Dharuhera.



## Why Bhiwadi?

Bhiwadi, the gateway of Rajasthan, is a fast growing industrial town in the NCR, and is being featured as one of the hottest destinations in India. Bhiwadi has received a total investment of Rs. 15,000 crores last year, and the picture for this year (2013-14) is even better. Major portion of the investment has gone into Housing and other infrastructure projects. Bhiwadi is surrounded by well developed industrial hubs like Manesar, Bawal, Khushkhera, Chopanki, Neemrana, Rewari etc., Little wonder, the prominent corporates like HONDA SIEL CAR, HONDA SCOOTERS, SHREE CEMENT, LAFARGE, PARRYWARE, HINDWARE, etc. have already got themselves established there. Apparel Processing Export Zone, Leather Processing Zone have been approved to emerge in the area in the near future. Besides industries setting their footholds in Bhiwadi, other facilities like banks, schools, shopping malls etc. are also available in plenty.

ZRICKS





welcome to the world of **Ananta Jagat**

At 'Ananta Jagat' homes are best in location, amenities & features. Around 600 dream homes, 2/3 BHK, will go all out in ensuring that every member of your family celebrates life together like never before. Here homes are created from the finest materials and include amenities that you'll absolutely fall in love with. Here we will endeavour for warmest neighbour & best quality of life with every moment as celebration. Homes where every moment is celebration, bring together the best features, with most exciting amenities, with warmest neighbours, with best quality of life and homes situated in the very best location. Home at Ananta Jagat brings joyful moments, happiness for a minute, delight for an hour, bliss for a day, ecstasy for a week, an elation for a month and celebration for lifetime. At Ananta Jagat, it's our endeavor to put our heart and soul to create finest homes that is delight in every way.





## Project Features

**ananta**  
Jagat

Vehicle Parking	<ul style="list-style-type: none"> <li>• Car Parking for each flat</li> <li>• Option for Open/covered parking</li> </ul>		
Security Automation	<ul style="list-style-type: none"> <li>• Automatic Boom barriers on Entry &amp; Exit Gate.</li> <li>• CCTV Camera Security</li> <li>• Perimeter sensor</li> <li>• Video enabled intercom terminal from main gate</li> </ul>		
Lift	<ul style="list-style-type: none"> <li>• All Lifts with Automatic Rescue Device (ARD)</li> <li>• All lifts are Gearless</li> </ul>		
Lift Lobby	<ul style="list-style-type: none"> <li>• Wall with properly designed cladding</li> <li>• Flooring Marble/Granite/tile</li> </ul>		
Electrical	<ul style="list-style-type: none"> <li>• 0.8 KVA Power Back up in each flat</li> <li>• Full power backup for common area</li> </ul>		
Water & waste Water Management	<ul style="list-style-type: none"> <li>• 24 Hrs. water supply</li> <li>• Rain water harvesting for ground water recharge</li> <li>• Sewerage Treatment Plant (STP)</li> <li>• Recirculation of treated water for flushing and gardening</li> <li>• Water Bodies</li> </ul>		
Other Facilities	<ul style="list-style-type: none"> <li>• 75 % open and Landscaped area</li> <li>• Children Play Area</li> <li>• Retail area</li> <li>• Multipurpose Hall</li> <li>• Jogging Track</li> </ul>		
Club	Health	Sports	Others
	<ul style="list-style-type: none"> <li>• Swimming Pool</li> <li>• Gymnasium</li> </ul>	<ul style="list-style-type: none"> <li>• Badminton Court</li> <li>• Table Tennis</li> <li>• Billiards Room</li> <li>• Card Room</li> <li>• Carrom</li> </ul>	<ul style="list-style-type: none"> <li>• Reading Room</li> </ul>
Structure	<ul style="list-style-type: none"> <li>• Earthquake Resistant Structure</li> </ul>		
Fire Fighting system	<ul style="list-style-type: none"> <li>• As per Norms</li> </ul>		
Common area Maintenance	<ul style="list-style-type: none"> <li>• Professional Facility Management Service</li> </ul>		

**Luxury and Lifestyle Amenities**, exclusively for you.





Here's a chance to live a magical life...



de-luxe  
living



2/3 BHK  
APARTMENTS

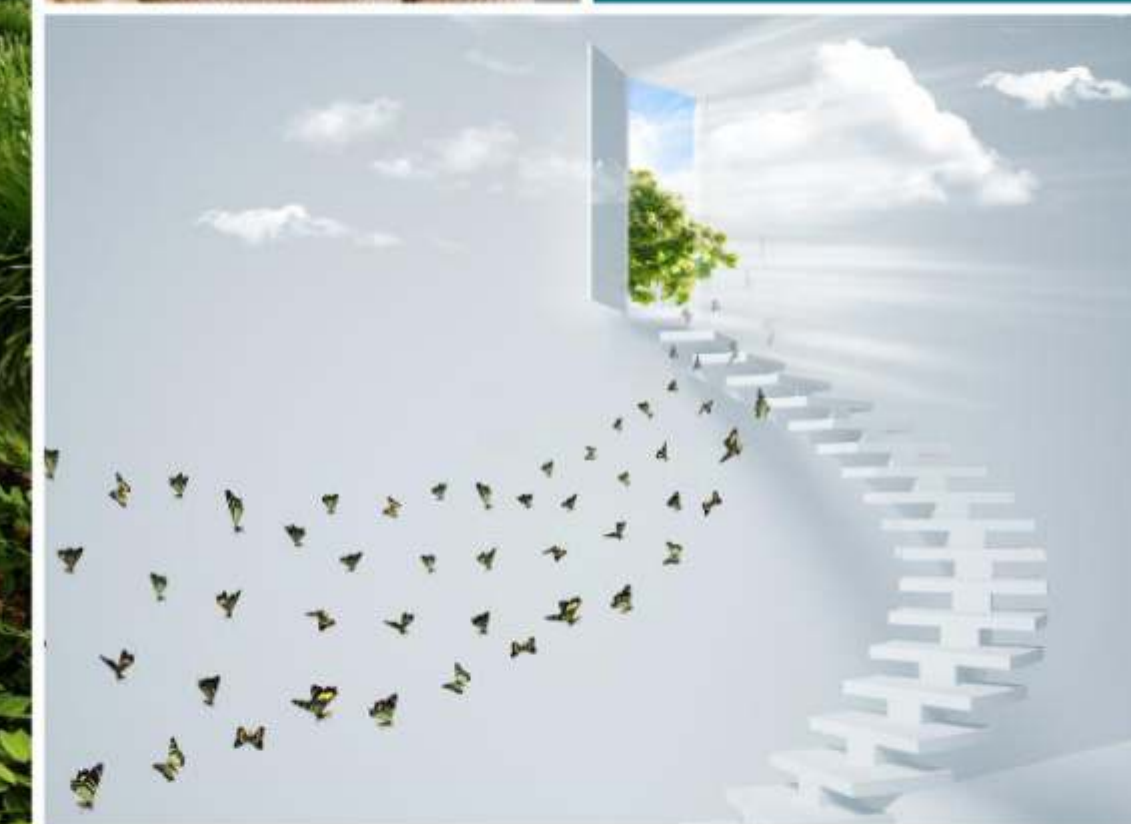

2 & 3 BHK A P A R T M E N T S



ananta  
Jaqat

Welcome to a contemporary lifestyle

- Premium Location
- 75% open &  
Landscaped area
- 2/3 BHK Apartments
- Modern Architecture
- 24 X 7 Security
- Latest Amenities
- Fully equipped club

ZICKS





Bhiwadi's group housing project that makes a style statement



LEGENDS

1 Entrance Plaza

2 Active Recreation Zone

3 Tot Lot

4 Space For Yoga

5 Walk over Fountain

6 Swimming Pool

7 Walking Boulevard



Site Plan





Color Code	Category	Configuration	BUA*(Sq. Ft.)	BUA*(Sq. Ft.) Corner
●	B	3 BHK + Servant Room	1620.00	1666.00
●	C	3 BHK + TOI-3	1433.00	1473.00
●	D	3 BHK + TOI-2	1285.00	1325.00
●	E	2 BHK (T-1)	1034.00	1076.00
●	F	2 BHK (T-2)	935.00	-

\*All BUA's are approximate and each unit will have different area







ZRICKS .COM

CATEGORY B  
3 BHK + SERVANT ROOM  
CORNER UNITS  
BUA : 1666.00 SQ.FT.

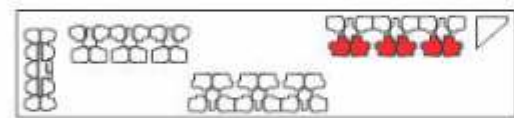

CATEGORY C  
3 BHK + TOI-3  
BUA : 1433.00 SQ.FT.

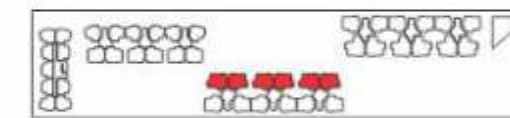





CATEGORY D  
3 BHK + TOI-2  
BUA : 1285.00 SQ.FT.

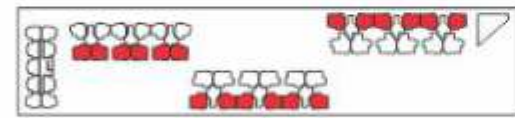

ZRICKS.COM



CATEGORY E  
2 BHK (T-1)  
BUA : 1034.00 SQ.FT.







CATEGORY F  
 2 BHK (T-2)  
 BUA : 935.00 SQ.FT.

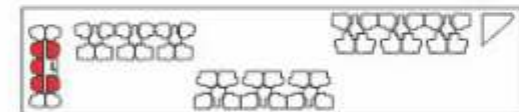

ZRICKS.COM





Welcome to **club life** at ananta jagat

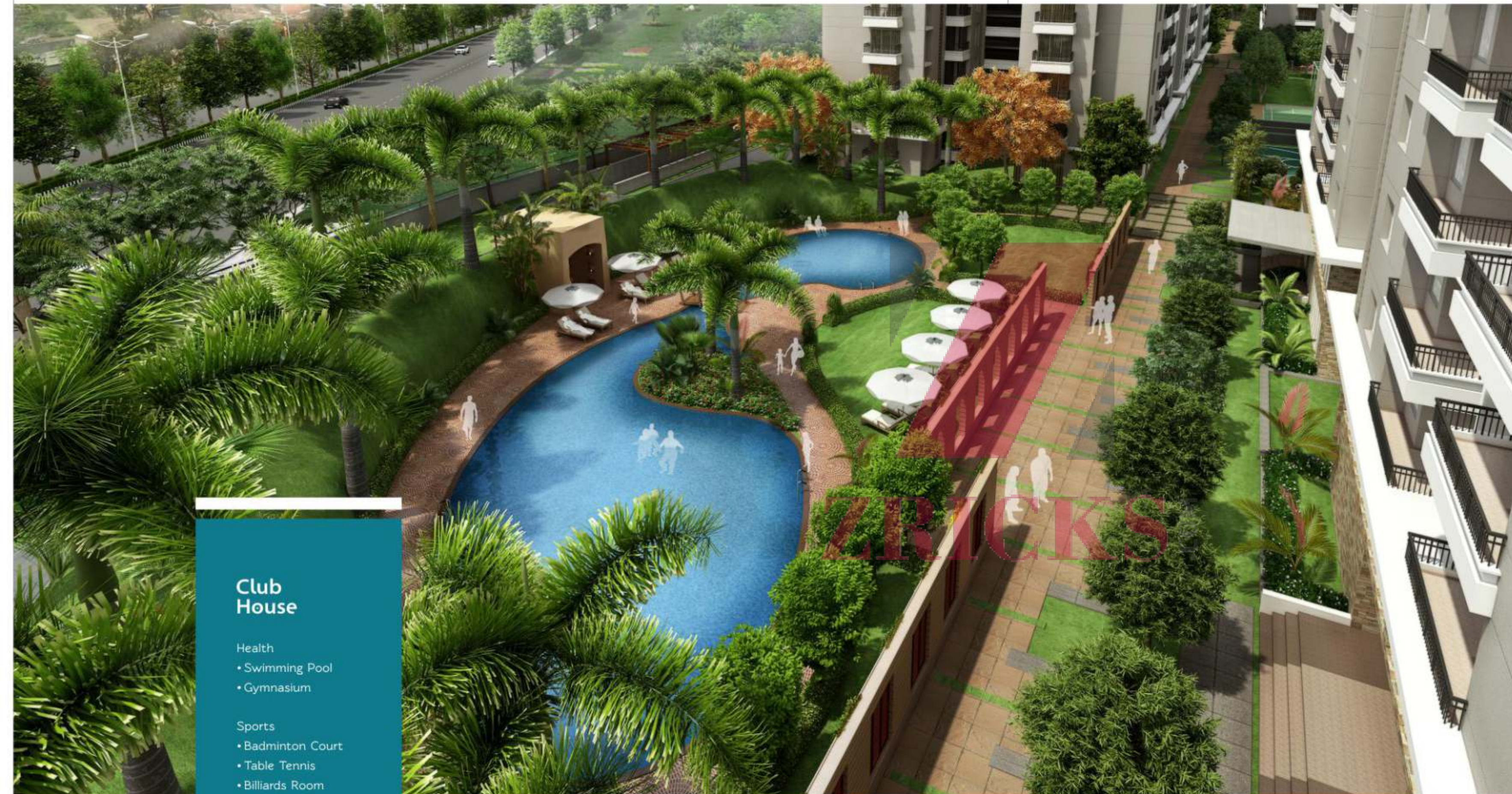

club  
like  
resort



Club House  
for wholesome  
entertainment



- Club House**
- Health
- Swimming Pool
  - Gymnasium
- Sports
- Badminton Court
  - Table Tennis
  - Billiards Room
  - Card Room
  - Carrom
- Others
- Reading Room

C L U B H O U S E



## Well equipped **club houses** to relax with **friends and family**

Life is dull without entertainment. Take up a new hobby or simply get-together with friends or neighbours right at your doorstep. The clubhouse at Ananta Jagat is fully equipped with all modern facilities. The Club complex has numerous games, both indoor and outdoor. It has taken the luxury into the next era of glamour with beautiful new features. The layout provides adequate visibility and space for gathering. You can walk into the clubhouse and indulge in a number of fun filled activities.

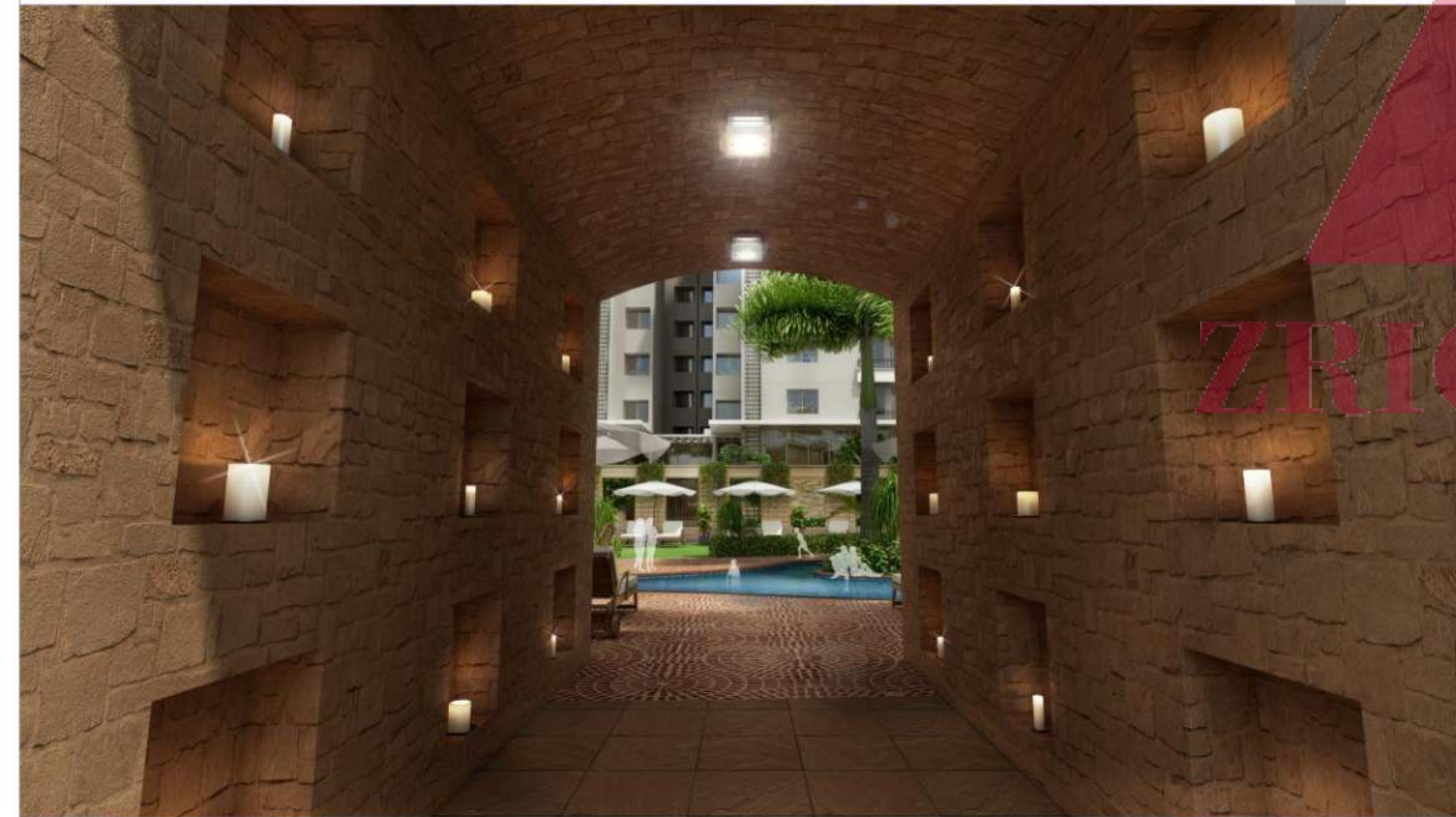

Entrance for Swimming Pool



Entrance for Club House





Club Ground Floor Plan

ZIKICKS



Club First Floor Plan



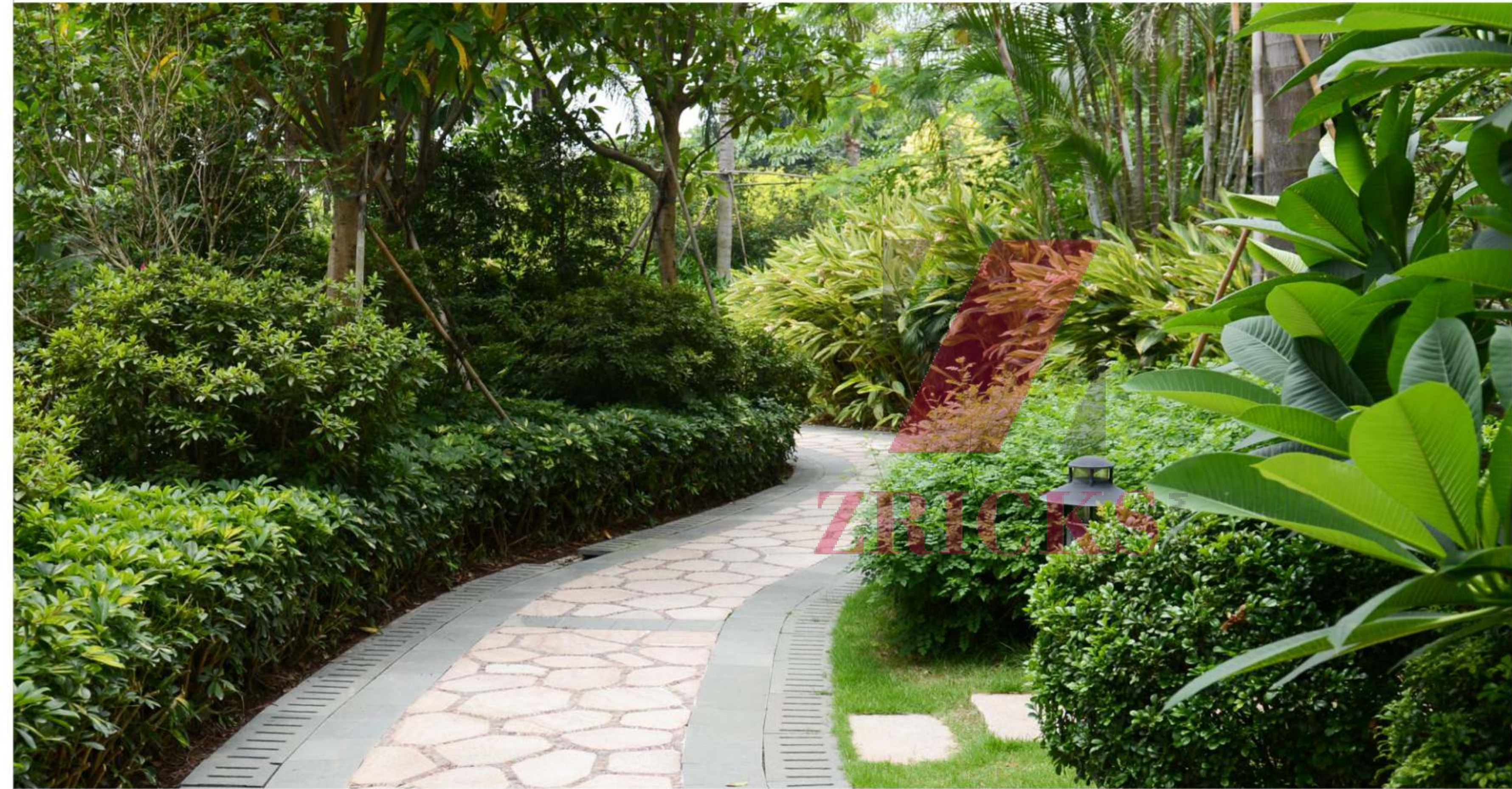

green  
at  
heart  
Landscaping



sports  
for  
health  
sports zone



S P O R T S   &   L A N D S C A P I N G



## well-landscaped gardens, dotted with a variety of flora in a palette of **cooling greens**

**Flora & Fauna Accentuate the Infrastructure** The landscape creates a climate of calmness and reverence. The alignment of landscaping done in a more systematic way to manoeuvre the way around. It radiates splendour with warmth and elegance, a couple's love of travelling and hosting family and friends.



- Lush green Garden
- Feature Walls
- Tot lot
- Yoga Centre
- Sculptural Platform
- Walk Over Fountain
- Gazebo

Sitout and Kids play area

L A N D S C A P I N G



simply have a **friendly Sunday cricket match** with your neighbours

ananta  
Jagat

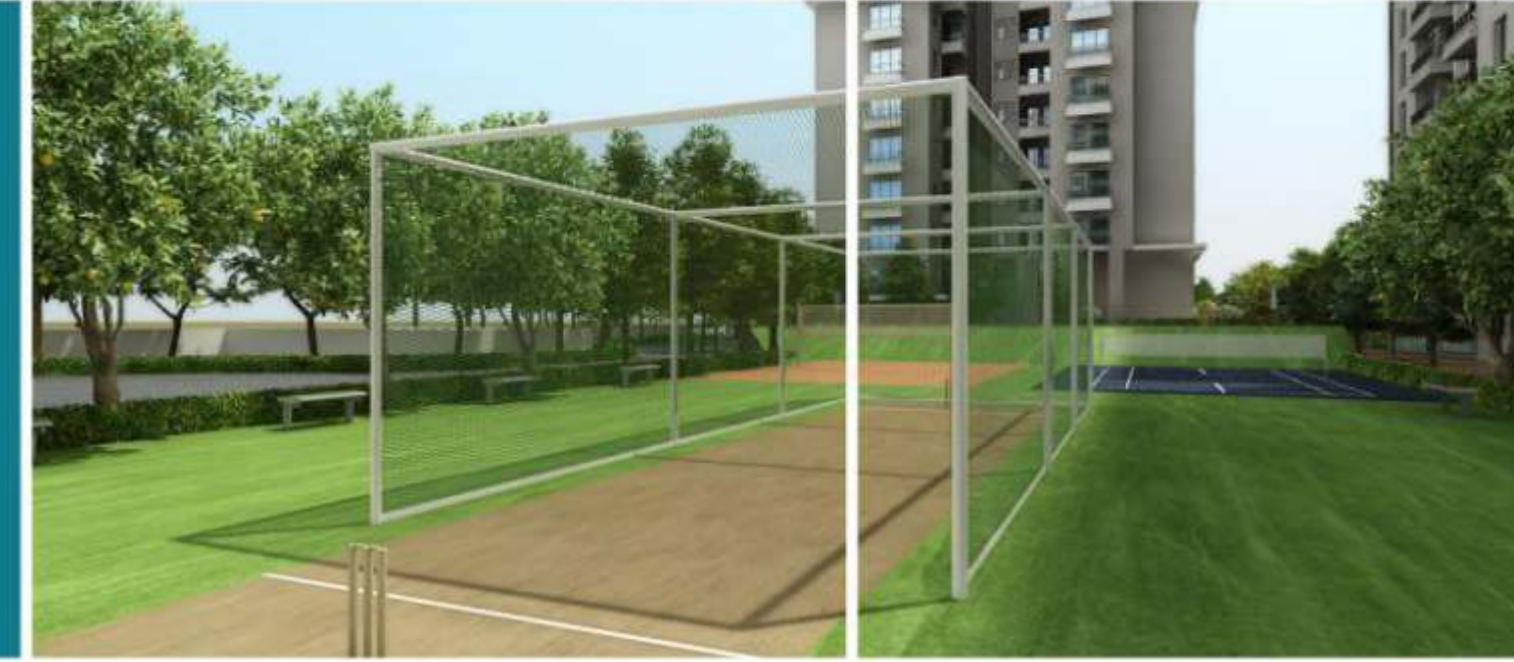

SPORTS

- Badminton court
- Cricket Net
- Basketball Court

Spend your evenings in leisure playing

Spend your evenings in the recreation-cum-community area with provisions for play articles and also a place to recline.

ZIRCKS



Most visually striking aerial view

ananta  
Jagat





# Specifications of the Project



AREA	Item	Specification	Brand
BEDROOM/ LIVING DINNING	Floor	Vitrified Tiles	Johnson/Kajaria/Equivalent
	Wall & Ceiling Finish	POP finished	
	Wall & Ceiling Paint	Plastic Paint	Berger/Asian/ICI/equivalent



TOILETS	Floor	Ceramic anti skid Tiles	Johnson/Kajaria/Equivalent
	Wall & Ceiling Finish	Tiles upto lintel level and POP above	
	Wall & Ceiling Paint	Plastic Paint	Berger/Asian/ICI/equivalent
	C.P. Fittings	Single lever fitting	Jaquar/Equivalent
	Sanitary Fittings	Wall hung W.C.	Jaquar/CERA/Hind ware /equivalent



BALCONY	Floor	Ceramic anti skid Tiles	Johnson/Kajaria/Equivalent
	Railing	Iron railing	



KITCHEN	Floor	Vitrified Tiles	Johnson/Kajaria/equivalent
	Wall & Ceiling Finish	POP finished	
	Wall & Ceiling Paint	Plastic Paint	Berger/Asian/ICI/equivalent
	Counter	2' wide Granite counter top	Black/Green/Red Granite
		2' Dado tiles above counter	Glazed/Johnson/Kajaria /equivalent
	Sink	Stainless Steel	Neelkanth/equivalent
CP Fittings	Mixture	Jaquar/Equivalent	

Area	Item	Specification	Brand
WINDOWS		Anodized aluminum/ PVC sliding windows	
		Wire mesh and glass sliding shutter	
		Provision of a steel guard rail inside the room	



ELECTRICALS	MCB Box	Good Quality	Legrand/Havells/Schneider/equivalent
	Wires	Multi-Strand copper wires.	Finolex/National/Havells /equivalent
	Switch	Modular Switches	Legrand/Havells/Schneider/Havells/equivalent
	Provision for Air Condition	Ear marked position for Split A/C in drawing room/bedroom	
Ear Marked position for outdoor unit			



DOORS		30 mm internal wooden doors	
		35 mm wooden designer door at entrance	
		Provision of wire mesh door in all external door frame	
		Good quality hardware fittings	Dorset/Archies/equivalent



STAIRCASES		Granite/Natural Stone	
		MS Railing	



ZRICKS .COM





## The Group

### Ashadeep Advantage

- ♦ High on Transparency
- ♦ Clarity on All charges
- ♦ Committed for quality
  - ♦ Use best quality materials
  - ♦ Use Best construction practices
  - ♦ Use of Best of Human Resource
  - ♦ In-house and third party, quality check
- ♦ Timely completion of projects
- ♦ Professional set up for Projects execution, Building Maintenance and Rental services

Ashadeep Group was established in 2002. It is headquartered at Jaipur. The Group has interests in Real Estate and Infrastructure sector. It is a professionally managed Group involved in real estate development in Rajasthan. The Group has accomplished many Townships and Group Housing Projects in Jaipur city. Group is currently developing townships in Neemrana also.

Group had built Group Housing Project for Central government employees (CGEWHO) in Jaipur city. Group is also building an Affordable Housing Project in Jaipur city under Public Private Partnership Model (PPP).

The Group projects are differentiated by their futuristic layouts, aesthetics and eco-friendliness. All projects have value added features such as aesthetic landscaping, recreational facilities, education, healthcare and institutional services.

Group leverages several years of engineering experience. It has the best of breed, professional-class capabilities, in civil engineering and construction industry. The Group's experienced engineers & project managers, go hand-in-hand with client to develop project specific knowledge to offer innovative solutions that exemplify world class architecture, ergonomic design, and scalability that address the needs of future generations.

The Group process ensures specific focus towards project planning & construction management, integration with latest trend in wastewater & rain water harvesting, solid waste management, environment, safety and cost optimization.

## "Green Acres" One of the prestigious successfully ongoing project at Neemrana



Layout of "Green Acres", Neemrana

### Green Acres, Neemrana (Actual Photographs)



Green The Villas

Gulmohar Walkup Apartments

Tulip, Group Housing

Green The Villas

Gulmohar Walkup Apartments

Ashadeep Royal Club



### Completed Project

"Green Avenue" was group's first housing project started in year 2007. The project is situated at Jagatpura, Jaipur. The project is fully approved and received completion certificate from J.D.A. This project has infrastructure facilities i.e. drainage and water supply system, lush green landscaping in 70% of land area, STP & system for recirculation of treated water. It has a fully equipped club house. At present (March 2013) 125 families are enjoying living at "Green Avenue"



Green Avenue, Jagatpura Jaipur (242 flats)

Actual Site Photograph

### Completed Project Completion certificate received from JDA



Kendriya Vihar -2, Jagatpura Japur (572 flats)

Actual Site Photograph

### Upcoming Projects

1. "Vedanta" is an upcoming residential project by 'Ashadeep Group' at Jagatpura, Jaipur. It has 631 flats. The project will have all modern basic facilities and fully equipped clubhouse. It will have more than 75% of the landscaped and open area. Project will be fully approved by JDA.
2. "Vasant Kurj" is also an upcoming fully developed Residential township of plots, in land area of 60 acres. It is located near Goner village, just adjoining to Ring Road. The project will have basic facilities like roads, electrical line, sewer line, STP, water harvesting structure etc. Project will be fully approved by JDA.





# ZRICKS



Developed & Marketed by

**Renaissance Buildhome Pvt. Ltd.**

6-D, Corporate Tower A2, Jawahar Lal Nehru Marg

Near Jawahar Circle, Jaipur 302 017

Ph. : 0141-4112190, 4112192, Mobile : 93093 21000

E-mail : [info@ashadeepgroup.com](mailto:info@ashadeepgroup.com)

Website : [www.ashadeepgroup.com](http://www.ashadeepgroup.com)



Architects

**m | a | a | r | c | h | i | t | e | c | t | s**

Jaipur • bangalore • hyderabad

Disclaimer: This brochure is only conceptual and does not constitute an offer. It is not part of any selling document. All the existing drawings are illustrative and for reference only. The developer reserves the right to amend the number of floors, number of units, layout, plans, elevations, colour schemes, specifications, etc. without prior notice. All dimensions are approximate and subject to verification on-site and approvals.