

**EXPRESS**
KMP SONEPAT **City**

ZRICKS.COM



ENDLESS HAPPINESS...



SONEPAT

Located at stones throw distance from Delhi, Sonapat is one of the most promising locations of National Capital Region (NCR). Rapid development of Kundli - Manesar - Palwal (KMP) Expressway has acted as a catalyst for the progress of the area. The expressway will not only provide easy access to the International Airport but also open floodgates for numerous development projects.

Key Highlights :

Global Corridor along the KMP Expressway for world class development

Rajiv Gandhi Education City spread over 5000 acres

Proposed metro rail connectivity

Just 15 min. drive from Rohini and Pitampura and Next to KMP

45 min. drive to IGI Airport via KMP Expressway

Major Industrial Parks already operational in Kundli and Rai

Proposed Food Park in Rai and an Apparel Park in Kundli

Major SEZ projects

Various theme cities such as Leisure City, Fashion City and IT City



THE PROJECT



EXPRESS
KMP SONEPAT City

ZRICKS

Express City is a well planned, fully integrated, modern township where all present and future needs of the residents have been taken care of.

Spacious villas and regular sized plots with well planned wide roads, drainage system and street lighting are the hallmark of Express City.

The whole township would be bifurcated into well-defined residential sectors with ample provision for nursery schools, shopping complex etc.

Entire gamut of infrastructural needs have been well envisaged, i.e.:

- Water & Power Supply
- Sanitation
- Internal Road Network
- Drainage System
- Parking Facilities
- Entertainment & Shopping
- Safety & Security Features etc...



WALK IN DREAM...LIVE IN TRANCE
ENJOY LIFE...AT EVERY CHANCE
LIVE THE VERVE WITH ALL ITS MIGHT...



- Regular geometrical shape of plots
- Infinite possibilities for personalized designing
- Free flowing area for movement
- Dwelling surrounded with liberal amount of greenery
- Vaastu friendly layout
- Well-lit wide roads
- 24x7-manned security
- A modern sewage disposal system



VILLAS



The villas and plots are available in varied sizes to suit individual tastes and needs. The regular shaped plots ensure flexibility in planning and personalized design.

Adequate open space is being provided in front of the plots for development of green cover.

Innovatively designed with eco-friendly features, the villas shall compliment the modern cosmopolitan lifestyle of its residents.

Express City invites you to an open lush green environment with well carpeted, wide, illuminated arterial road network.



BUILT UP INDEPENDENT DUPLEX VILLAS AND PLOTS IN VARYING





- Pollution free secure environment
- Spacious interiors
- Ultra Modern fixtures and fittings
- Ample parking space
- Round the clock security
- Seismic zone IV specifications for all constructions
- Ultra modern fire-fighting system to ensure your safety



APARTMENTS

ZRICKS

The appealing apartments of The Express City would mesmerize its residents. The superior style and the dazzle of architectural appeal bear the mark of Express Group, having more than 3 decades of experience.

An effortless blend of modernity and elegance reverberates all around. Be it interiors or exteriors every detail has been carefully thought upon before converting it into scintillating reality.



2/3/4 BEDROOM
APARTMENTS AND
PENTHOUSES
IN VARIED SIZES ARE THE
OPTIONS TO CHOOSE
FROM.





Maximum Open Area

Beautiful landscaping

Wide & networked jogging tracks

Picturesque water bodies

Demarcation of residential and non-residential areas to minimize noise and air pollution

Provision of rain-harvesting system

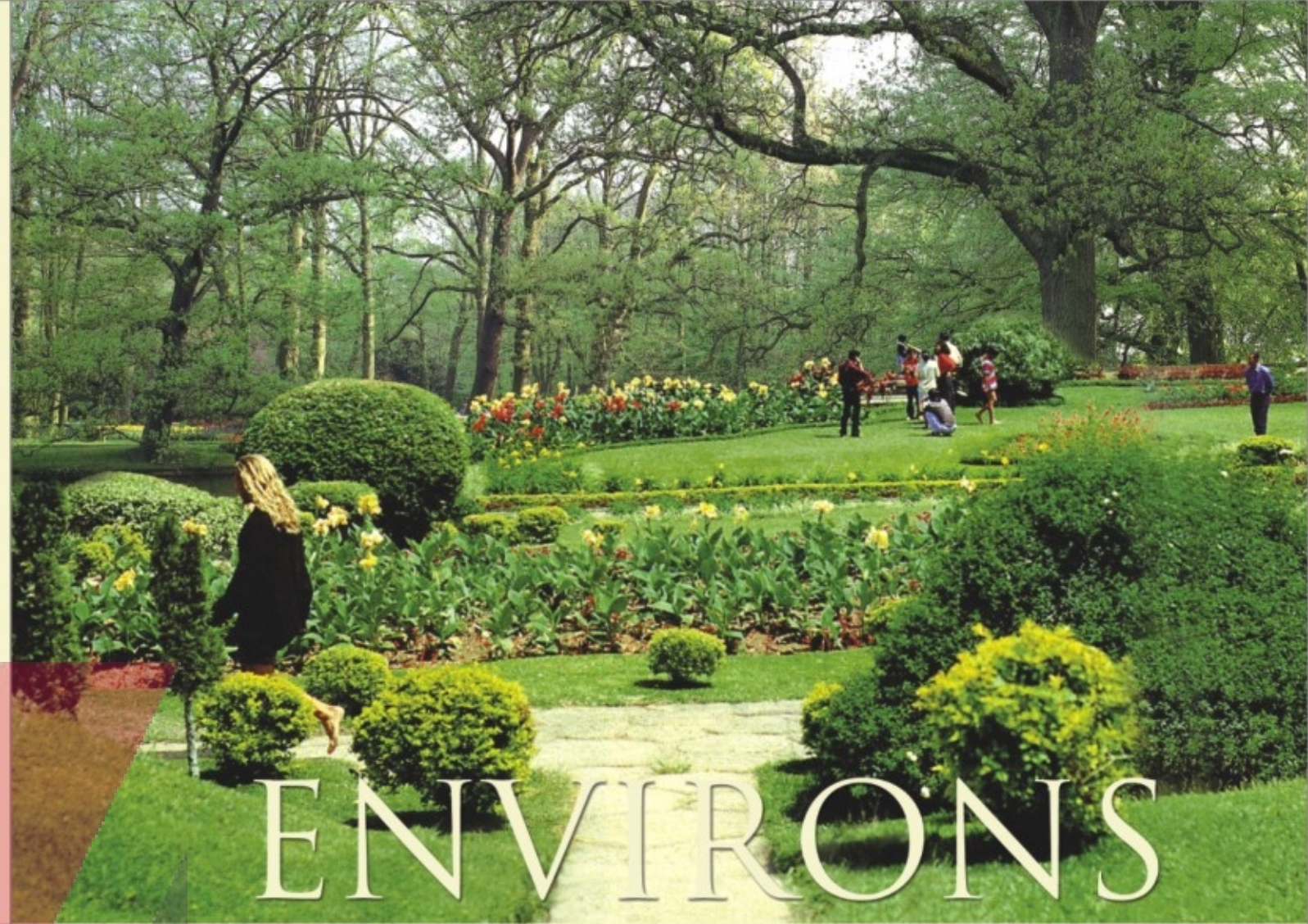

ENVIRONS

Express City is a visual feast with a vast green belt stretching along both sides of the township and a touch of greenery at every corner.

Express City has star attractions of fountains, joggers tracks etc.

The "exotic exteriors" of Express City will mesmerize you endlessly through the cool surroundings.

Designed in harmony with the tenents of Vaastu Shastra, Express City is a creative blend of innovative space management, with perfect synergy of privacy, aesthetics and vast green spaces.



ENJOY THE CHARISMATIC SET UP TO EXPERIENCE THE CELEBRATION OF

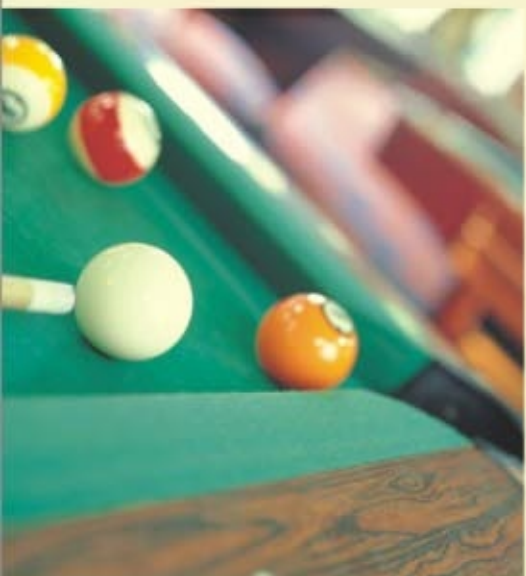

Ultra Modern recreational area with Swimming Pool

An up-to-date Gymnasium with modern facilities

Provision of illuminations

Pole lights for dazzling bays and spaces

Security Posts at all essential junctures

A power station that will remain 24 hrs functional



RECREATION AREA

Leading life with style is the motto of Express City. Exclusive as well as all-inclusive recreation facilities will keep your social nerve ticking. Various means of entertainment, indoor sporting facilities and leisure games will be there for that extra dash of stimulation required by mind and body.

Have an early morning tryst with nature at the jogging track. Melt your lethargy and experience a healthy lifestyle after an invigorating walk along well-trimmed track. A tempting water pool will invite you for a cool leisure swim during summers.



WHAT A WAY...
TO START YOUR DAY!

ZRICKS



A mini super market will ease out your daily shopping rigmarole. It is going to be very convenient to simply get everything of your needs within a very short distance. Even your children would be able to hop-and-shop for you.

Also stop worrying about the basic necessity of medical facility. An updated and adequately staffed nursing home will take care of the residents of the township.



AMENITIES

ZRICKS

Express Group is aware that apart from beauty and chic style a lot more is needed for actually living. We have made elaborate arrangements for the daily needs of the residents like shopping, grocery demands, educational provision and medico facility. A state-of-the-art mall would be right close to your vicinity for all your shopping and entertainment needs.

A branch of a renowned and reputed school will be present right within the township to make you carefree of your children's education.



EXPRESS CITY : A WORLD WHERE LIFE IS NOT LIVED BUT CELEBRATED.

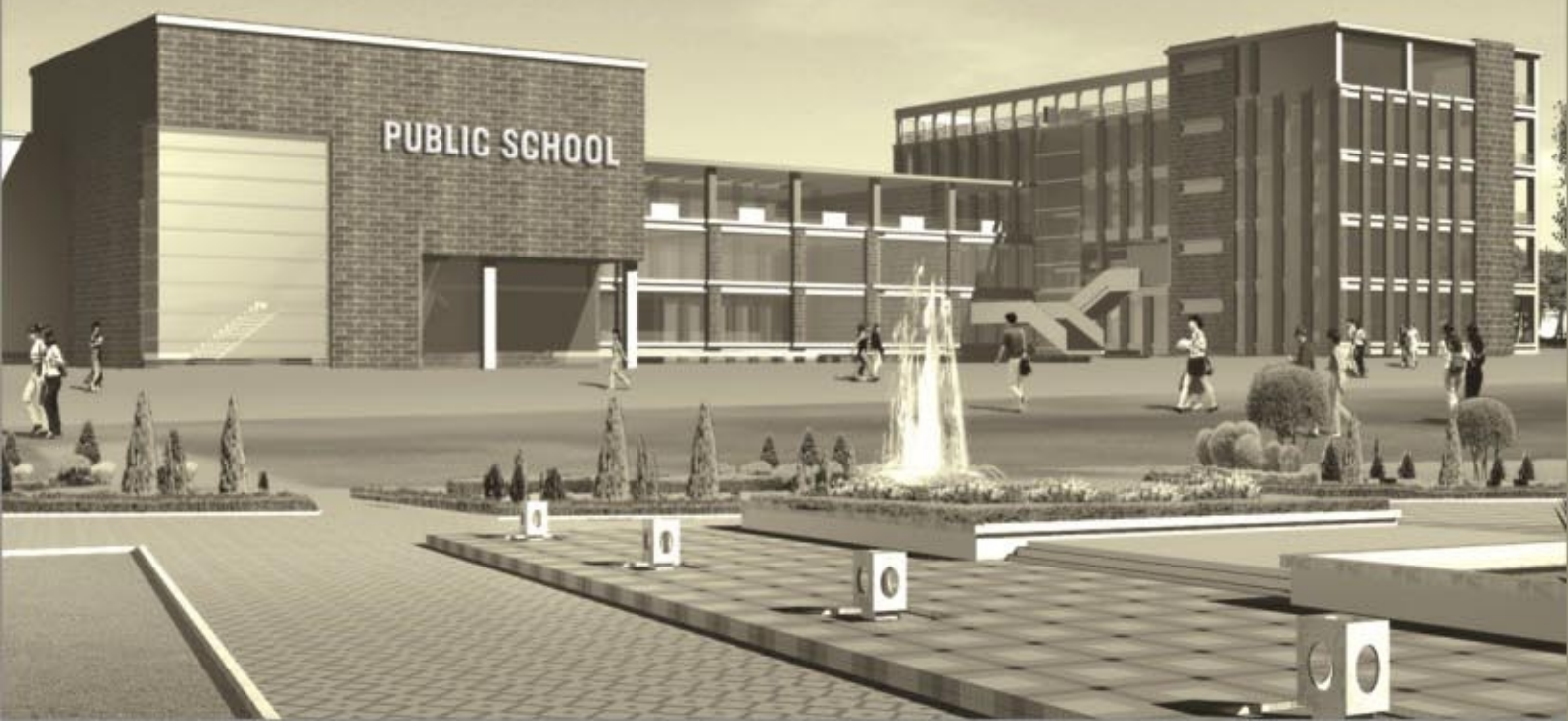

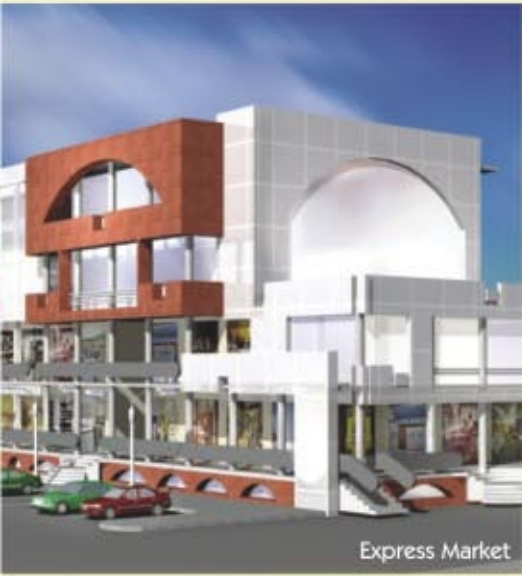

Express Market



Express Plus



Some of our projects are :

Name of Project	Location	Name of Project	Location
Express Garden	Indirapuram	Gitanjali Apartments	Bangalore
Express Market	Indirapuram	Ashirwad Enclave	Delhi
Gitanjali Layout	Bangalore	Express Plaza	Delhi
Express Apartments	Bangalore	Express Market	Delhi
Express Apartments	Hyderabad	Gitanjali Corner	Bangalore
Express Apartments	Vaishali	Express Market	New Delhi
Express Plus	Vasundhara	Palm Court	Bangalore
Express Mall	Indirapuram	Express Residency	Bangalore
Super Bazar	Moradabad	Express Elegance	Bangalore
Express Tower	Delhi	Express New City	Bangalore



EXPRESS
Zenith
Sector-77, Noida
2/3 Bedroom Luxury Apartments & Penthouses

THE GROUP

EXPRESS
garden
Indirapuram

ZRICKS

Express Group has carved a niche for itself, as the developers of prime Commercial and Residential Properties across India.

The Express Group is a legacy that needs no introduction. The Express Group rests over the sturdy platform of architectural eminence that is firmly supported by the pillars of dedication, perseverance, innovation and modernism.

Express Group stands for real architectural landmarks and exemplary end-to-end realty business solutions that are not only integrated with innovation, but are endorsed by a high octane professional experience that is a class apart.

Today the group is growing by leaps and bounds, developing a niche for itself as a highly acclaimed Promoter, Developer and Colonizer working with perfection and excellence.



WITH OVER 3 DECADES
EXPERIENCE THE LEGACY
CONTINUES....



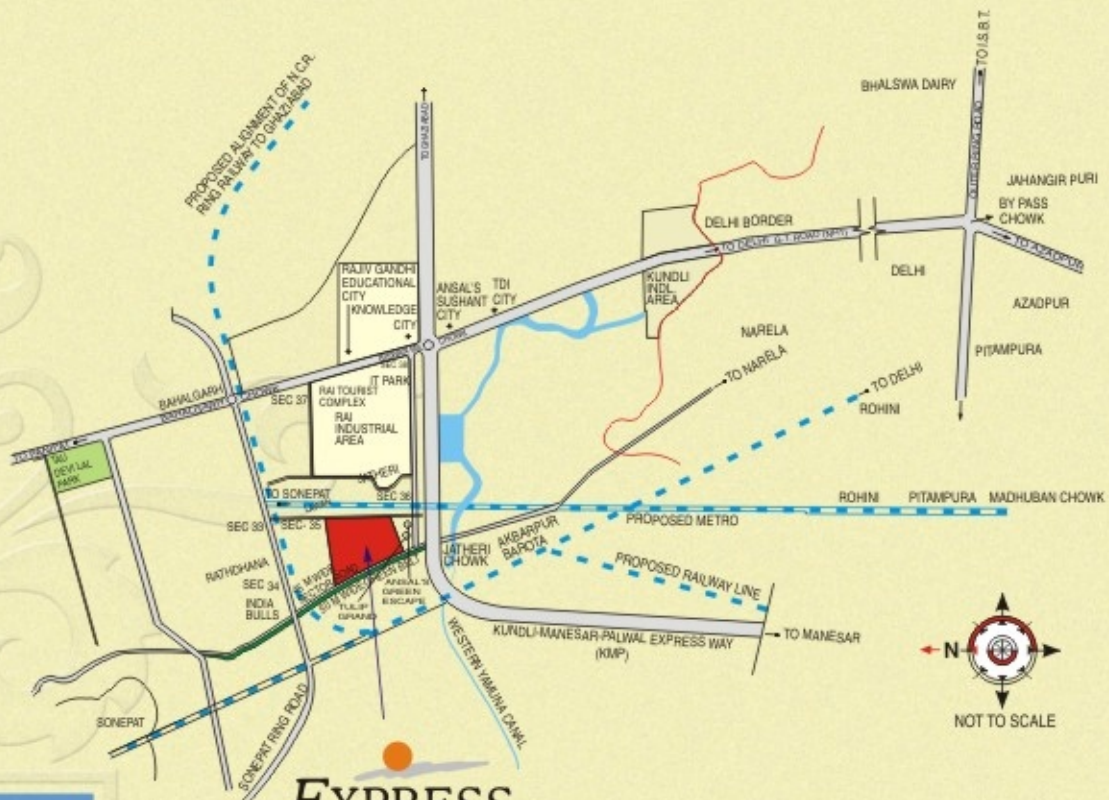

EXPRESS
City
KMP SONEPAT

LOCATION

- Prime location next to Kundli-Manesar-Palwal Expressway
- Good connectivity to Delhi and Indira Gandhi International Airport
- In close vicinity of proposed IT Parks and SEZ
- Only 15 minutes drive from Azadpur Bypass
- Fastest developing area of NCR
- Easy connectivity with southern districts of Haryana such as Gurgaon, Faridabad, Rohtak and Jhajjar
- Proposed metro rail connectivity



Express Projects (P) Ltd.
an associate of



EXPRESS BUILDERS LTD.

Head Office : 810, Surya Kiran Building, 19, Kasturba Gandhi Marg, Connaught Place, New Delhi-110 001
Tel.: 2375 2430-31. Fax : 2375 2432. E-mail : sales@expressbuildersltd.com
Website : www.expressbuildersltd.com

Site Office : Express City, Sector-35, KMP, Sonepat.

INHABIT THE WORLD OF EXPRESS

Builder/ Architects have the right to change the specifications/ drawings.
All the pictures and accessories shown in this brochure are conceptual & do not amount to the offer.