





ZRICKS<sup>MEM</sup>

All of us at some point of time in our lives  
wish to be closer to the moon.

The Moon Court homes  
are an ode to the mystical allure of the moon  
inviting it to seep into our lives  
drenching us in its Godly glow.





# The Creative Community

Jaypee Greens, Greater Noida, India's first and only golf centric, self-contained township has ushered in revolutionary concepts in lifestyle living creating a synthesis of beautiful homes, lush landscapes, signature golf courses and recreational areas with freshness of nature at its best.

Developed in a vast area of over 450 acres, this township offers community-living that celebrates life, health and creativity. We now present **MOON COURT** by the creators of Best Golf Development and Best Apartment in India.



'Best Golf Development'  
by CNBC Asia Pacific Property  
Awards 2008



## Universe Unfolding...

Moon Court apartments are the latest addition at the India's best residential community - Jaypee Greens Greater Noida.

These residential apartments aim to provide all the elements of comfort for those who desire it for their new home, with facilities that define modernity, optimum space utilization and style. Meticulously designed these apartments offer 2 BHK + Study and 3 BHK + Servant Room option.

An artistic rendering of the Moon Court Apartments, a modern high-rise residential complex. The building features a white facade with extensive glass windows and balconies. It is situated in a lush green environment with palm trees and other tropical vegetation. In the foreground, a couple is walking on a path, and a group of people is visible in the distance. The sky is blue with some clouds. A large, stylized 'Z' logo is overlaid on the image, with the word 'ZBRICKS' written in red below it.

ZBRICKS





ZPRICKS

These elegant and stylish apartments are complemented by imaginative recreational amenities.

Strategically located on the periphery of the 60 acre Nature Reserve Park, all the apartments at Moon Court offer expansive view of the beautiful lake spread over 7.5 acres, landscaped greens and 350 yard driving range.





Actual view of the apartments at Jaypee Greens



## Good living comes home...

The interiors offer proportioned spaces adapted to modern needs. The goodness of nature has been well blended with the most modern architectural facilities, thus enhancing the overall look and feel of newage lifestyle.

Embossed with modern specifications, these apartments ensure perfect harmony between aesthetics and functionality.

Where everything is extravagant-right from the exquisite design and spacious interiors to ample lighting and ventilation with all quality fittings.



## In nature's lap...

Green undulations encompassing your home, render not only a vista to your window but also add sumptuous treat to your soul. Nothing can gratify you more than the tender affection of Mother Nature.

Jog your way through the trees or walk the trail down to the water bodies. Moon Court apartments have the most apt surroundings to make your life as healthy as refreshing as it can be.

As a privileged resident of the Moon Court, enjoy the pleasures of individually designed apartments along with the facilities such as Social Club, the Jaypee Resort & Spa, Golf Courses and the Jaypee Integrated Sports Club.









# The Moon Court - Unit Level Specifications

**Structure**

Earthquake Resistant RCC frame structure with masonry infill /RCC wall

**Floors**

Living/ Dining / Foyer	Imported / equivalent Vitrified Tile Flooring
Bedrooms/ Study	Laminated wood flooring
Workers/Utility Room	Ceramic Tiles
Balcony	Antiskid Ceramic Tile
Main Staircase	Kota Stone
Fire Escape Staircase	Kota Stone
Lift Lobby	Vitrified Tiles

**Walls**

External	Texture Paint
Internal	Acrylic Emulsion/Texture Paint on POP
Lift Lobby walls	Imported /equivalent Marble
Ceilings	Acrylic Emulsion/Texture Paint on POP

**Doors/Windows**

Internal	HDFB Skin Doors
Main Door	Paneled Veneered Ply Doors
Wardrobes	Pre-laminated board modular wardrobes

**Bathrooms**

- High Quality vanity counter, fixtures and fittings
- Imported / equivalent tiles on flooring and on walls
- Vanity, Water Closet, Shower area

**Kitchen**

- High Quality counter, fixtures and fittings
- Imported / equivalent tiles on flooring and on walls
- Modular Kitchen



Utilities and Facilities

Security	<ul style="list-style-type: none"><li>• Door Phones &amp; Intercom in Apartment</li><li>• 24 Hour manned security on entrance gates</li></ul>
Air-conditioning	Individual Split
Ventilation	Exhaust fans in kitchen and bathrooms. Natural ventilation through doors and part external windows.
Landscaping	Landscaped common areas to preserve and enhance the natural characteristics of site
Water Supply	Water Supply through underground lines/overhead tanks
Sewage Water	Soiled water drainage into main sewer outside property (through our STP)
Storm Drainage	Storm water drainage system integrated for rainwater harvesting
Fire Protection	Fire detection / sprinkler system as per fire safety norms
Main Electrical Supply	Electrical wiring in concealed conduits with modular switches and power back up
Telephone/Data	<ul style="list-style-type: none"><li>• Telephone cable pre-wired into all rooms</li><li>• Cabling for internet access as per design</li></ul>
Services	Maintenance of common area on chargeable basis

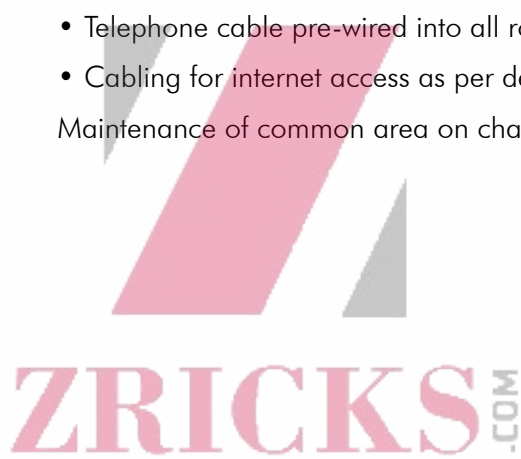

Notes and Remarks

1. Brands and makes are indicative only. Actuals will be of equivalent of make and quality as per availability at the time of execution.
2. Wood being natural materials has inherent characteristics of colour and grain variations.
3. All floor plans, layout plans and specifications are indicative and are subject to change as decided by the company or by a competent authority.
4. All works shall be carried out as per standard practice.
5. All works shall be executed as per the standard architectural design and details worked out by our Project Architects.

# Typical Floor Plan - Tower 1 & 4

60 Acre Nature Reserve View

### 2 BHK + Study

Sale Area: 112.13 sq.m. (1207 sq.ft.) appx.

### 3 BHK + Servant (Corner)

Sale Area: 153.29 sq.m. (1650 sq.ft.) appx.

### 3 BHK + Servant (Stair Side)

Sale Area: 148.64 sq.m. (1600 sq.ft.) appx.

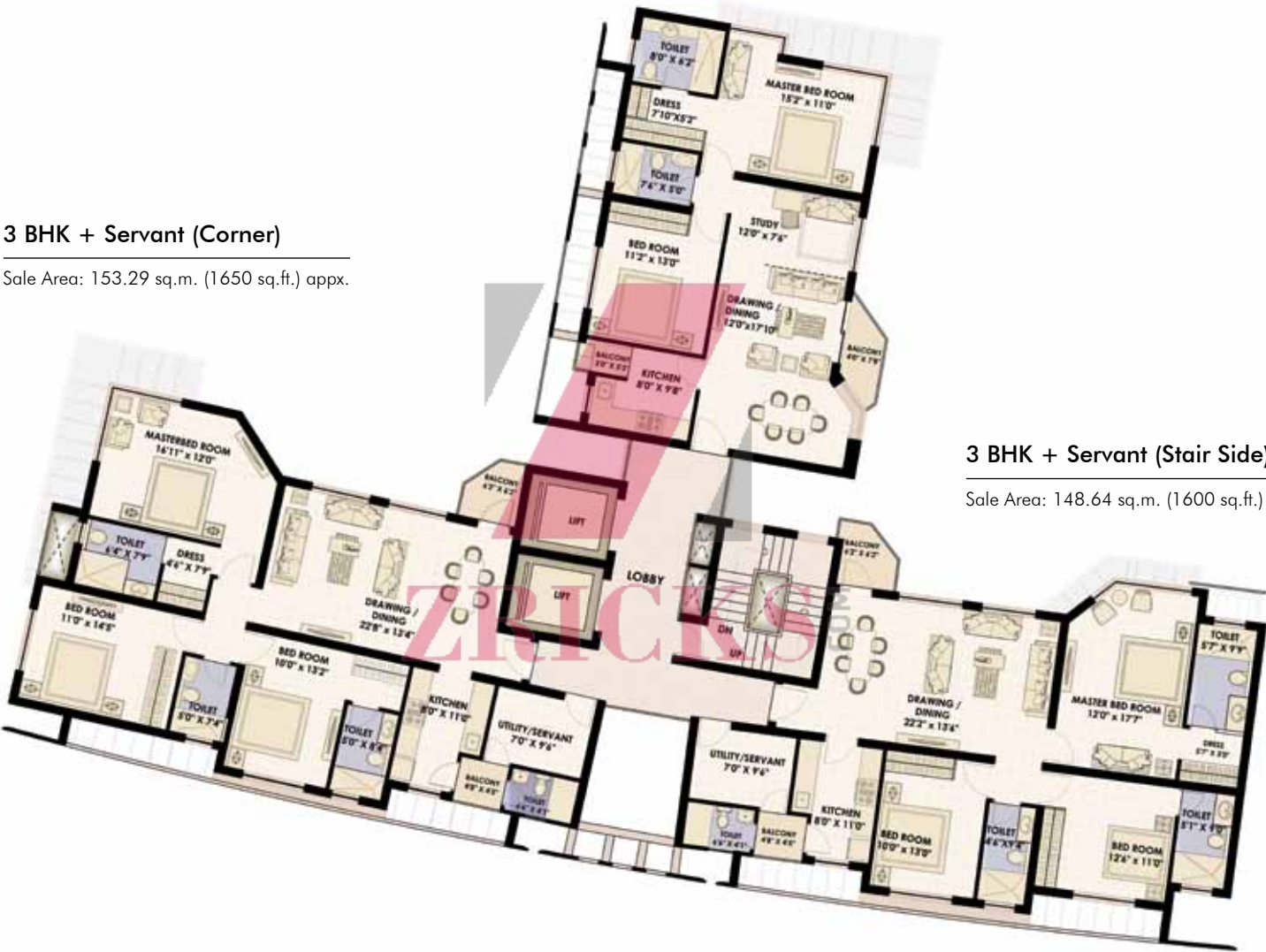



# Typical Floor Plan - Tower 2

60 Acre Nature Reserve View

## 2 BHK + Study

Sale Area: 112.13 sq.m. (1207 sq.ft.) appx.



## 3 BHK + Servant (Stair Side)

Sale Area: 148.64 sq.m. (1600 sq.ft.) appx.



## 3 BHK + Servant (Stair Side)

Sale Area: 148.64 sq.m. (1600 sq.ft.) appx.

# Typical Floor Plan - Tower 3 & 5

60 Acre Nature Reserve View

**2 BHK + Study**

Sale Area: 112.13 sq.m. (1207 sq.ft.) appx.

**3 BHK + Servant (Corner)**

Sale Area: 153.29 sq.m. (1650 sq.ft.) appx.

**3 BHK + Servant (Stair Side)**

Sale Area: 148.64 sq.m. (1600 sq.ft.) appx.





# Unit Floor Plan - 2 BHK + Study



2 BHK + Study

Sale Area: 112.13 sq.m. (1207 sq.ft.) appx.

Unit Floor Plan - 3 BHK + Servant Room

3 BHK + Servant (Stair Side)

Sale Area: 148.64 sq.m. (1600 sq.ft.) appx.



3 BHK + Servant (Right Corner)

Sale Area: 153.29 sq.m. (1650 sq.ft.) appx.





Location Plan

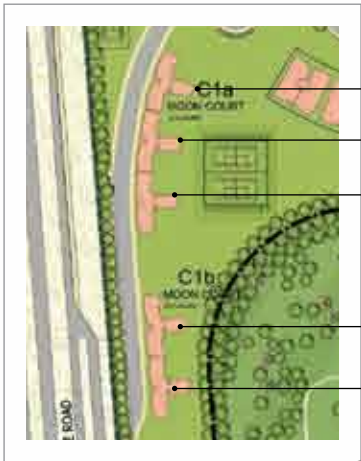

- A 18 hole Greg Norman Golf Course
- B 9 hole Golf Course
- C Bommerang Clubhouse
- D 350 yard Driving Range and Golf Academy
- E 60 acre Nature Reserve Park
- F Boutique Spa Hotel
- G Jaypee Integrated Sports Club
- H Town Centre
- I Way to Jaypee Greens Gated Community

## A Beautiful Reality

*where you love the whole tree, the shapely branch, the tender & wither leaf, the falling petal, the flight of birds and white moths dancing on the wings of fire into the enticing night. The splendid shadow of full love ... in the scenery, the people and the environment.*

*Life in its fullness... knows no decay.*

Incorporating the ideas of the world renowned architects & design firms, the project - Jaypee Greens has been evolved with the following features :



18 hole Greg Norman championship golf course. Spread over 197 acres, it is the longest in India at 7347 yards with 88 bunkers and 14 waterbodies.



9 hole Graham Cooke designed chip and putt golf course, present an enjoyable challenge to every level of golfer.

**ZRICKS**.COM

An immaculately maintained 350 yards Driving Range has the facility to practice from both ends simultaneously with six target greens and one putting green fringed by roughs and bunkers.



Golf Academy with a well equipped Pro shop is all set with state-of-the art training facilities.





170 room Boutique Spa Hotel in collaboration with ‘Six Senses Resorts & Spas’, tucked away in the ambient setting of the golf course.



An international standard Integrated Sports Club with multiple sports disciplines, designed for amateurs & professional training and competitive formats.



60-acre Nature Reserve Park enveloped by 7.5 acre man-made lake full off flora and fauna.



Well-designed Town Centre with shopping malls, convenio, boutique, cafes & restaurants in place.



## The Lineage

Transforming challenges into opportunities has been the hallmark of the Jaypee Group, ever since its inception four decades ago. The group is a well diversified infrastructure conglomerate with a turnover of over Rs.5000 Crore, and has a formidable presence in engineering & construction along with interests in the power, cement, hospitality and real estate sectors.

### Engineering & Construction

The engineering and construction wing of the Group is an acknowledged leader in the construction of multi-purpose river valley and hydropower projects and has the unique distinction of completing various projects spread over six states in India and neighbouring country Bhutan in different capacities in the 10th five year plan to provide 7880mw of hydropower to the nation. The company has to its credit completion of some of the most challenging projects in the country in the last decade.

### Cement

The Group entered the cement business with 1 mtpa capacity cement plant in 1986 and today has become the 3rd largest cement producer in the country and largest cement producer in the state of Uttar Pradesh. Its cement division currently operates modern, computerized process control cement plants with an aggregate capacity of 9.0 mtpa. The company is in the midst of capacity expansion of its cement business in northern, central and western parts of the country and is slated to be a 25 mtpa cement producer by the year 2010 and 32.8 mtpa by 2011 with captive thermal power plants totaling 300 mw.

Post expansion the group will have 12 integrated cement plants supported by 300 mw of captive thermal power, 9 split location plants, 11 railway sidings and one jetty giving the group a pan India presence in cement sector.

### Power

Jaypee Group, an integrated power player in the country after having established a strong presence in the hydro power sector has initiated its entry into thermal power generation, power transmission and also forayed into wind power.

The Group with its 300 mw Baspa-II Hydropower Station in Himachal Pradesh and 400 mw Vishnu Prayag Power Station in Uttarakhand is the largest private sector hydropower producer. The group is in the process of implementing 2 x 660 mw pit head based Nigrie Thermal Power Plant in district Sidhi of MP, 1000 mw Karcham-Wangtoo in Himachal Pradesh, 2025 mw Lower Siang and 500 mw Hiron in Arunachal Pradesh, 270 mw Umngot and 450 mw Kynshi (Stage-II) hydro-power projects in Meghalaya and 5 x 250 mw coal based thermal power plant at Bina in Madhya Pradesh. On commissioning of these projects, the Group will have total power generation capacity of over 7490 mw.

### Hospitality

The Group owns and operates four 5- star hotels, two in the national capital, New Delhi and one each in Agra and Mussorie and also a five star golf resort at Greater Noida. The properties have a total capacity of 675 rooms.

### Real Estate and Expressways

The Group has pioneered the development of golf centric real estate in India. Jaypee Greens - a world class integrated community with a sanctuary of residences sculpted around an international championship 18 hole Greg Norman Golf Course. Sprawled over 450 acres of land in Greater Noida, it houses an integrated sports club, boutique spa hotel, 60 acre Nature Reserve and Town Centre with convenio, boutique shop, cafes and restaurant.

The Group is currently implementing 165 km, Noida to Agra, 6/8 lane Yamuna Expressway project. Along the expressway a ribbon development of 2500 hectares of land at five or more locations will also be developed for commercial, industrial, institutional, residential and amusement purposes.

The Group has also bagged the contract to construct 1047 km long eight lane Ganga Expressway along the left bank of river Ganga from Greater Noida to Balia. This is by far the largest infrastructure project in the country. On completion of this expressway, great potential of agro-based industry, infrastructure facilities and development of new towns would take place. The Group will also have the right of development of an estimated 30,000 acres of land along the expressway.

The company plans to develop such installations to international standards with state of the art technology.

### Social Commitments

For over 3 decades now Jaypee Group has supported the socio-economic development of the local environment in which they operate and ensure that the economically and educationally challenged strata of the work surroundings are also benefited from the Group's growth by providing education, medical and other facilities for local development.

The Group believes that providing quality education is the best service that an organisation can provide to society. The Group supports various educational initiatives at all levels of the learning curve through Jaiprakash Sewa Sansthan (JSS), a not-for- profit trust. Today with 16 schools, 2 ITI's and 3 universities in UP, MP and HP, the Jaypee Education System is touching the lives of over 20,000 students and has an objective to equip at least 1 lac students with the power of education by 2013.



## Our Associates

### Arcop Associates

Originally founded in Montreal in the early 50s, Arcop Associates began its presence in India in early 70s through the office of world-renowned Montreal based architect Mr. Ramesh Khosla. His credits include the Mughal Sheraton in Agra, the Centrum in Los Angeles and Jaypee Palace, Agra.

### Shiban Ganju Associates

Shiban Ganju Associates have been majorly involved with designing number of hospitals, commercial buildings, institutional buildings, hotels, township development, homes and offices. Some of the Shiban Ganju Associates projects handled are Master Plan of the Township at Shambupura for Grasim Industries Ltd, and Hotel Residency Manor Mussoorie for JaiPrakash Industries.

### Greg Norman

Greg Norman, also known as the White Shark, established Greg Norman Golf Course Design Company in 1987 in Sydney, Australia. Since then, the company has grown into one of the leading golf course design companies in the world. Norman's hands-on approach is invaluable to the design process given his more than 25 years of playing professionally on a global basis. He employs this experience into each of his designs, with a goal of creating tournament-quality golf courses while maintaining an enjoyable sense of playability for players of all skill levels, as well as maintaining constant touch with nature.

### Belt Collins & Associates

In January 1953, Belt Collins & Associates was incorporated in Honolulu as a consulting civil engineering and planning firm by Robert M Belt and Water K Collin. Adapting to evolving client needs, Belt Collins has added services to compliment its engineering and planning techniques. Beginning with the addition of landscape architecture in 1960 and golf course architecture in 1980, the company has grown from two man organisation to one employing over 200 people.

### Sujata Kohli & Associates

Is an established firm of landscape & Environment Planners and Architects with office in Rajouri Garden, New Delhi. The company provides specific services required by clients for site layouts, site grading, external services and overall site management with respect to the existing features and topography.

# Location Details

A symbol of modern day town planning with ISO 9001 & ISO 14001 Certification, Greater Noida is the fastest growing townships in the National Capital Region, with international standard infrastructure ensuring quality of life, both at home and work. It is the only city in North India with privatised power distribution & uninterrupted power supply, underground cabling for electricity, water, sewer & drainage services, optic fibre cable networking & an extensive network of wide roads, flyovers, highways with plans for metro rail connectivity from Delhi region.

Jaypee Greens is located in the heart of Greater Noida, thereby enjoying good connectivity and locational advantage with respect to the city master plan. Residential, commercial, institutional, recreational and related facilities have been simultaneously developed in a planned manner to make Greater Noida a prestigious address.

The recent plans & approvals by the Govt. of India for hosting the Commonwealth Games, 2010, has further enhanced the pace of development in the form of additional world class infrastructure to support the cause.

The drive to Jaypee Greens via the Expressway is 25 minutes from New Friends Colony, 35 minutes from South Extn., 50 minutes from Vasant Vihar, 50 minutes from Connaught Place.

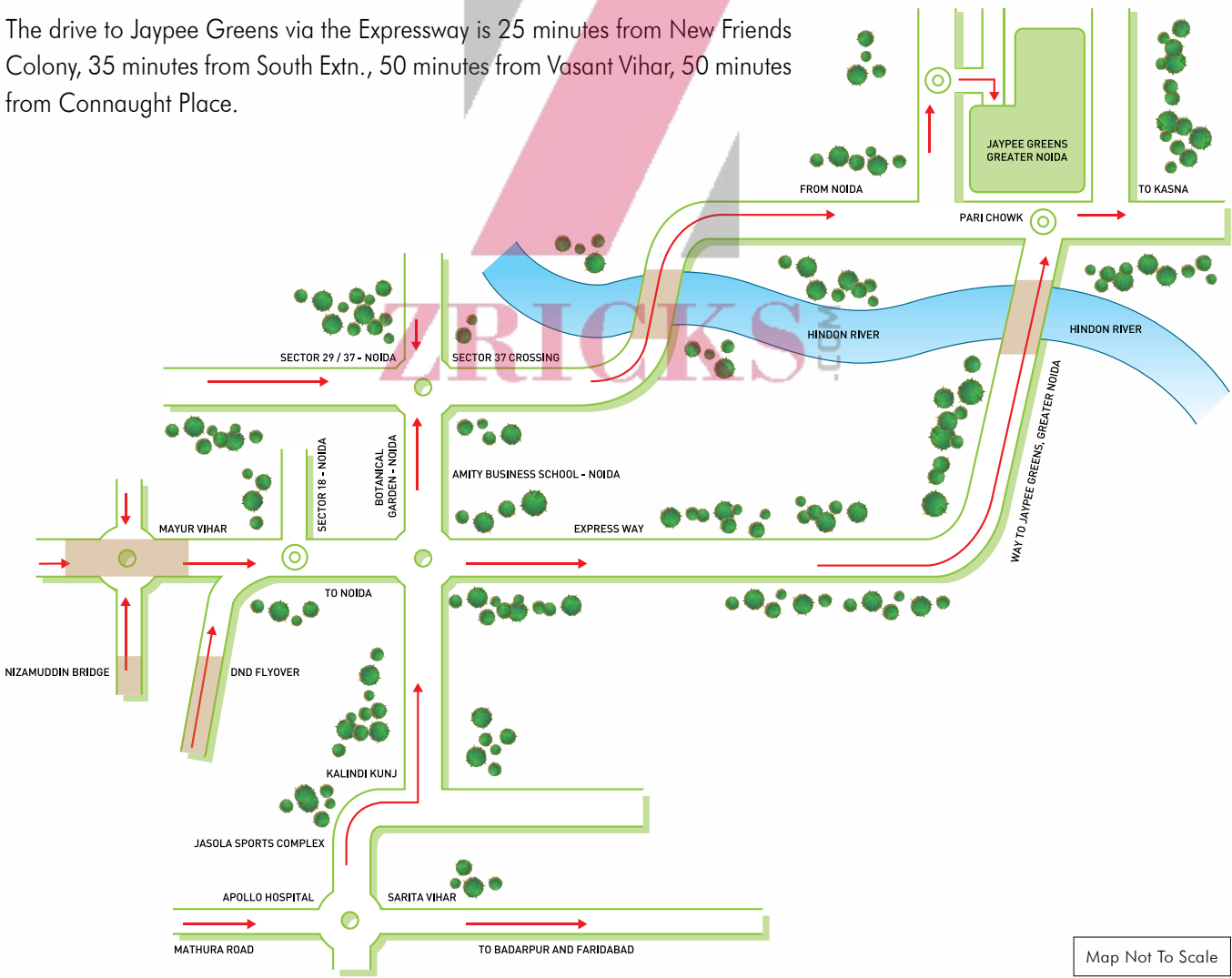





ZRICKS<sup>MOD</sup>



Sales & Marketing Office : Jaypee Greens, G - Block, Surajpur Kasna Road, Greater Noida - 201 306 (U.P.), India  
Phone : +91 120 2326533/34/35/36 Fax : +91 120 2320454 Toll Free No. : 1800 - 180 - 9900 (National)  
CRM Cell : 9999946339, 9910449989

E-mail: [response@jaypeegreens.com](mailto:response@jaypeegreens.com) Website : [www.jaypeegreens.com](http://www.jaypeegreens.com)

*This brochure is conceptual and not a legal offer and gives only a bird's eye view of the project. The contents in this brochure, including the buildings, elevations, area, designs, layouts, specifications, etc., are tentative and are merely indicative in nature and are subject to variations and modifications by Jaypee Greens or the competent authorities, statutory and otherwise.*