



At Rajnagar Extn., Ghaziabad



Welcome To High End Paradise

Highend Paradise is a high rise residential project which is situated in Ghaziabad. This modern day residential project is spread over 3.50 acres of land comprising of all the modern and basic facilities for a comfortable lifestyle. Highend Paradise offer luxurious 2 BHK and 3 BHK apartments in various configurations ranging from 920 sq. ft. to 1,650 sq. ft. respectively, suitable for all types of families. These residential apartments redefine luxury and comfort, promising a high standard of living in Ghaziabad.

Project USP

- Access to the modern clubhouse facilities:
 - A large modern swimming pool exclusive for adults and a separate pool for kids
 - Various indoor game facilities like table tennis, chess etc
- Entire structure based on eco friendly principles with the compliance of vaastushashtra
- Ample area dedicated for hassle free parking
- Efficient and professional management services
- Inbuilt modern shopping arcade catering to all the daily and basic needs of the residents
- Adjacent to a 2000 acre greenbelt
- Wide and spacious balconies providing breathtaking views in every apartment
- Beautiful landscaped green surroundings with 70% green area
- Designed with maximum optimization of space allowing the free flow of light and air



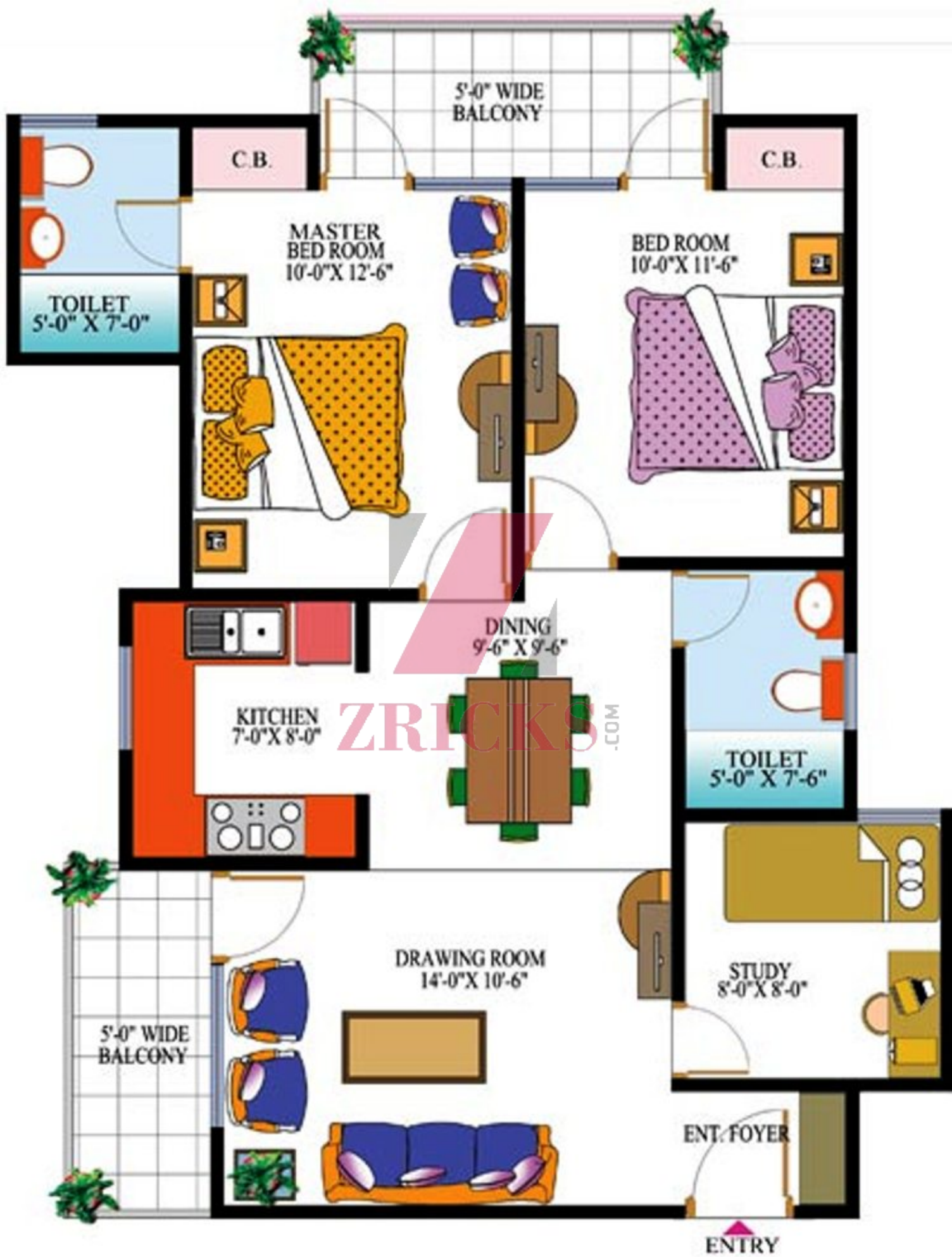

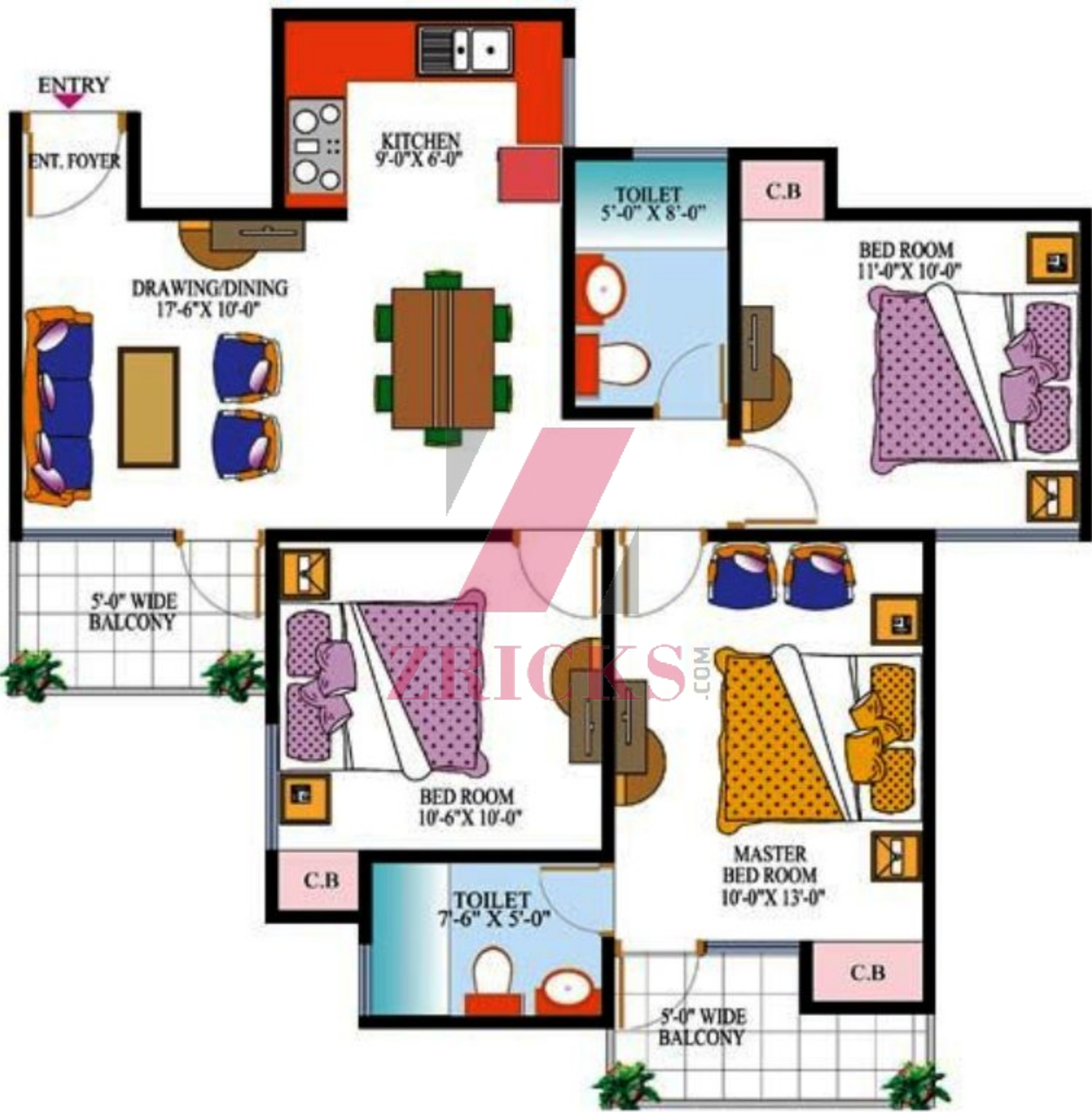



C.B.

C.B.

5'-0" WIDE
BALCONY

BED ROOM
10'-0" X 11'-0"

TOILET
5'-0" X 7'-6"

BED ROOM
10'-0" X 12'-0"

ENTRY

5'-0" WIDE
BALCONY

DRAWING ROOM
10'-0" X 14'-0"

DINING
9'-0" X 9'-6"

KITCHEN
9'-0" X 6'-6"

MASTER
BED ROOM
10'-0" X 13'-0"

TOILET
5'-0" X 7'-6"

5'-0" WIDE
BALCONY

C.B.

ZRICKS.COM

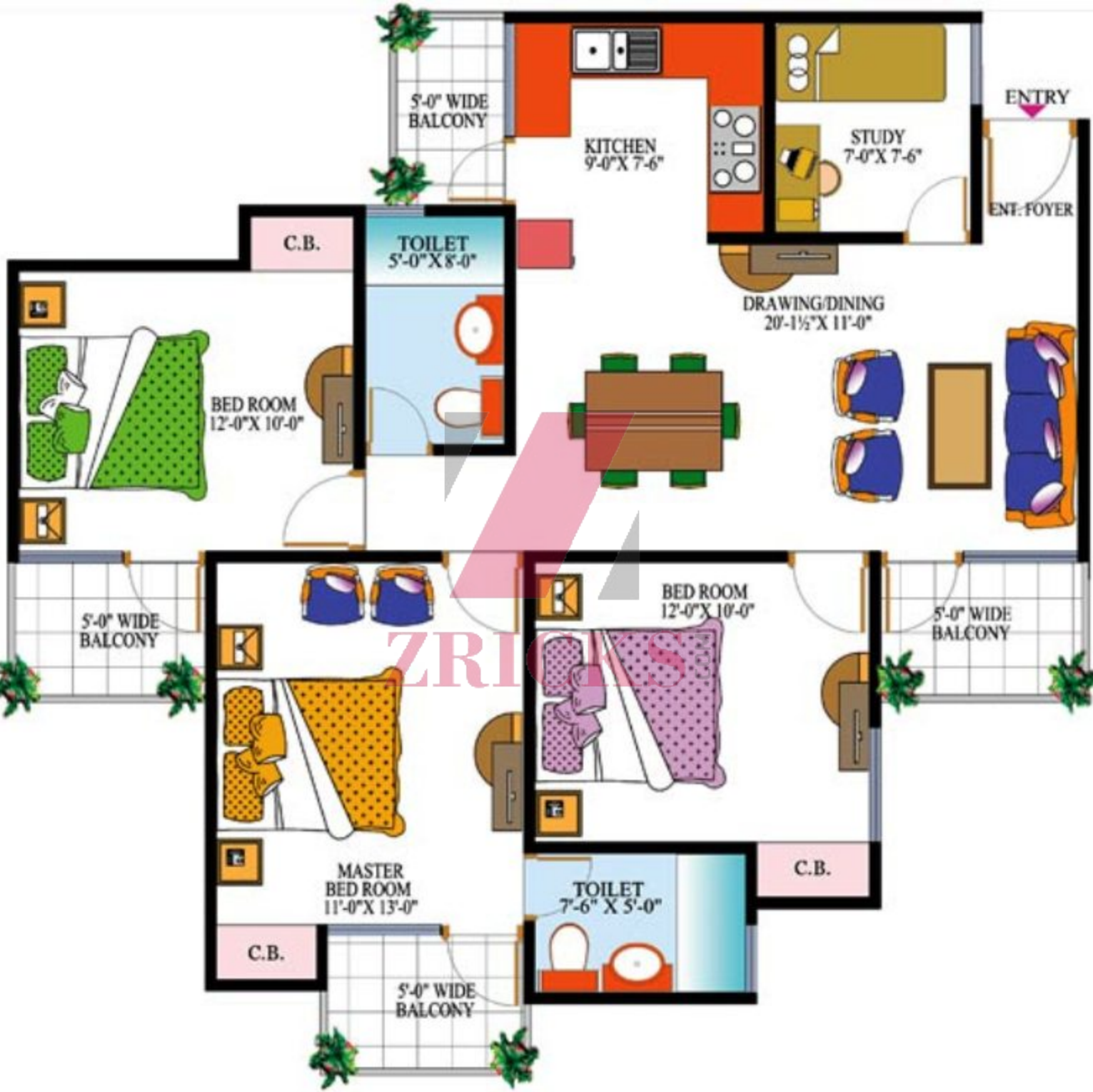

**F**

BASIC FEATURES

- A Luxurious Club
- Seperate Swimming pools for adults and kids
- Green park, Jogging Track
- Indoor Games(Table Tannis, Chess, Caroms etc.)
- Billiards Room, Gymnasium
- Open Badminton/ Volleyball/ Basket Ball Courts
- Lawn Tennis Court

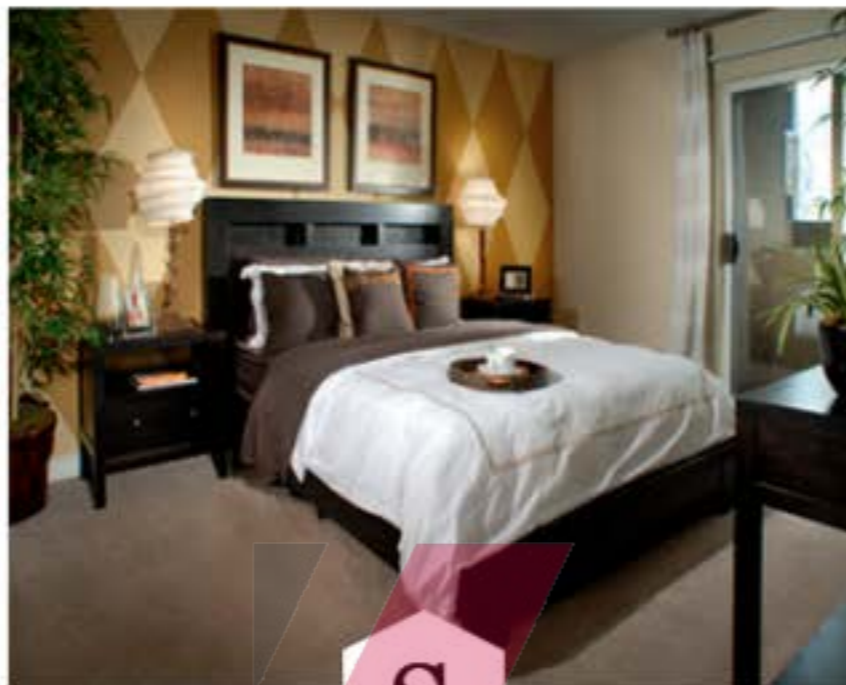
**S**

SAFETY FEATURES

- 24 Hours security .
- Gated complex .
- Assurance of quality .
- Peace of mind
- Secured lifestyle
- Safety of Investment
- High speed lifts & Latest fire fighting Equipments
- Planning as per vastu norms
- Professional Maintenance* .

**A**

ADVANCE FEATURES

- Independent R/O system.
- Tube Lights & Fans in Drawing/Dinning & Bedrooms
- Car parking*.
- Rain water harvesting
- Spacious balconies.
- Internet connectivity in each Apartment*
- Solar Energy System*
- 24 hours power backup*.

*condition apply

Tower A

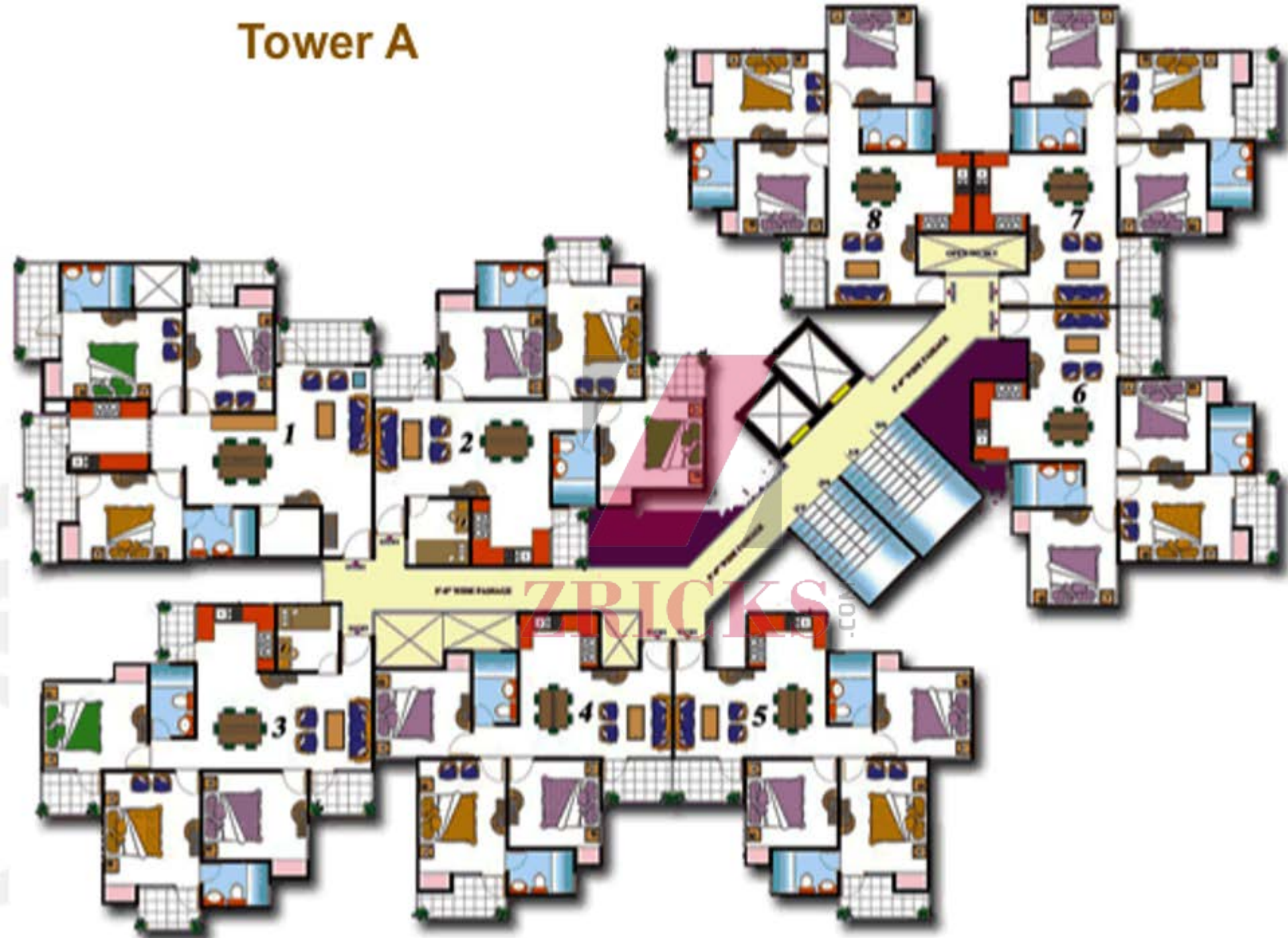

Tower C

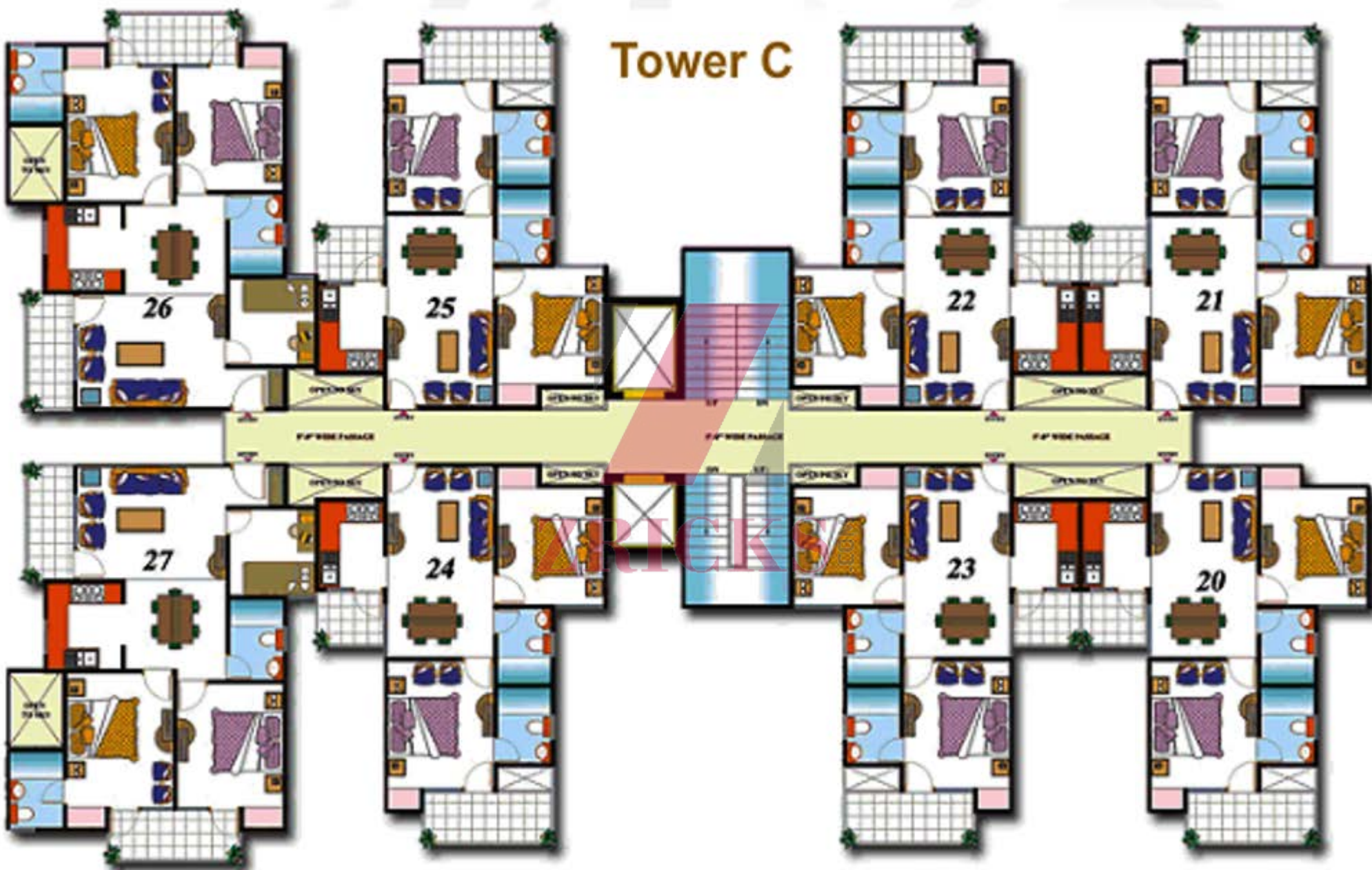



Payment Plan

Down Payment Plan

At the time of booking		10% of BSP
Within 30 days of booking		5% of BSP + 50 % of Additional charges except IFMS
Within 45 days of booking		80% of BSP + 50% of Additional charges except IFMS
On offer of possession		5% of BSP + IFMS

Flexi Payment Plan

At the time of booking		10% of BSP
Within 30 days of booking		30% of BSP
On Foundation of block		10% of BSP + 50 % of Additional charges except IFMS
On casting of 2nd floor roof slab		10% of BSP + 50 % of Additional charges except IFMS
On casting of 5th floor roof slab		10% of BSP
On casting of 8th floor roof slab		10% of BSP
On casting of 10th floor roof slab		10% of BSP
On completion of masonry and plaster work		5% of BSP
At the time of offer letter for possession		5% of BSP + IFMS



- Registration Expenses, Stamp Duty, Legal Charges, Court Fee, Documentation charges etc shall be payable extra at the time of possession.
- Individual meter connection charges, along with proportionate cost towards load, supply, security deposit prepaid billing & monitoring etc shall be charged extra at the time of possession as decided by the company.
- The recurring monthly costs shall be borne by the Allottee on Super Area basis or as per actual s/units consumed on the unit rates as decided by the Maintenance Agency/Company.
- Two Years Advance Maintenance Charges (AMC) shall be used to provide Complete Maintenance & Facility Management services viz Campus Security, common area house keeping & garbage disposal, Horticulture, Maintenance of lifts, Generators, Water Pumps & Filtration



RECKS