



**the corporate address of sohna road, gurgaon**



MOETS: COMING SOON

IRIS

ZBRICKS

# location map

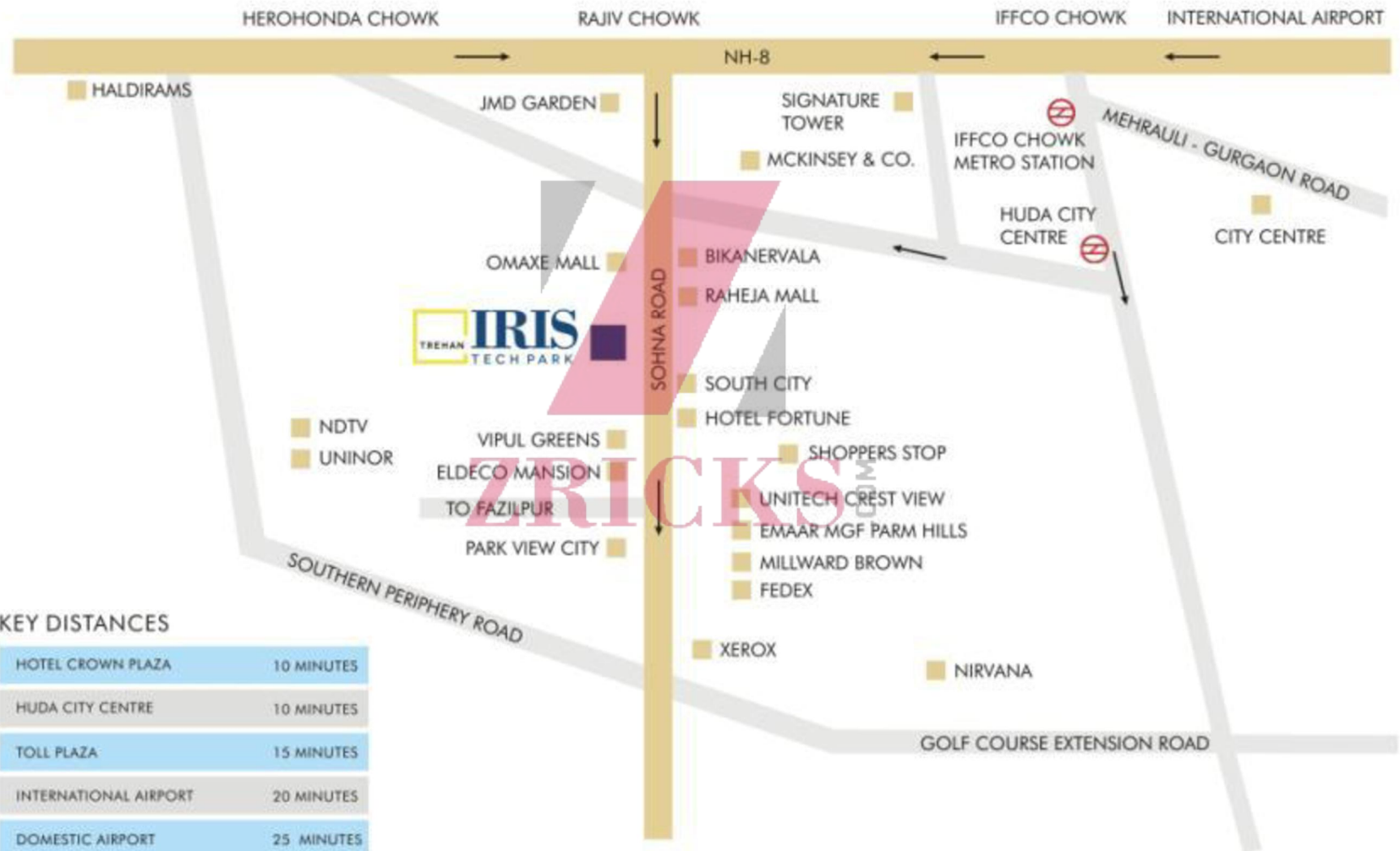

## KEY DISTANCES

HOTEL CROWN PLAZA	10 MINUTES
HUDA CITY CENTRE	10 MINUTES
TOLL PLAZA	15 MINUTES
INTERNATIONAL AIRPORT	20 MINUTES
DOMESTIC AIRPORT	25 MINUTES



- OCCUPIED AREA
- UNOCCUPIED AREA
- COMMON AREA

**TECK PARK**  
GROUND FLOOR PLAN

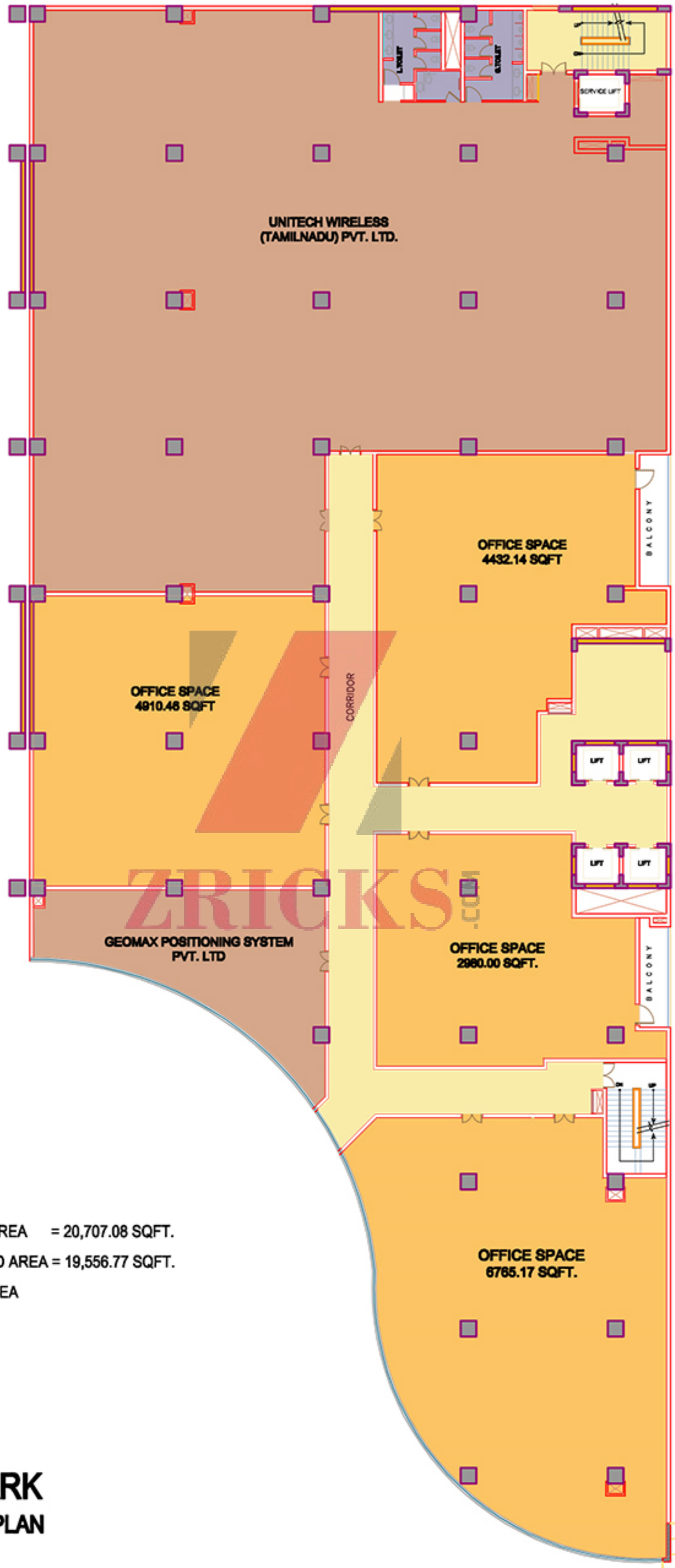

- OCCUPIED AREA = 20,707.08 SQFT.
- UNOCCUPIED AREA = 19,556.77 SQFT.
- COMMON AREA

**TECK PARK  
2ND FLOOR PLAN**

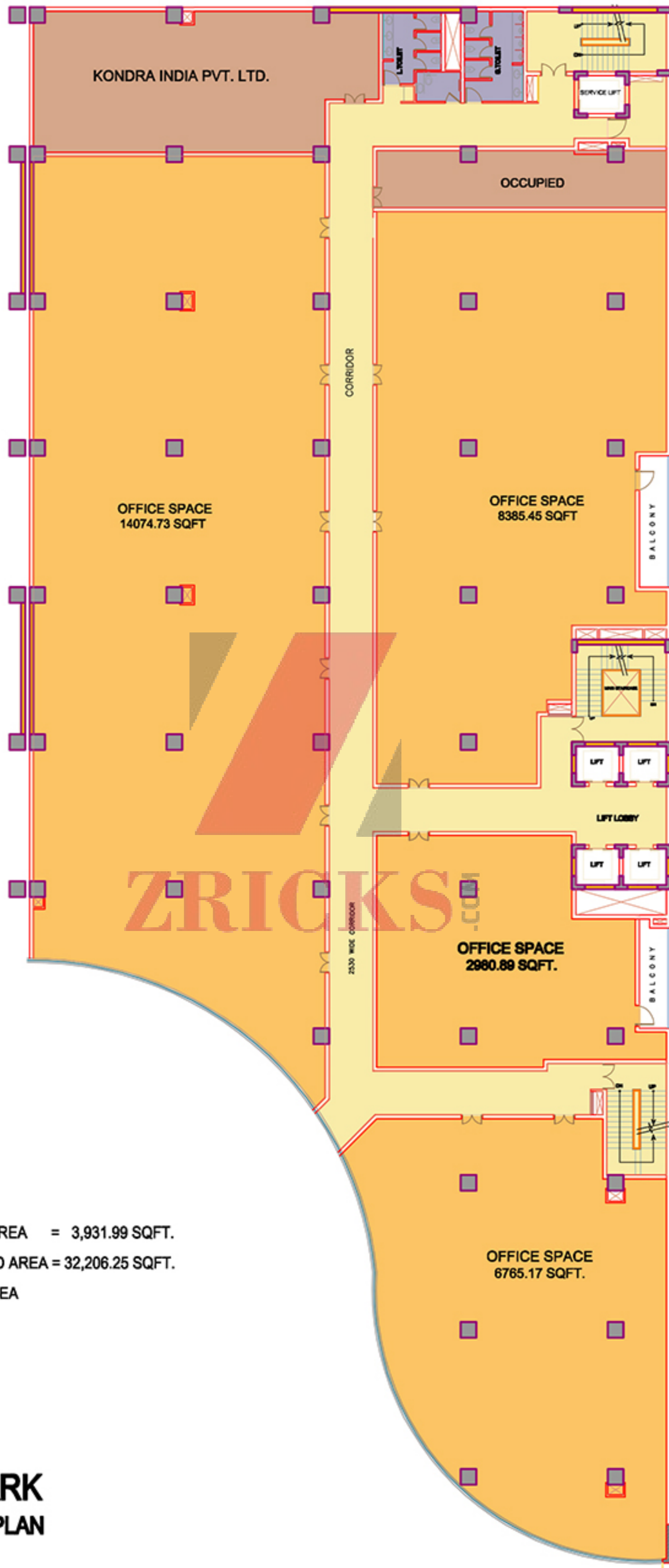

- OCCUPIED AREA = 3,931.99 SQFT.
- UNOCCUPIED AREA = 32,206.25 SQFT.
- COMMON AREA

**TECK PARK  
3RD FLOOR PLAN**

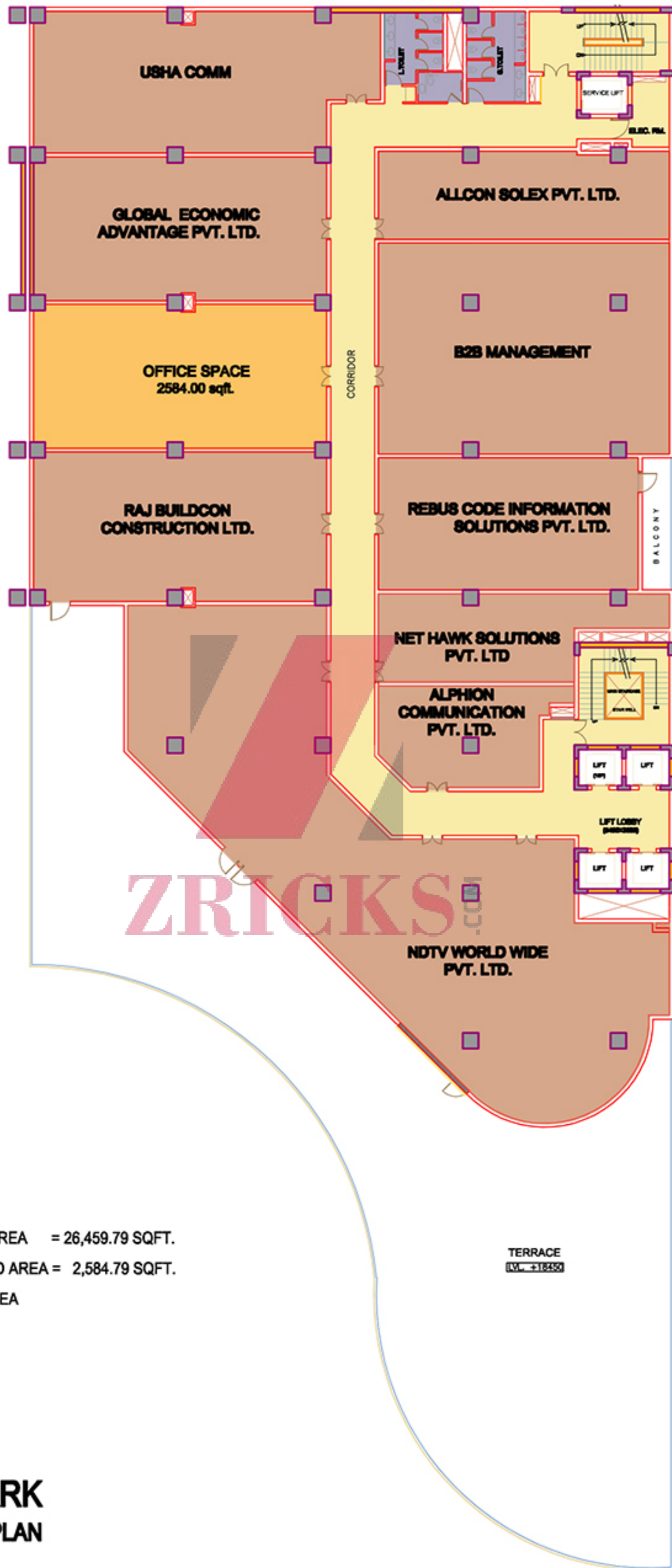

- OCCUPIED AREA = 26,459.79 SQFT.
- UNOCCUPIED AREA = 2,584.79 SQFT.
- COMMON AREA

**TECK PARK  
4TH FLOOR PLAN**

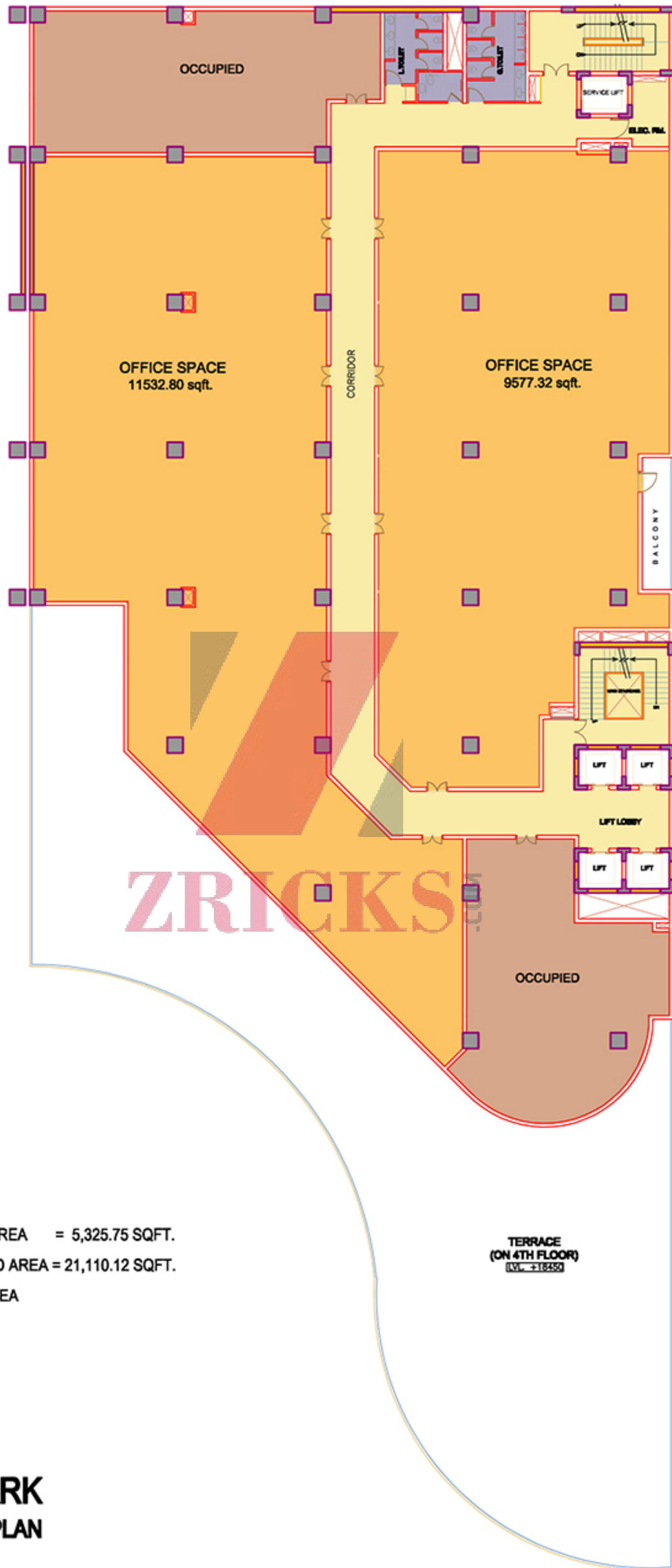

- OCCUPIED AREA = 5,325.75 SQFT.
- UNOCCUPIED AREA = 21,110.12 SQFT.
- COMMON AREA

**TECK PARK  
5TH FLOOR PLAN**



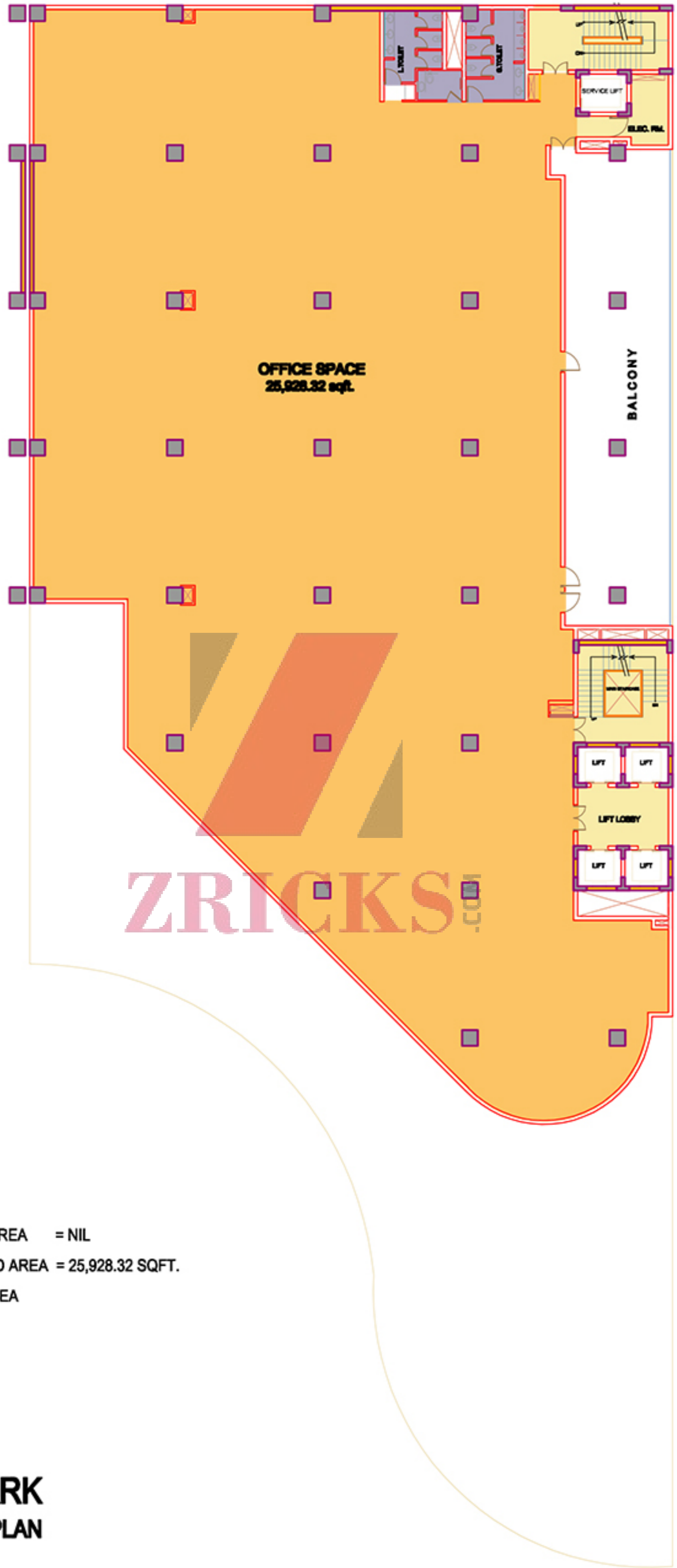

- OCCUPIED AREA = NIL
- UNOCCUPIED AREA = 25,928.32 SQFT.
- COMMON AREA

**TECK PARK  
6TH FLOOR PLAN**

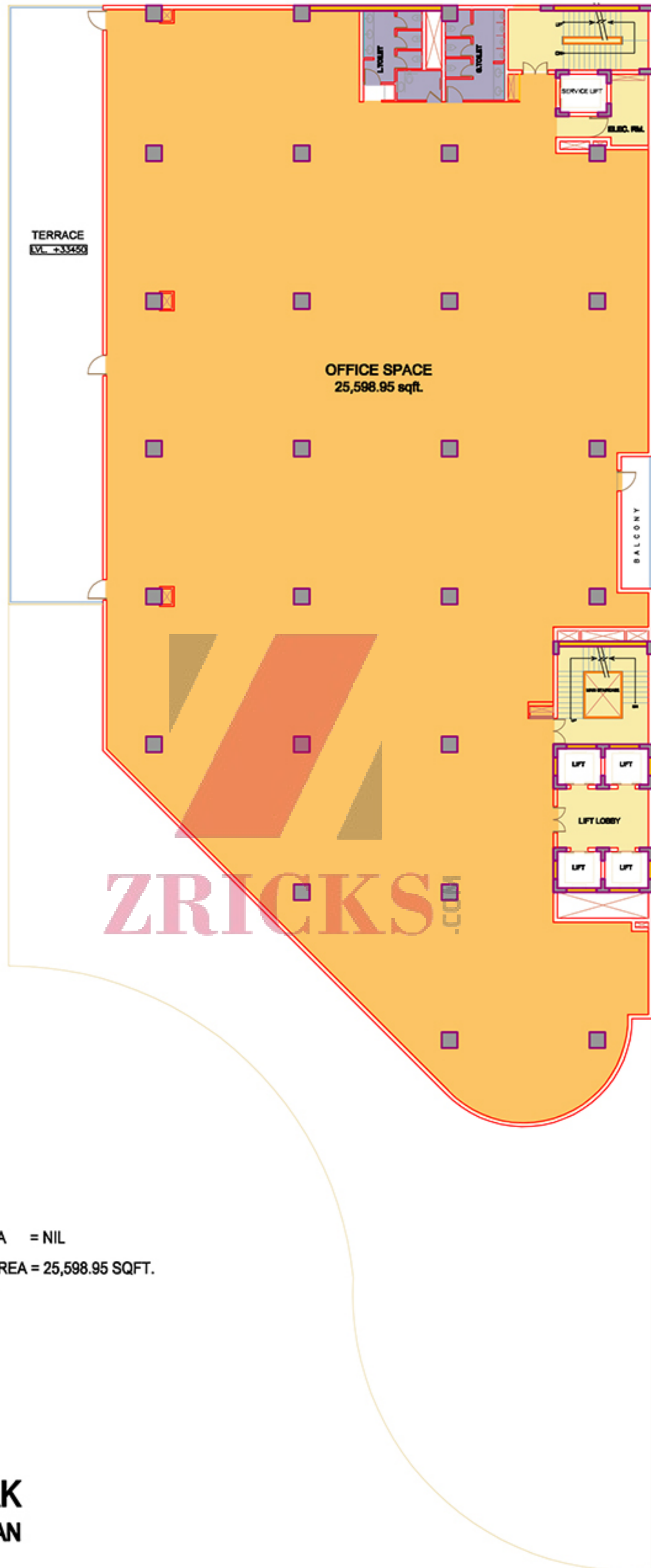

- OCCUPIED AREA = NIL
- UNOCCUPIED AREA = 25,598.95 SQFT.
- COMMON AREA

**TECK PARK**  
**8TH FLOOR PLAN**

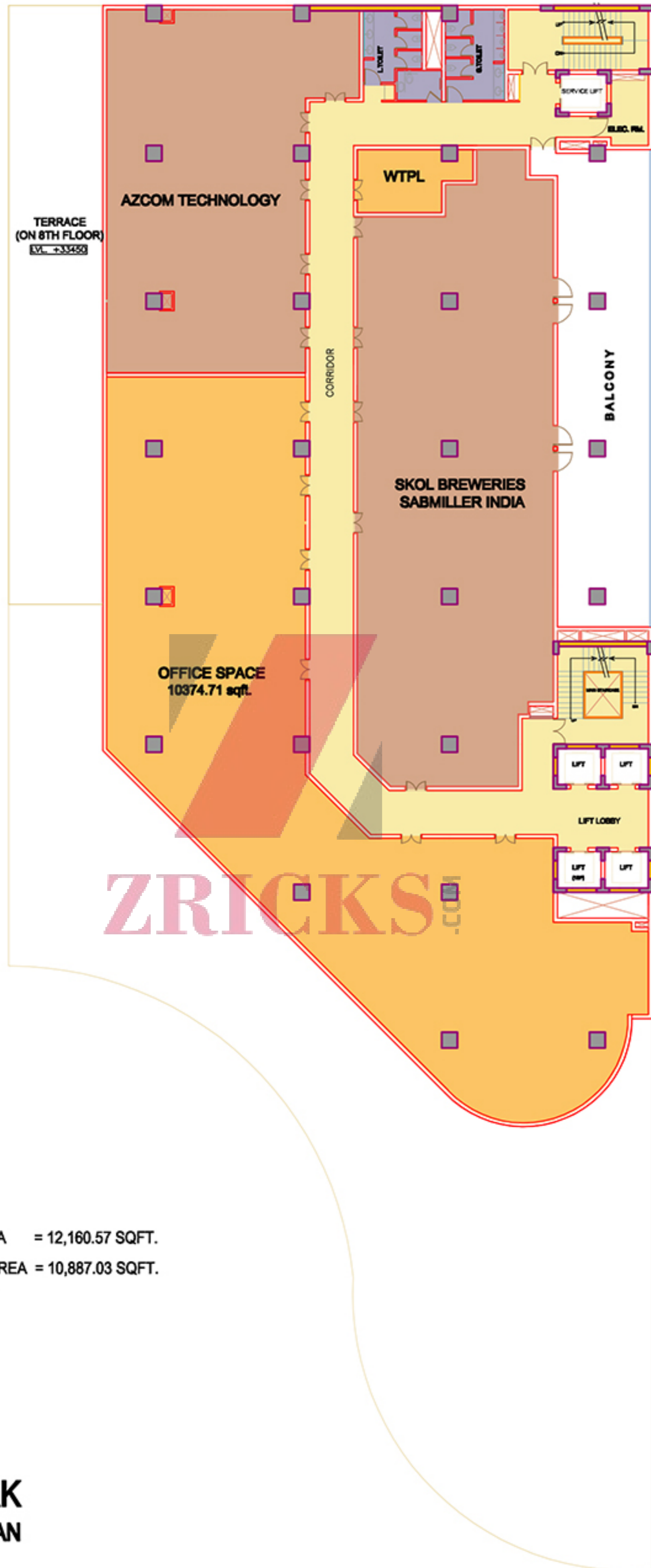

- OCCUPIED AREA = 12,160.57 SQFT.
- UNOCCUPIED AREA = 10,887.03 SQFT.
- COMMON AREA

**TECK PARK**  
**9TH FLOOR PLAN**

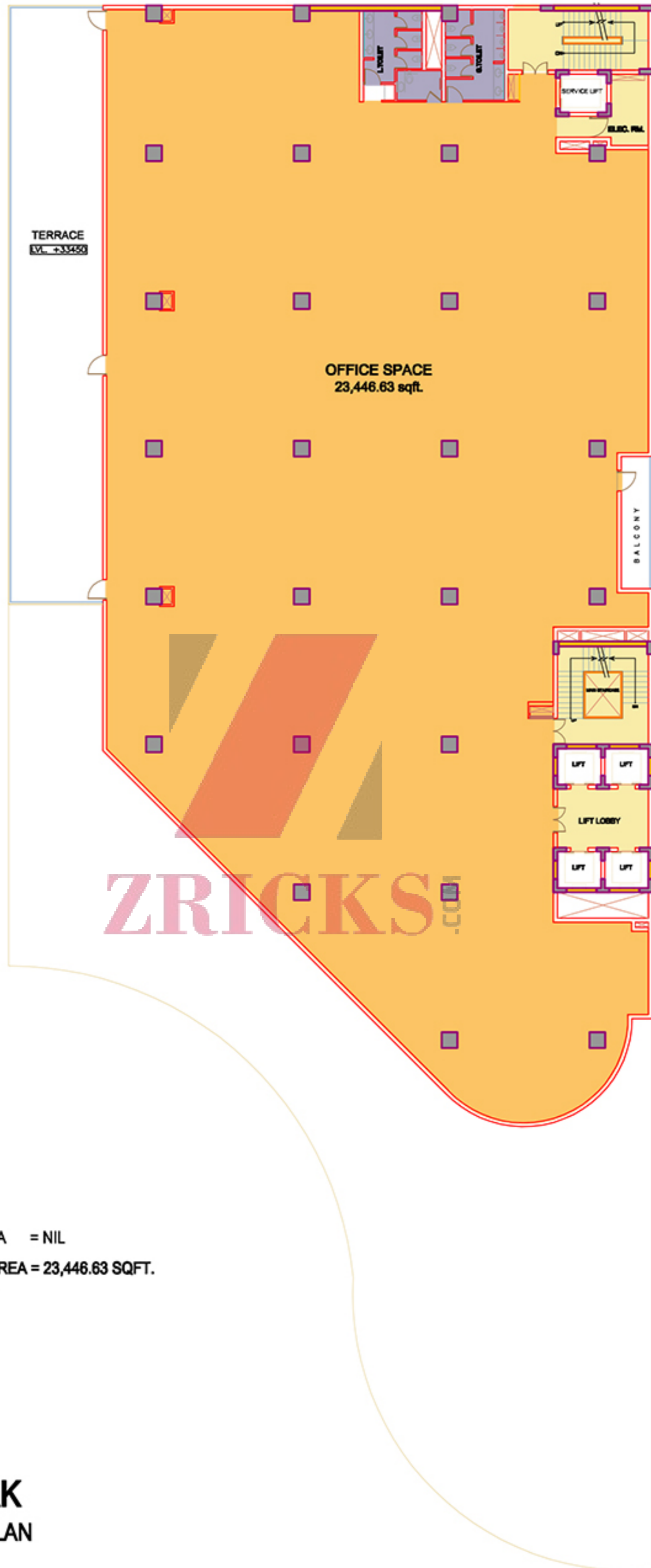

- OCCUPIED AREA = NIL
- UNOCCUPIED AREA = 23,446.63 SQFT.
- COMMON AREA

**TECK PARK**  
10TH FLOOR PLAN

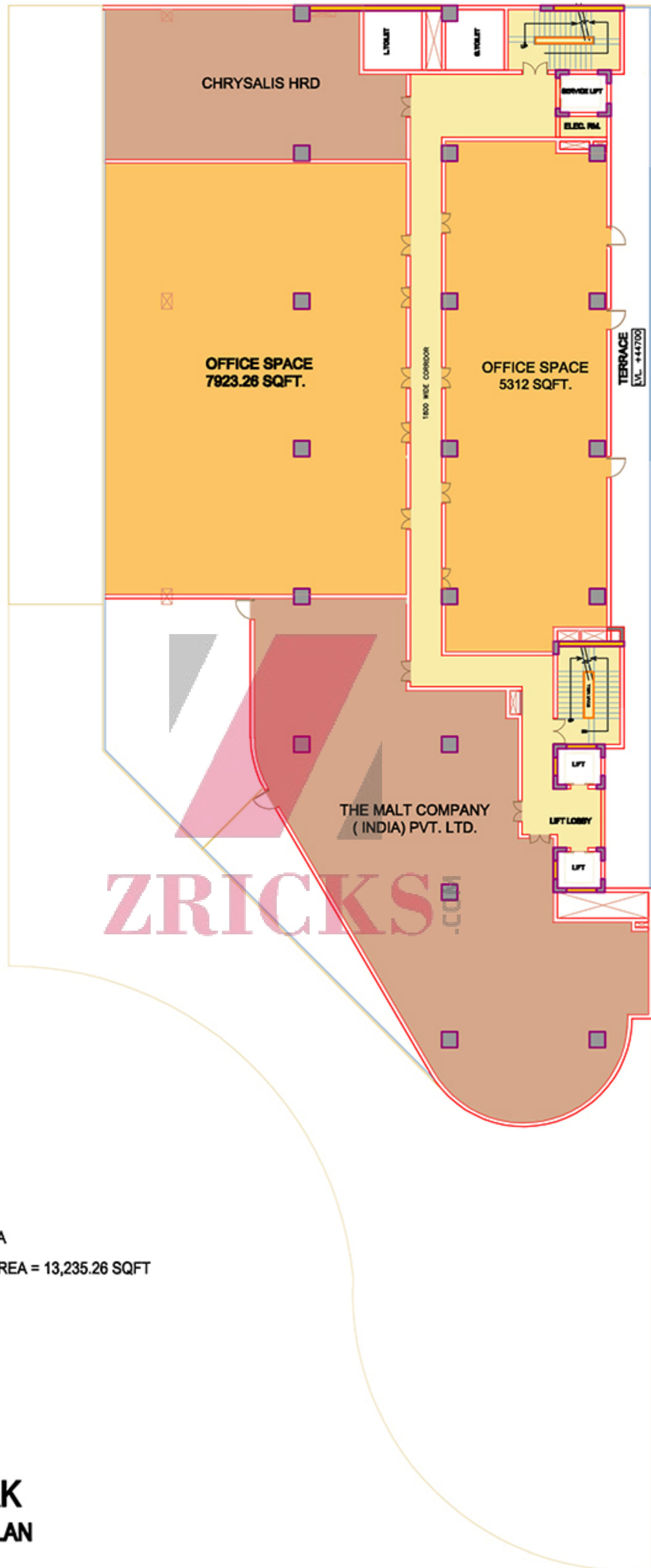

- OCCUPIED AREA
- UNOCCUPIED AREA = 13,235.26 SQFT
- COMMON AREA

**TECK PARK**  
**11TH FLOOR PLAN**

ZRICKS .COM

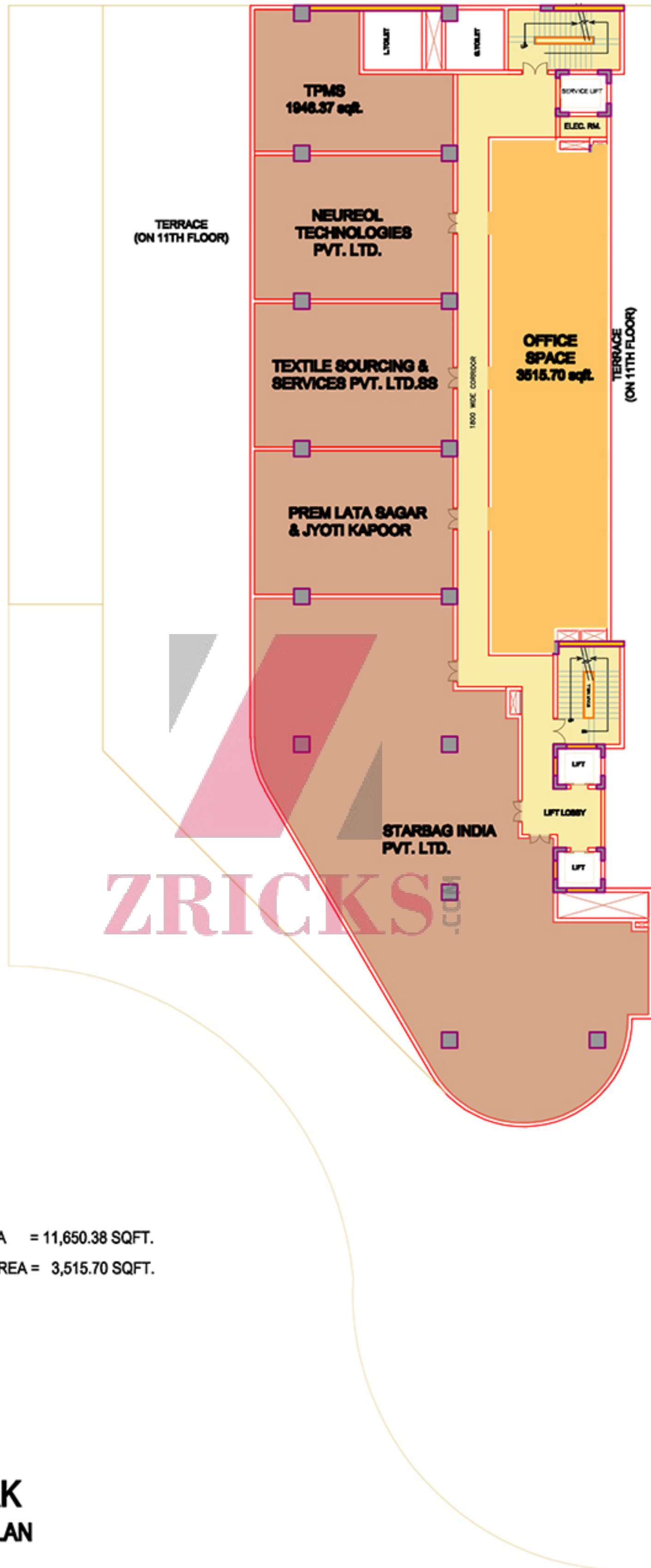

- OCCUPIED AREA = 11,650.38 SQFT.
- UNOCCUPIED AREA = 3,515.70 SQFT.
- COMMON AREA

**TECK PARK**  
**12TH FLOOR PLAN**



**ZRICKS**



ZRICKS



IRIS  
TECH PARK

ZRICKS





ZTRICKS



**arrive to work in style**

- Located at the city's commercial nerve center - Sohna Road
- An integrated architectural building consists of three exquisitely designed towers spread over 5 acres of area
- Designed by the awarded & well acclaimed architectural firm - Sikka Associates Architects
- 360° solution for clients offering fully customized office spaces
- The brand, IRIS, is a preferred office solutions provider for more 50 brands across all industries

TOWER A



TOWER B



TOWER C

**IRIS**  
TREHAN  
TECH PARK

A stylized letter 'Z' logo composed of three overlapping geometric shapes: a dark grey triangle on the left, a purple parallelogram in the center, and a dark grey triangle on the right.

**glimpse of iris techpark**

**ZRICKS**.COM



**ZRICKS**  
COM

**open span corridors**





**ZRICKS**

**designer interiors**



ZRICKS

**customised offices**

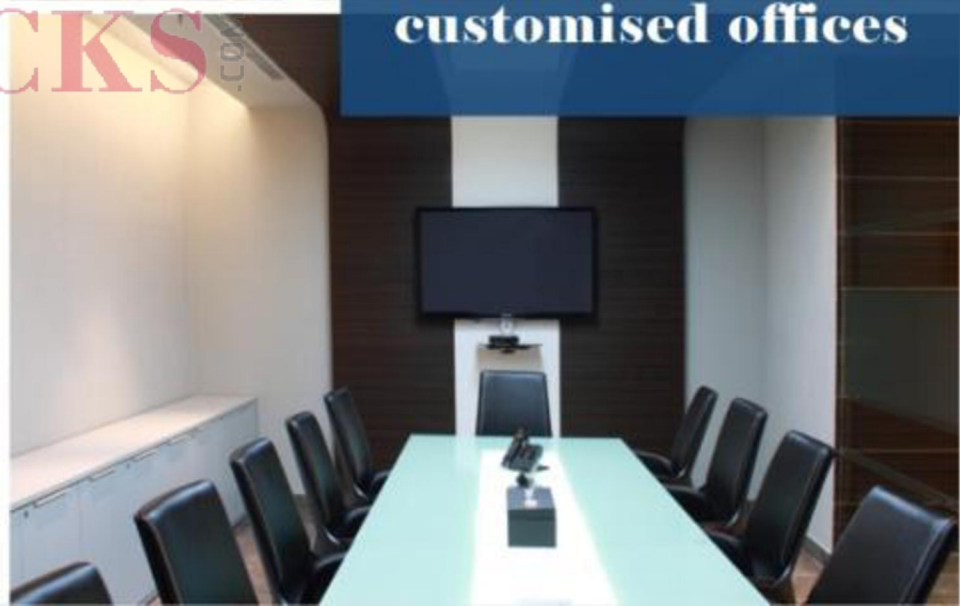





ZRICKS.COM

## cutting-edge infrastructure and backup facilities

- 100% power backup
- Designed as per seismic zone IV
- Centralized air-conditioning system
- Intelligent fire protection system
- Ample closed and open parking
- Multi-level basement parking with connecting elevators
- Impressive drop offs & common lobbies, finished with granite, marble etc.
- Public address and voice communication system
- Separate passenger and service/ freight lifts for each floor
- Individual electrical distribution board and metering for each floor



**refresh, revive & recharge**

ZRICKS.COM

- Functional Coffee Shop
- Lounge Bar
- Food Court
- Multi-cuisine restaurant
- Packed Lunches round the clock already available 24x7 to clients
- Bank & ATM on Ground Floor

# project details



## DEVELOPMENT DETAILS – BLOCK A

Total Development	3,36,000 sq.ft.
Total Number of Floors	3 Basements + Ground + 10 floors
Average Floor Plate Size	35, 000 sq.ft. approximately
Floor to Floor Height	3.75 mtrs. (Ground floor – 6 mtrs.)
Column Grid Size	9 X 9 mtrs.
Floor Loading Capacity	500 Kg/ sq.mtr.
Power Load	4500 KVA
Power Back Up	2 DG sets of 1500 KVA + 1 DG set of 1000 KVA + 1 DG set of 500 KVA (Sudhir Gensets – Cummins make)
Air-Conditioning	100%, 3 chillers of 30 TR each (Trane make)
Elevators	4 Passenger + 1 Service elevators (Thyssen make -20 PAX)
Car Parking	400 car parks across 3 basements + 75 car parks for visitors
Fire Protection System	As per standard norms
Availability for Fit Outs	Immediate

**join the company of  
FedEx, Lenovo, Xerox,  
HDFC, NDTV, Fujifilm  
on sohna road**



**ZRICKS**.COM

- Sohna road - Gurgaon, is one of the fastest growing business districts of Delhi NCR.
- Close proximity to NH 8 and excellent connectivity to Domestic & International airports.
- Access to well planned infrastructure of hotels, hospitals, shopping malls and residences

# clientele

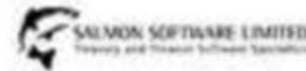
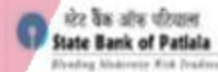

clientele



ZRICKS.COM



TANISHA SYSTEMS



# floor plan

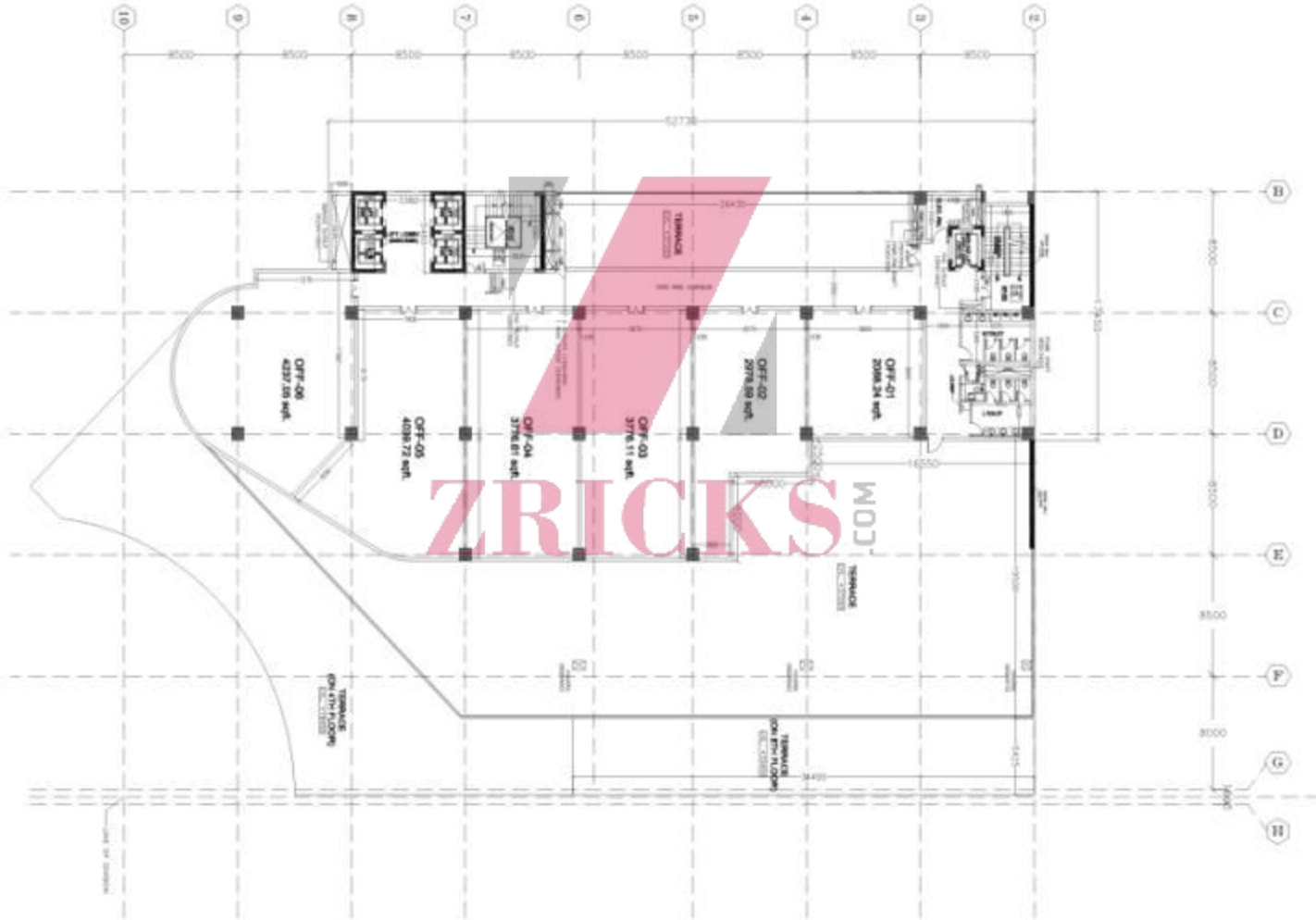



ZRICKS.COM

**the developers:  
trehan group**





**six decades of excellence**

**ZRICKS**.COM

actual executed project:

top left: IRIS Cyber Square, Udhyog Vihar

top right: IRIS Cyber Tower, Manesar

bottom left: IRIS Villas, Gurgaon

bottom right: IRIS Farms, Sohna Road

- Over 6 decades of unprecedented experience in the construction field
- A trusted brand with 3 generations of heritage
- Highly skilled staff with experience of over 15 years
- Leading government & private contractors with over 100 projects in Delhi & NCR
- More than 10 million sq. ft. area in prime locations of Delhi and NCR
- Professional end-to-end project management and delivery practices
- In-house quality control systems and processes with structured manuals to deliver excellence in quality
- Expertise in Group Housing projects, Hi-end residences, Farm Houses, Commercial Complexes, IT Parks, Hotels, etc.
- Footprints in North as well as South India with highly prestigious projects under development in Delhi, Gurgaon & Bangalore



**ZRICKS**.COM

**upcoming projects:  
for the lifestyle to come**

- Retail & Hospitality Project in Gurgaon
- Residential Group Housing in Bangalore
- Residential Group Housing in Jaipur
- Residential Group Housing in Faridabad
- I.T. City in Noida
- I.T. Park in Bangalore
- I.T. Complexes in Manesar
- Five Star Hotel in Bangalore
- Luxury Corporate Suites in Delhi & NCR

**self integrated**  
commercial park

MOETS

IRIS  
TECH PARK

ZIRICKS





ZRICKS.COM

IRIS  
TREHAN  
TECH PARK

ZRICKS COM



## **trehan promoters & builders pvt. ltd.**

corp. office: iris tech park, 808, tower a, sector 48, sohna road, gurgaon, haryana - 122018  
t: 011 4654 6260/70 f: 011 4654 6280 w: [www.trehanbuilders.com](http://www.trehanbuilders.com)

regd. office: e-26, (l.g.f) panchshila park, new delhi-110017  
[www.trehanbuilders.com](http://www.trehanbuilders.com)