



Discover
the privilege of
golf side
living





A home in nature's embrace

From the lush green surroundings to the breath-taking view to the intricate detailing of each home, these warm and spacious 2 and 3 BHK apartments at Arocon Golf Ville are indeed the quintessence of the good life. So if you love the luxury, then you'll feel right at home here. What's more, these homes adhere to the traditional principles of Vaastu Shastra which give harmony to your home and life.





Actual photographs of apartment

Actual photographs of apartment



Enjoy 
living at the
finest place

Arocon GolfVille is situated at 'Crossings Republik', an award winning 360 acre township designed by the world famous architecture firm from USA- 'Sasaki associates Inc'. This township offers spectacular facilities like a golf course, malls, retail-outlets, convenient shopping centers, office spaces, hospitals, nursery, primary and secondary schools, sports facilities, township clubs, three tier security, and 24hr electric and water supply. The project is strategically located on NH-24, just 25 km from 'Connaught Place' which is the center of the National Capital- Delhi. It is just 6 km from 'Electronic City', Noida and just 3 km away from Ghaziabad railway station.





World of 
 enchanting
 experiences

- Secured Township Entrance Gate
- Grand Central Plaza with fountains, subway and shopping centre
- Golf course with lake and lake side food courts
- Arterial and Central Landscape Greens
- Cycling Track • Jogging Track • 24hrs water supply
- Sector Level club with swimming pool and Gymnasium
- Kids' play area • Senior Citizen sitting lounge
- Neighborhood market • Power backup
- Tennis and Badminton courts
- Three tier Security – CCTV at Township Gate, Security guards at Sector Entrance and at Tower Entrance





- Structure** Earthquake resistant framed structure designed by highly experienced structural engineer and proof checked by IIT
- Electrical** ISI PVC conduits, ISI fire retardant multi strand electrical wires, Legrand or equivalent make MCB Boxes, MCBs, Philips or equivalent Modular switches, and video door phone. Designer Fans & Lights. Fall ceiling lights. Chandelier in Drawing Room.
- Walls & Ceiling finish:** POP Plaster and Fall Ceilings of Plaster of Paris in all Rooms, Dulux velvet Touch paint with putty will be applied on walls & ceilings in pleasing shades. Wall paper or Texture paint on one wall of each room.
- Flooring** 800 x 800 mm Designer Digital Polished Glazed Vitrified tiles with skirting in drawing / dining room & kitchen & Master Bed Room . 600 x600 mm Digital Polished Glazed Vitrified tiles in Bedrooms and 300 x300 mm ceramic tiles in wash rooms and balconies.
- Kitchen** Designer Modular Kitchen with chimney and Hob. Granite working top with stainless steel sink & faucet. Individual RO water system, ceramic tiles on 2 feet dado above working platform and up to 5 feet from floor level on remaining wall.

The following are the standard specifications of the Apartment. There may be slight modification/ alteration in the specification due to change in design/pattern/availability of certain materials.

Uncover **luxe** dimensions of delight



- Washrooms** Vanities with Wash Basin .Plumbing done with Prince / Astral or equivalent UPVC/PVC pipe. Ceramic Sanitary ware, designer wall tiles up to door/ Fall ceiling level, Supreme or equivalent CP fittings.
- Doors** Door frame of Size 8' & Section 6"x2.5" of Maranti Sinker wood with Dulux or Equivalent mat finish enamel. 32mm thick ISI waterproof laminated flush door shutter with good quality stainless steel hardware.
- Windows** Window frame of Section 6"x2.5" of Maranti Sinker wood with Dulux or Equivalent mat finish enamel. Good quality stainless steel hardware .Glass window shutter of Maranti wood with Dulux or equivalent mat finish enamel with good quality stainless steel hardware. Retro reflective Glazing & MS Grills.
- Staircase** Granite steps with MS railing.
- Exterior** Exterior coating of Dulux weathershield max or equivalent exterior emulsion.
- Cupboards** One Cupboard in Every Bed Room.

 **CROSSINGS**
Republik *Your city. Your life.*



Diamond 1 (3 BHK)

Super Area: 1880 Sq. Ft.
(174.65 Sq. Mt.)

- Drawing
- Dining
- Kitchen
- 3 Bedrooms
- 2 Washrooms
- 3 Balconies



Diamond 2 (3 BHK)

Super Area: 1600 Sq. Ft.
(148.64 Sq. Mt.)

- Drawing
- Dining
- Kitchen
- 3 Bedrooms
- 2 Washrooms
- 3 Balconies



Gold 1 (2 BHK)
 Super Area: 1350 Sq. Ft.
 (125.42 Sq. Mt.)



Gold 2 (2 BHK)
 Super Area: 1255 Sq. Ft.
 (116.59 Sq. Mt.)



**Diamond Block
Layout
Plan**

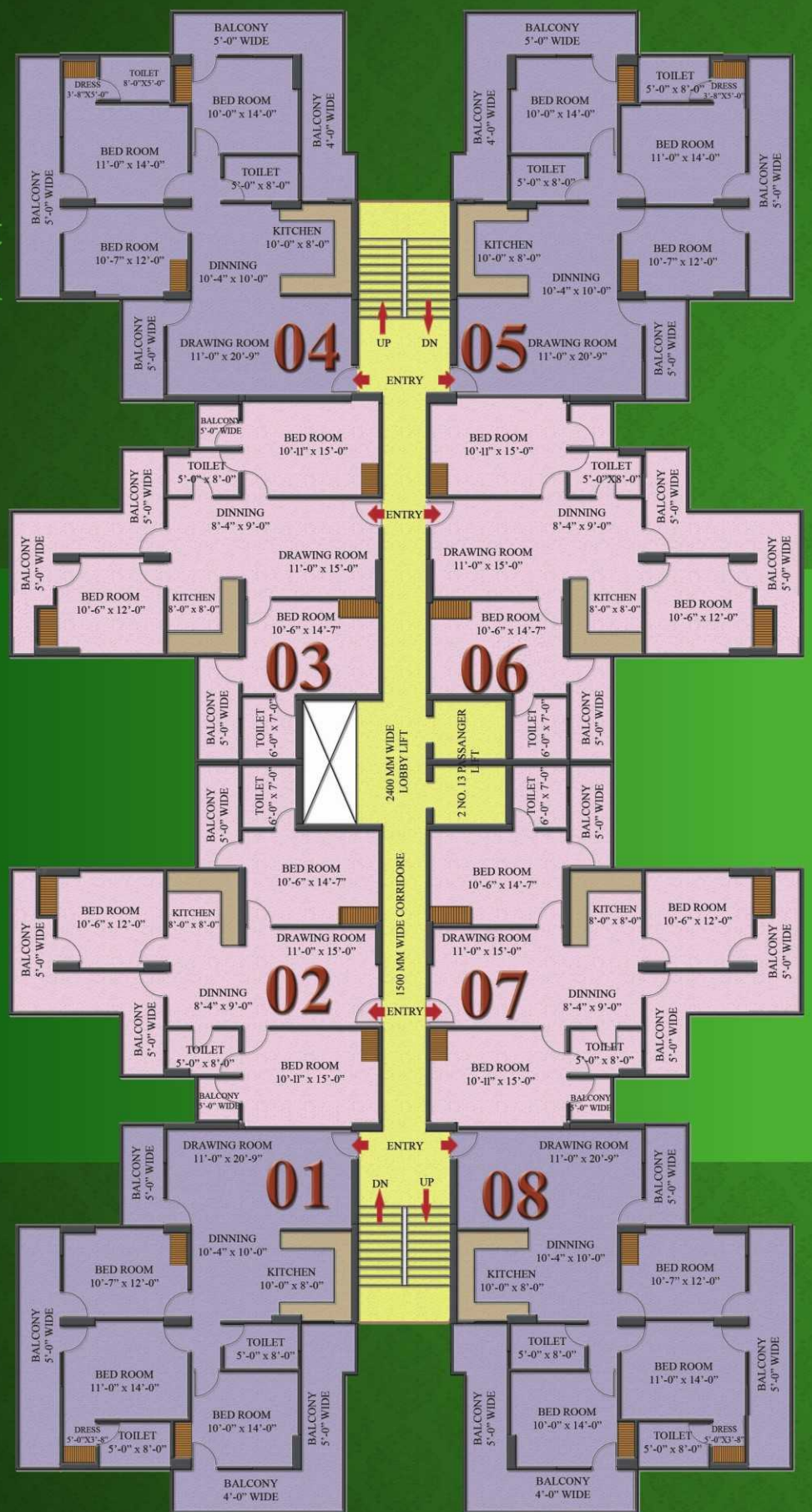

GOLF SIDE

CLUB SIDE

**Gold Block
Layout
Plan**



CLUB SIDE

ZRICK



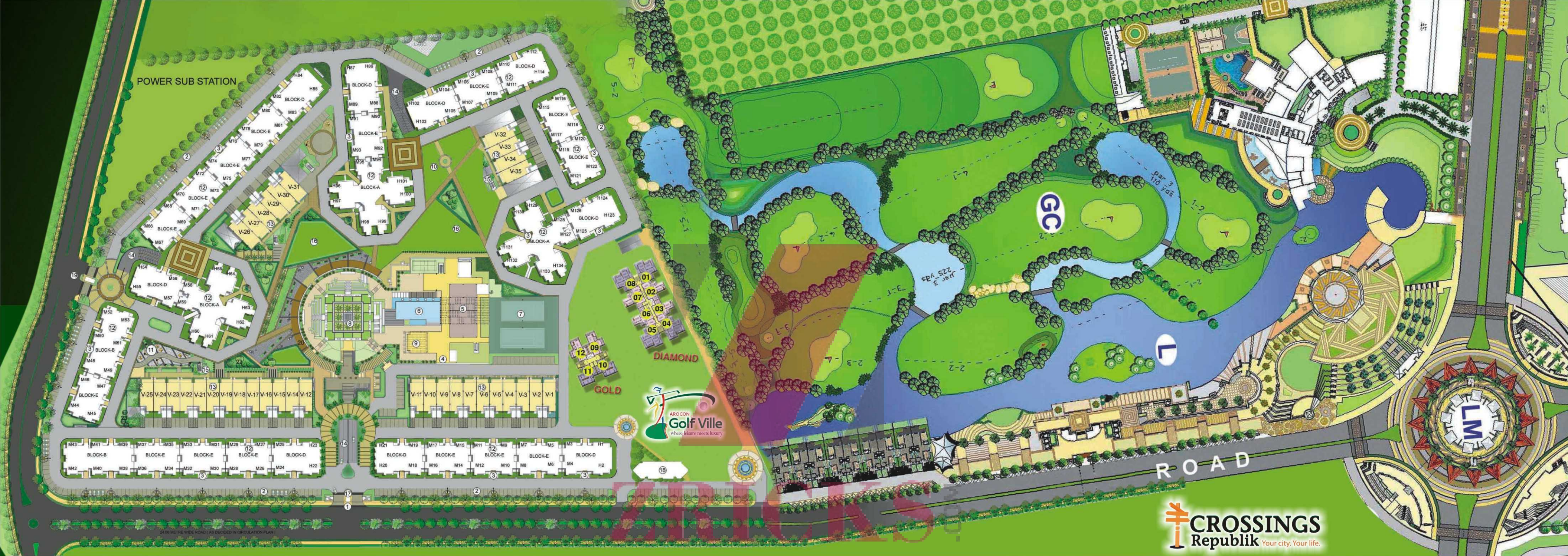

CROSSINGS
 Republik *Your city. Your life.*

Legends

- | | | | | | |
|-------------------------|------------------|---------------------------------|-------------------------------|----------------|--------------------------------|
| 1. MAIN ENTRY GATE NO.1 | 5. CLUB HOUSE | 9. GYM AT BASEMENT | 13. DUPLEX HOUSE | 17. GUARD ROOM | 21. GOLF COURSE(GC) |
| 2. OPEN PARKING | 6. SWIMMING POOL | 10. CONVENIENCES | 14. RAMP DOWN TO 1st BASEMENT | 18. COMMERCIAL | 22. MAIN ROUNDABOUT |
| 3. ENTRANCE TO BUILDING | 7. TENNIS COURT | 11. CHILDREN PLAY AREA | 15. FIRE ESCAPE STAIRCASE | 19. GATE NO.2 | 23. GOLF COURSE CLUB |
| 4. ENTRY TO CLUB | 8. SUNKEN GARDEN | 12. RESIDENTIAL APARTMENT BLOCK | 16. GREEN AREA | 20. LAKE(L) | 24. LAKE SIDE COMMERCIAL SPACE |



Exceptional Realty Solutions!

Arocon Real Estate Pvt. Ltd. has been established under the self-motivated supervision of Mr. Inderjeet Arora, Director (Ex Director Projects of Gaursons India Ltd.) & Mr. Rajiv Goel Director (IRSE Ex Deputy Chief Engineer/Indian Railway).

With the never say die attitude of our directors Mr. Inderjeet Arora and Mr. Rajiv Goel have brought the group at a standing which only existed in dreams at one point of time. We strengthened our existence in real estate by adapting cutting-edge technologies and powerful policies that have added many dimensions to the growth of the company.

Mr. Inderjeet Arora has done B. E. from Delhi College of Engineering which has helped him deal and guide his group with technical assistance. Mr. Rajiv Goel has done M. Tech in Structural Engineering from Delhi College of Engineering and his rich experience in planning, design and execution of various projects will make him successful in implementing the multistory group housing projects.

We have earlier constructed Designer Builder apartments of 3 & 4 BHK in the name and style of Arocon Apartments and Desire Residency.

OUR DELIVERED PROJECT **Desire Residency**
2 & 3 BHK Apartments, Indrapuram



Road Map

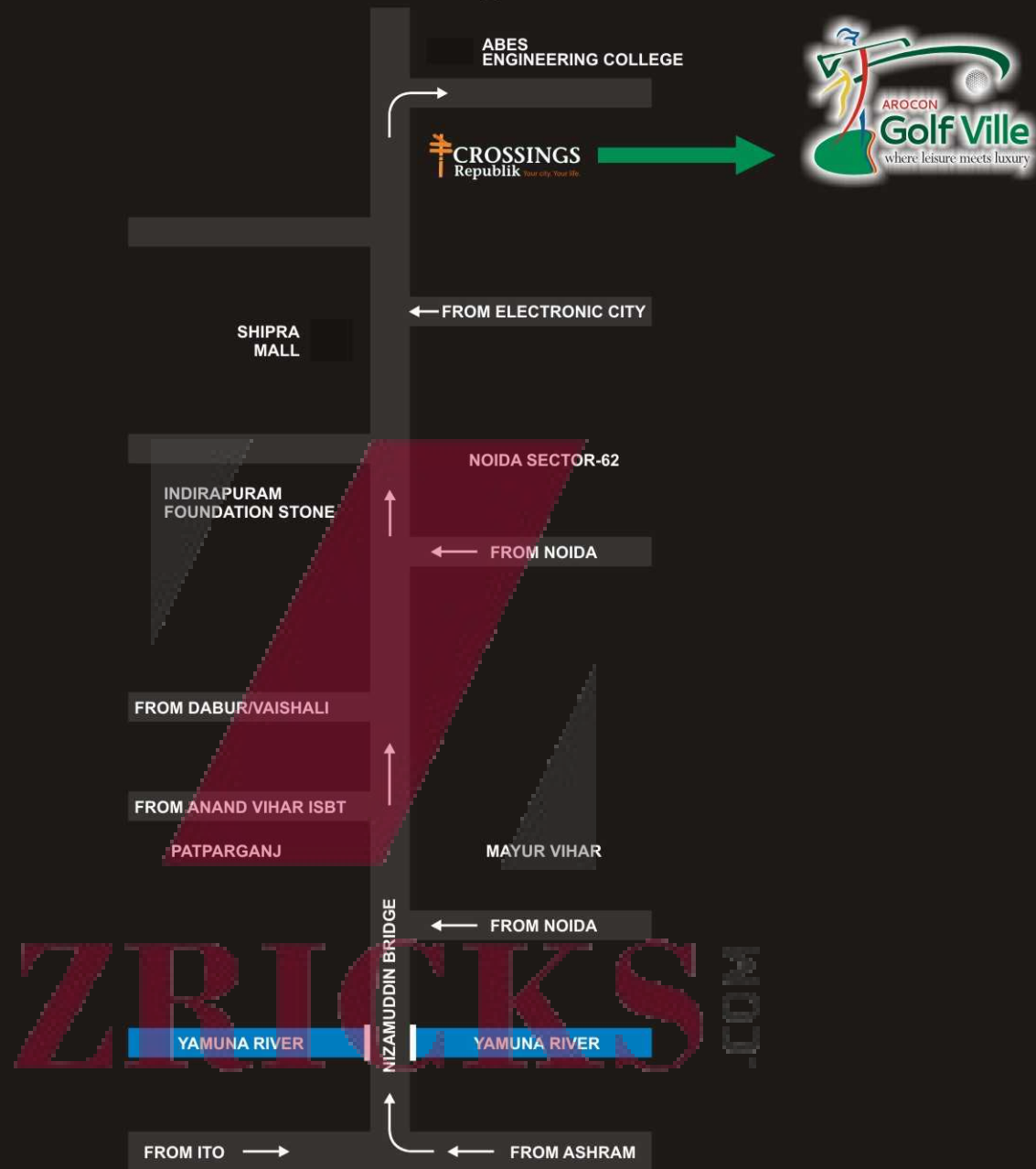

LOCATION ADVANTAGES

0 KM SHOPPING CENTRE	3 KM GHAZIABAD RAILWAY STATION COLUMBIA ASIA HOSPITAL	8 KM SHIPRA MALL NOIDA CITY CENTRE METRO STATION	8 KM FORTIS HOSPITAL SECTOR 61, NOIDA	10 KM ANAND VIHAR RAILWAY STATION METRO STATION, ISBT	25 KM NEW DELHI RAILWAY STATION CONNAUGHT PLACE
--------------------------------	--	---	--	--	--



AROCON REAL ESTATE PVT. LTD.

GH-7, Crossings Republik, NH-24, Ghaziabad • Ph.: 9582289096, 9582289097 • email: arocongolfville@gmail.com • www.arocon.in