



CAPITAL GREENS

B H I W A D I

LIVE GREEN, LIVE BLISSFULLY

ZRICKS.COM





Live Green, Live Blissfully

After the successful development of the commercial projects, R-Tech Group has now entered into the residential segment, keeping in mind all the interests of end-users from all walks of life. Its first residential offering is a delightfully beautiful group housing project called **“Capital Greens”**.

Spread over 10.25 acres, Capital Greens is first of its kind in Bhiwadi having all facilities including Club, In-Door Games, Podium Parking, Swimming Pool, Jogging Track and a lush green Park. It is specifically targeted at our esteemed customers and end users across Delhi (NCR), Gurgaon, Bhiwadi & Alwar.



CAPITAL GREENS

BHIWADI

Highlights

- Secured Complex
- 1, 2 & 3 Bedroom Apartments
- Badminton Court
- Kids Play Area
- Fountain
- Theme Garden
- Jogging Track
- Club
- Swimming Pool
- Car Parking



Artistic View of Entrance



Location

- Strategically located within close to NH-71 B & NH-8
- 180 Kms Rapid Metro pass through Bhiwadi.
- Within close proximity of 4 Star Hotels, Wellness Centers, well established Hospitals & Health care, Quality education centers and Entertainment facilities
- Many national & international industries have moved into bhiwadi & some of them are Honda Cars, Honda motorcycle & scooters, Saint Gobain, Pepsi, Jaquar, Bausch Lomb, Gillette India & other Bluechip companies.



Artistic View

Distance Chart

• Dhaula Kuan (Delhi)	55 Minutes
• IGI Airport	50 Minutes
• Gurgaon	30 Minutes
• IMT Manesar	20 Minutes
• Dharuhera	05 Minutes
• Neemrana	40 Minutes
• Jaipur	2.5 Hours
• Rewari Railway Station	15 Minutes
• DTC Bus Service available	



Location Map

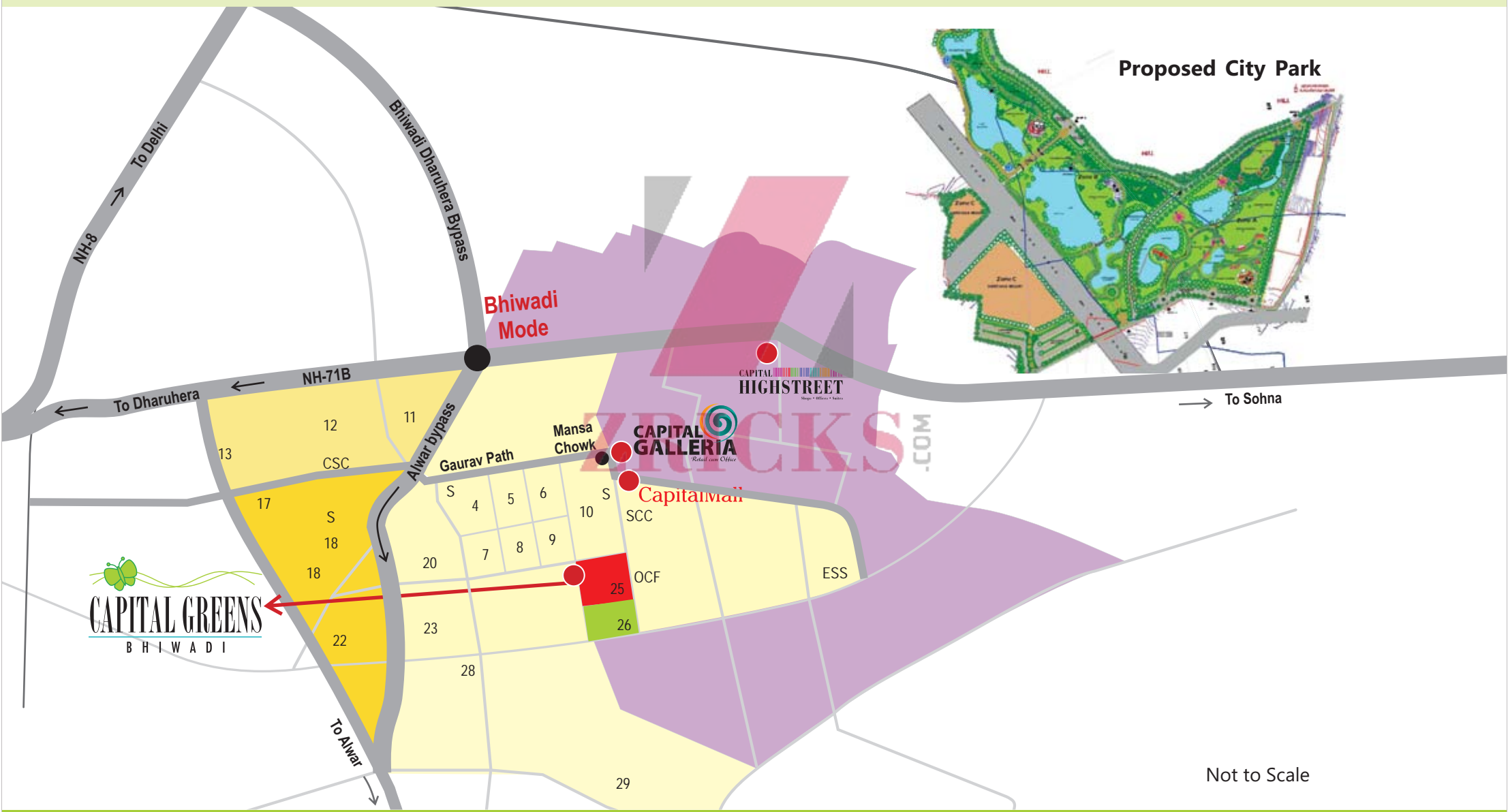



CAPITAL GREENS

B H I W A D I



Artistic View Central Park



Specifications

- Super Structure** : Earthquake resistant RCC frame structure. Brick work in cement & mortar.
- Bedroom** : Vitrified Tiles.
- Flooring** : Vitrified tiles in drawing/dining.
Ceramic tiles in Kitchen, Toilets and Balconies.
- Doors & Windows** : Wooden frames with painted doors. Powder coated aluminum doors & windows.
- Kitchen** : Granite top working platform. Stainless steel sink with drain board. Ceramic glazed tiles dado 2' above working platform.
- Toilets** : Non skid ceramic floor tiles, ceramic tiles upto 7' on walls. English WC. Provision of hot and cold water. Good quality of CP Fittings, Soap dish, towel rail and looking mirror.
- CP Fittings** : Jaquar or equivalent
- Inside Wall Finish** : Inside walls in oil bound distemper. POP cornice in drawing room / dining hall and all Bedrooms.
- External Facade** : Exterior in superior maintenance free finish.
- Electrical** : Copper wiring in concealed PVC conduits. Sufficient light and power points. Provision for TV and telephone point in living room and all bedrooms. Ready Internet Connectivity.



Not to Scale

Legends

1. Entry
2. Exit
3. Drop off
4. 1B+1T Unit
5. 2B+2T Unit
6. 2B + 2T + ST Unit
7. 3B+3T Unit
8. BADMINTON COURT
9. RAMP FOR PODIUM
10. FOUNTAIN
11. KIDS PLAY AREA
12. SHOPPING COMPLEX
13. THEME GARDEN
14. JOGGING TRACK
15. CENTRAL GREEN
16. CLUB
17. SWIMMING POOL
18. S.T.P.
19. CAR PARKING

Note: The site layout plan is not a legal document. It is tentative and describes the conceptual plan to convey the intent and purpose of Capital Greens. The layout is subject to variations and modification as decided by the architect/Company.



Tower Plans

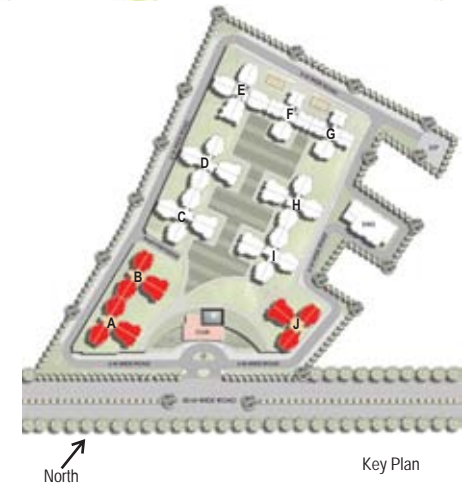
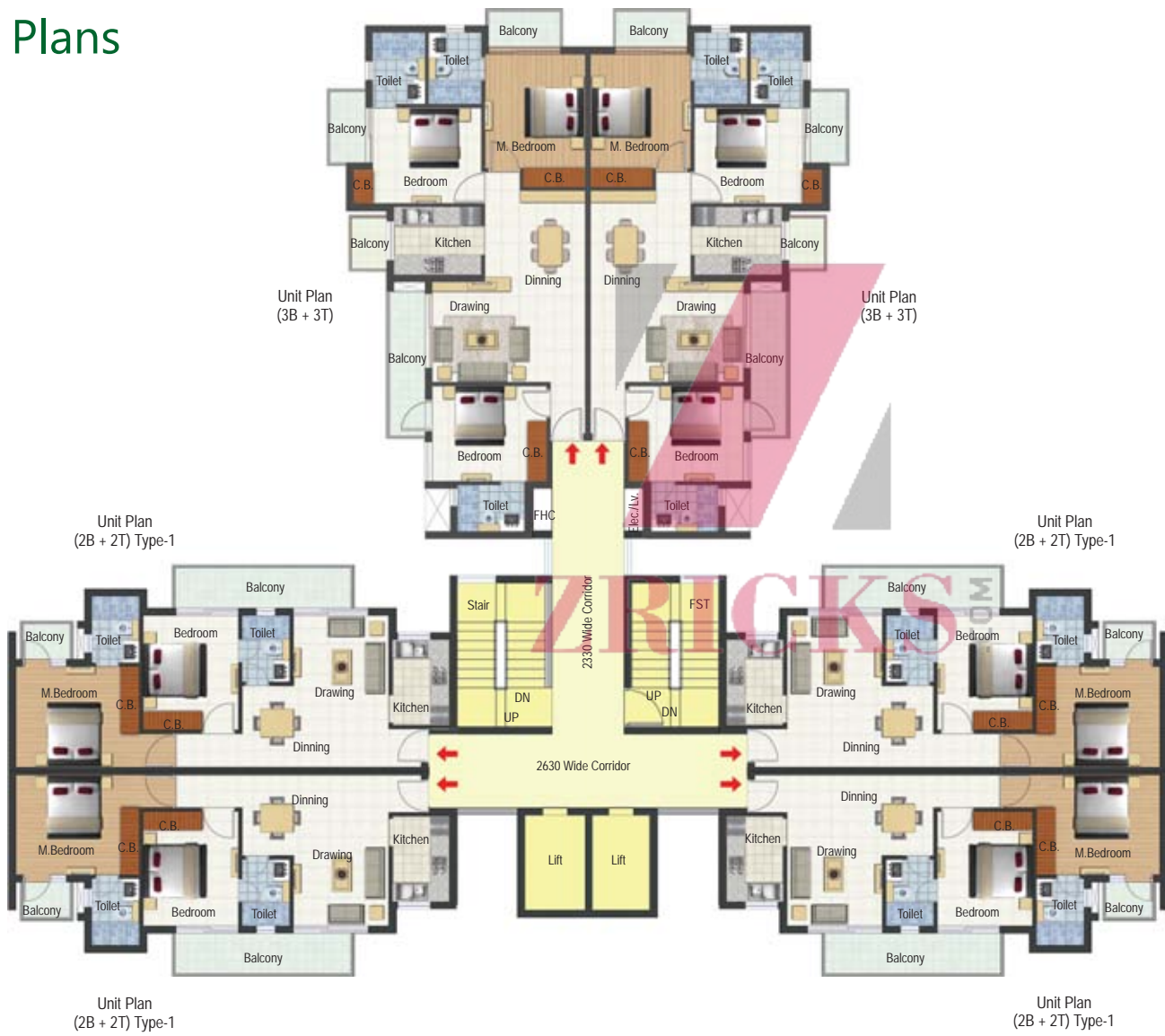

Tower A, B (S+20) & J (S+14)

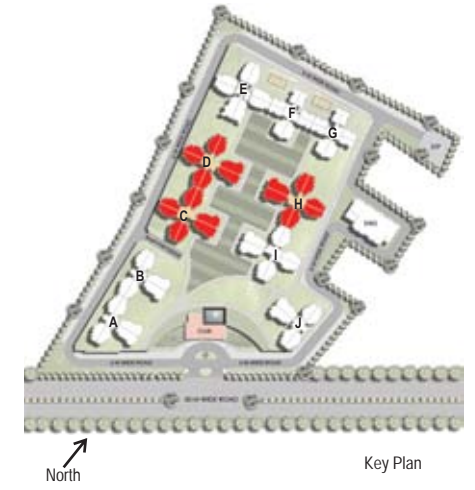
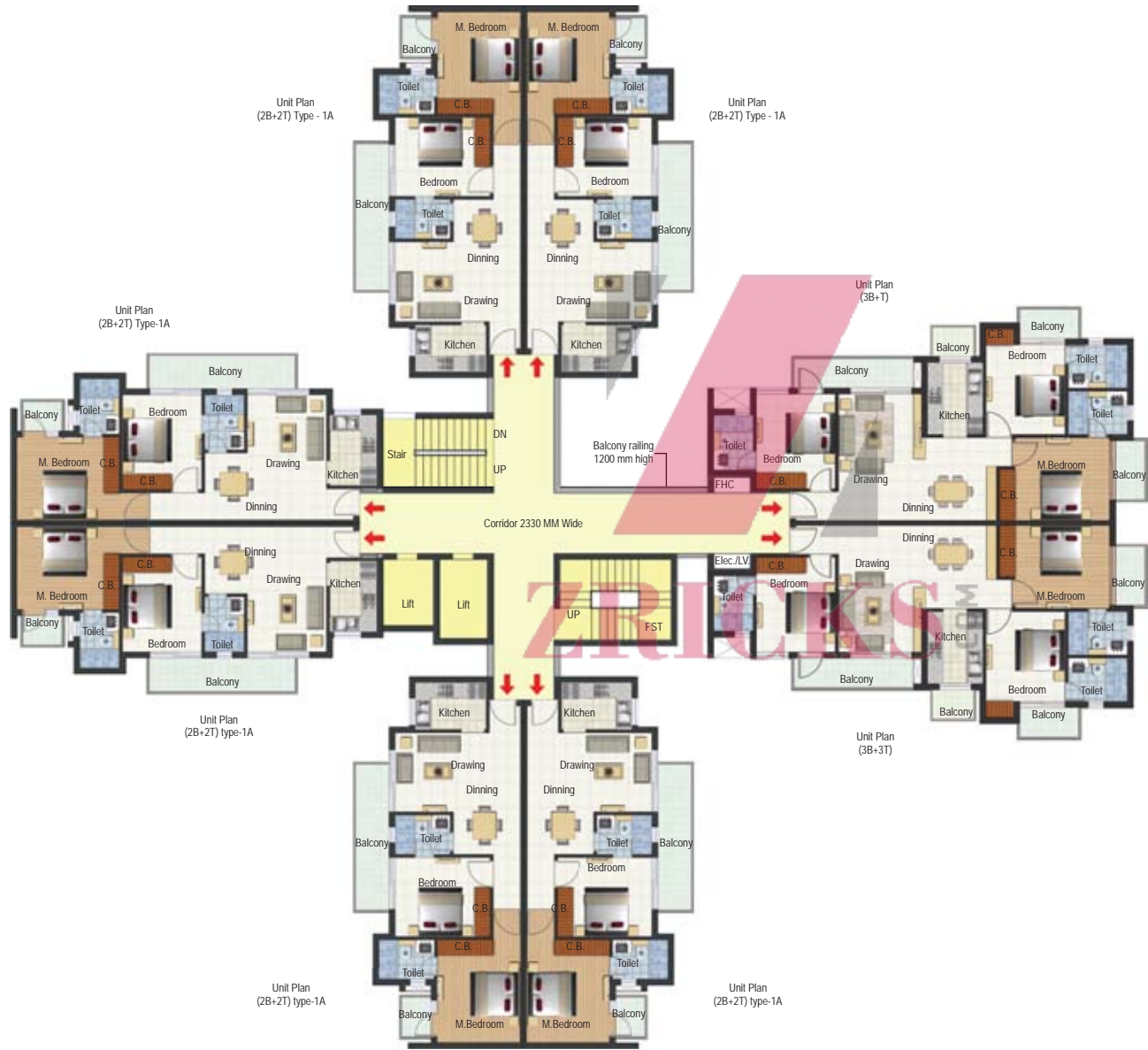

Tower C, D & H (S+14)

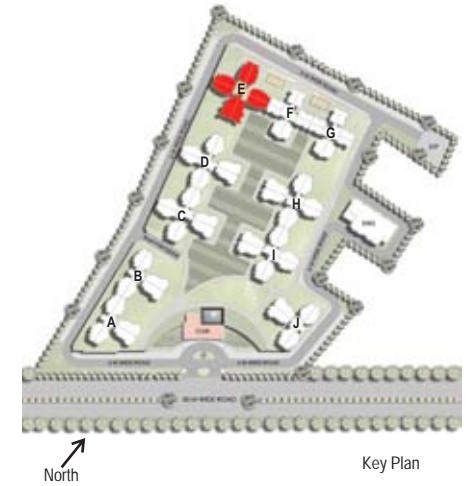
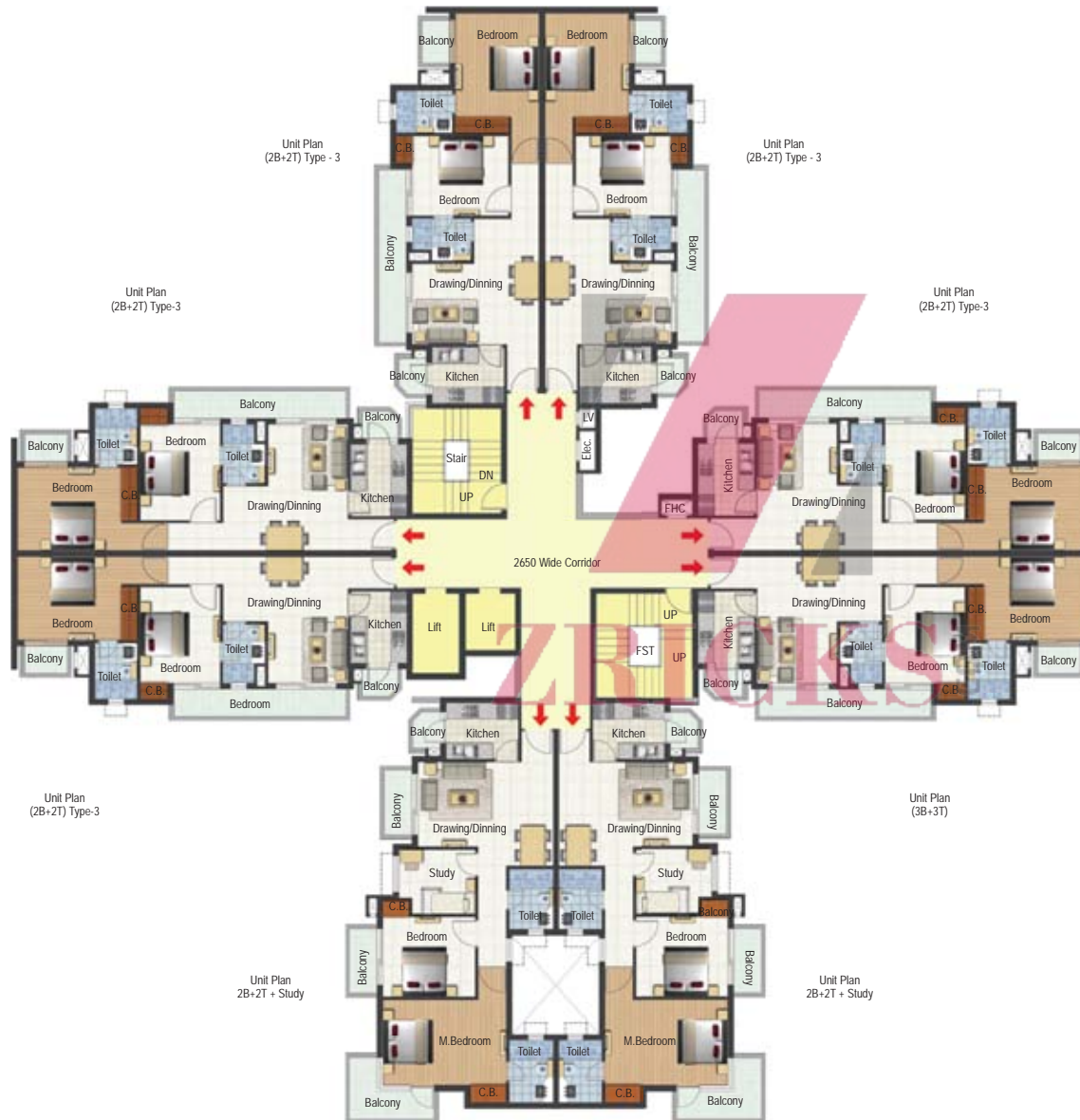

Tower E (S+14)

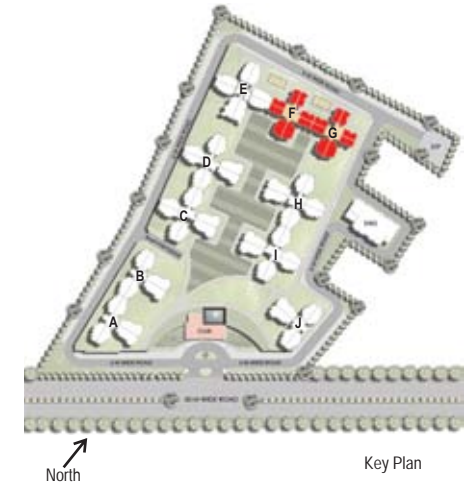
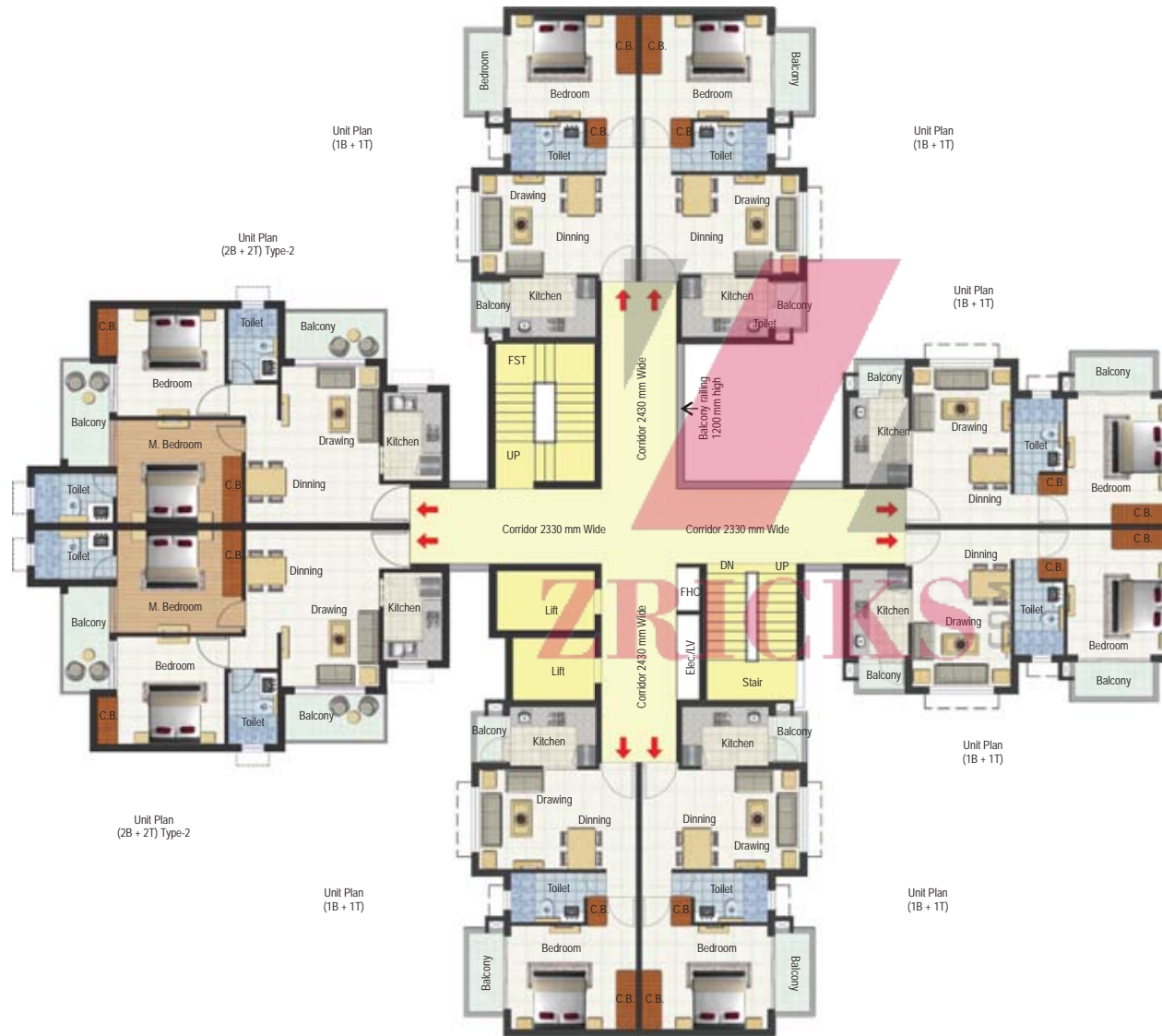

Tower F & G (S+14)

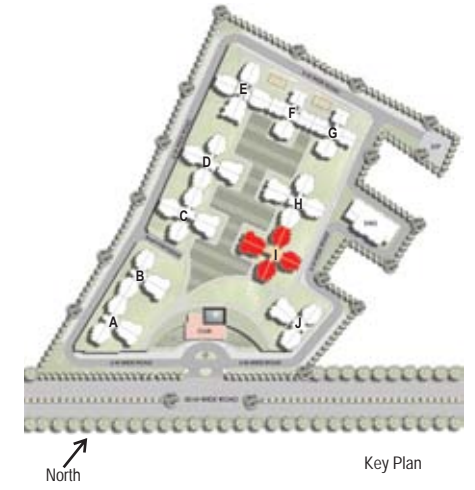
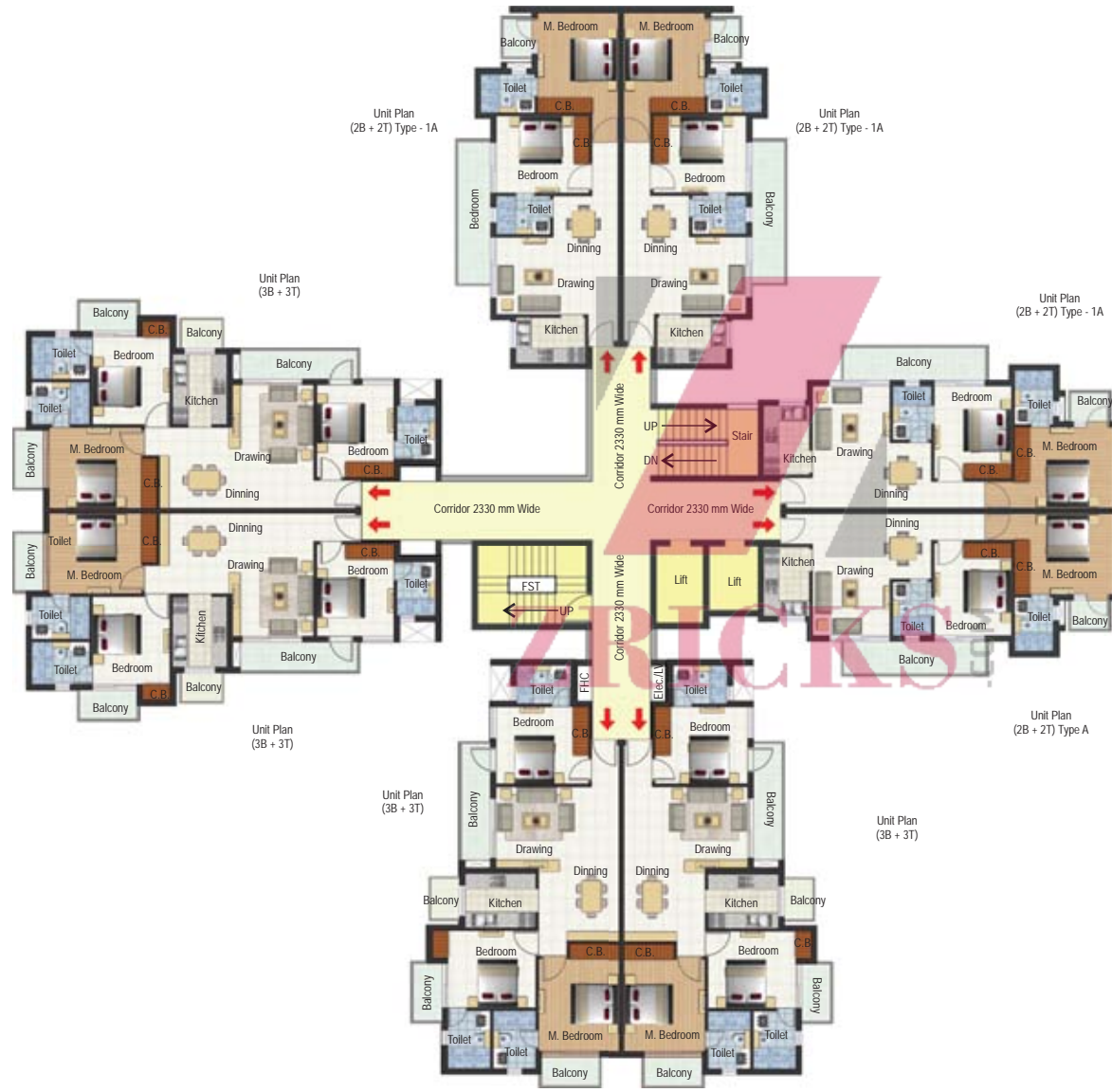

**Unit Plan (3B+3T) type-1
TOWER - A,B & J**

Super Built-up Area - 1396.29 sq. ft.

**Unit Plan (3B+3T) type-1A
TOWER - C,D,H & I**

Super Built-up Area - 1396.29 sq. ft.

Unit Plans



Unit Plans

Unit Plan (2B+2T) type-1
TOWER- A,B & J
Super Built-up Area - 1037 sq. ft.



Unit Plan (2B+2T) type-1A
TOWER - C,D,H & I
Super Built-up Area - 1037 sq. ft.



**Unit Plan (2B+2T) type-2
TOWER - F & G**

Super Built-up Area - 1017.175 sq. ft.

Unit Plans



**Unit Plan (2B+2T) type-3
TOWER-E**

Super Built-up Area - 1134.60 sq. ft.



Unit Plan (2B+2T+STUDY)
TOWER-E

Super Built-up Area - 1324 sq. ft.

Unit Plans



Unit Plan (1B+1T)
TOWER - F & G

Super Built-up Area - 661.14 sq. ft.



Our Other Projects



CapitalMall
Bhiwadi

Fully Operational



CROSS POINT MALL
Alwar

Fully Operational



CAPITAL HIGHSTREET
Shops • Offices • Suites
Bhiwadi

Under Construction



CAPITAL GALLERIA
Retail cum Office
Bhiwadi

Under Construction

ZRICKS

Our Associated Brands

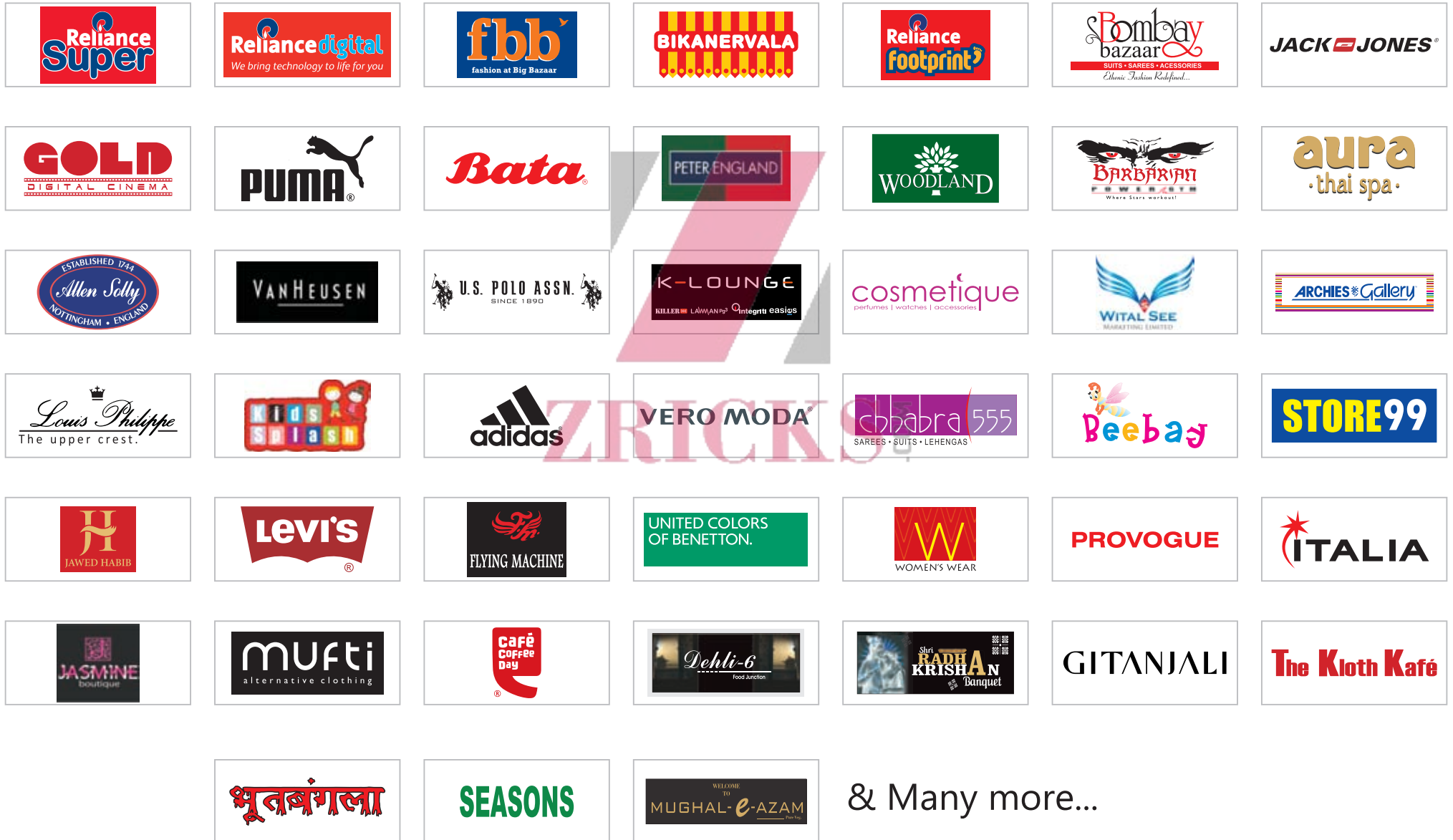

About R-Tech

The R-Tech name is synonymous to trust, quality, comfort and reliability. We believe in combining the strength of our experiences with the resources at hand so that we can cater to the dynamic needs of our customers.

R-Tech pioneered the concept of organized retail in Bhiwadi and Alwar by creating the world class infrastructure.

From start to finish it took two and a half years to complete Capital Mall, Bhiwadi and Cross Point Mall, Alwar which is a record. Both are running successfully for the last one year with all the top class retail brands converging therein with world class products and services.

Our Malls have become the ultimate destination for the seekers of high lifestyle shopping and entertainment.

R-Tech is a trendsetter and has created milestones to be chased by others in the times to come.

Not only that, R-Tech has won the award for the "Most admired launch of shopping mall of the year 2012" by ISCA and also awarded runner-up for Best Project under the category Commercial & Retail – Shopping Mall – Non Metro at the CREDAI REAL ESTATE AWARDS 2012.



R-TECH DEVELOPERS PVT. LTD.

Corporate Office: Building No. 80, Sector 44, Gurgaon 122002, Haryana.

E mail: sales@rtechdevelopers.com

Web: www.rtechdevelopers.com



Disclaimer : The visual shown and represented herein are on conceptual basis only, and shall have no bearing, in any manner, of booking to be made in this Project and the Developer reserve all rights, in this regard. This brochure is not a legal document.