



Jasmine
ZRICKS .COM



Niho Jasmine Scottish Gardens is a residential project that is located in Ghaziabad, close to NH 24. This project offers elegant and spacious 2 BHK deluxe apartments that cover a total area of 1,075 sq. ft, 2 BHK super deluxe apartments that cover a total area of 1,299 sq. ft, 3 BHK deluxe penthouse apartments that cover a total area of 1,545 sq. ft and 3 BHK super deluxe penthouse apartments that cover a total area of 1,545 sq. ft. Jasmine Scottish Gardens brings luxury living at extremely affordable prices. This project is ready to move into.

Project USP

- Exclusive club with a range of recreational facilities such as:
 1. Indoor and outdoor sports
 2. Reading room with a library
 3. Conference rooms
 4. Guest rooms that can be booked
 5. Swimming pool to keep you cool
 6. Community hall that can be booked anytime
 7. Restaurant with great food
- Reserved parking spaces for cars with all apartments along with a separate space dedicated to guests
- A completely gated community that promotes a sense of community living along with privacy and adheres to stringent security measures such as 24x7 guard duty, CCTV surveillance and restricted entry for unknown people
- 100% automatic power back up for all homes in the complex to ensure convenience and comfort at all times
- Landscaped greens with jogging tracks that help create a lush, green environment in the complex, bringing residents closer to nature



ZRICKS.COM



ZIRCKS







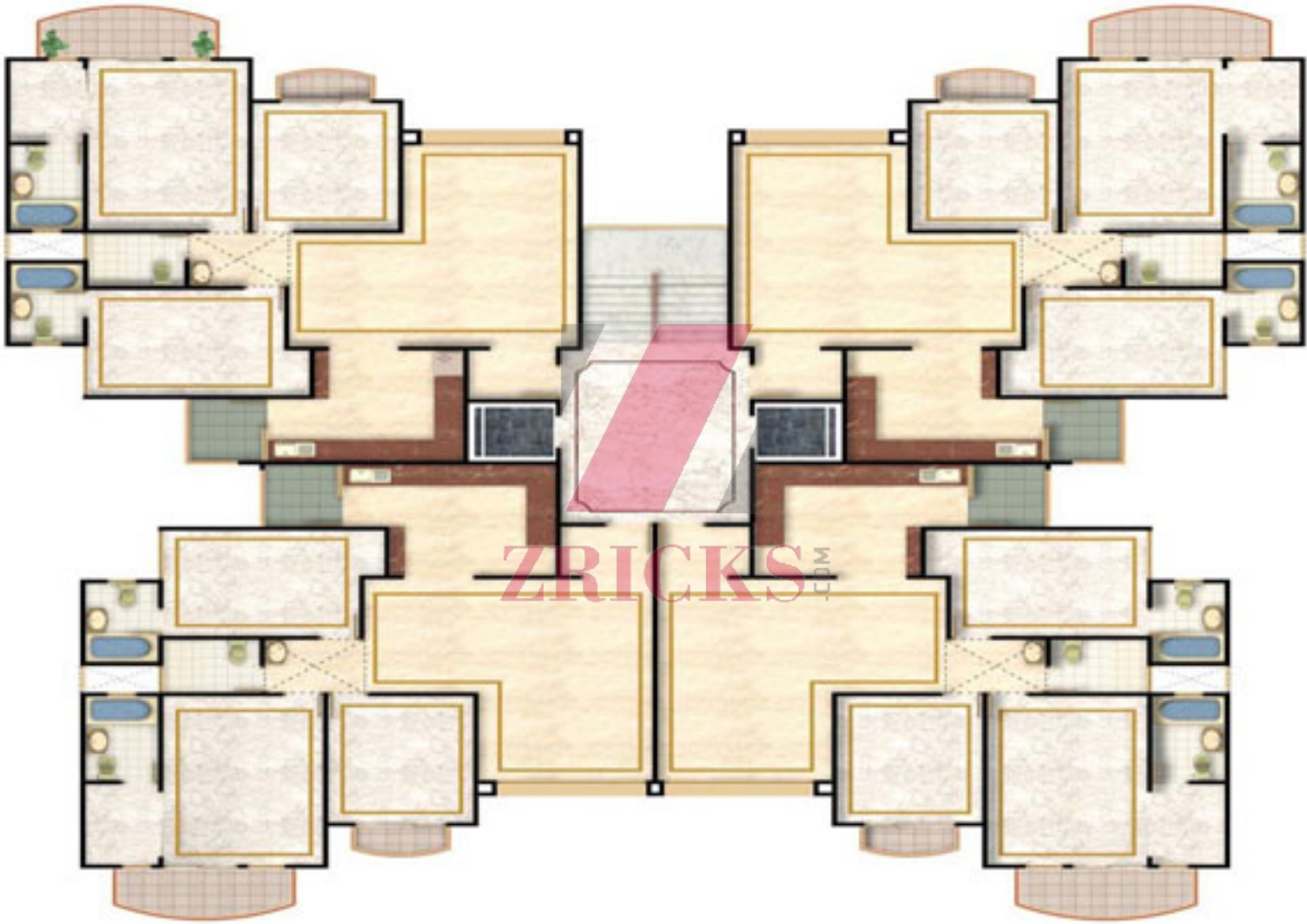

ZRICKS
CDM

Angel Mercury



Niho Scottish Gardens

ZRICKS

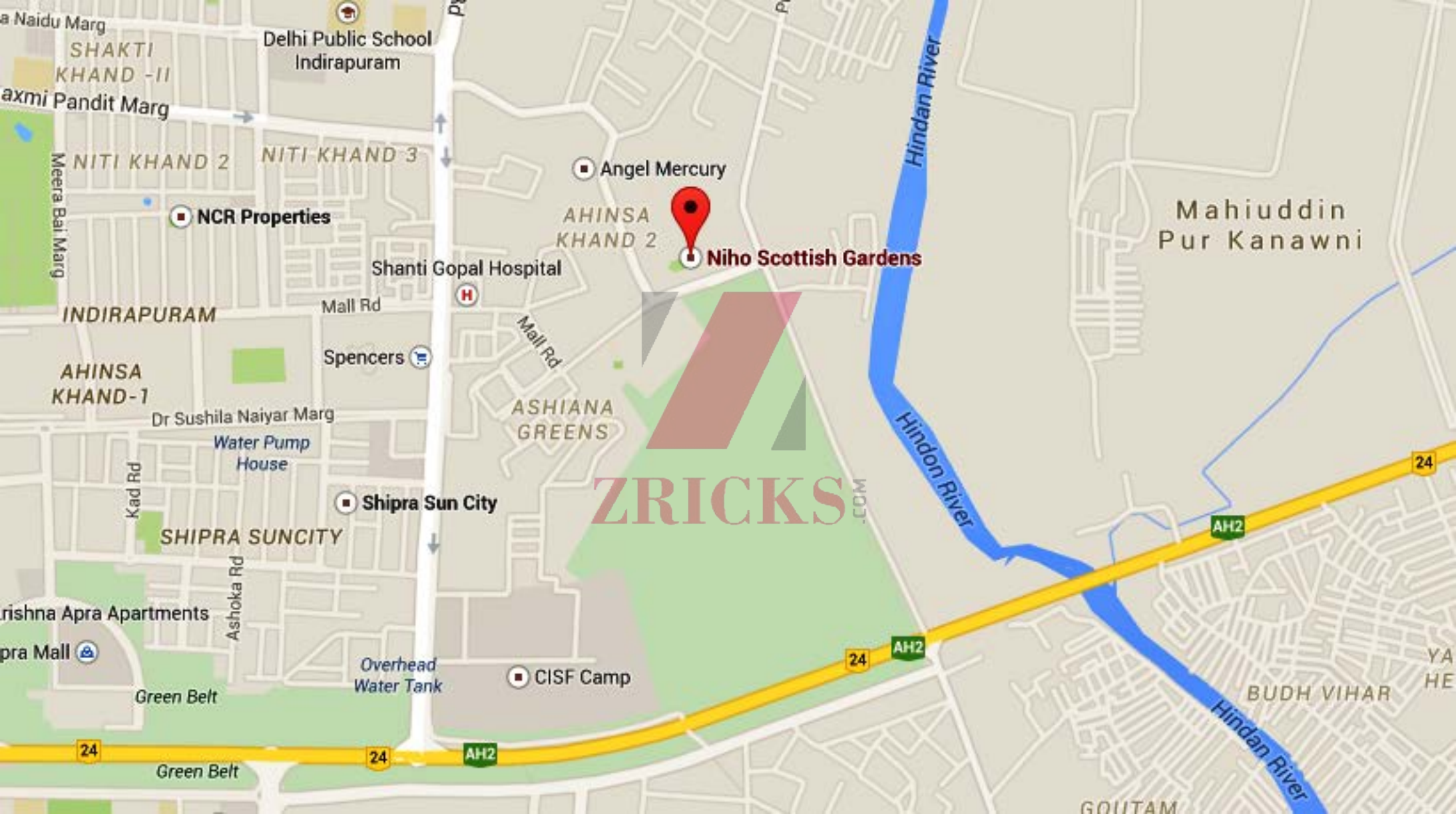

Niho Scottish Gardens

Angel Mercury

AHINSA
KHAND 2

Shanti Gopal Hospital

Mall Rd

Spencers

ASHIANA
GREENS

Shipra Sun City

CISF Camp

NCR Properties

NITI KHAND 3

NITI KHAND 2

INDIRAPURAM

AHINSA
KHAND-1

Dr Sushila Naiyar Marg
Water Pump
House

SHIPRA SUNCITY

Prishna Apra Apartments

Apra Mall

Green Belt

Overhead
Water Tank

Green Belt

Hindon River

Hindon River

Hindon River

Mahiuddin
Pur Kanawni

BUDH VIHAR

GOUTAM

ZRICKS .COM

24

24

AH2

24

AH2

24

AH2

❏ SPECIFICATION

Structure :	Earth quake resistant RCC framed structure designed by highly experienced structural engineers and approved by IIT or equivalent authorities.
Doors :	Main entrance designer panel door made of teak wood. Internal doors made of designer flush doors.
Windows :	Powder coated aluminum/wooden windows duly powder coated with fly mesh net.
Flooring :	<ul style="list-style-type: none"> ▶ Drawing/Dining Room - Designer marble with border and mirror finish ▶ Bed Rooms - Marble with border and mirror finish/ceramic tiles ▶ Entrance Foyer/Lobby/Staircase - Marble flooring ▶ Kitchen - Marble flooring.
Kitchen :	<ul style="list-style-type: none"> ▶ Granite platform with stainless steel sink. ▶ Dado upto 2 ft. ceramic tiles ▶ Furnished with modular type kitchen furniture.
Toilet :	<ul style="list-style-type: none"> ▶ Dado upto 7 ft. height of designer ceramic tiles. ▶ Designer antiskid ceramic flooring ▶ Cera/Hindustan/Parryware sanitary ware fittings in pleasing shades ▶ Excellent quality of C.P. Fittings ▶ Bath tub in master bedroom.
Wood Work :	<ul style="list-style-type: none"> ▶ All frame of hard wood. ▶ Wooden cupboards in all the bedrooms. ▶ Main door - Teak panel door. ▶ Wardrobe in dress area. ▶ Kitchen Cabinet with modular accessories. ▶ Internal door - Flush-door Teak ▶ Brass hardware fittings.
Electrification :	Copper concealed wiring with sufficient number of light/fan/telephone/T.V./power points in all rooms/toilets/kitchen etc. with modular switches and protective MCBs.
Furniture/ Fixitures :	<ul style="list-style-type: none"> ▶ Fans in all rooms ▶ Geyser in all Bathrooms and instant geyser in kitchen