



USP

### What's Special?

- ➔ Spread over 4,250,000 sq. ft.
- ➔ 4-screen multiplex comprising of approx 30,000 sq. ft.
- ➔ Huge Gaming zone.
- ➔ Mega Atrium with approx 70 ft. heights.
- ➔ Unrestricted view to every unit from Mega Atrium.
- ➔ Maximum units have provision of wet point.
- ➔ Latest Fire Fighting Equipment.
- ➔ 24 hour CCTV surveillance.
- ➔ A big food court to deliver all type of foods.
- ➔ Strategic location on NH-1.

Located on NH-1, Just 20 minutes drive from North Delhi populated area like Rohini, Pitampura etc.

- ➔ Unrestricted view to every unit from mega atrium.
- ➔ Ideally located just before Kundli Border (Entering Delhi)
- ➔ Ample & hassle free multilevel parking for more than 650 vehicle
- ➔ Eco friendly layout of the project.
- ➔ State of the art/multitier security system for the entire development
- ➔ Breath-taking landscaping amidst lush green atmosphere
- ➔ Maximum units have provision of wet points
- ➔ Mega atrium with 70 ft height
- ➔ Latest fire fighting equipments
- ➔ 24 hours CCTV security surveillance

ZBRICKS.COM

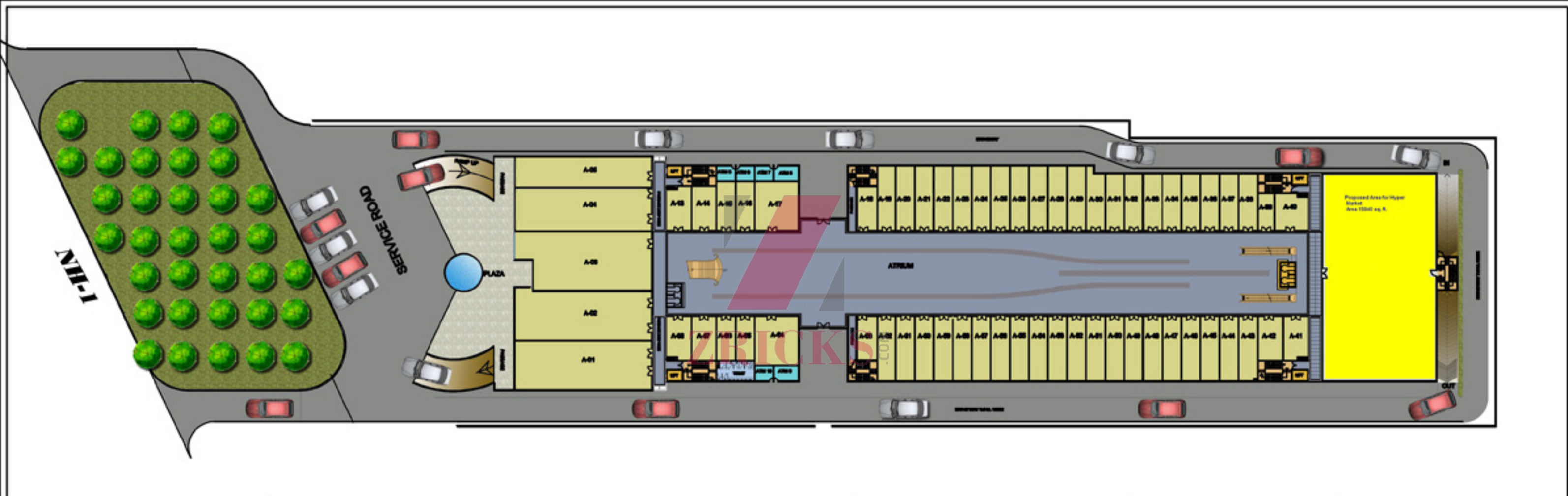

PROJECT:  
**PARKER MALL**

MAIN GT ROAD, KUNDLI, SONEPAT

ARCHITECTS:-  
**Ichinen**  
ARCHITECTS PRACTICE LIMITED

ATRIUM FLOOR

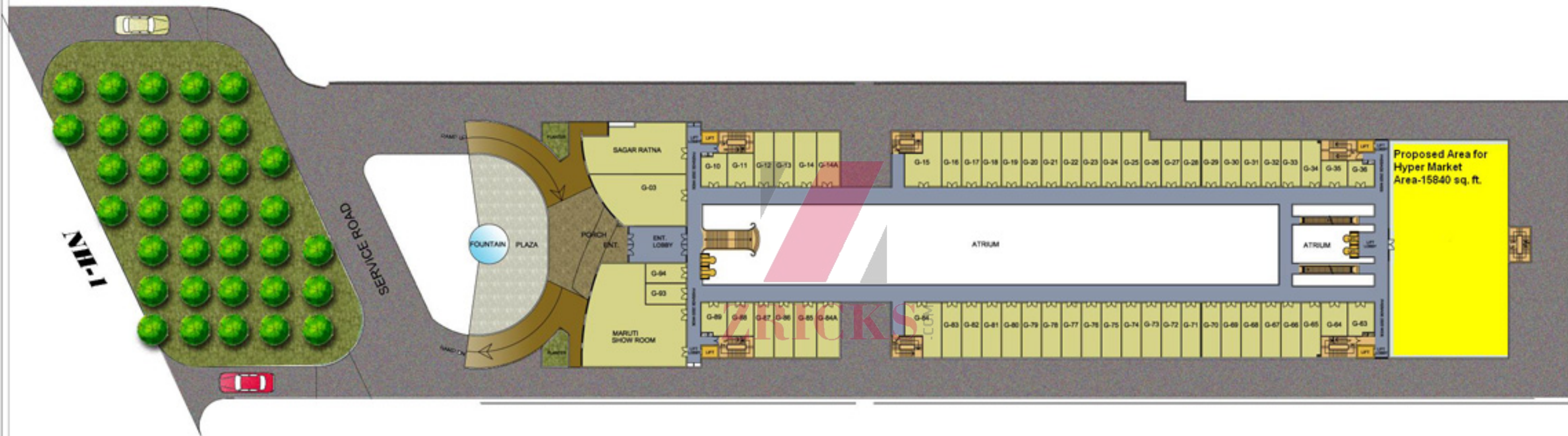

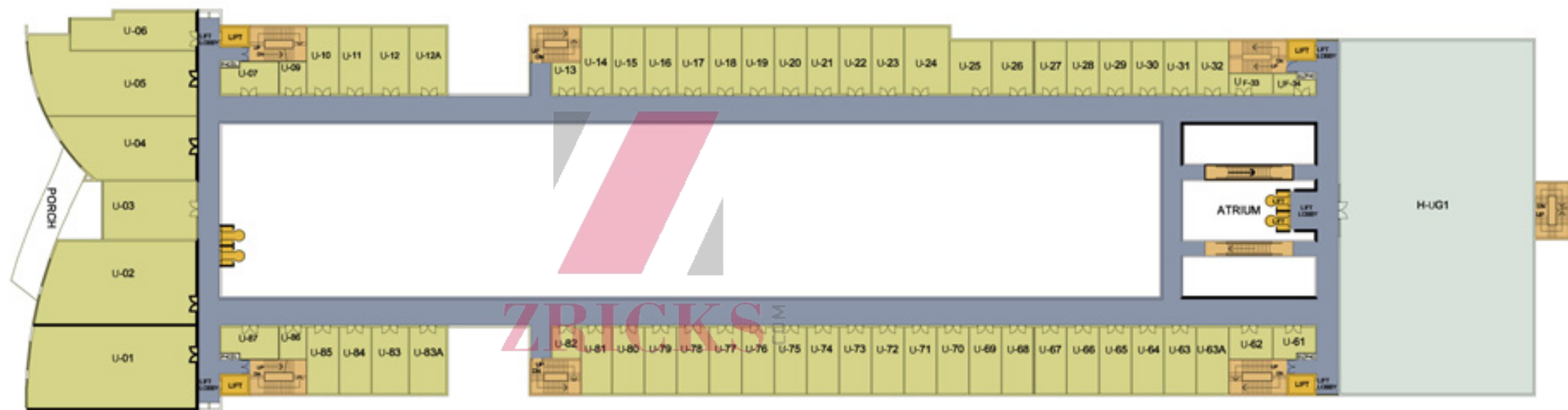

PROJECT:

**PARKER MALL**

MAIN GT ROAD, KUNDLI, SONEPAT

ARCHITECTS:-

**Ichinen**  
ARCHITECTS PRIVATE LIMITED

UPPER GROUND FLOOR

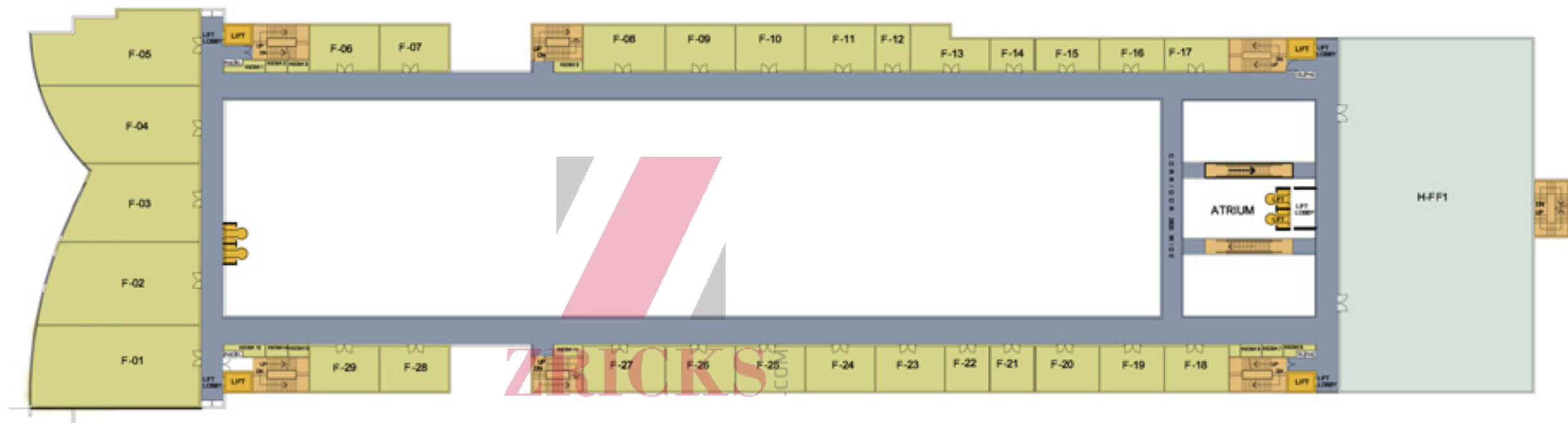

PROJECT:

**PARKER MALL**

MAIN GT ROAD, KUNDLI, SONEPAT

ARCHITECTS:

**Ichinen**  
ARCHITECTS PRIVATE LIMITED

FIRST FLOOR

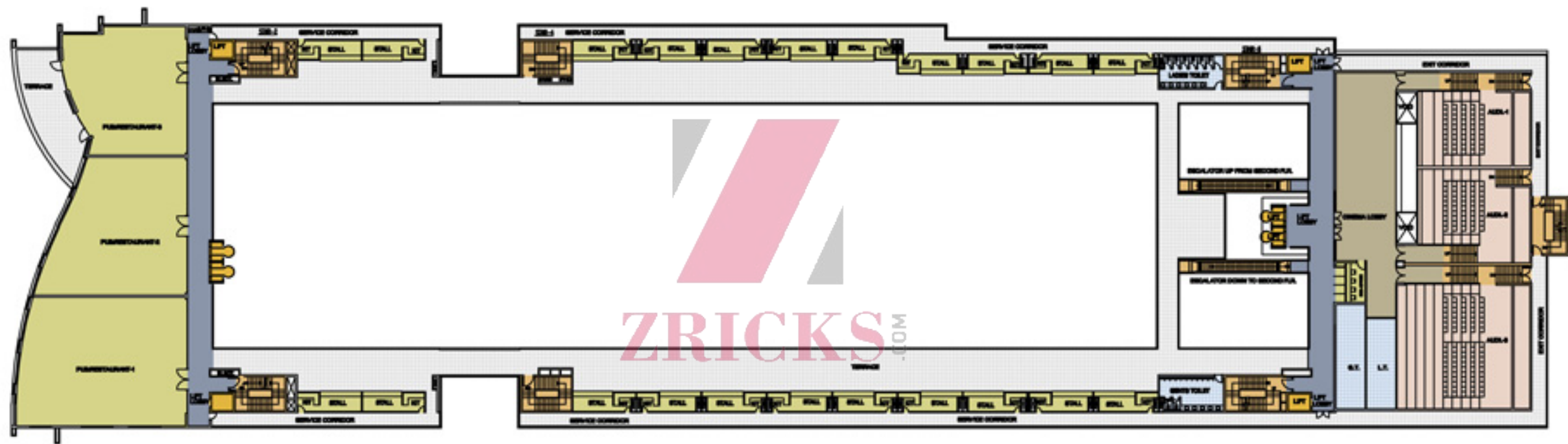

PROJECT:

**PARKER MALL**

MAIN GT ROAD, KUNDLI, SONEPAT

ARCHITECTS:-

*Ichinen*  
ARCHITECTS PRIVATE LIMITED

**SECOND FLOOR PLAN**



PARKER

SUZUKI MOTOR