



Impressive Homes, Impressive Lifestyle



ZRICKS.COM



— SG —  
HOMES

With S.G. Homes, S.G. Estates yet again adds another impressive residential project to its list of creations. S.G. Homes being situated at the posh location of Sector-3, Vasundhara offer easy connectivity to Delhi, NCR. These homes offer a choice of 2, 3 and 4 bedroom spacious and well ventilated apartments. The very fact that these apartments are constructed on a four side open plot makes them airy, spacious and vastu friendly. The advantages of being a four side open plot are manifold which include; maximum sunlight, improved ventilation, better view and open space to name a few. Apart from this the location at Sector-3, Vasundhara is a bonus. Vasundhara is located at Ghaziabad, one of the fastest growing place in today's time, making Vasundhara the most desired location to dwell at.



# Features



- 4 side open plot that allows proper ventilation and natural light
- Located in well developed sector of Vasundhara with several happy families comprising the major populace. Fully developed infrastructure ensures proper supply of electricity and water along with proper sewerage system.

- Approx 70% open area
- Guarded complex with intercom
- Modular kitchen
- Fully loaded AC gym
- Club with steam, sauna, table tennis and billiards
- Multipurpose hall for meditation, yoga and gatherings
- Badminton court
- Swimming pool and separate kids splash pool
- Convenient market centre
- Proposed metro connectivity



# SITE LAYOUT



Area	Unit No.
101.72 sq.mtr. (1095 sq.ft.)	3, 6, 9, 17, 20
121.7 sq.mtr. (1310 sq.ft.)	4, 5, 10, 18, 19
134.70 sq.mtr. (1450 sq.ft.)	2, 7, 8, 15, 16, 21
153.29 sq.mtr. (1650 sq.ft.)	12, 12A
167.68 sq.mtr. (1805 sq.ft.)	11, 14
225.75 sq.mtr. (2430 sq.ft.)	1, 22

**Super Area-101.72 sq. mtr. (1095 sq. ft.)**

- 2 Bedroom
- Drawing/Dinning
- Kitchen
- 2 Toilets
- 4 Balconies

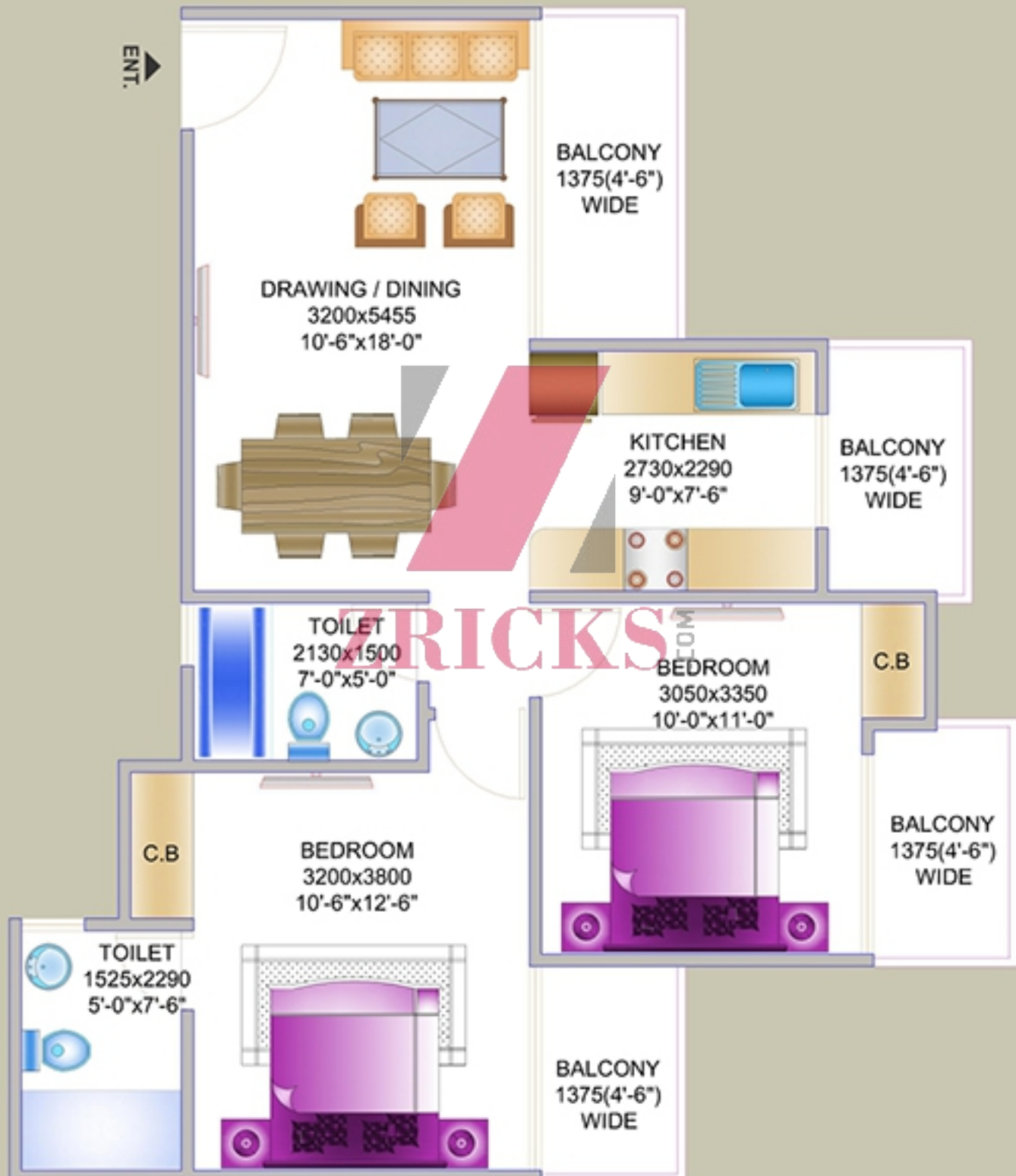

**Super Area-121.7 sq. mtr. (1310 sq. ft.)**

- 3 Bedroom
- Drawing/Dinning
- Kitchen
- 2 Toilets
- 4 Balconies



**Super Area-134.70 sq. mtr. (1450 sq. ft.)**

- 3 Bedroom
- Drawing/Dinning
- Kitchen
- 2 Toilets
- 4 Balconies

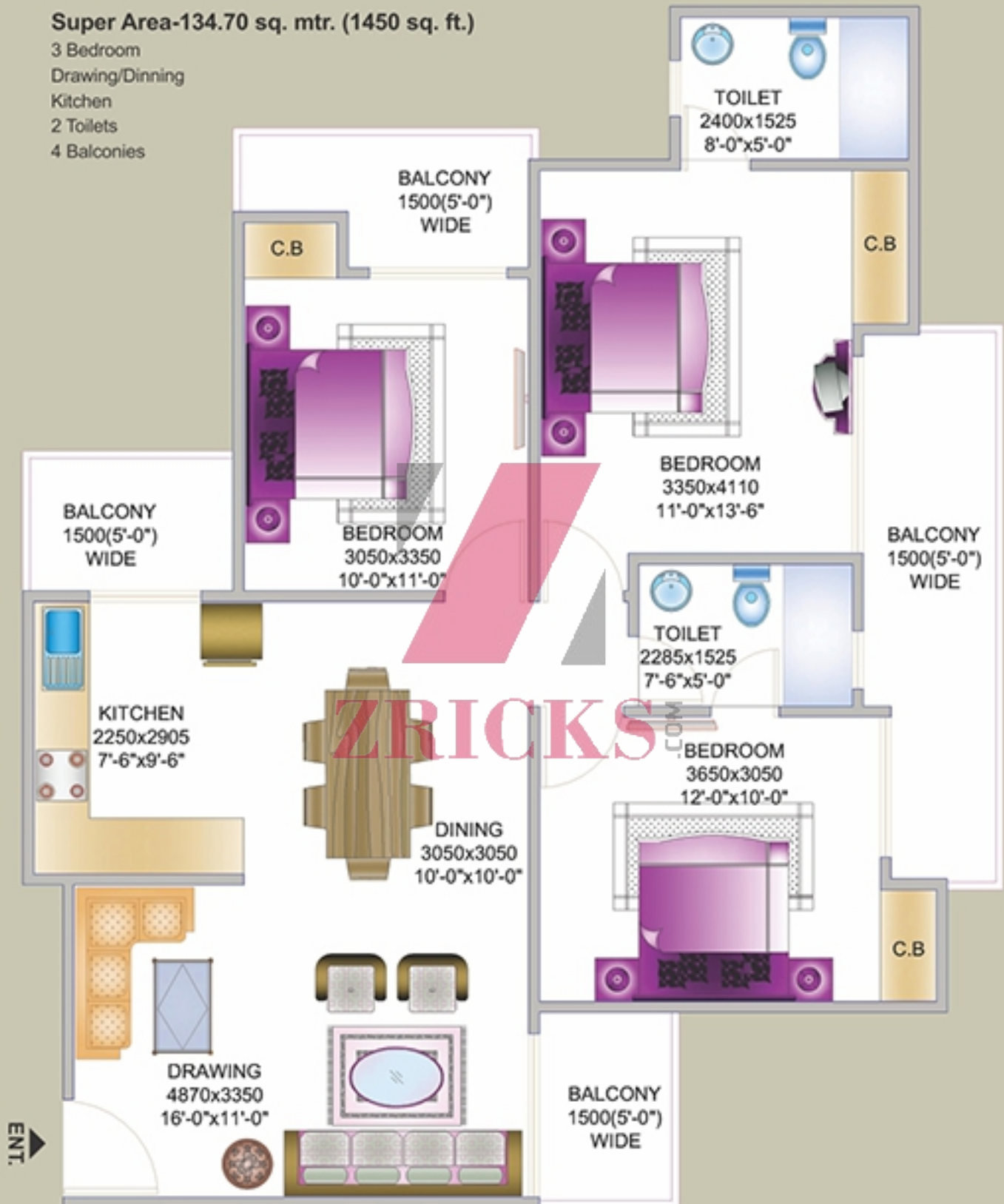

**Super Area-153.29 sq. mtr. (1650 sq. ft.)**

- 3 Bedroom
- Drawing/Dinning
- Kitchen
- Servant Room
- 4 Toilets
- 4 Balconies

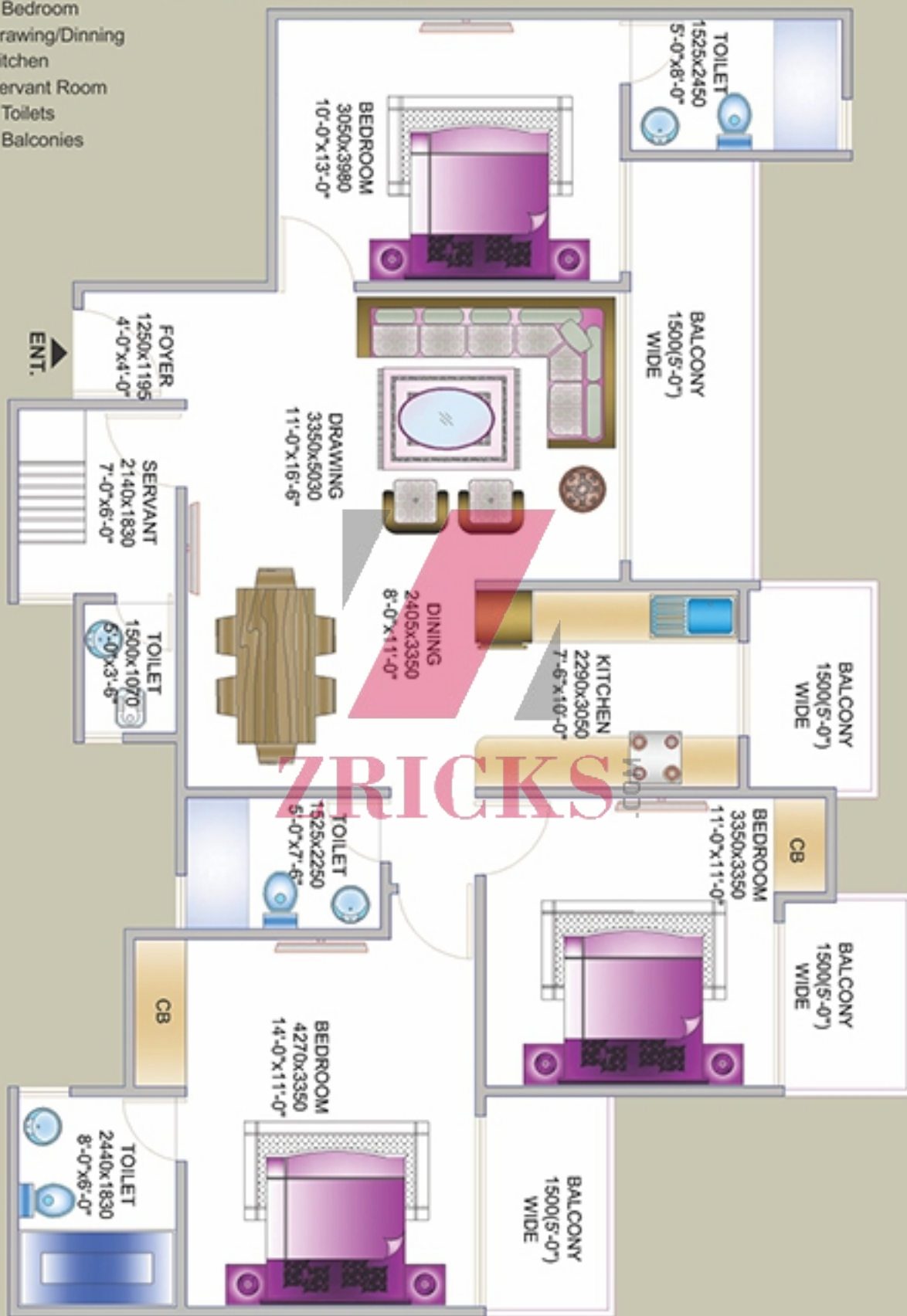



**Super Area-167.68 sq. mtr. (1805 sq. ft.)**

- 3 Bedroom
- Drawing/Dinning
- Kitchen
- Study/Puja
- Servant Room
- Dress Room
- 4 Toilets
- 4 Balconies

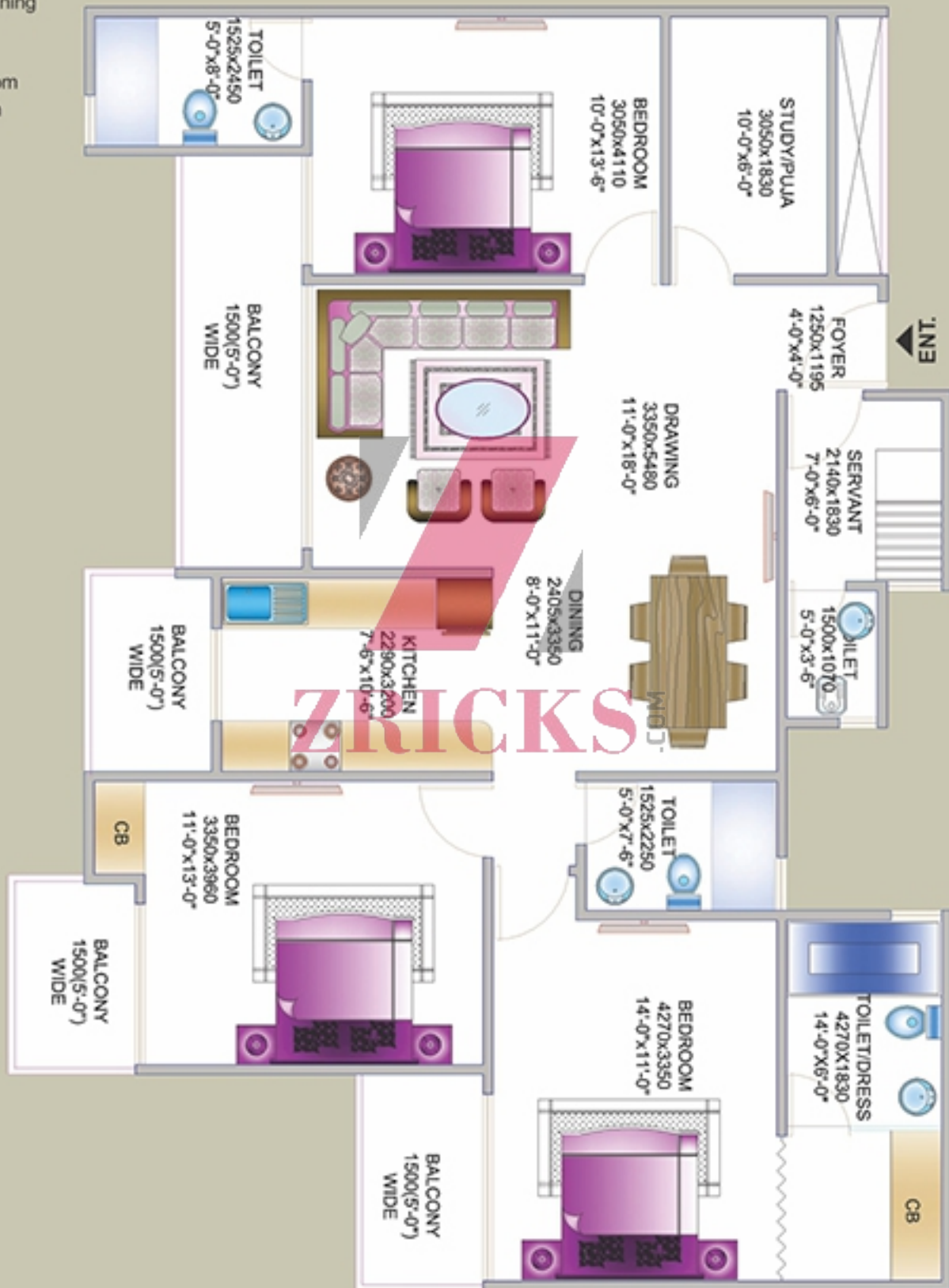



# SPECIFICATIONS

## Drawing Room

Floors	:	Vitrified Tiles
External Doors & Windows	:	Powder coated Aluminium Doors & Windows with glass
Walls	:	POP & Plastic Emulsion Paint
Internal Door	:	Designer flush door with Polish
Ceiling	:	POP Cornish & Plastic Emulsion Paint
Fixtures & Fittings	:	Chandeliers and Fancy light fittings with modular switches, Telephone cable outlet

## Dining Room

Floors	:	Vitrified Tiles
External Doors & Windows	:	Powder Coated Aluminium Doors & Windows with glass
Walls	:	POP & Oil Bound Distemper
Internal Door	:	Flush door with Polish
Ceiling	:	POP Cornish & Oil Bound Distemper
Fixtures & Fittings	:	Fancy lights with modular switches, Telephone cable outlet

## Bedroom

Floors	:	Vitrified Tiles
External Doors & Windows	:	Powder coated Aluminium Doors & Windows with glass
Walls	:	POP & Oil Bound Distemper
Wood Work	:	3 / 4 Bedroom Flats : 2 Wardrobes 2 Bedroom Flats : 1 Wardrobe
Internal Door	:	Flush door with Polish
Ceiling	:	POP Cornish & Oil Bound Distemper
Fixtures & Fittings	:	Fancy lights with modular switches, Telephone cable outlet

## Toilets

Floors	:	Anti Skid Floor Tiles
External Doors & Windows	:	Powder coated Aluminium Doors & Windows with glass
Walls	:	Ceramic Tiles up to 7' Level
Internal Door	:	Flush door with outer Polish inside paints
Ceiling	:	POP & Oil Bound Distemper
Fixtures & Fittings	:	Arrangement of Hot & Cold water in all Toilets. In Master Bedroom Western Seat with Cistern of Hindware or its Equivalent, Washbasin, looking Mirror with CP Fittings (ISI Mark) and same in other Toilets.

## Modular Kitchen

Floors	:	Vitrified Tiles
External Doors & Windows	:	Powder coated Aluminium Doors & Windows with glass
Walls	:	Ceramic Tiles up to 2 feet on Working Counter
Wood Work	:	Modular Kitchen Cabinets on working counter below 2 feet above
Internal Door	:	Flush door with Polish/paint
Ceiling	:	POP & Oil Bound Distemper
Fixtures & Fittings	:	Granite Counter, Stainless Steel Sink, Fancy Light Fittings with Modular Switches, Common Water Softener Plant

## Balconies

Floors	:	Ceramic Tiles
Railing	:	M-Steel Railings
Ceiling	:	Texture Paint

## Lift Lobbies/Corridors

Floors	:	Marble Walls & Ceiling: Oil Bound Distemper
Fixtures & Fittings	:	Adequate Light Points

## Staircase

Floors	:	Baroda Green with White Marble
--------	---	--------------------------------

## Exterior

Outer Finishing	:	Weather Proof Coating
-----------------	---	-----------------------

## Structure

Floors	:	Earthquake Resistant Structure Approved by IIT with First Class Bricks
--------	---	--

Note: Variation in colour of vitrified tiles may occur due to natural/ production lots and are not changeable.

**SG BENEFIT**  
residential & commercial  
Kirti Nagar, Ghaziabad

**SG GRAND**  
2/3 BHK Apartments  
Rajnagar Extn., Ghaziabad



ACTUAL PHOTOGRAPHS

**ZRICKS**.COM

Map not to scale

## delivered projects

### ACTUAL PHOTOGRAPHS



SG Impressions 58  
Rajnagar Extn., Ghaziabad



SG Impressions,  
Vasundhara, Ghaziabad



SG Impressions Plus,  
Rajnagar Extn., Ghaziabad



Ivory & Indigo SG Impressions 58 II,  
Rajnagar Extn., Ghaziabad



SG Alpha Tower, Sec-9,  
Vasundhara, Ghaziabad



SG Beta Tower,  
Sec-3, Vasundhara, Ghaziabad

## Ongoing projects

### ARTISTIC IMPRESSION



SG Grand,  
Rajnagar Extn., Ghaziabad



SG Benefit,  
Govindpuram, Ghaziabad



SG Oasis,  
Sec-2B, Vasundhara, Ghaziabad



## SG ESTATES LIMITED

QUALITY CONSTRUCTION, OUTSTANDING INTEGRITY

-An ISO 9001-2000 certified company-

CIN NO. - U70101DL1984PLC17265

105-106, Deep Shikha Tower, Rajendra Place, New Delhi-110 008

Call: 9910050600 • Tel.: 011-42323230 (Hunting Lines) • Fax: 011-42323244

Email: enquiry@sgestates.in • www.sgestates.in, www.sghomes.in