



spacious
3 bedroom
budget homes

INDIGO 
SG impressions58 - Phase II
Rajnagar Extension, Ghaziabad



ZRICKS





Indicative image

hassle free commuting

- Situated on NH-58 • Connectivity with Delhi as well as NOIDA (15 minutes drive) • Greater Noida (35 minutes) • Vasundhara (10 minutes)
- Indirapuram (10 minutes) • Vaishali (10 minutes)
- Meerut and Hapur (40 minutes each)
- Full functional expressway GT Road with NH-58
- 25 km. from the Central Business District, Connaught Place • 14 km from Delhi • Proposed Metro Connectivity

specifications that uplift your mood!

DRAWING & DINING ROOM- Floors: Vitrified Tiles or equivalent flooring Doors & Windows: M.S. Frame and Flush Door Shutter Walls: POP Cornice & Oil bound Distemper Electrical Fittings: Modular switches telephone cable cutlet etc.

BEDROOMS- Floors: Vitrified Tiles or equivalent flooring Doors & Windows: M.S. Frame and Flush Door Walls: POP Cornice & Oil bound Distemper Paint Electrical Fittings: Modular switches telephone cable outlet Fixtures & Fittings: Wooden Almirah in Master Bedroom only

TOILETS- Floors: Floor Tiles Doors & Windows: Wooden Flush Door Walls: Ceramic tiles up to 7 feet Electrical Fittings: Arrangement of hot & cold water (without geyser), western seat with cistern of Hindware or its equivalent washbasin with CP fittings (ISI mark)

KITCHEN- Floors: Vitrified Tiles or equivalent flooring Doors & Windows: Flush Door Walls: Ceramic tiles up to 2 feet on working counter Electrical Fittings: Modular switches Fixtures & Fittings: Granite counter, stainless steel sink & wooden cabinet below the kitchen working counter



Indicative image

BALCONIES - Floors: Ceramic Tiles Railing: M-Steel Railings Ceiling: Texture Paint LIFT LOBBIES/ CORRIDORS Floors: Baroda Green with white marble or equivalent Walls: Oil Distemper Ceiling: Oil Distemper Fixtures & Fittings: Adequate light points

STAIRCASE - Floors: Baroda Green with white marble or equivalent

EXTERIOR - Outer Finishing: Weather proof coating



Indicative image

features, highly appreciable!

- Swimming pool • Power back-up* • Dedicated car parking* • Home loan available • 70% open area with beautiful landscapes • High speed lifts & latest fire fighting equipments • Planning as per vastu norms
- Spacious and well ventilated rooms • Club with billiards & card room • Landscaped garden dotted with flower beds • Professional maintenance*

SAFETY FEATURES

- 2 tier security • Gated complex • Fire fighting system
- Earthquake resistance structure • Secured complex for elderly & children • Assurance of quality • Peace of mind • Safety of investment



on a never ending journey of perfection!

as ISO 9001-2000 certified company

SG Estates Limited, a twenty four years old name in the real estate industry is a group that stands for meticulous planning and application of the consumer insights. It works on the simple philosophy of 'Working out solutions that perfectly harmonize with nature and at the same time enhance life all-round. This philosophy has helped the group in extending complete peace of mind to all patrons and strengthen the already strong confidence with every new project. All this in turn has made the group catapult into a major force in the real estate industry in north India. With the growth it has witnessed the group has even grown in terms of investment in man, machine and material, and thereby, matching up to international standards and requirements. The group continually moves forward with its philosophy which is reflected in its commercial, residential, and corporate complexes. Its projects have always been a perfect example of comprehensiveness of approach and application.

SG Estates Limited with its residential projects, Impressions Vasundhara, Impressions Dehradun, Impressions 58 and Impressions Plus has made its presence stronger in real estate. With quality assurance, value for money, friendly features, timely construction and on-time possession, it gives you every reason to own a home of your desire within your budget. SG Estates, for its ethics and professionalism has been awarded as a PROMISE OF BRILLIANCE AWARD OF THE YEAR 2007 by the Lt. Governor of Delhi, but the biggest reward for the group is the overwhelming response of its satisfied customers. SG Estates continues its journey of developing residential flats, luxurious apartments and commercial and retail properties.

floor plan

super area- 1225 sq.ft.

- 3 Bedrooms
- Drawing/Dining
 - Kitchen
- 2 Toilets
- 3 Balconies

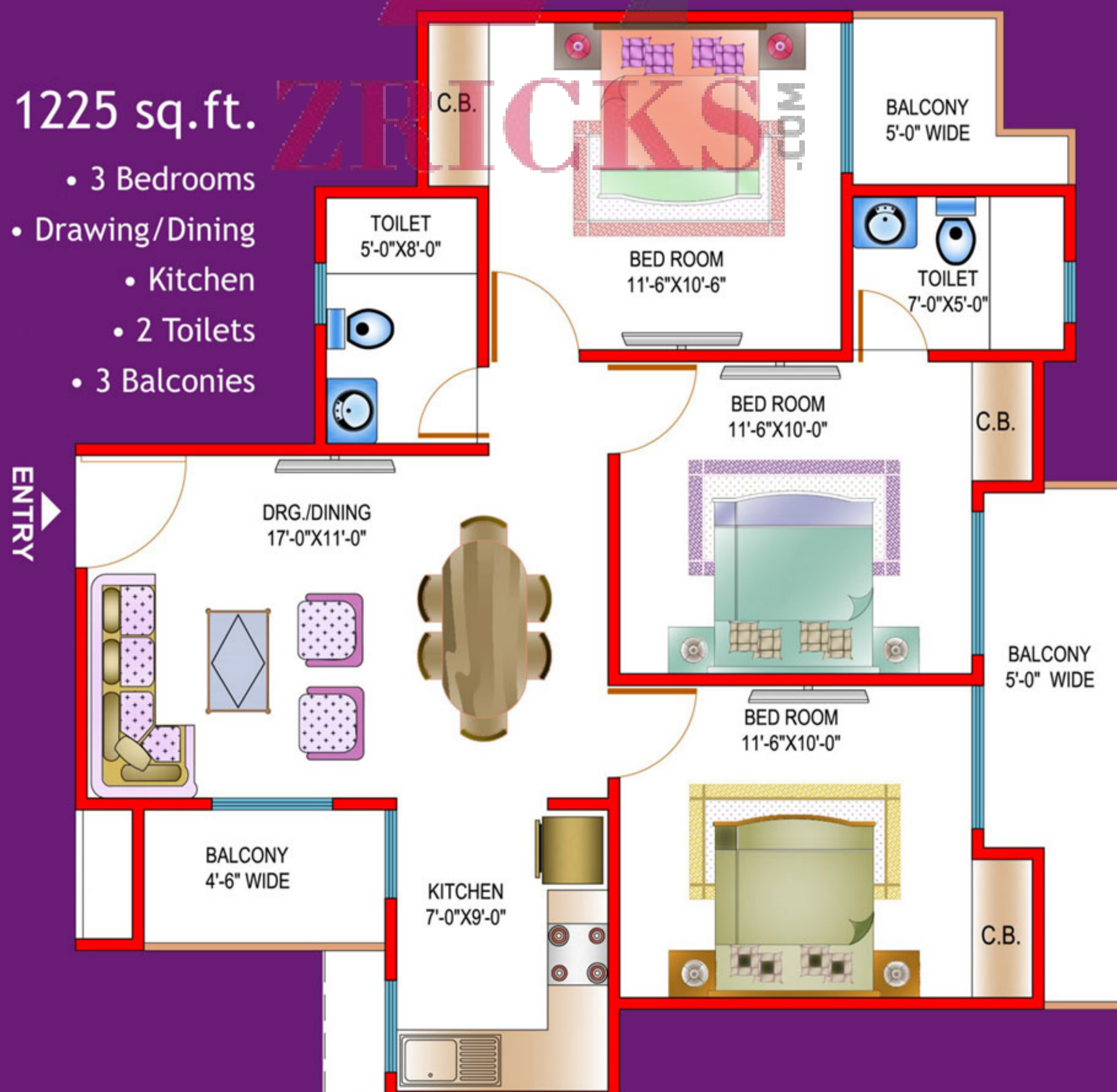

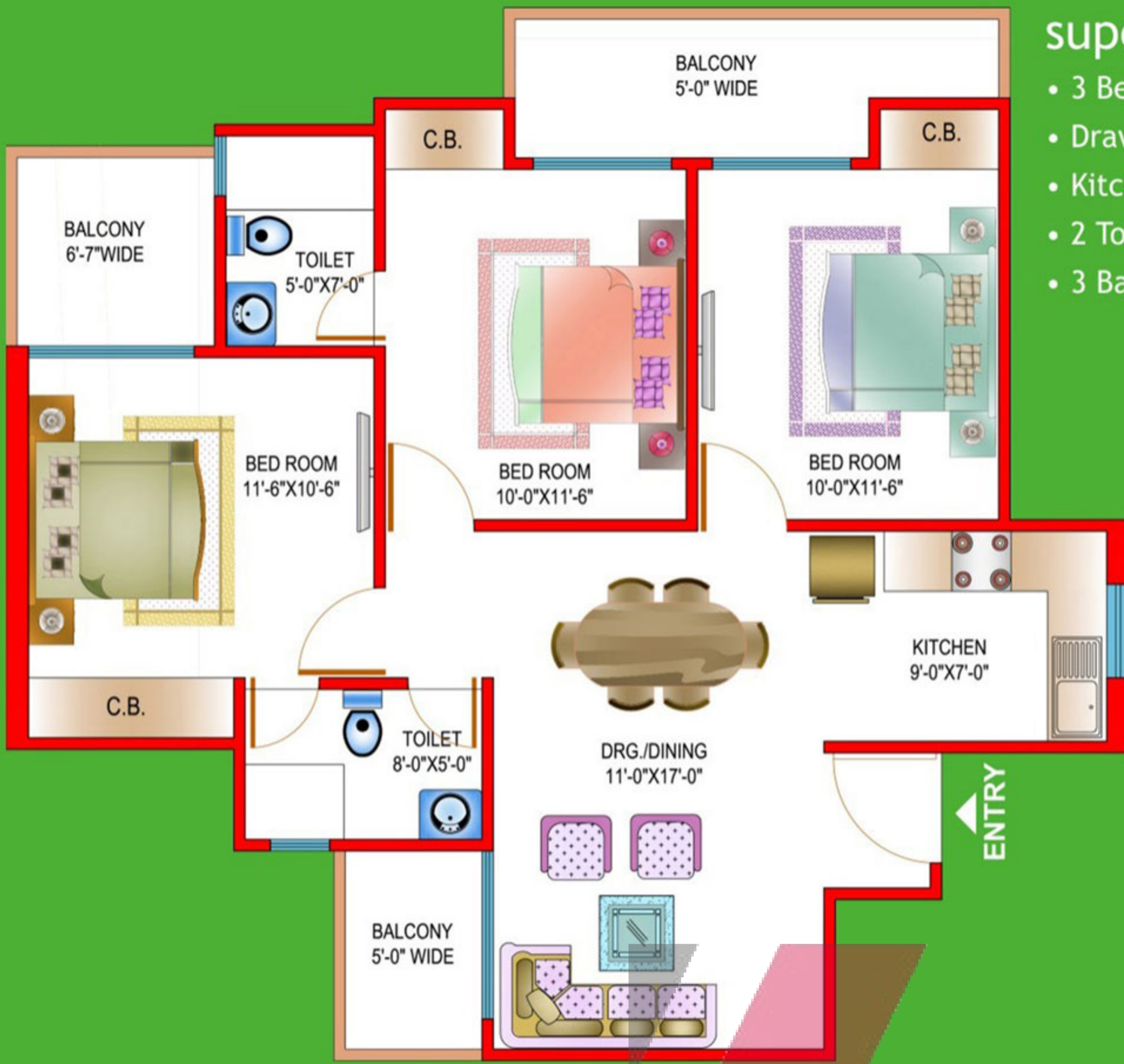

super area - 1248 sq.ft.

- 3 Bedrooms
- Drawing/Dining
- Kitchen
- 2 Toilets
- 3 Balconies

super area- 1250 sq. ft.

- 3 Bedrooms
- Drawing/Dining
- Kitchen
- 2 Toilets
- 4 Balconies

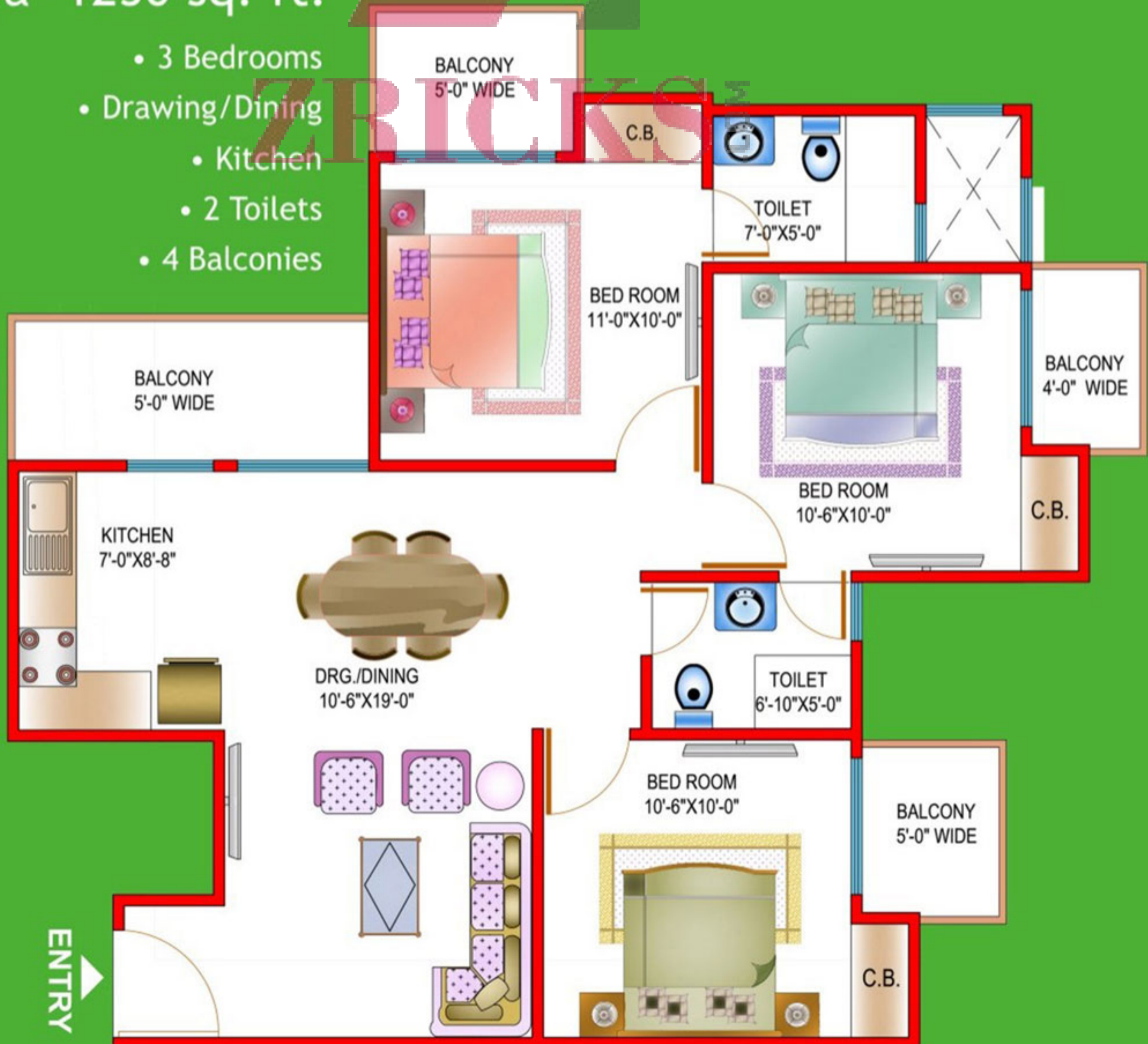

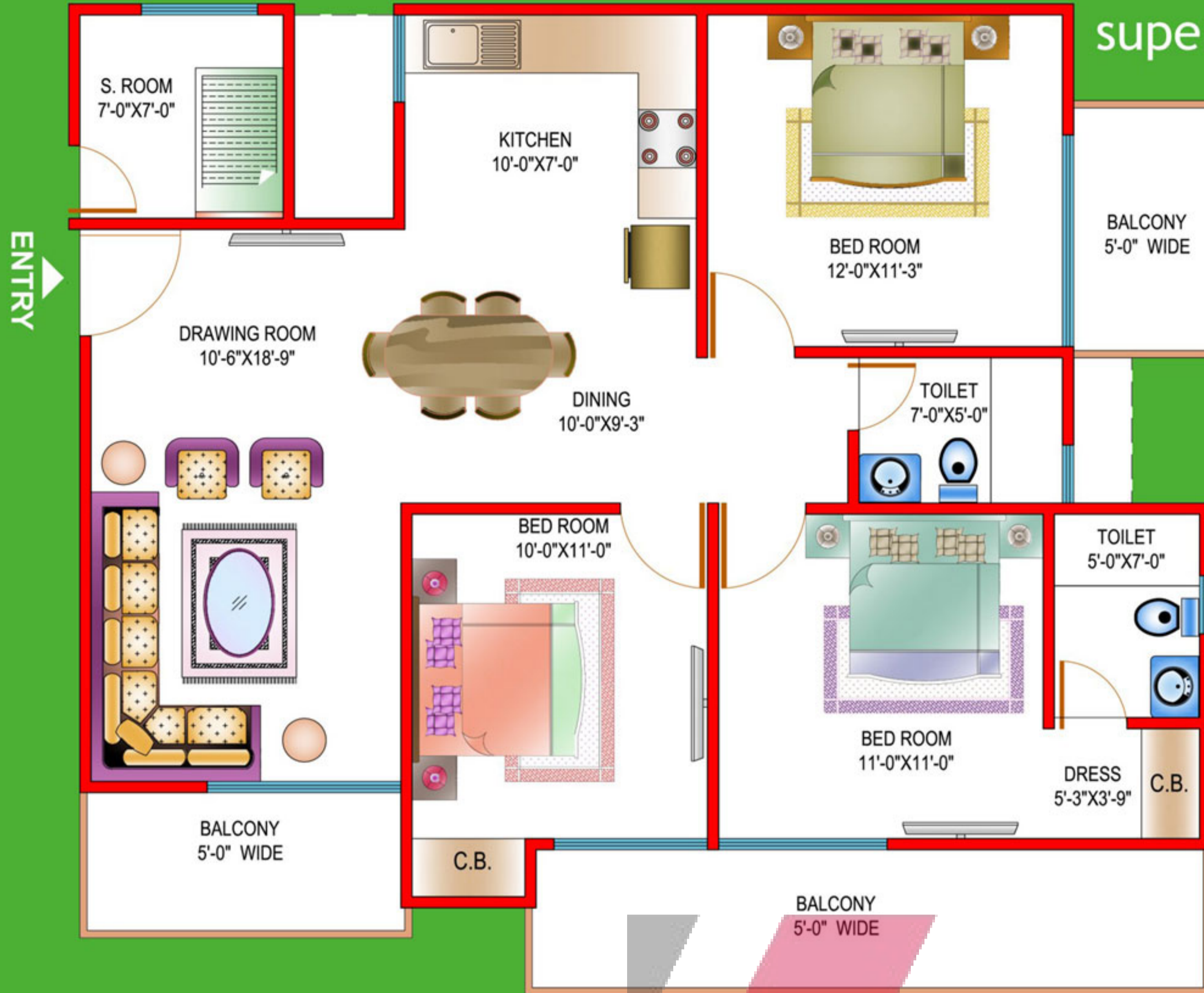

super area - 1530 sq. ft.

- 3 Bedrooms
- Drawing/Dining
- Kitchen
- 2 Toilets
- Servent Room
- Dress
- 3 Balconies

super area - 1585 sq. ft.

- 4 Bedrooms
- Drawing/Dining
- Kitchen
- 3 Toilets
- 5 Balconies

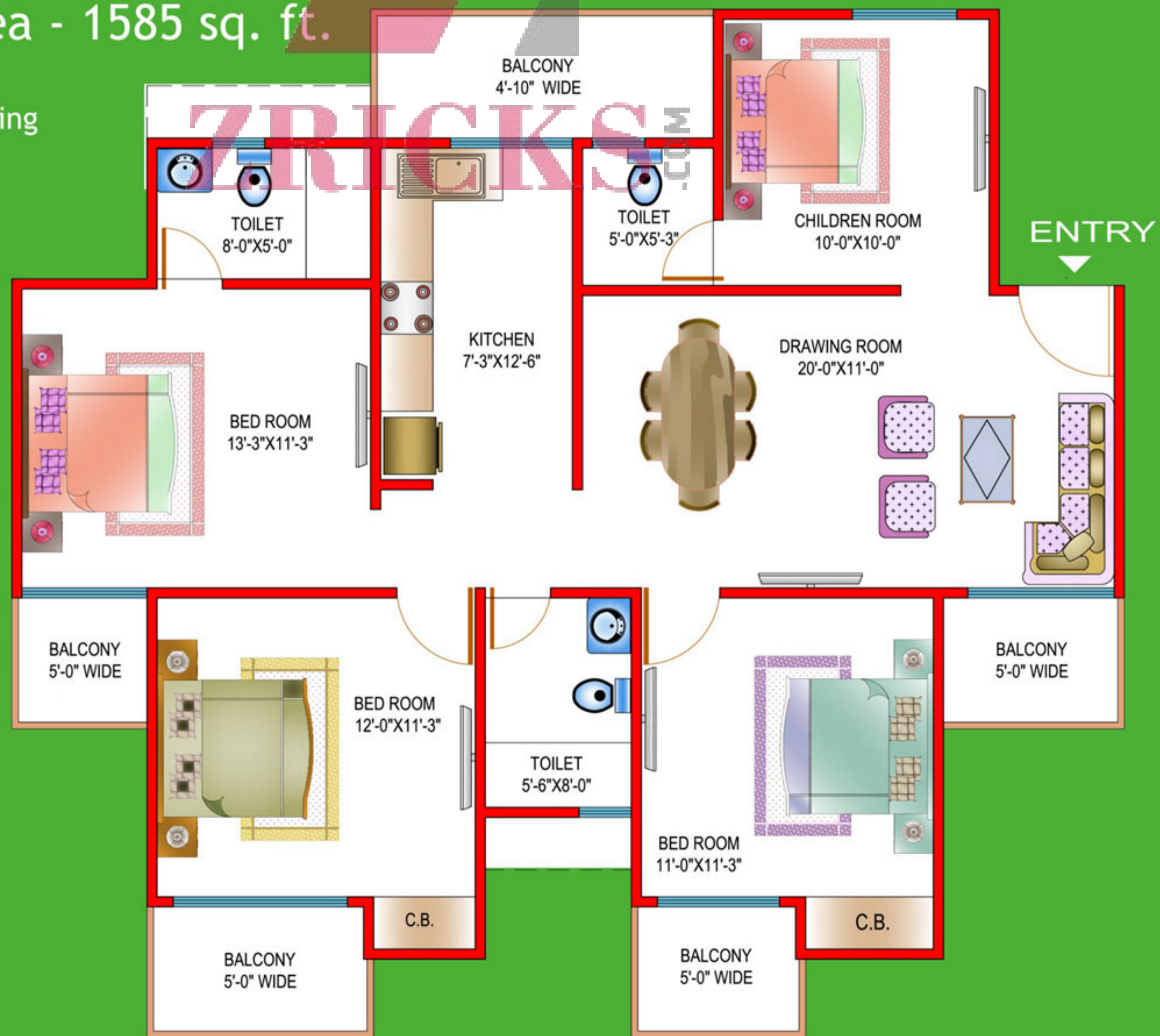

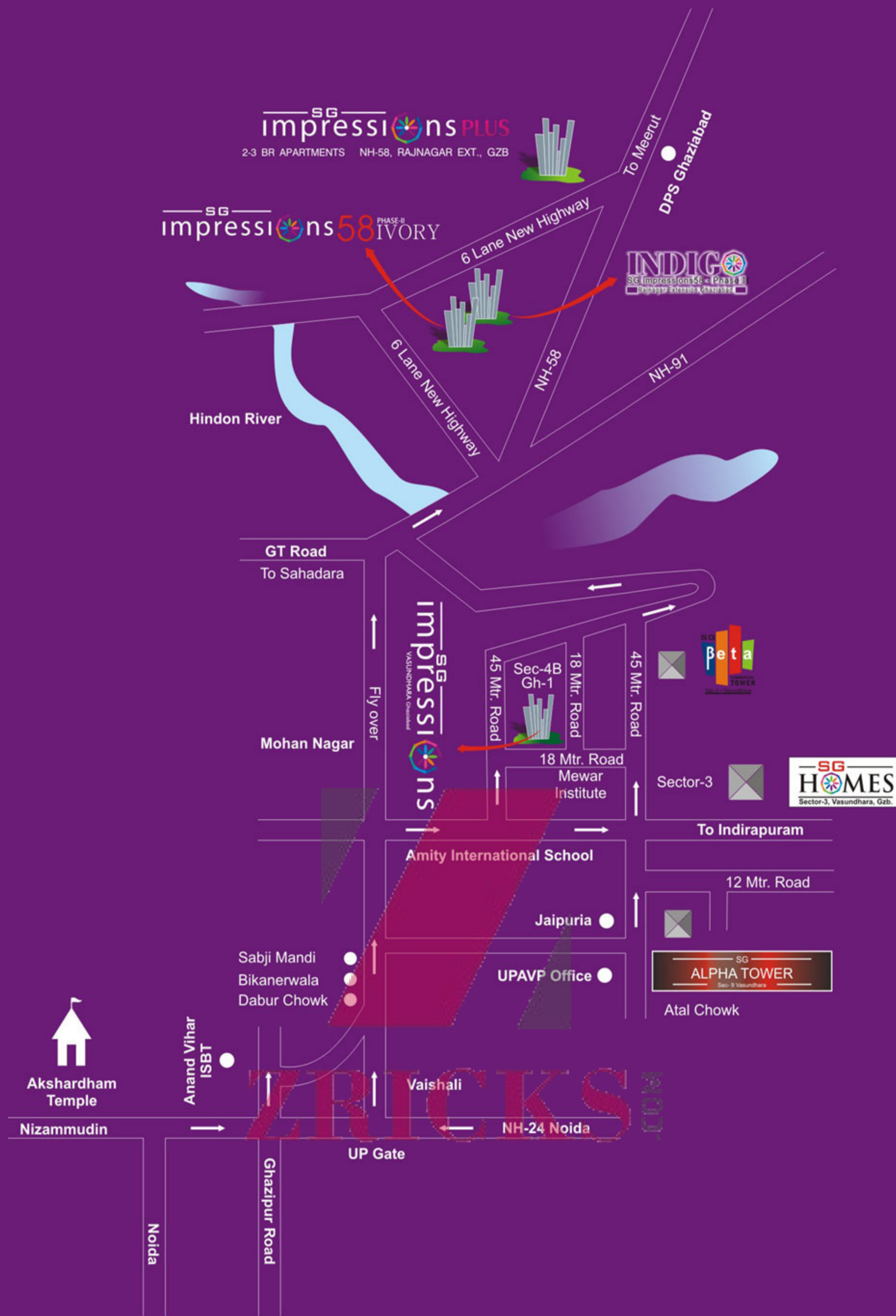

Our other Projects in Ghaziabad



SG HOMES, Vasundhara
(Construction Started)



SG Alpha Tower-1, Vasundhara
(Ready for possession)



Impressions58, Rajnagar Extn., Ghaziabad
(Ready for possession)



ImpressionsPlus, Rajnagar Extn., Ghaziabad
(Under Construction)



SG ESTATES LIMITED

QUALITY CONSTRUCTION, OUTSTANDING INTEGRITY

-An ISO 9001-2000 certified company-

105-106, Deep Shikha Tower, Rajendra Place, New Delhi-110008

Mob.: 9899951043, 9899975167, 9899979558 • Tel: 011-42323230 (Hunting Line) • Telefax: 011-42323244

Email : enquiry@sgestates.in • www.sgestates.in