



ZRICKS.COM







655 Sq.Ft.



1125 Sq.Ft.



Floor Plan 2055 SQFT

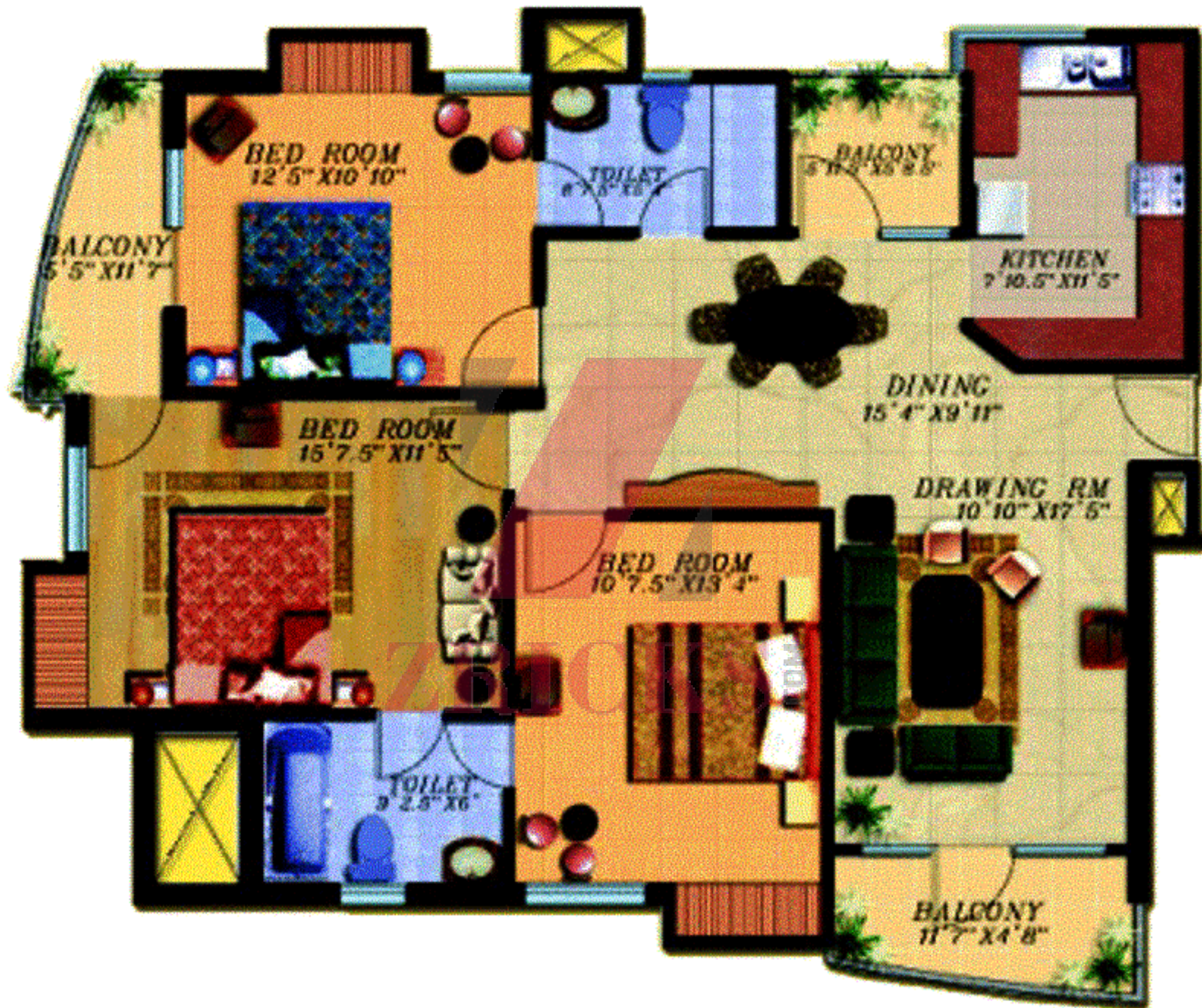

Floor Plan 1605 Sq. Ft.

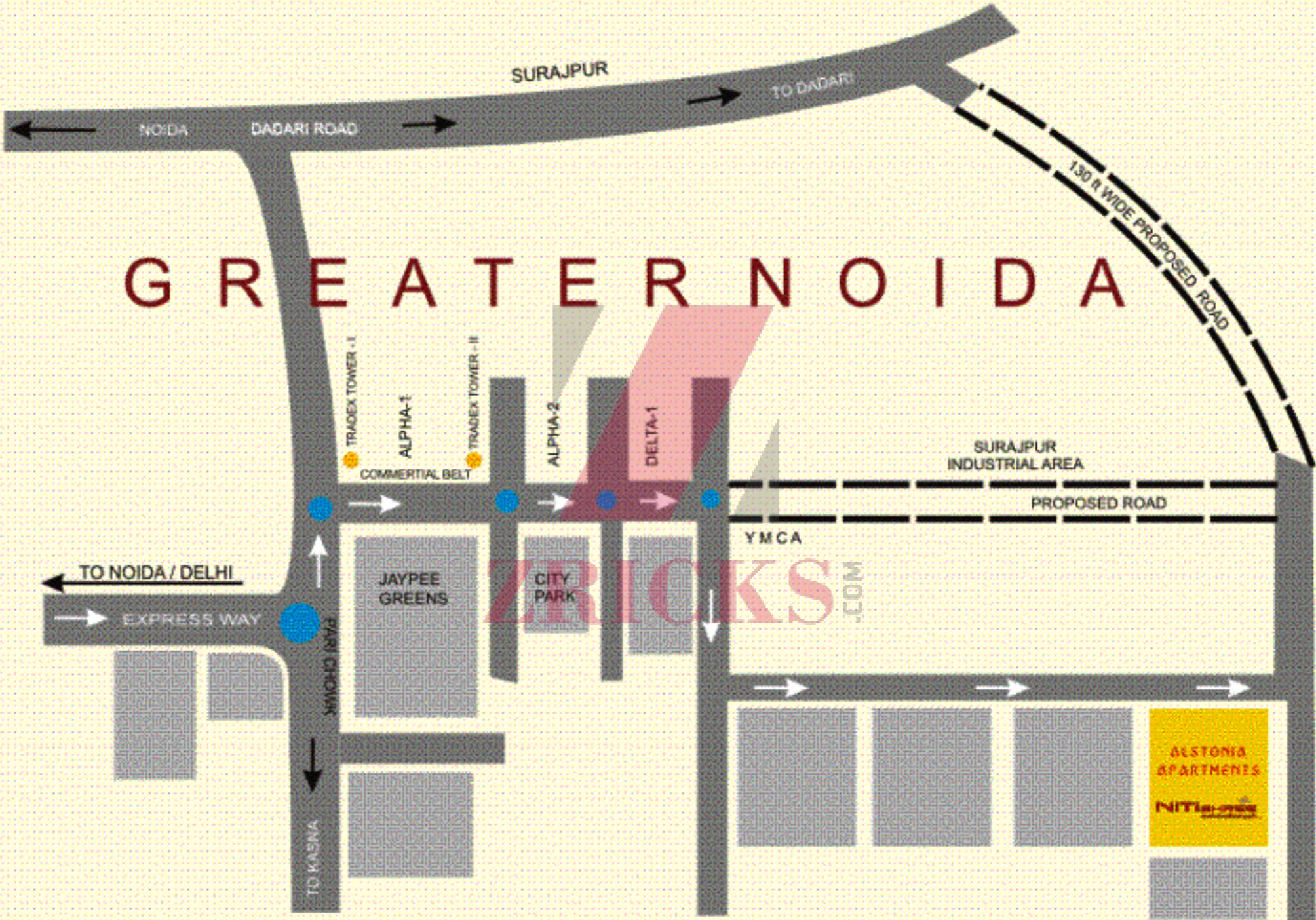

G R E A T E R N O I D A

NOIDA DADARI ROAD SURAJPUR TO DADARI

130 FT WIDE PROPOSED ROAD

TO NOIDA / DELHI EXPRESS WAY

PARI CHOWK TO KANWA

TRADEX TOWER - I ALPHA-1 COMMERCIAL BELT

TRADEX TOWER - II

ALPHA-2

DELTA-1

SURAJPUR INDUSTRIAL AREA

PROPOSED ROAD

YMCA

JAYPEE GREENS

CITY PARK

ALSTONIA APARTMENTS
NITIA-1998

Specificationsn

Structure

RCC frame structure. Earthquake resistant structure.

Construction:

Drawing, dining, bedrooms in vitrified tiles, and master bedroom with wooden flooring, kitchen, dress/toilets and balconies will have group IV ceramic tiles. Staircases and corridors in polished Kota Stone / Baroda green marble.

Doors & Windows:

All door and windows chowkhats in salwood/marindi with spirit polish/painted flush door shutters, polished painted wooden glazed window shutters. Designer main door fitted with night latch and door eye.

Wardrobes:

Specific space provision (clear of room sizes) in each bedroom.

Kitchen:

Granite work-top, stainless steel sink with drain board. Glazed tiles up to 2 feet height above work top. Geyser and exhaust fan will be provided as standard equipment in all the units. Woodwork without accessories below them working top. R.O. water system. Stainless steel sinks with drain board.

Toilet:

Branded glazed tiles and attractive borders up to door height. Standard chrome plated fittings with hot and cold water pipe system, shower, mirror and towel rail and ring.

Electrical:

Concealed conduits. Wiring with copper conductors with DBS and MCBS. Adequate light, power and fan in all rooms. Telephone points in drawing / living room and TV points in drawing / living rooms. All the rooms will have fans and light fittings as standard equipment.

Flooring:

Vitrified tiles in Drawing Room, Bedroom and Kitchen. Wooden Flooring in Master Bedroom, of your choice. Ceramic Tiles in Bathroom & Balconies. Internal and external finish Oil bound paint in pleasing shades on inner walls. POP cornice in drawing room and dining room.