



HomeToppers
InfraTech Private Limited

Laxmi Homes



ZIRCKS.COM



1 BHK
Super Area
600sqft.
RCC Slab
Area
495sqft.

2 BHK
Super Area
900sqft.
RCC Slab
Area
738sqft.

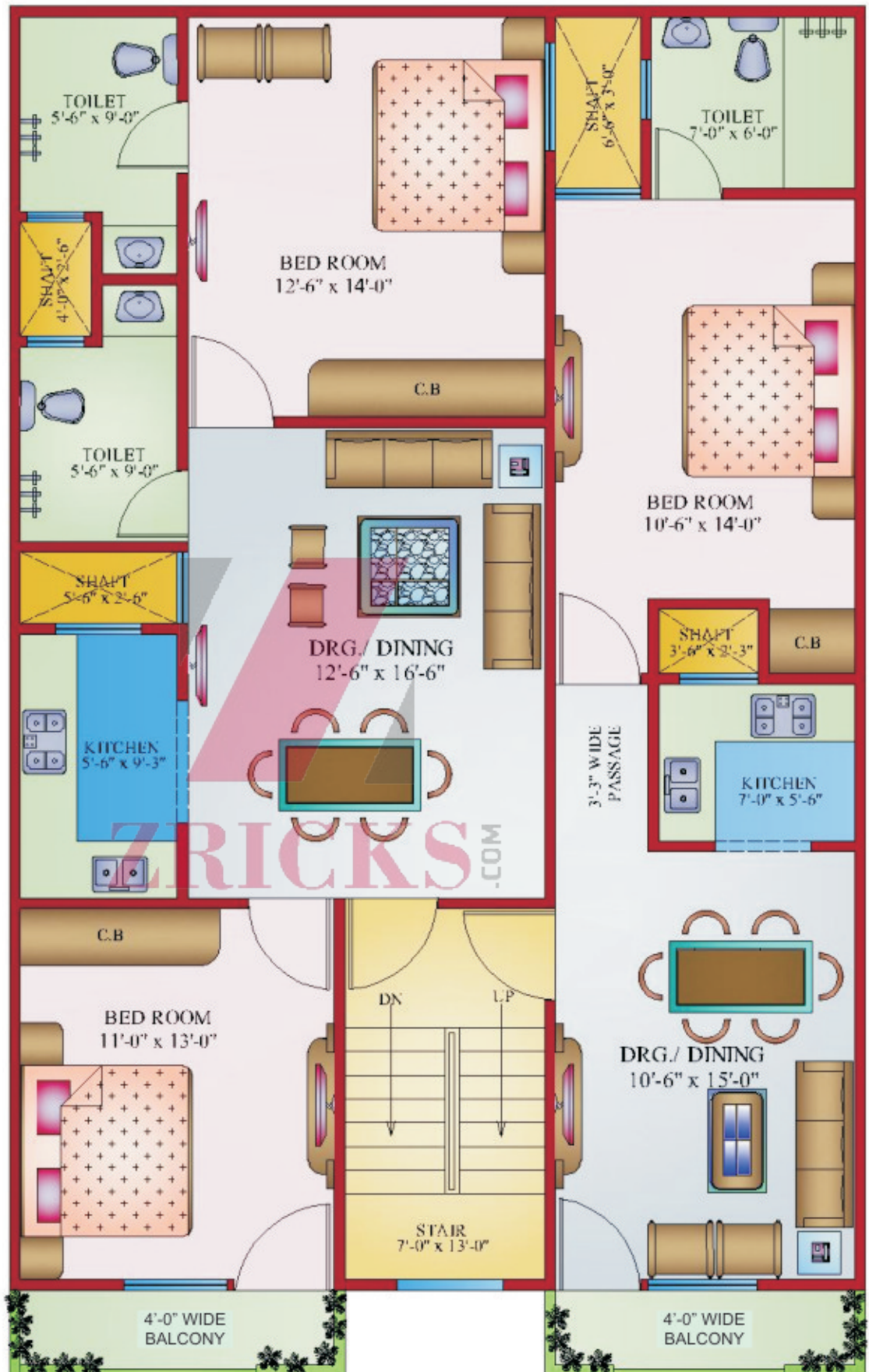

FRONT ROAD
TYPICAL FLOOR PLAN

Project Highlights

- Complete complex with all amenities and facilities.
- Composite RCC earthquake resistant structure
- Rain Water Harvesting
- Thoughtfully designed floor plan for maximum usable area
- Covered reserved car parking
- Hindware or Equivalent bathrooms fittings & Plumbing done with UPVC/CPVC pipes to avoid corrosion.
- Fully Modular Kitchen and Almirah.
- High ceiling apartments designed with floor-to-floor height of 10'ft.6".
- 24 hours water supply.
- Project surrounded residential Apartment (Crossing Republic & Gaur City).
- Leading Colleges, Institutions, Commercial complex, Hospital and Mall in close vicinity.
- **Flooring** : Vitrified tiles 2'x2' in Drawing - Dining room, kitchen, bedrooms and entrance lobby.
- **Kitchen** : Granite working top & stainless steel sink with drain board.
- **Wall & Ceiling Finish** : Designer POP work on drawing room, bedroom ceilings.
- **Doors & Windows** : All doors frame of Marandi or equivalent wood of designer look. Good quality hardware fittings.
- **Electrical** : Cooper wire in PVC conducts with MCB supported circuits and adequate number of points and light points on the wall / Ceilings.

Distance From

- Flat Facing 35ft. Authority Road.
- Connected with FNG Highway
- Gated Entry
- Sewar Connectivity
- 05 Min. Drive from NH-24
- 10 Min. Drive from Fortis Hospital, Noida
- 10 Min. Drive from Metro City Center, Noida
- 20 Min. Drive from Kalindi Kunj, Delhi