

## Location Map

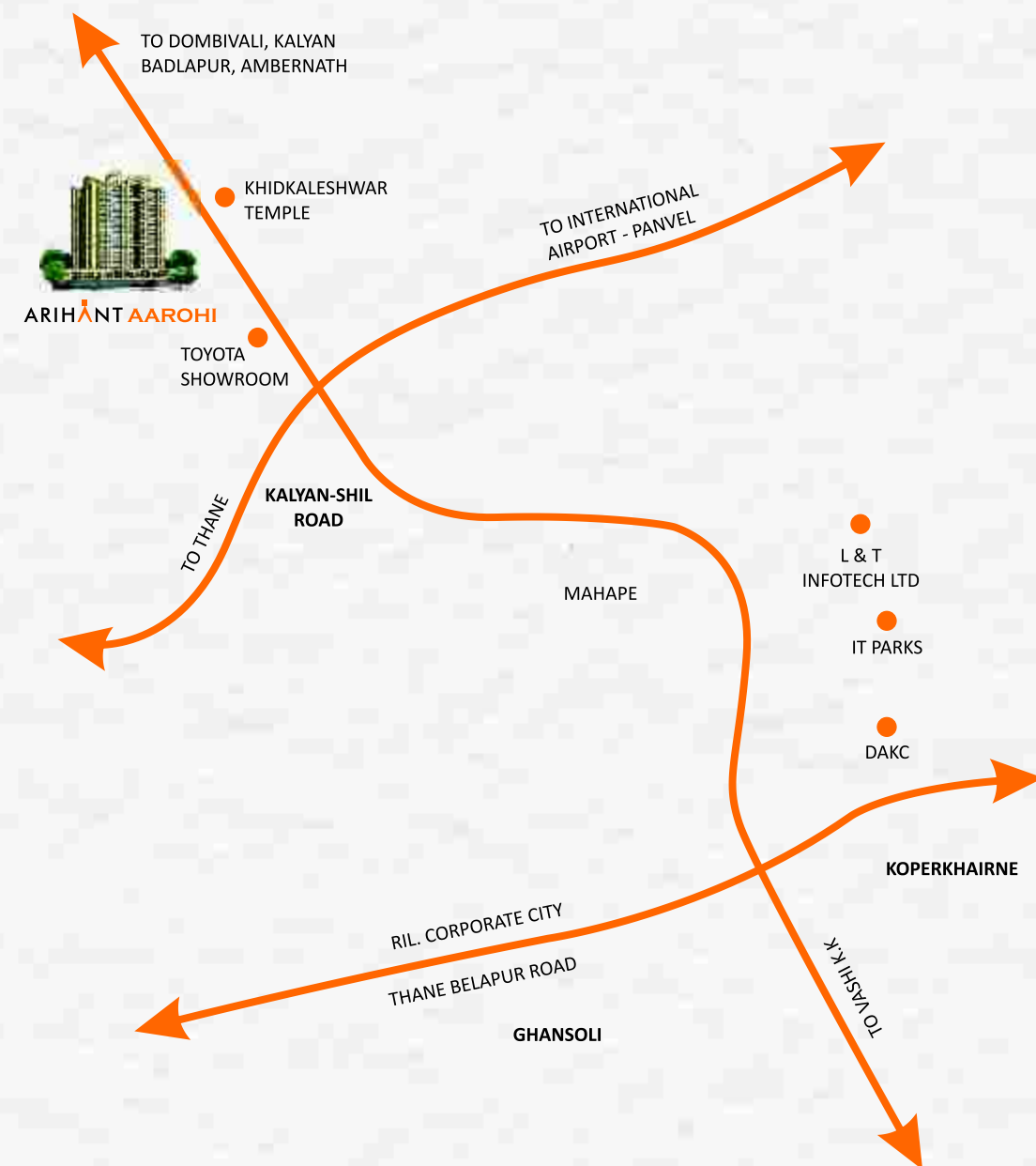

**ARIHANT**<sup>TM</sup>  
SUPERSTRUCTURES LTD.  
CONTINUING STABILITY

Site Address: On Main Kalyan - Shil Road.

Welcome to a junction  
where luxury  
meets affordability

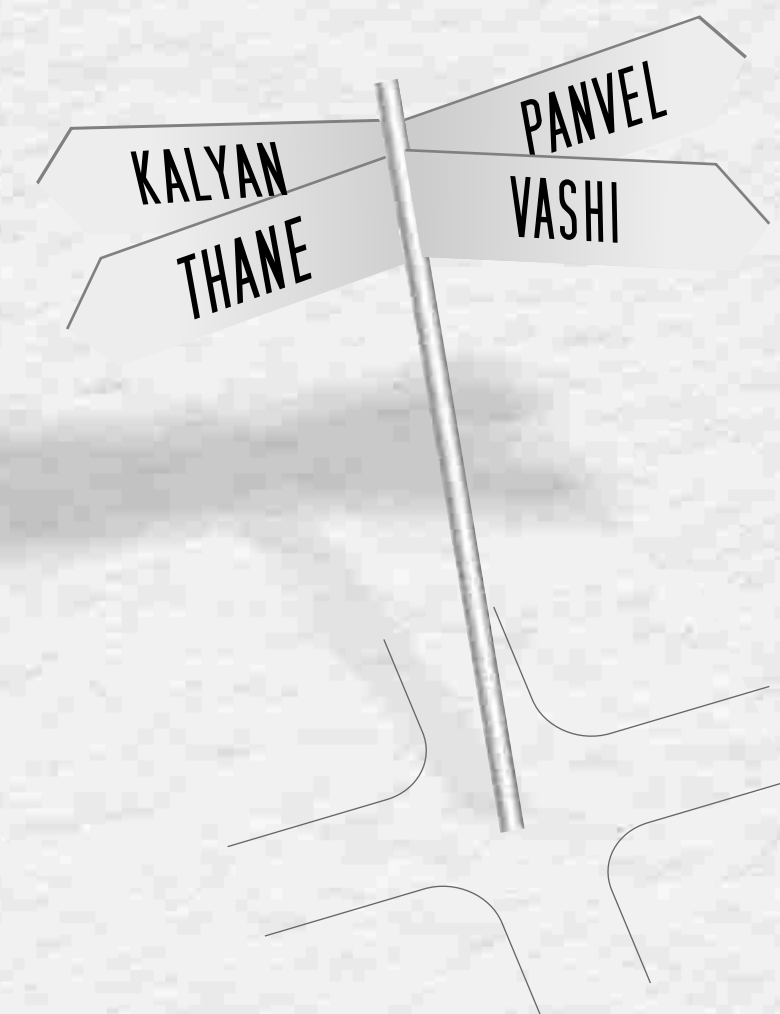

Corporate office: 302, Persipolis Building, Plot No. 74, Sector 17, Vashi, Navi Mumbai  
• Tel: 022 - 41113333 • Mob: 98925 09406, 88795 43912 • Fax: 2788 2946 • E-mail: sales@asl.net.in • www.asl.net.in  
SMS "ARIHANT" on 56161 to get quick project details

Disclaimer: All the plans, drawings, layouts, amenities, facilities etc, are subject to approval of the respective authority and would be changed, if necessary. The final discretion remains with the developers. All rendering and maps are artist's conception and not actual depiction of the building walls, driveways or landscaping and the developer reserves the right to make changes at any time, without notice or obligation, to the information contained in this brochure, including and without limitation to areas, amenities and specifications. The developer does not warrant or assume any legal liability or responsibility for the accuracy, completeness or usefulness of any information disclosed.





Presenting

# ARIHANT AAROHI

Kalyan - Shil Road.



Arihant Aarohi, a residential cum commercial project, is located in a unique place indeed. A place that's easily accessible from four popular suburbs: Kalyan, Thane, Panvel and Vashi.

Sooner than you realize, Kalyan-Shilphata itself is going to be one of the most sought-after areas. Arihant Aarohi comprises 2 towers of stilt upto 17-storeyed offering spacious 1 and 2 BHKs. Of course, being a prestigious Arihant project, expect truly world-class facilities. Indeed, there's everything you need to lead a truly world-class lifestyle. All at a cost that will come as a surprise to you.

#### Other Locational Advantages:

- 15 minute drive from proposed Usarghar Rly. Stn
- Close Proximity to Navi Mumbai IT Millenium park
- DAKC / Reliance Corporate City / Mindspace and other Business hubs
- Near Khidkaleshwar Temple
- Close proximity to schools, colleges and hospitals





## Enviably Outdoors

- Library Cum Study Area
- Indoor Games and Activity Area
- Swimming Pool
- Party Lawns with Garden
- Gymnasium and Steam room
- Children's play area
- Stainless Steel High Speed Lifts
- Designer Lift Lobby on all Floors
- Power Backup for Lifts Common Areas
- Pure Acrylic External Paint

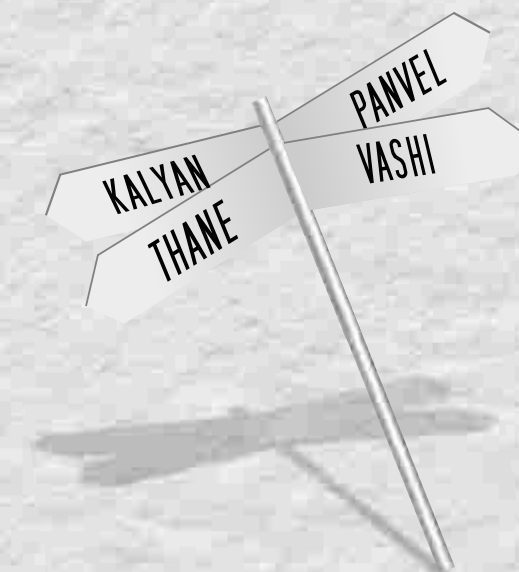





## Impressive Indoors

- indoor games and activity area
- Gas Hob and Chimney in kitchen
- Vitrified Flooring in all rooms
- Granite Top Kitchen Platform with full glazed tiles above platform with SS sink
- Toilets – Fully tiled upto beam level
- Concealed Plumbing with Premium Quality Fittings.
- Branded C.P fittings and sanitary ware
- Concealed wiring with ample Electrical Points and Modular Switches
- UPVC. Sound resistant French Windows
- Intercom facility in each flat
- Lusture or Velvet Touch Paint with POP in all rooms
- Provision of space for Wash Basin and Washing Machine
- Ceramic flooring on attached terraces

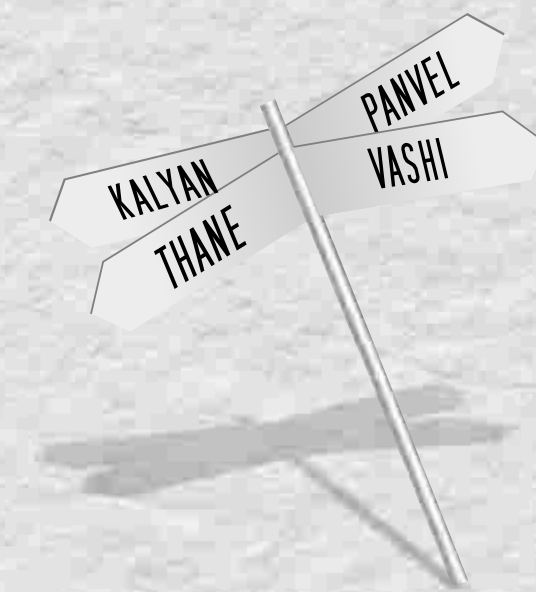



**ARIHANT AAROHI**  
Kalyan - Shil Road.

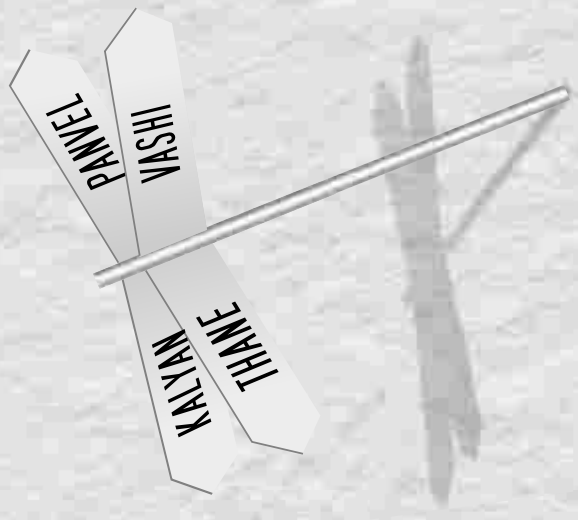

Master Layout

Layout

**ARIHANT AAROHI**  
Kalyan - Shil Road.

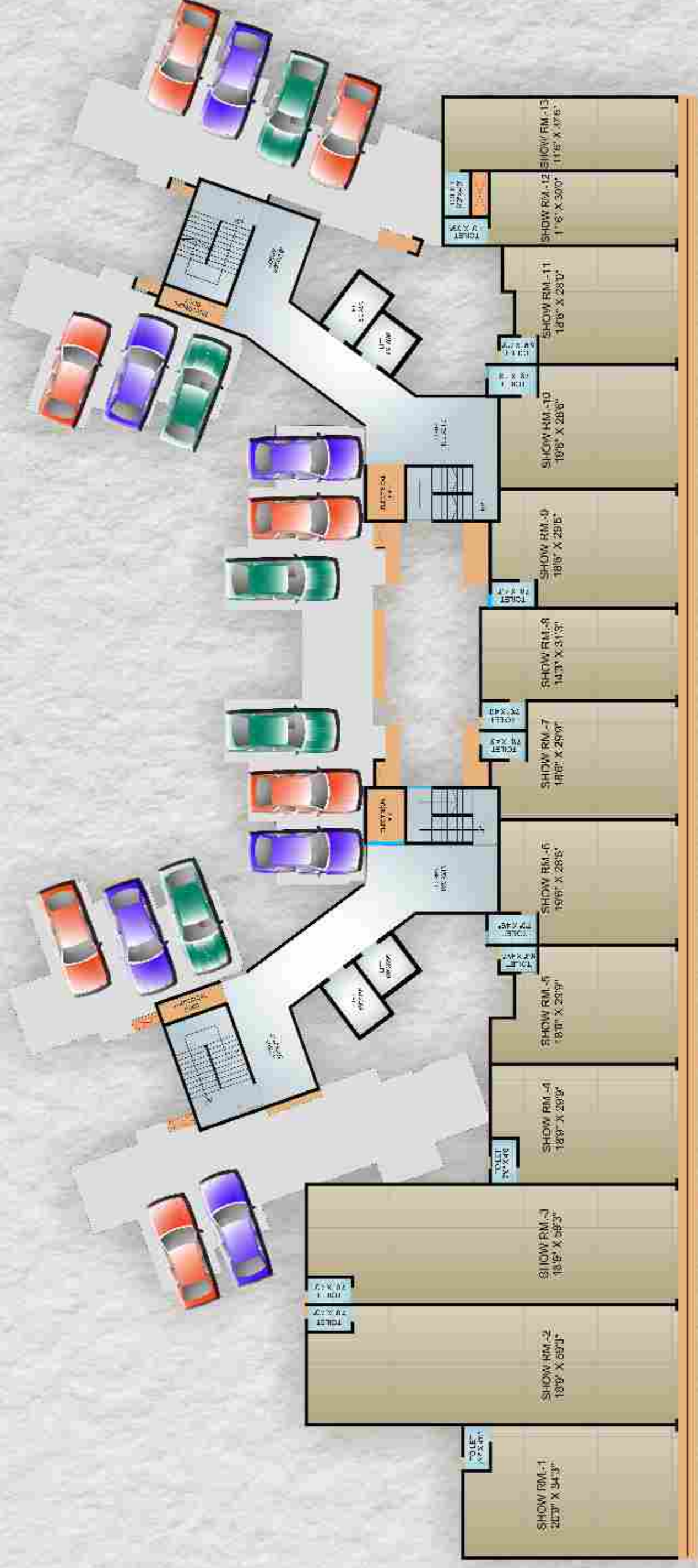

Ground Floor Shopping Plan



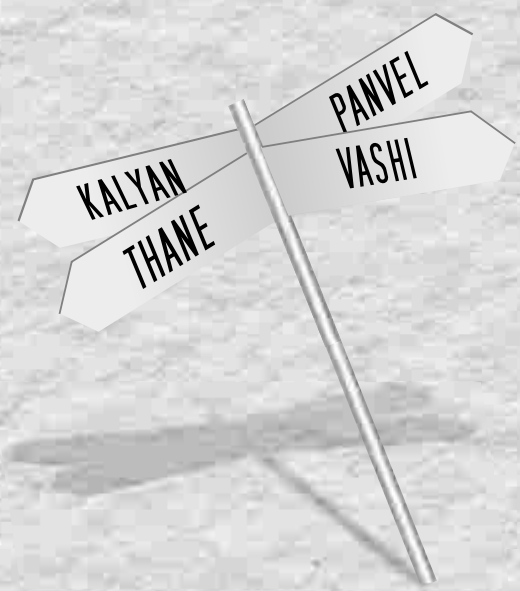

**ARIHANT AAROHI**  
Kalyan - Shil Road.

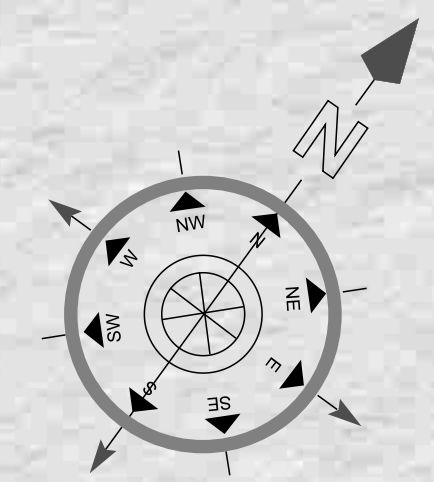

Typical Floor Plan