



Asvini

*Atvarika*

K e l a m b a k k a m



*W*

Welcome to a life of timeless luxury,  
elegance and exclusivity.

A life that will be admired by others.

A life that will elevate your status.

A life that will fulfill all your aspirations,  
both now and in the future.



Asvini

Atvarika

Kelambakkam





Sea Life In A New

# Perspective

A magnificent haven for the select few, Asvini Atvarika offers you an unparalleled opportunity to perfectly balance your work and leisure in an ambiance of captivating beauty and welcoming tranquility.

Designed to delight & built to international standards, this spectacular residential paradise is a charming constellation of just 55 premium apartments in sizes ranging between 1500 & 1750 sq. ft.

Refreshingly enveloped by a picture perfect view of the backwaters on one end and the glistening sea on the other, this opulent landmark brings together the best of natural splendor and urban luxuries to offer residents a distinguished and privileged lifestyle, like none other.



Double Happiness!

Double

*Rewards!*



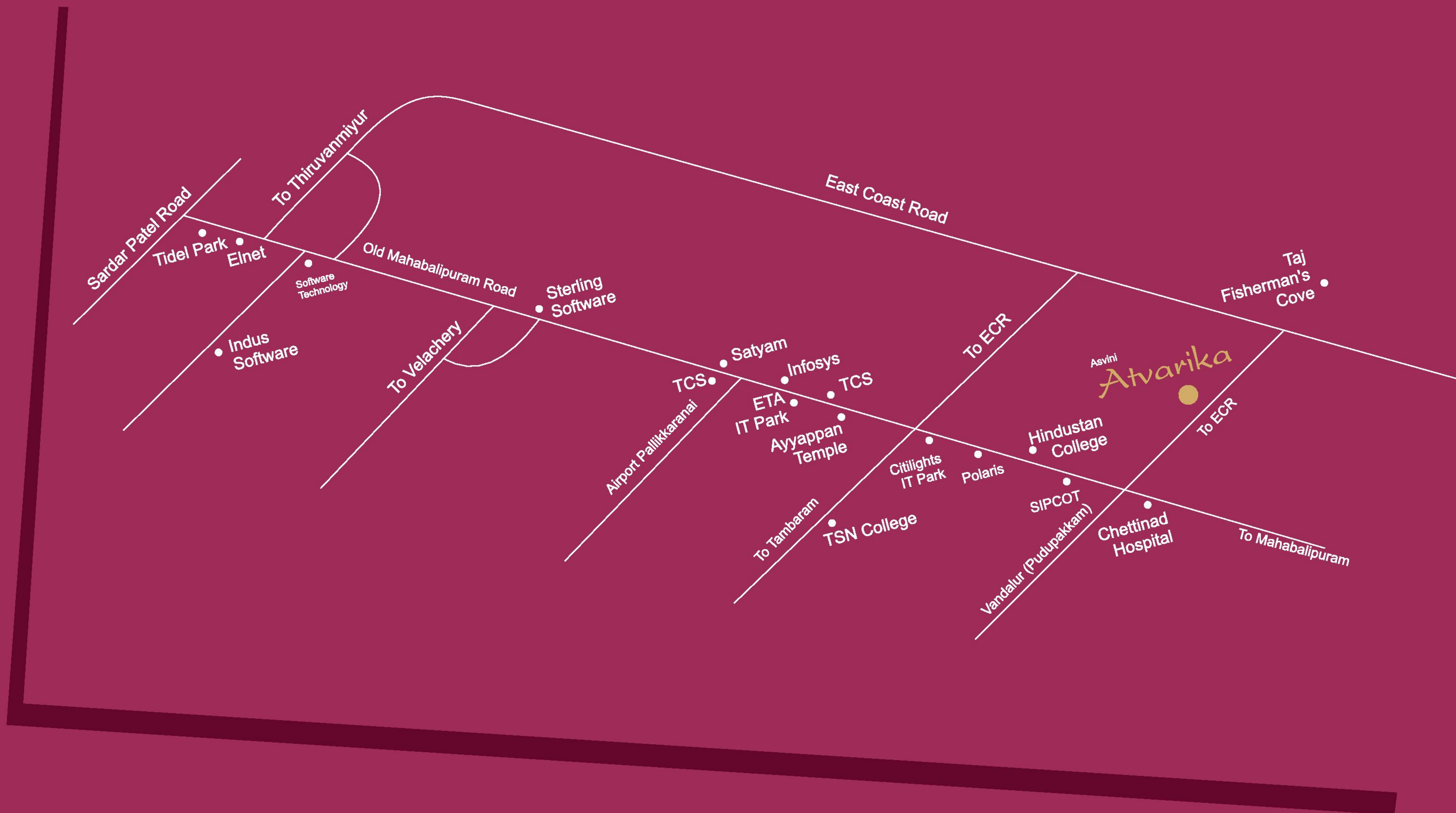

A first-of-its-kind project on the Kelambakkam- Kovalam Main Road, investing in Asvini Atvarika guarantees multifold returns on investment, due to its prime location with access to ECR & OMR. Asvini Atvarika benefits from the dual advantages that ECR & OMR present to the intelligent investor.

Asvini Atvarika also enjoys close proximity to many renowned educational institutes, IT firms, hospitals, shopping hubs, retail outlets, banks, places of worship, entertainment centers and restaurants and is well connected to all parts of the city through a good network of roads.

And a home at this remarkable development will ensure that your weekdays are active while the weekends are spiced with entertainment and excitement.

Perfecting The Art Of Perfect

*Living*



Asvini

**Atvarika**  
K e l a m b a k k a m

## Amenities

Embellished with an exceptional array of alluring amenities, Asvini Atvarika strings together the best in comfort, style and sophistication to redefine the concept of luxury living like never before.

- Swimming Pool • Power Back-Up • Children Play Area
- Terrace Party Area • Shuttle Court • Extensive Landscape



Homes That Reflect Opulence And

*Luxury*



## Specifications

- Vitrified Tile flooring
- Designed ceramic tiles on toilet walls
- Anti-Skid ceramic tile flooring for toilets
- Granite cooking platform with Caryl sink
  - Sanitaryware - Parryware / Hindware
- Bathroom Fittings - Jacquar Continental range
- Windows of Wooden / Aluminium frames and shutters
  - Putty Finish for living and dining
  - Modular Switches
- Sewage Treatment Plant
- Extensive Rain water harvesting
  - Covered / Open car Park

## Typical Floor Plan first to tenth floor



Flat No.	Built Up Area	Common Area	Saleable Area	Terrace Area
A	1439	301	1740	-
B	1295	271	1566	-
C	1380	288	1668	-
D	1354	283	1637	-
E	1326	277	1603	-



# Typical Floor Plan

## Eleventh floor



Flat No.	Built Up Area	Common Area	Saleable Area	Terrace Area
A	1207	252	1459	239
B	1070	224	1294	218
C	1380	288	1668	-
D	1179	246	1425	175
E	1156	241	1397	170

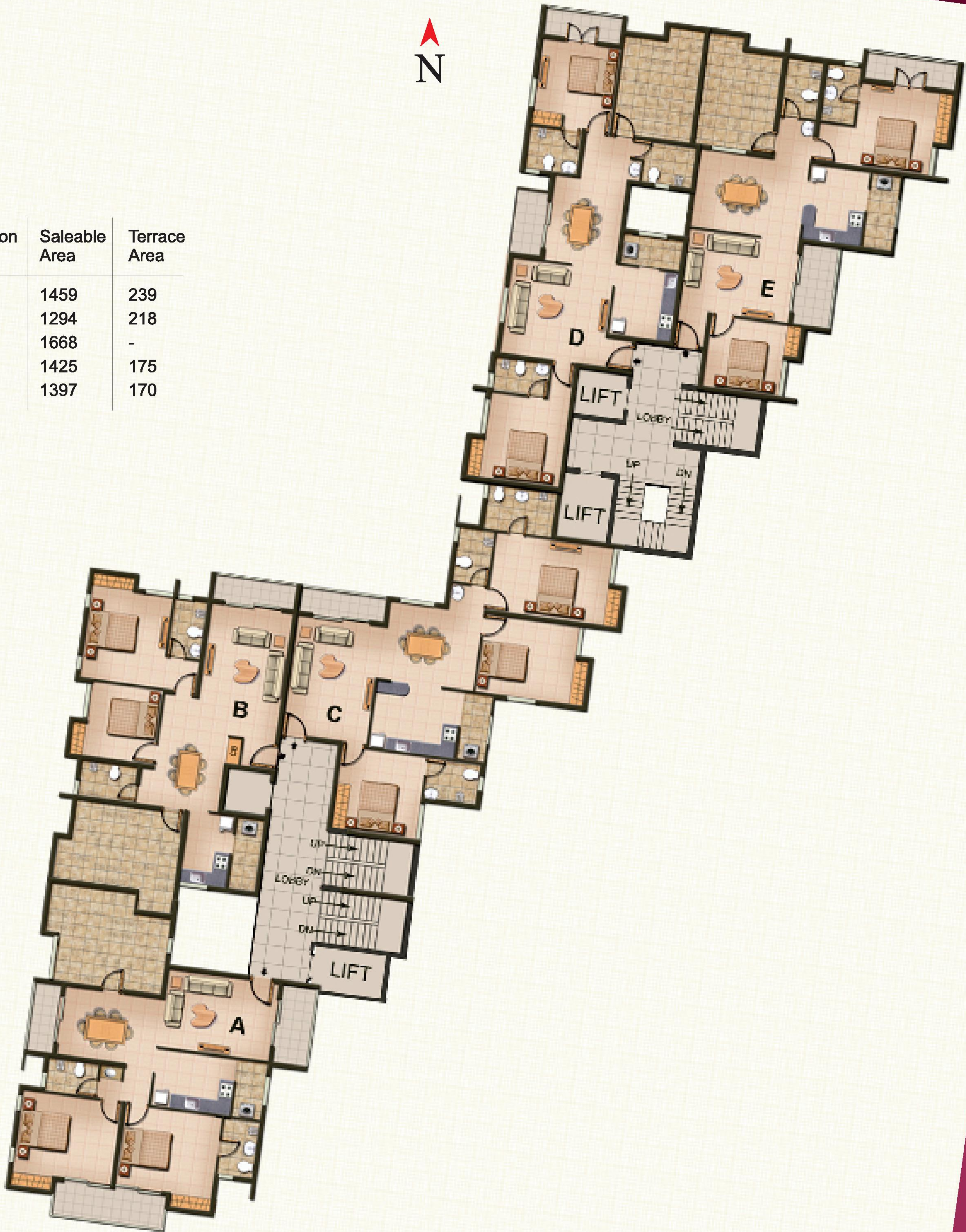

**PLANNING PERMIT No. 16/2011**

**BUILDING PERMIT No. 08/2011**

**ARCHITECT :**

Mrs. Sujatha K. V.  
M/s. Dimensions  
No.187, Habibullah Road,  
T.Nagar, Chennai – 600 017.  
Mobile No. 98407 98081  
Email - sujatha@jainhousing.com

**FAÇADE ARCHITECT :**

Mr. Vijay Bargoitra  
M/s. Dhrishticone  
32, First Cross Street, Second Floor, Kasturba Nagar,  
Adyar, Chennai - 600 020.  
Mobile No. 94440 25674  
Email : info@dhrishticone.com

**STRUCTURAL CONSULTANT :**

Mr. P. Raman, M.E., (Strs)  
PR Complex- 2nd Floor (No.207)  
No.38, Thambiah road Extension, West Mambalam,  
Chennai - 600 033. Mobile No. 98402 02004  
Email - raman\_str@yahoo.co.in

**PLUMBING & ELECTRICAL CONSULTANT :**

Mr. Salil  
M/s. Sumanam Engineering Services (P) Ltd  
66, II Floor – 7, Baba Foundations, Spurtank road,  
Chetpet, Chennai - 600 031.  
Telephone No. 044 - 6462 1545

**LANDSCAPE :**

Mr. Velayudam  
M/s. VVM Designs  
38, GN Chetty Street,  
Mylapore,  
Chennai – 600 004.  
Mobile No. 94441 04763

**PROJECT MANAGEMENT CONSULTANT :**

Mr. R. Jeevanandam  
M/s. MICRO PLAN  
No : 9, 2nd Floor, Dharma Towers,  
88 / 150, Nelson Manickam Road, Choolaimedu,  
Chennai - 600 094. Mobile No. 99401 73131  
Email : ramjee@airtelmail.in

## Pioneering Excellence Since *1999*

Year 1999 witnessed a pioneer emerge in the real estate industry - Asvini Foundations. Since then the company has relentlessly transformed the skylines for over 11 successful years with innovative designs, superior technology and impeccable craftsmanship. Today the name Asvini is synonymous with trust, stability, excellence and customer satisfaction, and the reason behind 1000 happy smiles. Blending in beautifully, style with elegance, each home at Asvini reflects the true charm of opulence and a life of unmatched splendor.

Winner of the Coveted  
**CNBC AWAAZ CRISIL - CREDAI  
REAL ESTATE AWARDS 2010**

In The Most Affordable Residential Property (Metros)  
Category For **Asvini Amarisa Ramapuram**

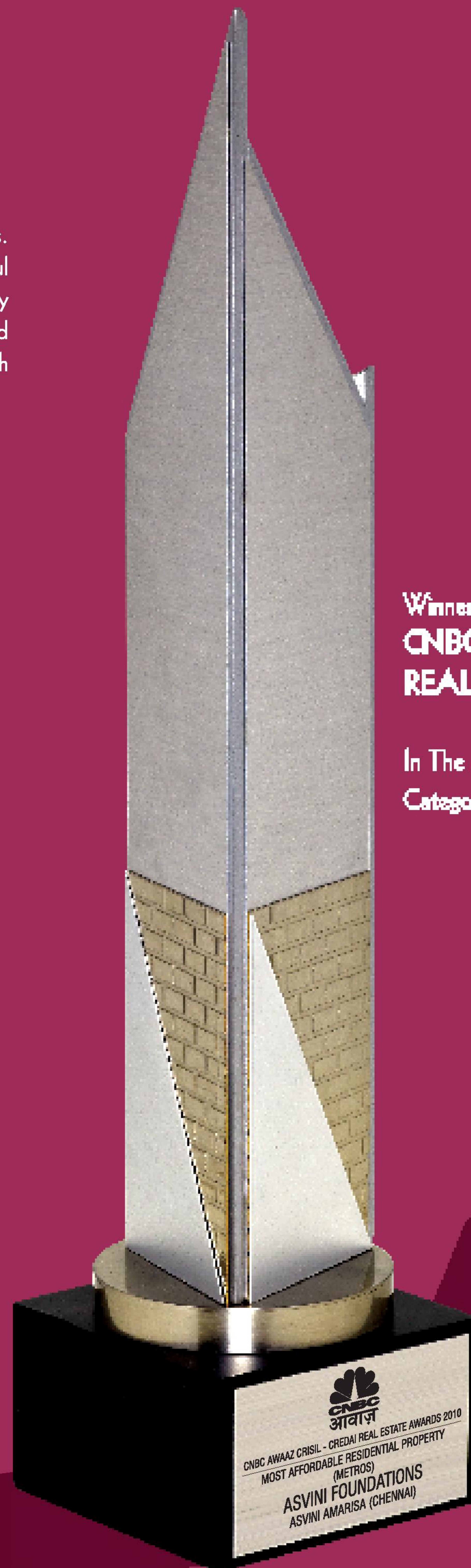

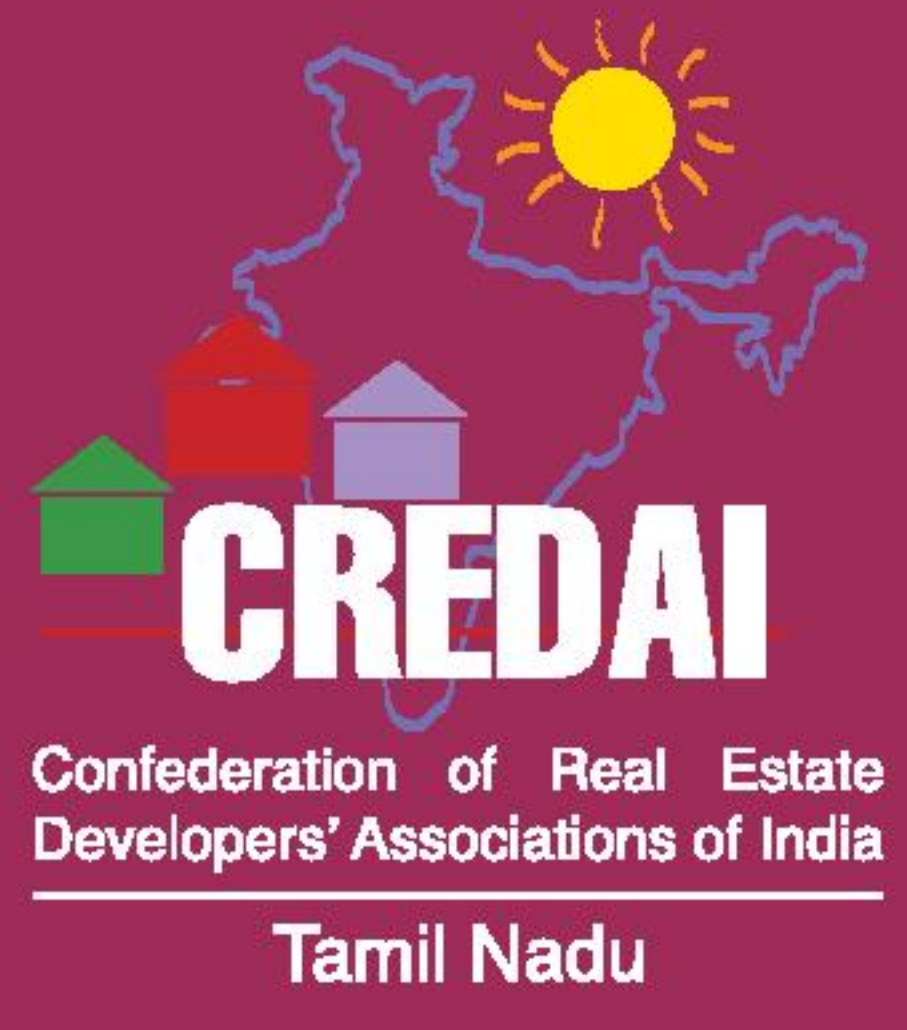

[www.asvini.com](http://www.asvini.com)



Marketing Office : Plot No. 27, Elango Nagar, OMR, Kottivakkam,  
Opp. to Indian Oil Petrol Pump - SRP Tools, Chennai - 600 041.  
Ph: 2454 4500 / 4501 / 4502, 98416 77800, 98416 77600