

# THE FRESHER SIDE OF LIFE



Live life fresh  
Airoli, Navi Mumbai



A PROJECT BY



**Office Address:** 225, Second floor, Big Splash, Plot No. 78 & 79, Sector 17, Vashi,  
Navi Mumbai- 400 705 | **Tel:** +91-22-2788 9991-98 | **Fax:** +91-22-27889982  
**Email:** info@akshardevelopers.com | www.akshardevelopers.com

**Site Address:** Gut No. 242, Hissa No.1 to 7, Near Patni Computers, Thane Belapur Road, Airoli, Navi Mumbai.

**Note:** All specifications, drawings, amenities, facilities, parameters, etc., shown in this brochure are subject to change as per the approval from the respective authorities. The final discretion remains with the developers.

# STEP INTO THE WORLD OF FRESHNESS



Live life fresh

Airoli, Navi Mumbai

1 ½, 2, 2 ½ & 3 BHK premium residences



# MEET THE LIFESTYLE OF THE FUTURE. MEET THE GREEN WORLD.

Standing in an expanse of 1, 15,000 sq. ft. stunning landscaping, Green World offers the most comfortable residences in Navi Mumbai. Open to the fabulous views and fresh air, graced by the impeccable design, modern amenities to enjoy, cherish the green living at its best.

#### Project hallmarks

- 11 majestic towers of 22 storeys each
- 1 ½ , 2, 2 ½ & 3 BHK premium residences
- 1,15,000 sq.ft. of Wi-Fi enabled podium landscaping
- Ultramodern clubhouse with health, recreation and wellness features
- Advanced security system with CCTV surveillance
- Adorned with world-class eco-friendly features
- Situated close to Airoli Railway Station
- In close proximity to schools, colleges, hospitals, restaurants & banks





# LIVE LIFE IN THE WELL-PLANNED METRO - NAVI MUMBAI

Navi Mumbai has been developed as a planned city and a counter-magnet for Mumbai. It has been developed as an independent, fully self-contained metro city. Navi Mumbai has been planned and developed by City and Industrial Development Corporation of Maharashtra (CIDCO) to meet the infrastructure needs of a modern metropolis. The Navi Mumbai Municipal Corporation (NMMC) administers the city and also operates public bus transport services. MIDC has played a vital role in the development of this city by successfully developing Airoli Knowledge Park and Millennium Business Park.

- Well connected to Mumbai & Thane by rail and road
- In close proximity to Digha railway station
- Navi Mumbai International Airport in progress
- Excellent motoring conditions with numerous flyovers, broad roads and parking lots
- Proposed hovercraft services from Vashi, Belapur, Nerul & Airoli to Gateway of India
- Famous shopping malls such as Centre One, Raghu Leela, Palm Beach Galleria, Citi Center and Inorbit
- All leading banks have branches throughout Navi Mumbai
- Biggest fresh fruits & vegetable market in Vashi
- Major business hubs in CBD Belapur, Vashi, Nerul & Mahape
- Important business landmark - Jawaharlal Nehru Port in Nhava Sheva
- DY Patil International Cricket Stadium in Nerul

# A SPREAD OF FRESHNESS

## SURROUNDING HAPPINESS IN DETAILS

- |                           |                        |                               |
|---------------------------|------------------------|-------------------------------|
| 01- Amphitheatre Seatings | 10- Tennis Court       | 19- Video Game                |
| 02- Jogging Track         | 11- Box-Cricket        | 20- Carrom                    |
| 03- Lawn                  | 12- Multipurpose Court | 21- Kitchen                   |
| 04- Hardscape Benches     | 13- Library            | 22- Banquet                   |
| 05- Pebbles Park Area     | 14- Gym                | 23- Pool Deck                 |
| 06- Arc Pergolas          | 15- Cafeteria          | 24- Swimming Pool             |
| 07- Senior's Aread        | 16- Card Room          | 25- Club Entrance Lobby       |
| 08- Waterbody Bubbles     | 17- T.T                | 26- Spa, Steam & Massage Room |
| 09- Kid's Area            | 18- Pool               |                               |



LIVE WHERE  
FRESHNESS  
IS ENABLED  
WITH TECHNOLOGY

THANE'S FIRST 1,15,000 SQ.FT.  
OF LUSH GREEN WI-FI ENABLED  
PODIUM LIFESTYLE.

- First-of-its-kind Wi-Fi Enabled Green Landscaping
- Landscaped Garden with Jogging Track
- Multipurpose courts
- Children's Play area with Sand Pit
- Amphitheatre for Community Activities
- Party Lawn with Designer Flowerbeds
- Senior Citizen's Park with Sit-outs
- Yoga & Meditation Deck



# LIVE WHERE PEACE, HEALTH AND WELLNESS LIVES

## FULL-FLEDGED CLUBHOUSE WITH HEALTH, RECREATION & WELLNESS FEATURES

- Swimming Pool with Family Jacuzzi
- Ladies Indoor Pool
- Gymnasium with Steam & Sauna
- Banquet Hall
- Well-stocked Library
- Cafeteria
- Children's Activity Room
- Indoor Games with Snooker, Table-tennis & Carrom



# LIVE WHERE ELEGANCE RESIDES WITH YOU

## APARTMENTS FEATURES

- Grand Living Room with Terrace
- Spacious Bedrooms
- Designer Kitchen with Granite Platform
- Bathrooms with World-class Sanitary Ware







# LIVE WHERE ENVIRONMENT IS YOUR FRIEND

## ECO-FRIENDLY FEATURES



### CLEAN & POLLUTION FREE NEIGHBOURHOOD

Green World offers a clean and pollution free environment to all the residents. You can live a healthy life here.



### RAIN WATER HARVESTING

Green World uses methods for rain water harvesting and other water conservation techniques to save this great resource.



### ENERGY EFFICIENT APPLIANCES AND LIGHT BULBS IN COMMON AREAS

There are many ways in which Green World conserves energy and resources in the complex. Usage of energy saving bulbs and appliances makes this world look more fresh and conscious towards the environment.



### PROVISION OF SEWAGE TREATMENT PLANT

As a global community we need to re-think the way we dispose sewage and waste water. For this purpose, Green World offers a standardised sewage treatment plant to reduce lifetime costs and create a sustainable environment.

# AT A GLANCE

## PROJECT HALLMARKS

- 11 majestic towers of 22 storeys each
- 1 ½ , 2, 2 ½ & 3 BHK premium residences
- 1,15,000 sq.ft. of Wi-Fi enabled podium landscaping
- Ultramodern clubhouse with health, recreation and wellness features
- Advanced security system with CCTV surveillance
- Adorned with world-class eco-friendly features
- Situated close to Airoli Railway Station
- In close proximity to schools, colleges, hospitals, restaurants & banks

## ECO-FRIENDLY FEATURES

- Clean & Pollution Free Neighbourhood
- Rain Water Harvesting
- Provision of Sewage Treatment Plant
- Energy Efficient Appliances and Light Bulbs in Common Areas

## LAVISH PODIUM FEATURES

- First-of-its-kind Wi-Fi Enabled Green Landscaping
- Landscaped Garden with Jogging Track
- Multipurpose Courts
- Children's Play area with Sand Pit
- Amphitheatre for Community Activities
- Party Lawn with Designer Flowerbeds
- Senior Citizen's Park with Sit-outs
- Yoga & Meditation Deck

## ULTRAMODERN CLUBHOUSE FEATURES

- Swimming Pool with Family Jacuzzi
- Ladies Indoor Pool
- Gymnasium with Steam & Sauna
- Banquet Hall
- Well-stocked Library
- Cafeteria
- Children's Activity Room
- Indoor Games with Snooker,

## DAILY NECESSITIES & PROVISIONS

- Small offices
- Showrooms
- Clothing
- Mechanical & repairs
- Clinics
- Medical store
- Restaurants
- Fast food centres
- Supermarket
- Electricals & hardware
- Boutiques
- Beauty spa & salon

## INTERNAL FEATURES

### Flooring

- Vitrified (marbonite) flooring
- Designer ceramic finish in all terrace floorings

### Kitchen

- Granite kitchen platform with service platform
- Branded stainless steel sink
- Modular kitchen with full-height glazed tiles
- Elegant counter wash basin for dining area

### Toilets

- Spartex/ glazed tiles in flooring
- Full-height glazed wall tiles
- Premium fittings
- Provision for hot geyser in all attached bathrooms
- Provision for exhaust fans, non-wood FRP doors, concealed plumbing
- Chromium-plated towel rods and elegant counter wash basin in attached bathrooms

### Doors & Windows

- Panelled main door
- Internal doors- commercial veneer finished flush doors
- Anodized coated heavy section aluminium sliding on granite with tinted glass
- One panel of mosquito preventive net in all windows

### Walls & Paint

- Velvet paints of premium quality on interior walls

### Electrification

- Concealed copper wiring
- Adequate points and modular switches
- 1/3 phase electricity connection
- Circuit breaker ELCB

### Plumbing

- Concealed piping system in kitchen and all toilets
- First quality C.P fittings

### Security

- Intercom system for all flats with round-the-clock security



# PLANS

LOWER GROUND PLAN

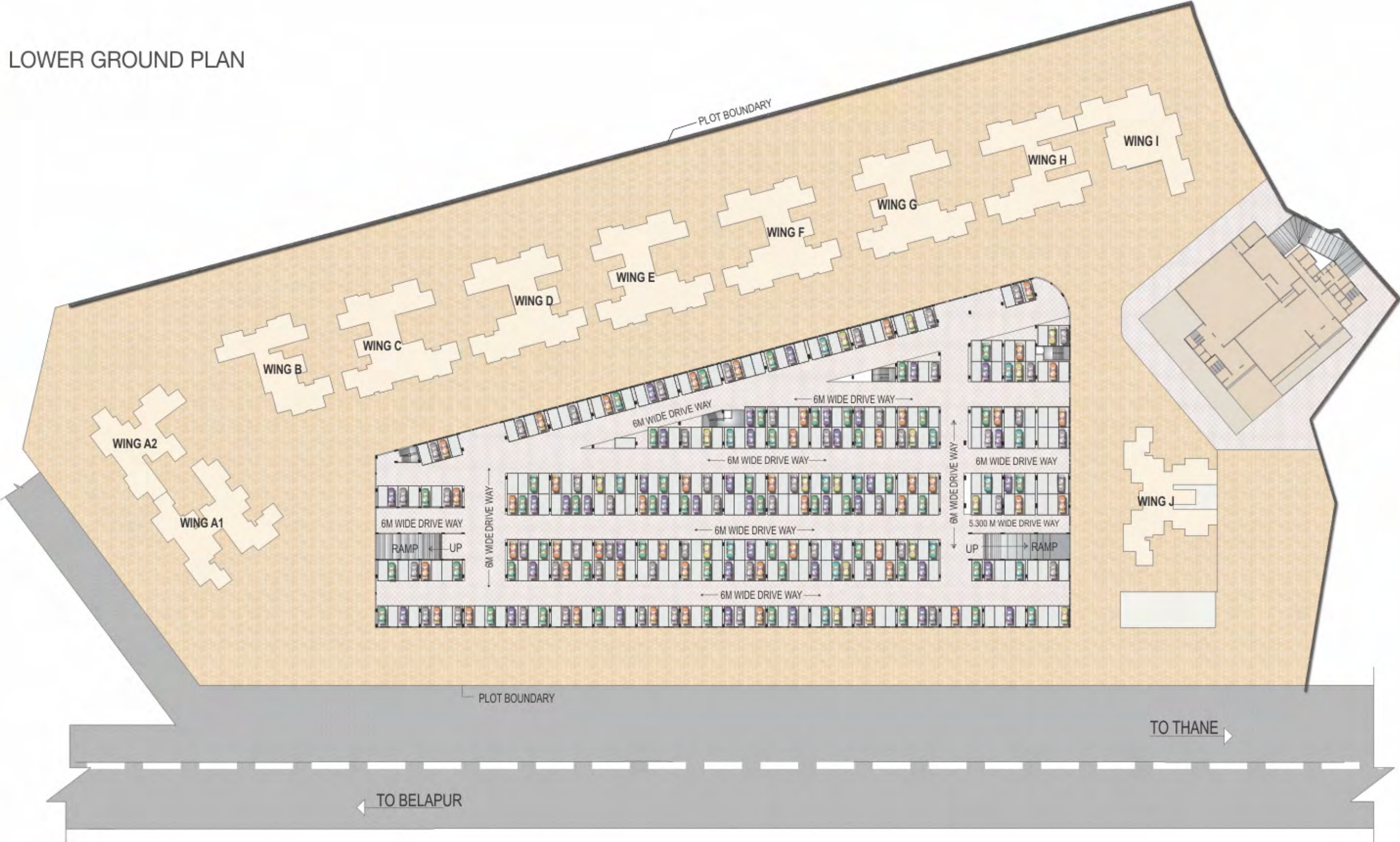



# PODIUM PLAN





WING - A2  
ODD FLOOR PLAN  
2 & 2.5 BHK

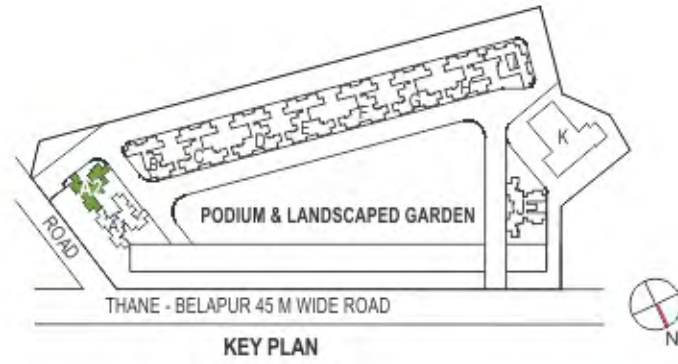

Note: Flat No. 101 & 102 are Terrace Flats

WING - A2  
EVEN FLOOR PLAN  
2 & 2.5 BHK

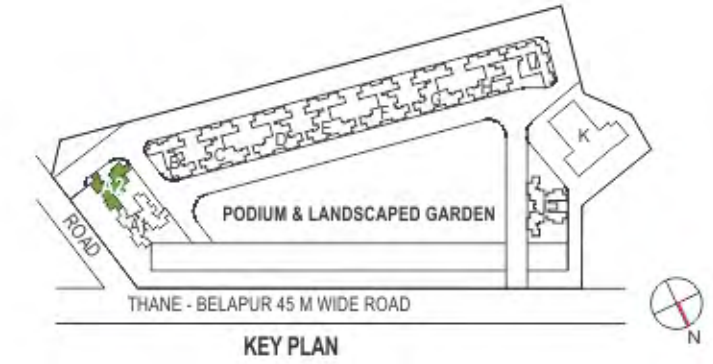



**WING - B**  
**ODD FLOOR PLAN**  
 1.5, 2 & 3 BHK

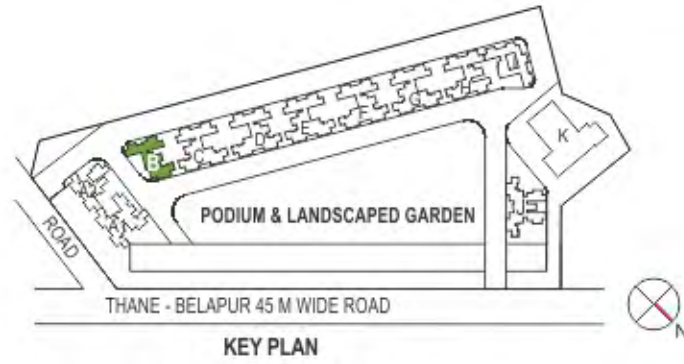

**WING - B**  
**EVEN FLOOR PLAN**  
 1.5, 2 & 3 BHK

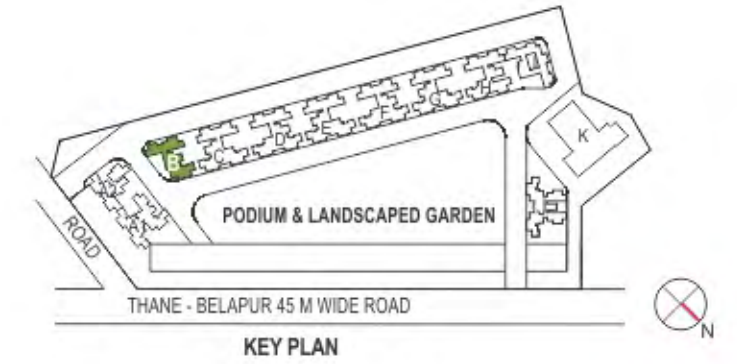

WING - C, E & G  
ODD FLOOR PLAN  
2 & 3 BHK

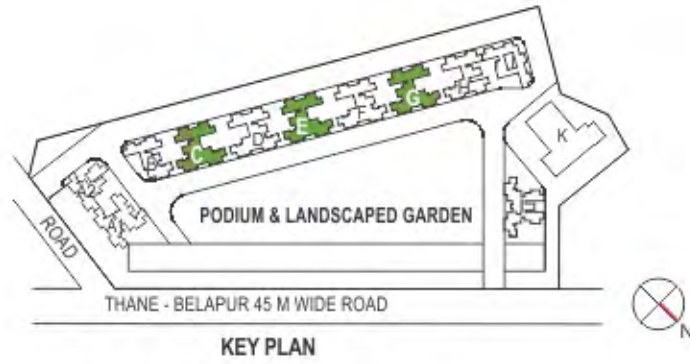

WING - C, E & G  
EVEN FLOOR PLAN  
2 & 3 BHK

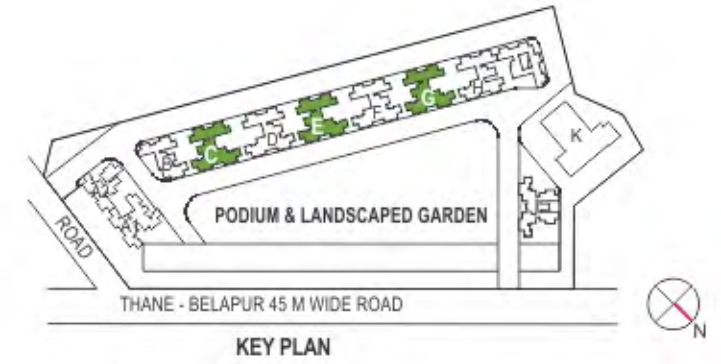



WING - H  
ODD FLOOR PLAN  
2 & 3 BHK

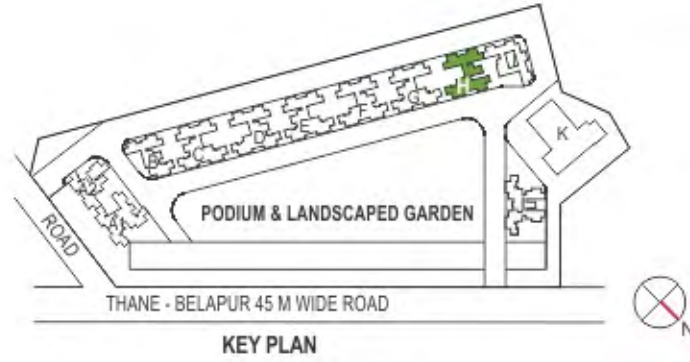

WING - H  
EVEN FLOOR PLAN  
2 & 3 BHK

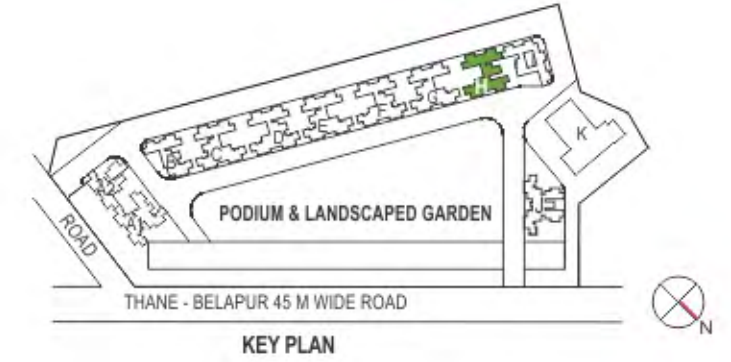

WING - I  
ODD FLOOR PLAN  
1.5 BHK

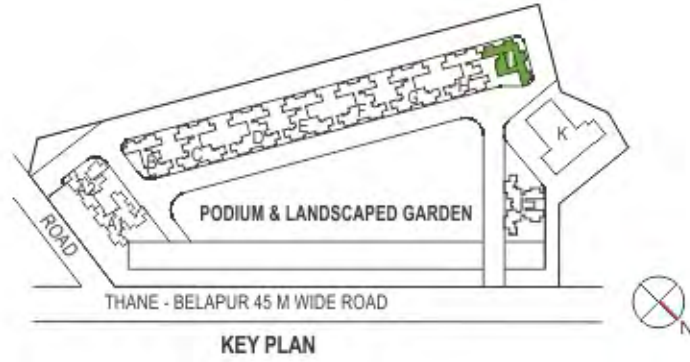

WING - I  
EVEN FLOOR PLAN  
1.5 BHK

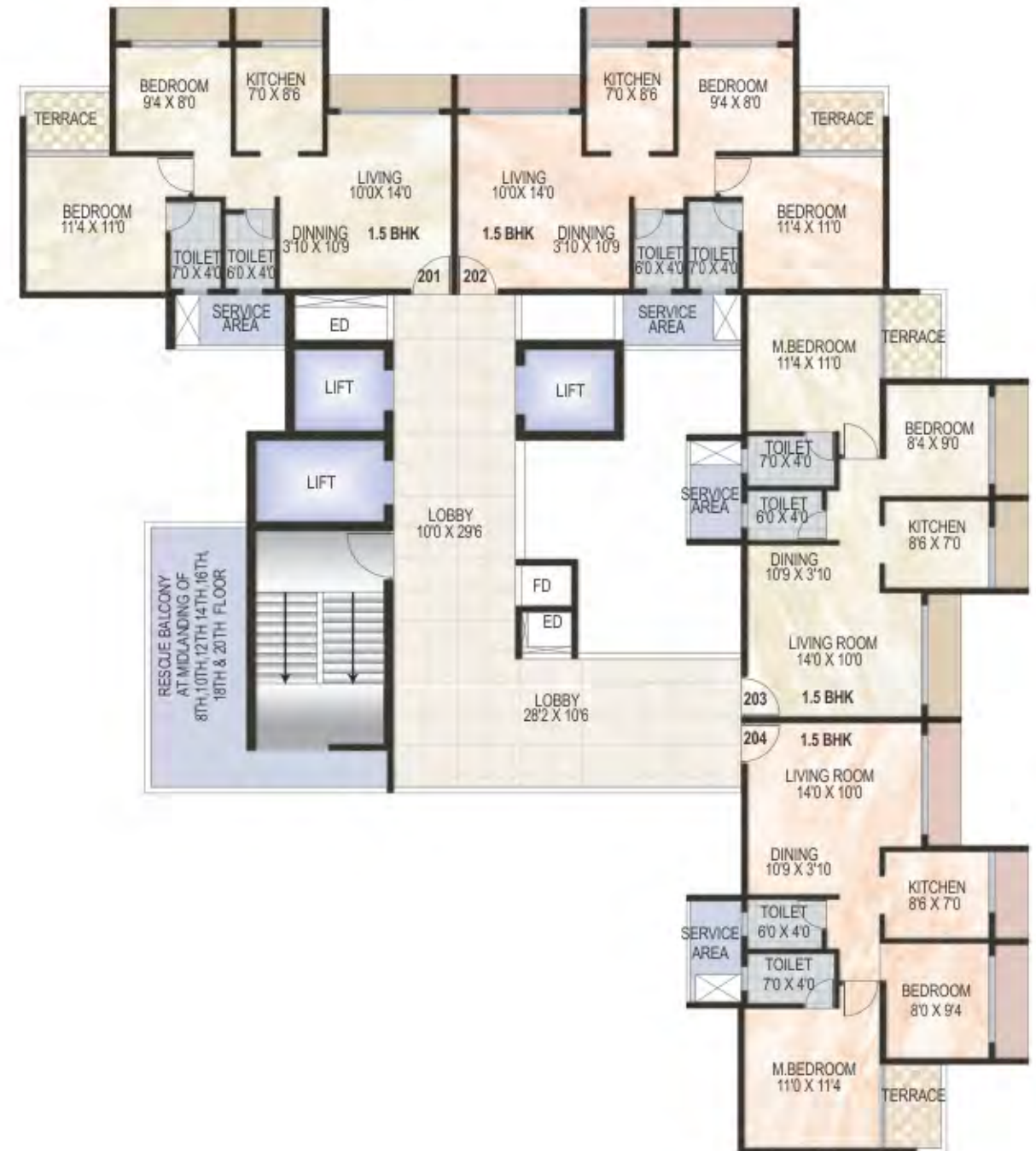
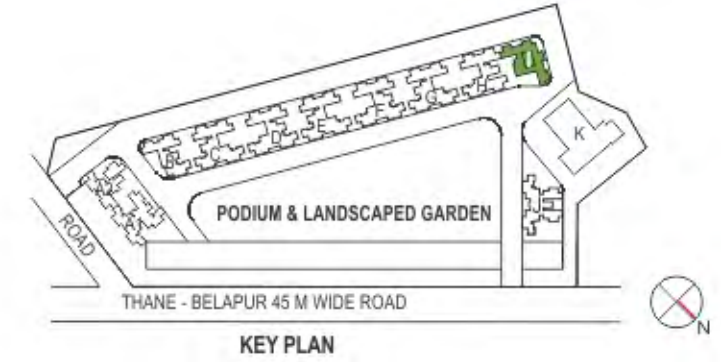

# THE MAKERS



The foundation of Akshar developers was on the real estate entrepreneurial insight and the passion to achieve the next level within stipulated time. The dream cherished and nurtured by Chairman Shri Bachubhai Patel, a force behind 15 year old Akshar brand.

The company's growth can be credited to dynamic leadership of Director Mr. Ketan Patel. The dedicated, dynamic and qualified professional accelerated the growth of the company. This success story can be seen by its presence across the premium sector of real estate market at Mumbai, Pune and Ahmedabad.

The companies' clear focus in on trends and market demands while innovating the future for clients that reflects company's core values.

[www.akshardevelopers.com](http://www.akshardevelopers.com)