



SHALIMAR  
ONEWORLD  

---

VISTA

— THE WORLD WITHIN REACH —





The comforts  
of the World

WITHIN REACH

The luxuries  
of the World

WITHIN REACH



The home  
of your dreams

WITHIN REACH





THE WORLD. WITHIN REACH.



SHALIMAR  
ONEWORLD  
VISTA





## Vista by the Shalimar Group.

Located in Shalimar's signature township, OneWorld – the 212 acre 'City Of Dreams', Vista sets the new paradigm for approachable luxury residences in Lucknow. A part of Lake District, the most exclusive residential precinct in OneWorld, a residence in Vista isn't just your home, it's an entire city.





## Seven majestic towers and a life like no other.

Vista is a collection of seven stately towers which present one of the finest neighbourhoods to live in. Life in Vista is much more than just a comfortable life, it's the Vista life. A refined new experience. A life enveloped in nature, with abundant facilities, all necessities and warm luxuries.



The finest 2 and  
3 bedroom residences.

The perfect initiation to a life of luxury, Vista's splendid two and three bedroom residences come with tasteful interiors, space and contentment for the entire family.



VISTA  
LIFE.

A modern residential complex at dusk. In the foreground, a swimming pool is illuminated with blue lights. Several people are swimming in the pool. To the left, there is a wooden pergola with a wicker chair and a small table. To the right, there is a glass-enclosed lounge area with a white sofa and a woman sitting on it. In the background, several tall apartment buildings are visible against a twilight sky. The overall atmosphere is serene and luxurious.

# A life of comforts and conveniences.

Besides having easy access to all the facilities of OneWorld, Vista has a host of services with exclusive access for residents of the seven towers of Vista. From a choice of recreational and sports facilities, to kids' zones and community centres and a range of safety features to a landscaped central park.

# AMENITIES & FACILITIES



 Vista Clubhouse



 Gymnasium



 Leisure & Kids' Pool



 Central Park



 Water Features



 Kids' Play Area



 Multipurpose Community Hall

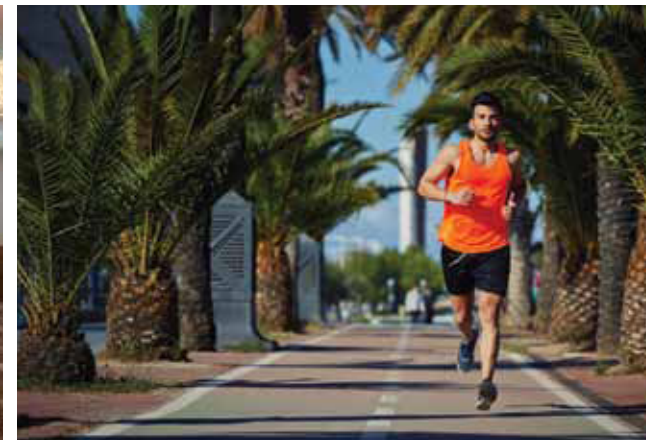

 Landscaped Jogging Track



 Sit-out Areas & Gazebos



 Double Height Lobbies In Every Tower



 Safety & Security Assurance



 24 Hour Power Back-up



VISTA  
HOMES.



The luxury of choice and promise of quality.

Vista homes come in a range of layouts and sizes to ensure you get the space of your dreams just as you desire. And every home comes with the assurance of world-class quality, best fittings and an impeccable finish.

# SPECIFICATIONS

## PROPOSED SPECIFICATIONS FOR ALL UNITS OF VISTA.

### STRUCTURE

Structure designed for the highest seismic considerations for the zone as stipulated by the BIS code and for better safety.

### FOUNDATION

Reinforced concrete footings & columns.

### ALL BEDROOMS

- Floorings / Skirting: Vitrified tiles / laminated wooden flooring
- Wall Finishes: Acrylic emulsion on POP punning
- Ceiling: Oil bound distemper

### LIVING/ DINING ROOM

- Flooring / Skirting: Superior quality vitrified tiles
- Wall Finishes: Acrylic emulsion on POP punning
- Ceiling: Oil bound distemper

### TOILETS

- Flooring: Antiskid Ceramic tiles
- Wall Finishes: Ceramic wall tiles upto dado level (approx. 2400 mm)
- Ceiling Finishes: Oil bound distemper with false ceiling
- Counter: Granite
- Sanitary Ware: Premium quality range

### BALCONIES

- Flooring Tiles: Antiskid ceramic tiles
- Wall Finishes: Exterior grade paint on plaster
- Ceiling Finishes: Exterior grade paint on plaster
- Railings: M.S railing

### STAIRCASE

- Flooring: Kota Stone / Indian Stone
- Railing: Painted M.S railing
- Wall Finishes: Oil bound distemper on plaster

### KITCHEN

- Flooring / Skirting: Antiskid ceramic tiles
- Wall Finishes: Tiles up to 600 mm above counter and acrylic emulsion paint in the balance area
- Ceiling: Oil bound distemper with part false ceiling
- Counter: Granite / Marble top with stainless steel sink

### CP. FITTING AND ACCESSORIES

Jaguar / Grohe / Kohler or Equivalent single lever fitting in all toilets.  
Provision for installation of geysers.

### LIFT LOBBY

- Flooring: Granite / Marble
- Wall Finishes: Granite / Marble up to 2100 mm on lift side wall and acrylic emulsion paint in balance area
- Ceiling: Acrylic emulsion paint

### COMMON PASSAGE

- Flooring: Granite / Indian marble
- Wall Finishes: Acrylic emulsion paint
- Ceiling Finishes: Acrylic emulsion paint

### DOORS

- Door Frame: Seasoned hard wood frame
- Main Door: Paneled door
- Bedroom Doors: Masonite / Flush door
- Toilet / Kitchen Door: Masonite / Flush door

### WINDOW / GLAZING

UPVC frame with clear glass.

### EXTERNAL WALL FINISHED

Exterior grade paint from reputed makes and brands.

### ELECTRICAL WIRING AND INSTALLATIONS

- Fixtures & Fittings: ISI mark switches / sockets, distribution boxes and circuit breakers from standard makes and brands
- Wiring: ISI mark concealed conduits with copper wire
- Plumbing: ISI mark CPVC water supply pipes with standard valves and accessories
- Security System: CCTV surveillance, EPABX



# PSITE PLAN



- TYPE A - 3 BHK with maid's room (1800 sq. ft.)
- TYPE B - 3 BHK (1700 sq.ft.)
- TYPE C - 2 BHK (1250 sq. ft.)
- TYPE D - 2 BHK with study room (1400 sq. ft.)
- TYPE E - 2 BHK (1300 sq. ft.)
- TYPE F - 3 BHK with maid's room (1830 sq. ft.)



# P FLOOR PLAN



3 BHK TYPE A (with maid's room)  
Super Area: 1800 sq. ft. | 1 sq. mt = 10.764 sq. ft.

# P FLOOR PLAN



3 BHK TYPE B

Super Area: 1700 sq. ft. | 1 sq. mt = 10.764 sq. ft.

# P FLOOR PLAN



2 BHK TYPE C

Super Area: 1250 sq. ft. | 1 sq. mt = 10.764 sq. ft.

# P FLOOR PLAN

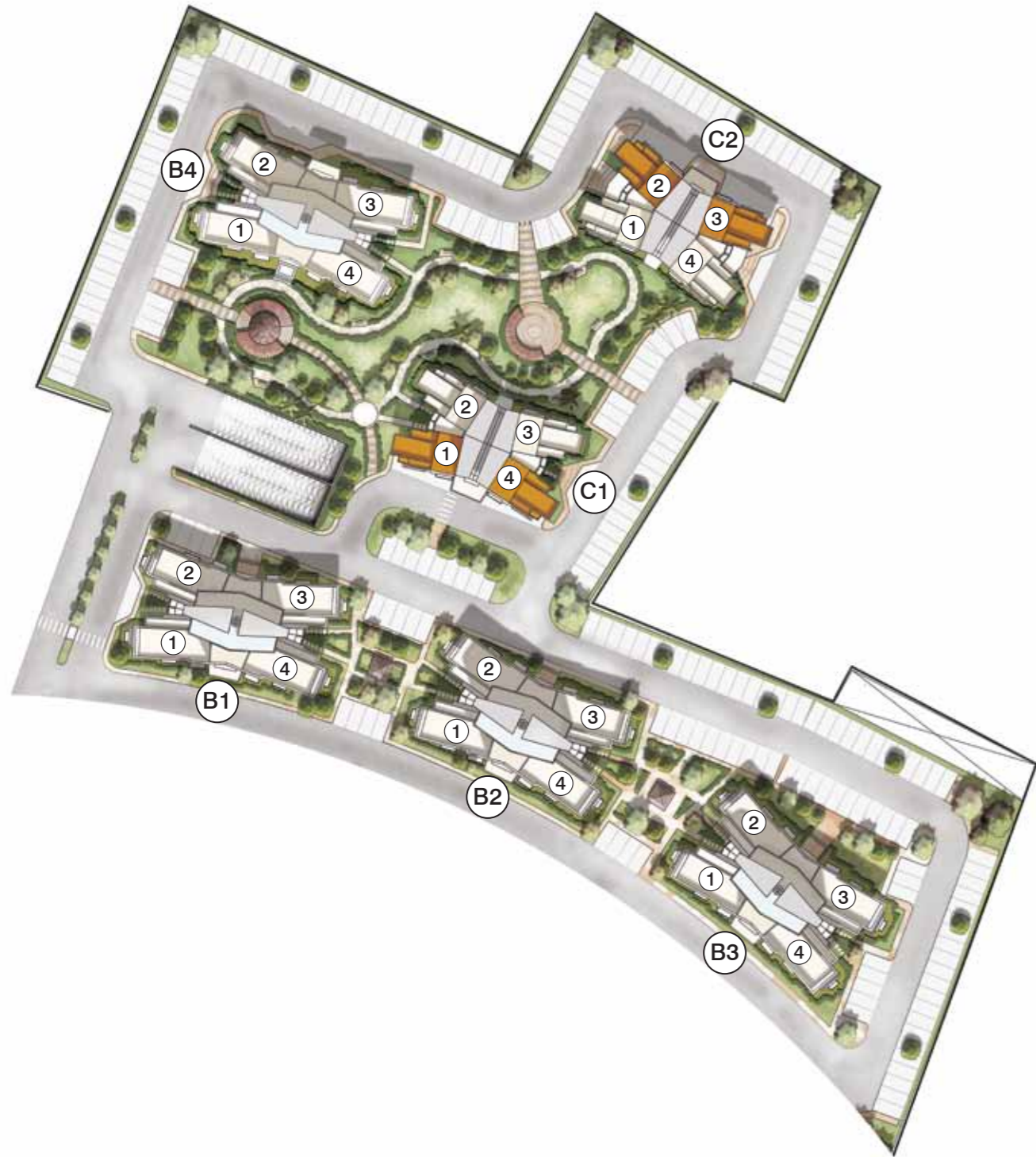

2 BHK TYPE D (with study room)  
 Super Area: 1400 sq. ft. | 1 sq. mt = 10.764 sq. ft.

# P FLOOR PLAN



2 BHK TYPE E

Super Area: 1300 sq. ft. | 1 sq. mt = 10.764 sq. ft.

# P FLOOR PLAN



3 BHK TYPE F (with maid's room)

Super Area: 1830 sq. ft. | 1 sq. mt = 10.764 sq. ft.



# VISTA BY SHALIMAR.

THE GROUP LEGACY



The image features a tall, curved glass skyscraper at night, illuminated from within. The building's facade is a grid of windows, many of which are lit up, creating a warm glow. To the left of the skyscraper, several colorful fireworks are exploding in the dark sky, adding a festive atmosphere. In the foreground, there are other modern buildings with balconies and glass facades, some of which are also lit up. The overall scene is a vibrant cityscape at night.

## The Shalimar Group.

Established in 1985 and having developed nearly 6 million sq. ft. of residential & commercial spaces, the Shalimar Group is a diversified conglomerate headquartered in Lucknow. The Group's footprint spans across sectors such as Real Estate, Property Management, various Allied Services, Civil Construction, Imports & Exports and Glass Processing.

Built on the cornerstones of Knowledge, Efficient Management & Transparency, the Group's mission is to provide world class products & services in each of its areas of operations through the tenets of Experience & Expertise.

With upcoming projects of over 15 million sq. ft. area across major cities of UP and Delhi+NCR and a dedicated team of over 750 personnel, Shalimar Group is poised to become one of India's leading developers and its signature township, OneWorld is a big leap forward in this direction!

# OUR LEGACY

## TOWNSHIP



SHALIMAR MANNAT



GARDEN BAY



SHALIMAR PARADISE

## CORPORATE



SHALIMAR ELLDEE PLAZA



SHALIMAR STAR



SHALIMAR LOGIX



SHALIMAR TITANIUM



SHALIMAR TCS BUILDING



SHALIMAR MALL, LUCKNOW



SHALIMAR SQUARE



SHALIMAR TOWER



CORAL MALL, JALANDHAR

## RESIDENTIAL



SHALIMAR APARTMENTS



SHALIMAR HOMES



SHALIMAR ESTATE



SHALIMAR COURTYARD



SHALIMAR HEIGHTS



SHALIMAR EMERALD



SHALIMAR ROYALE



SHALIMAR IMPERIAL



SHALIMAR DWELLING



SHALIMAR GRAND



SHALIMAR GALLANT



SHALIMAR MEADOWS



SHALIMAR NEST, DELHI



SHALIMAR RETREAT, DELHI



IBIZA TOWN, NCR





Shalimar Corp Limited, Titanium, Shalimar Corporate Park, Vibhuti Khand, Gomti Nagar, Lucknow-226010

---

**E:** [sales@shalimar.org](mailto:sales@shalimar.org) | **C:** +91 522 4030444 | **W:** [shalimarcorp.com](http://shalimarcorp.com)