

Project By:



Email: info@siddhivinayakhomes.co.in

Site Address: Survey No. 32/9A & 9B, Village - Koynavele, Taluja, Taluka-Panvel, Dist. - Raigad

Corporate Address: Plot No 35, Opp. Ganesh Mandir, Sector 5, Kharghar, Navi Mumbai - 410 210

www.siddhivinayakhomes.co.in - Call: 98999 00600

Exclusively Marketed by:



Space for every Dream

Sales office:

Shop No. 28-31, Payal Complex, Sector 17,

Opp. Panvel Railway Station, New Panvel (E)

Contact: 93222 56777

Disclaimer: The information contained in this brochure is intended solely to provide general information for discussion purpose to the prospective buyer and will not constitute or form part of any agreement or form the basis of any contract no warranty, neither representation nor covenant is given or implied as to the accuracy of the whole or any part of this information. All plans, drawings, amenities, facilities, etc. are subject to the approval of the respective authorities and would be changed, if necessary. The discretion remains with the developer.

SIDDHIVINAYAK
MAHIMA
NEXT TO KHARGHAR

Luxury. Leisure. Lifestyle.

1 & 2 BHK PREMIUM RESIDENCES



LIFE. UPGRADED.

Defying the stereotypes, blending the warmth of tradition, aspiring to create a story all so new. Welcome to the Siddhivinayak Mahima. Inspired by the Mediterranean style of homes, Mahima stands tall beyond the four stereotype walls and you are sure to brighten your living with a kaleidoscope of natural colours. With an epitome of world-class facilities, the property offers a sweet tranquility and spoils you with a suite of amenities that takes comfort to a whole new level. And outside the abode, the city awaits.

Arial View



WHERE SERENITY
RESIDES WITH REVELRY.

SIDDHIVINAYAK
MAHIMA
NEXT TO KHARGHAR

WHERE AN ARCHITECTURE
SPEAKS FOR ITSELF.

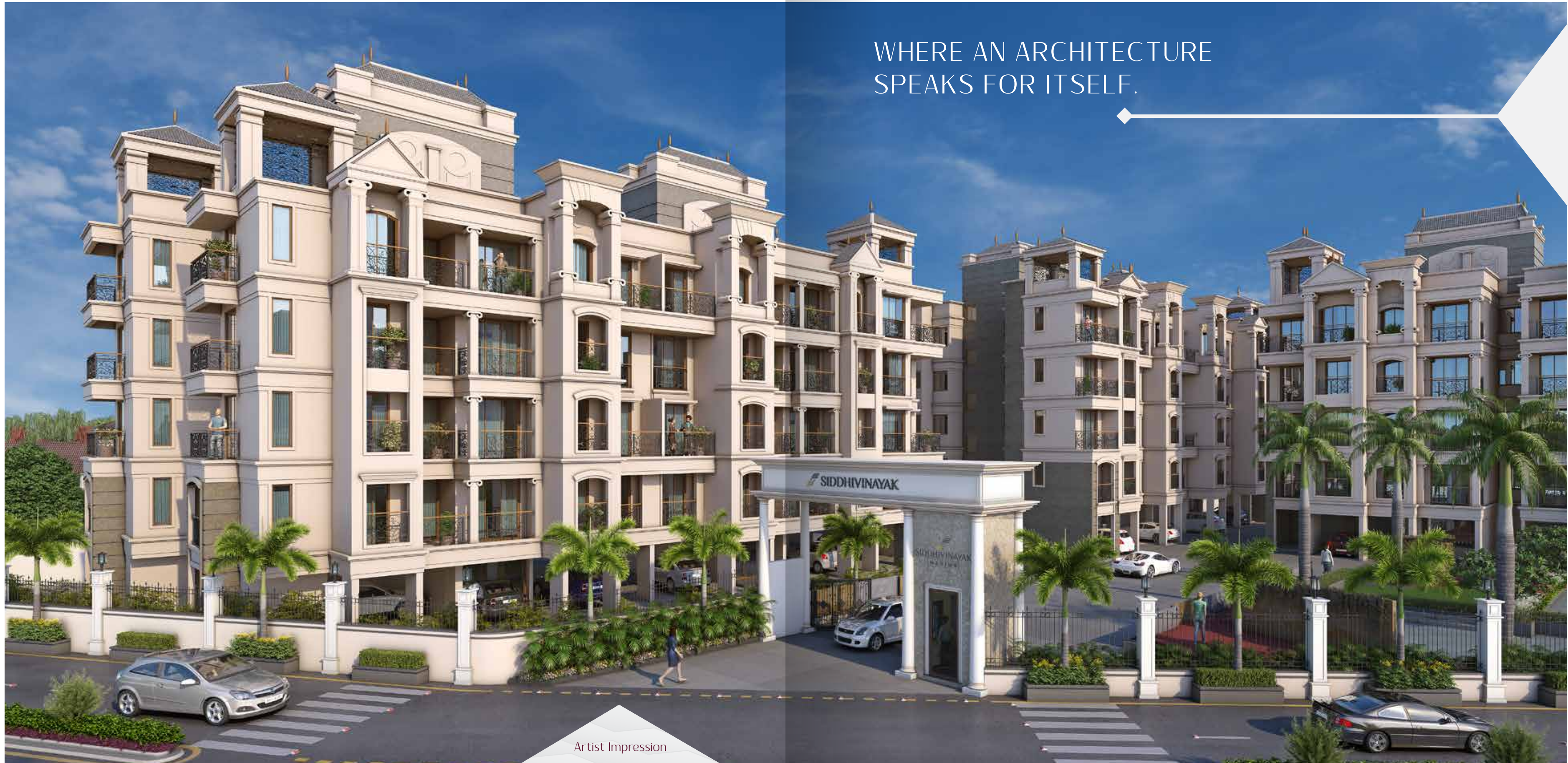

Artist Impression

WHERE INDULGENCE IS LIMITLESS.

What is indulgence without luxury? And luxury is nothing without choice. With unique life and lifestyles. Mahima explores the facets of luxury living and makes life come alive and vibrant.



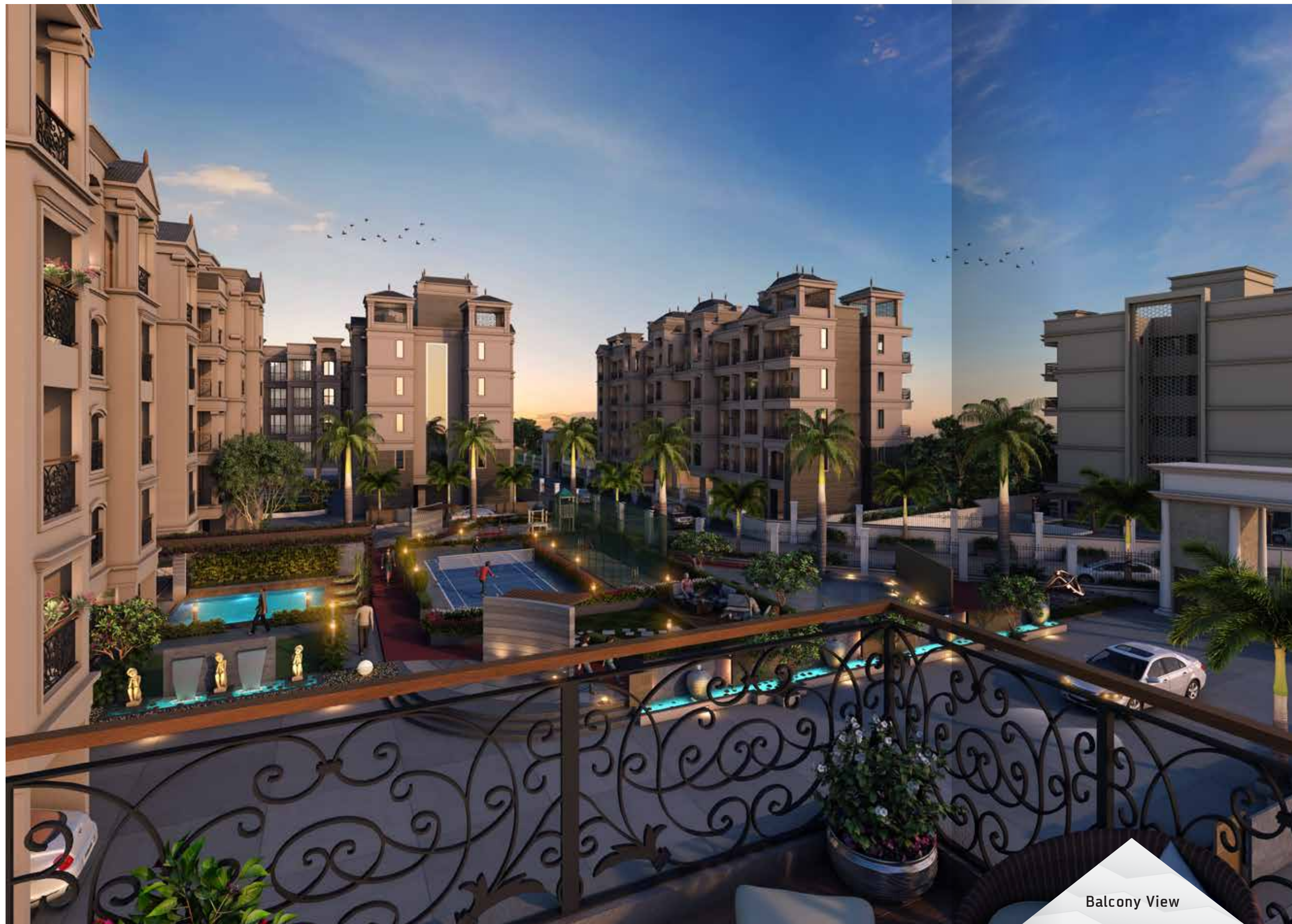

Balcony View

WHERE THE BEST
CONVERGE AT THE
PERFECT LOCALE.

Project Features:

- Exclusively designed Mediterranean styled luxurious residential complex
- Uniquely designed premium elevation
- Located in serene natural ecosystem
- G+4 storeyed buildings with lift
- Spacious & well-planned layout
- Earthquake resistant RCC design
- Grand entrance gate

CLUB ZEST EXCLUSIVE FEATURES

- Swimming Pool
- Gymnasium with latest equipment
- Indoor Games - Table tennis / Carrom / Chess
- Skating Ring
- Basketball & Badminton Court
- Yoga & Meditation area
- Net Cricket



PROJECT HIGHLIGHTS

- Swimming Pool
- Gymnasium
- Children's Play Area
- Grand entrance Gate
- Jogging Track
- Senior Citizen Area
- Badminton Court
- Skating Ring
- Net cricket
- Yoga & Meditation Zone

WHERE AN ADDRESS HAS MANY CHOICES.

The location of Mahima brings quietness and connectivity together. Bypassing the cacophony of the city, the project is situated at Taloja. With the upcoming metro station just 5 minutes away the project will be very well and conveniently connected with all the other parts of the city. Apart from metro, the project also enjoys connectivity with a network of roads and places.

- 5 mins walk to Pendhar Metro Station providing easy connectivity to CBD Belapur
- 10 mins drive to Central Park, Kharghar
- 15 mins drive from proposed Navi Mumbai International Airport (NMIA)
- 15 mins drive to Malls, Theatres and other major conveniences
- 7 kms from Mumbai-Pune Expressway
- 10 mins drive from existing Taloja Railway station
- 5 mins drive from Panvel-Shilphata Highway

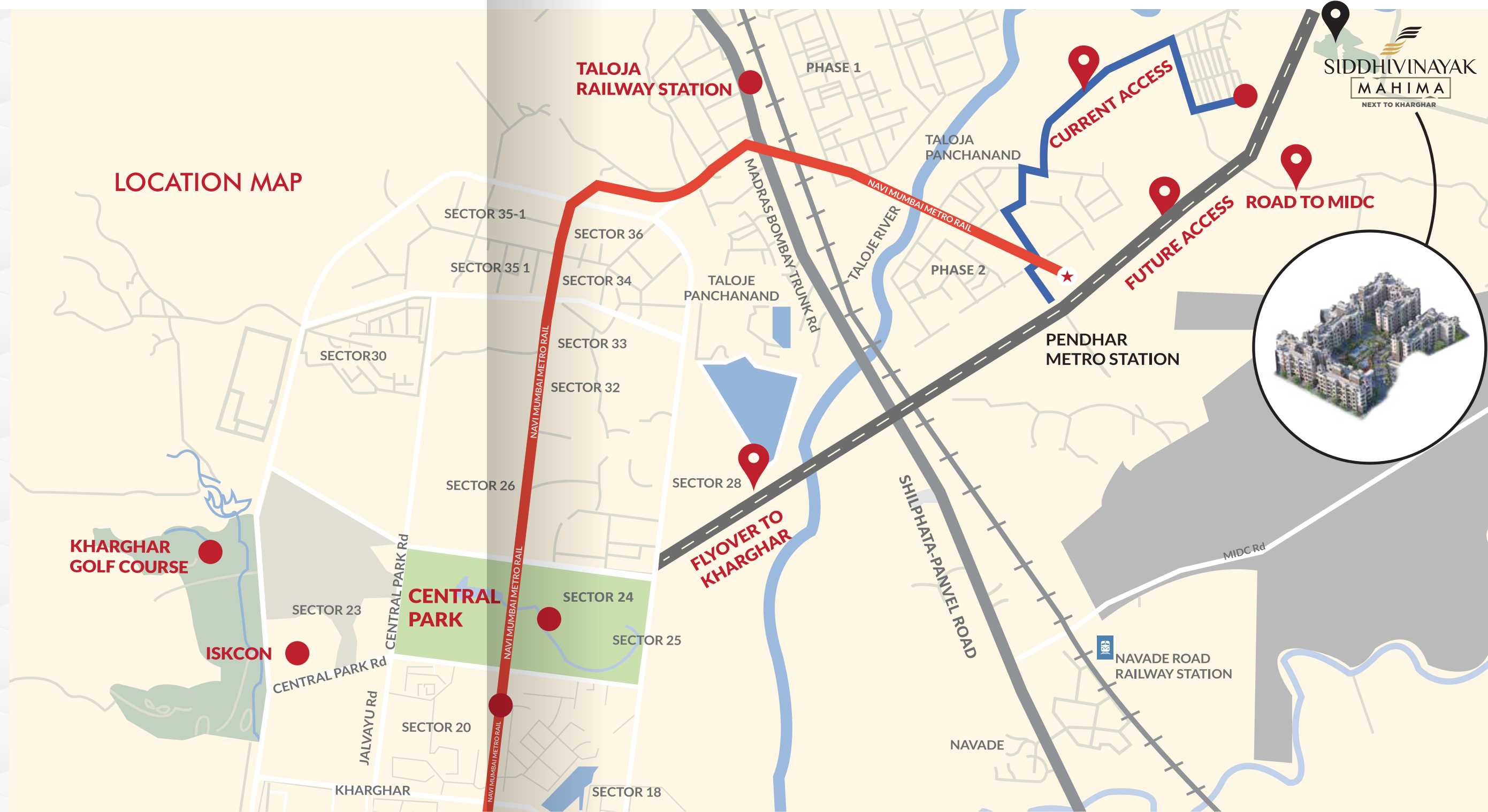

5 mins. walk to Pendhar Metro Station



10 mins. drive to Central Park.



10 mins. drive to Golf Course, Kharghar



10 mins. drive to Talloja Railway Station



15 mins. drive from proposed Navi Mumbai International Airport



15 mins. drive from proposed Trans-Harbour Link

WHERE THE BEST,
CRAFT THE DETAILS.

INTERNAL SPECIFICATIONS

Bedrooms:

Designer Bedrooms with Ample
Electric points.

Kitchen:

Designer tiles in Kitchen above Platform Granite
Kitchen Platform with S.S. Sink.

Flooring:

All rooms with Latest Range of Designer Vitrified
Flooring.

Doors:

Decorative Laminated Main Entrance Door with
Good Quality Door Fittings.

Windows:

Anodized Aluminium Sliding Windows.

Wiring:

Concealed Copper Wiring with Adequate
Electric Points & Good Quality ISI Marked
Modular Switches I Points for bTV, Cable &
Telephone.

Bathrooms/Toilets:

Designer Glazed Tiles in Bathroom & W.C. I
Branded Sanitaryware I Branded bathroom
Fittings.

Paint:

Waterproof Paint on external Walls Plastic
emulsion Paint on Internal Walls Finished with
POP/Gypsum Plaster.

BRANDS ASSOCIATED WITH US:

Sanitaryware



Tiles



Cement



Wall Paint



Window Glasses



Pipes & fittings



Wires & Cables



Electrical Fittings



Steel Pipes



Kitchen Sink



MASTER LAYOUT



LEGENDS

- 1 Main Gate
- 2 Net Cricket
- 3 Badminton Court
- 4 Swimming Pool
- 5 Clubhouse & Gym.
- 6 Children's Play Area
- 7 Amphitheatre
- 8 Skating Ring
- 9 Basketball Area
- 10 Stage & Lawn
- 11 Senior Citizen Area
- 12 Jogging Track



Children's Play Area



Gymnasium



Net Cricket



Senior Citizen Area



Plans - Building 1



1st & 3rd Floor Plan

Plans - Building 1



2nd & 4th Floor Plan

Plans - Building 2

C - Wing

D - Wing



29ft. width road

29ft. width road

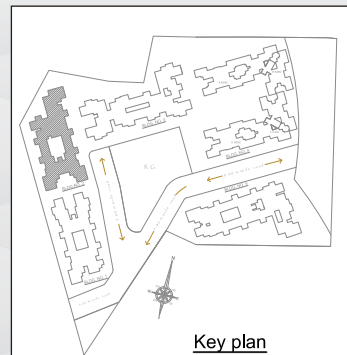

Key plan

1st & 3rd Floor Plan

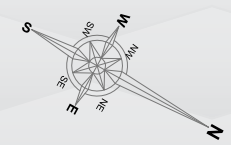

Plans - Building 2

C - Wing

D - Wing



29ft. width road

29ft. width road

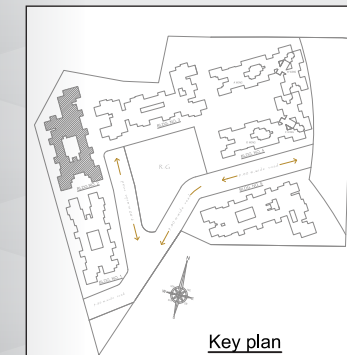

Key plan

2nd & 4th Floor Plan

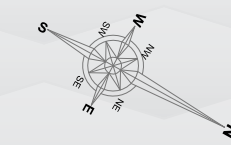

Plans - Building 3



Plans - Building 4

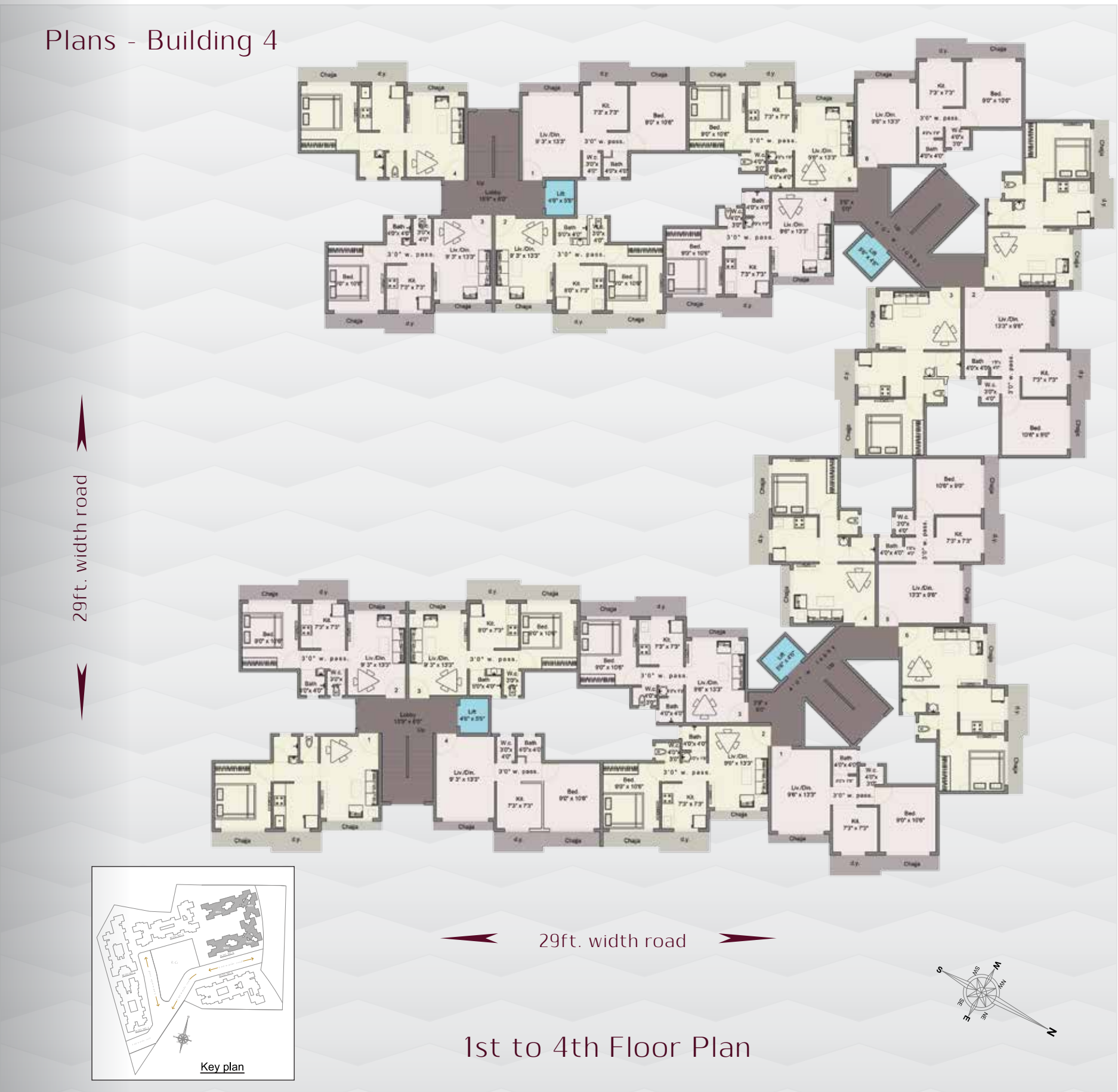

Plans - Building 5



Plans - Building 5





SIDDHIVINAYAK
MAHIMA
NEXT TO KHARGHAR



Siddhivinayak Mahima at a glance

Project Highlights

- Exclusively designed luxurious residential complex
- Uniquely designed premium elevation
- Located in serene natural ecosystem
- G+4 storeyed buildings with lift
- Spacious & well-planned layout
- Earthquake resistant RCC design
- Grand entrance gate

Recreation Features

- Swimming pool
- Landscaped garden with children's play area
- Badminton Court & Cricket net
- State-of-the-art Clubhouse & Gymnasium
- Senior Citizen Sitting area, Yoga & meditation Area
- Yoga & meditation Area
- Jogging track & Skating ring

Location Advantages

- 5 mins walk to Pendhar Metro Station providing easy connectivity to CBD Belapur
- 10 mins drive to Central Park, Kharghar
- 15 mins drive from proposed Navi Mumbai International Airport (NMIA)
- 15 mins drive to Malls, Theatres and other major conveniences
- 7 kms from Mumbai-Pune Expressway
- 10 mins drive from existing Taloja Railway station
- 5 mins drive from Panvel-Shilphata Highway

Internal Specifications

- Bedrooms:
Designer Bedrooms with Ample Electric points.
- Kitchen:
Designer tiles in Kitchen above Platform.
Granite Kitchen Platform with S.S. Sink.
- Flooring:
All rooms with Latest Range of Designer Vitrified Flooring.
- Doors:
Decorative Laminated Main Entrance Door with Good Quality Door Fittings.
- Windows:
Anodized Aluminium Sliding Windows.
- Wiring:
Concealed Copper Wiring with Adequate Electric Points & Good Quality ISI Marked Modular Switches I Points for TV, Cable & Telephone.
- Bathrooms/Toilets:
Designer Glazed Tiles in Bathroom & W.C.
Branded Sanitaryware I Branded bathroom Fittings.
- Paint:
Waterproof Paint on external Walls Plastic emulsion Paint on Internal Walls finished with POP/Gypsum Plaster.