

# PURE

life in XL size

by SANGATH® IPL group

## 2<sup>bhk</sup> XL Size Apartment

**PURE**  
SANGATH® IPL

Presenting a lifestyle sprinkled with pure happiness and unbridled joy. Presenting PURE by sangath IPL – 2 BHK XL Size apartments. Sangath IPL once again gift the esteemed customers an elevated living experience on the vast stretch of green surrounded by best in the class amenities in one of the most green and fresh neighborhood of Ahmedabad. The generously designed 2BHK apartments scheme, PURE redefines what spaciousness and class is all about with its XL size rooms and classy outlook. Connecting the most important locations and famous recreational points of Ahmedabad in few minutes' drive, PURE by sangath IPL is indeed an address worth flaunting.

And most importantly it comes from the most trustworthy and visionary real estate group of Ahmedabad who with their innovative and unique green projects has introduced some revolutionary initiatives like RCC Shear Wall structure, Carpet+Wall area transparent dealing, IGBC accreditation and changed the way of living and thinking of citizens.

So once again, be ready to experience the fresh wave of innovative living with PURE by sangath IPL.



Raft foundation with  
earthquake resistant RCC shear wall  
monolithic structure

## OUR INITIATIVES

Carpet + Wall Area Pricing (pay for what you own)

Green Building Certified Projects

Renewable Energy: Apartments with Wind + Solar Power

Earthquake Resistant RCC Shear Wall Structures

Usage of "A" class branded standard quality materials only

In-house Material Testing Laboratory established since Year 2000

Smart Usage of Resources

Warranty for Homes

After Sales Services through Online CRM

Exploring Location, Creating Landmarks

GUJARAT'S 1st



POSH



TERRACES

AHMEDABAD'S  
Best



TERRACES



SKYZ

AHMEDABAD'S  
Highest



TERRACES



Layout

--- 60' WIDE ROAD ---



block - A1 unit 1 & 4



rera carpet area	664.96 sq.ft
balcony area	27.76 sq.ft
wash area	27.97 sq.ft
<u>total</u>	<u>720.69</u>

block - A1 unit 2



raera carpet area	668.73 sq.ft
balcony area	27.76 sq.ft
wash area	46.91 sq.ft
<u>total</u>	<u>743.40</u>



block - A1 unit 3



raera carpet area	672.39 sq.ft
balcony area	27.76 sq.ft
wash area	36.36 sq.ft
<hr/>	
total	736.51



block - A2 unit 1



rera carpet area	666.15 sq.ft
balcony area	36.26 sq.ft
wash area	26.68 sq.ft
<hr/>	
total	729.09



block - A2 unit 2



rera carpet area	717.15 sq.ft
balcony area	22.70 sq.ft
wash area	28.94 sq.ft
<hr/>	
total	768.79



corner flat - block B1 unit 1 & block B2 unit 4

rera carpet area	631.18 sq.ft
balcony area	31.52 sq.ft
wash area	24.42 sq.ft
<u>total</u>	<u>687.12</u>

center flat - block B1 unit 2 & block B2 unit 3

rera carpet area	630.75 sq.ft
balcony area	31.52 sq.ft
wash area	24.42 sq.ft
<u>total</u>	<u>686.69</u>



center flat - block B1 unit 3 & block B2 unit 2

rera carpet area	655.71 sq.ft
balcony area	31.52 sq.ft
wash area	24.42 sq.ft
<u>total</u>	<u>711.65</u>

corner flat - block B1 unit 4 & block B2 unit 1

rera carpet area	656.79 sq.ft
balcony area	31.52 sq.ft
wash area	24.42 sq.ft
<u>total</u>	<u>712.73</u>

north view



south view





**east view**



**west view**





## specifications

- Flooring 2 x 2' vitrified tiles
- Kitchen - 2' wide black granite platform
- Toilet - full height glazed tiles dado
- Internal wall finish birla putty
- Adequate plumbing & electric point
- Decorative main doors
- All other doors with wooden frames, flush door with paints
- 2 automatic elevator for each building
- Every flat with one parking space
- Gymnasium, Children play area, Common terrace
- Raft foundation with earthquake resistant RCC shear wall monolithic structure
- Long Lasting – rich external finishes of expose R.C.C, Terrazo, Aluminum lovers, S.S & Glass railing.
- Most spacious in its segment.
- Spacious common foyer & stair.
- Positivity inviting entry doors (No south entry)
- Exclusive panoramic views.
- 5 years warranty for plumbing & water proofing

# hollow plinth parking plan



--- 60' WIDE ROAD ---

# 1st basement parking plan

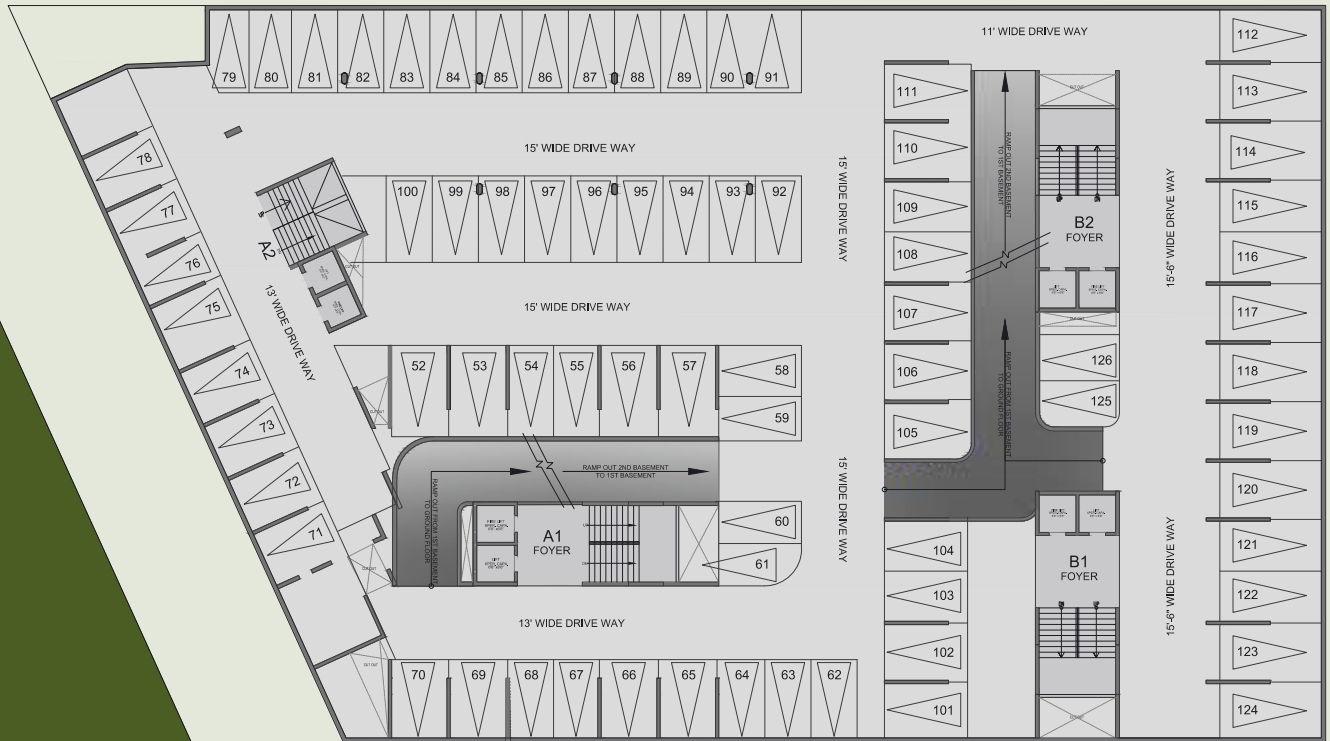

# 2nd basement parking plan

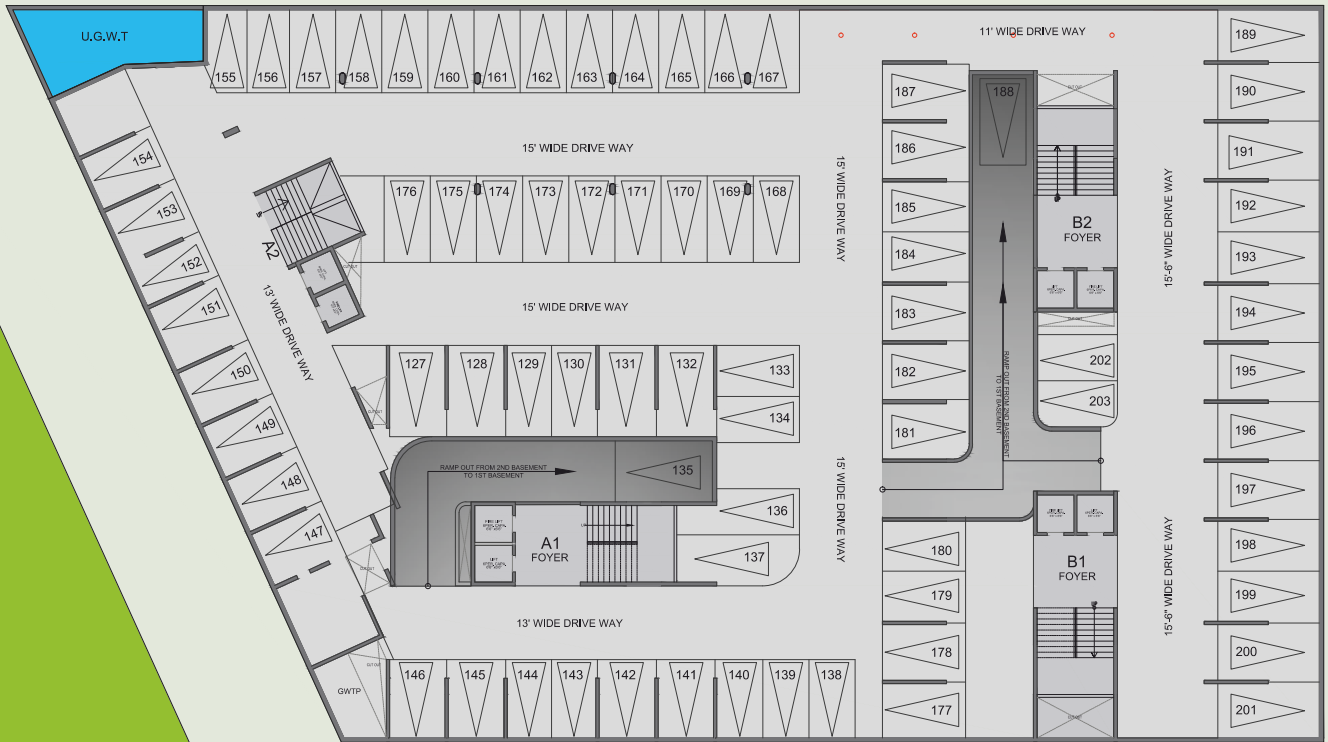



BRTS



Ring Road



S. G. Highway



Metro



Airport

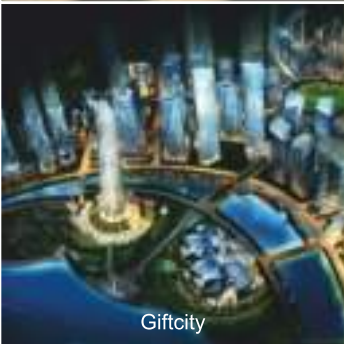

Giftcity

**TWINCITY HUB**  
 EVERYTHING WITHIN 0 TO 9 MIN.  
**LOCATION IS OUR OXYGEN**

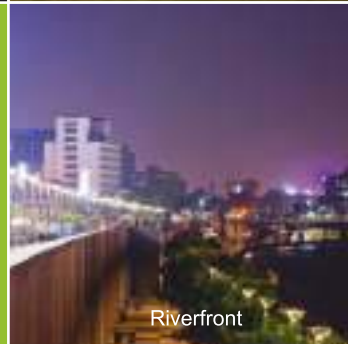

Riverfront



Knowledge corridor  
Gandhinagar



Narmada Main Canal Walk



Engineering College



Motera International Stadium



Mahatma Mandir



Multiplex PVR



Super Market - D Mart



Tapovan Jain Derasar



Apollo

# AMC PROPOSED DRAFT TOWN PLANNING SCHEME NO. 76/B (CHANDKHEDA)



Site : PURE by Sangath IPL, 200' Ring Road B/w S.G.Road to Airport, Nr.DCIS circle Chandkheda, Ahmedabad.

## current projects

<p>ready possession with b.u. permission</p> <p>nr. pvr cinema, motera</p>	<p><b>SILVER</b></p> <p>3 bhk</p>	
<p>Gujarat 1<sup>st</sup> platinum rated green building</p> <p>nr. dcis circle, chandkheda</p>	<p><b>POSH</b></p> <p>3 - 4 bhk AC</p>	
<p>green building with solar roof top</p> <p>nr. sargasan cross road, g'nagar</p>	<p><b>TERRACES</b></p> <p>3 bhk premium</p>	
<p>nr. dahegam 30 minutes from s. p. ring road</p> <p>gandhinagar</p>	<p><b>GOOD TIMES</b></p> <p>plots</p>	





■ Good Life  
■ Good Times  
■ Dahegam

Chiloda

■ GIFT JUNCTION

**GIFT CITY**  
**GIFT**

● Gandhinagar Sector 1 to 30

■ Mahatma Mandir

TCS  
NIFT  
DA-IICT

Infocity  
NICM  
NID

■ TERRACES

■ City Pulse

Institute of Seismological Research  
PDPU

■ IT Park Mind space

DPS School

Divine Child International School

■ Vaishno devi Temple

**S.P. RING ROAD**

■ Nirma University

Zundal Highway

Sabarmati - Kalol Highway

■ Derasar  
PURE POSH

Saundarya Green

New C.G Road

Sangath Mall  
DIAMOND

NANO SKYZ

■ Visat

Sangath Derasar

Agora Mall

EDI

Narayani Club & Resort

Apollo Hospital

■ Bhat

■ Mother Dairy

S.P. Ring Road

N.H. No 8

■ GIDC Naroda



Sabarmati Railway station



International Cricket Stadium

Hotel Taj Gateway



**AIRPORT**

● SAHIBAUG

--- METRO  
--- BRTS

Journey towards **GREEN** excellence... since 1981

**SANGATH®  
IPL**

group since 1981

## **Sangath Infrastructures Pvt. Ltd.**

Office: 402 Sangath mall-1, Opp. Engg. College, Sabarmati - Gandhinagar Highway, Motera, Ahmedabad, Gujarat.

W : [www.sangathipl.com](http://www.sangathipl.com)

PH : + 91 7878601981

E : [info@sangathipl.com](mailto:info@sangathipl.com)

Notes : All rights reserved to organizer for any changes in plan & specifications. • This brochure is only for advertisement and it shall not be considered as part of legal documents. • All the information & plans mentioned inside this brochure are for our proposed project "SANGATH PURE". • This marketing brochure is for guidance only. It does not constitute part of an offer or contract. • Design is proposed & subject and changes without any prior notice. • All elements mentioned inside are subject to grant of approvals from the relevant authorities.