

**LOCATION MAP**









# UNIT 1

**Bedroom 1**  
11'2" x 12'10"  
3.40m x 3.91m

**Kitchen**  
7'0" x 10'2"  
2.13m x 3.10m

**Living Room**  
12'1" x 24'2"  
3.70m x 7.37m

**Toilet**  
7'11" x 5'3"  
2.41m x 1.60m

**Bedroom 2**  
12'2" x 11'0"  
3.71m x 3.35m



Saleable Area	1272 Sq. Ft.	118.17 Sq. M
Carpet Area	788.24 Sq. Ft.	73.23 Sq. M
Balcony Area	89.02 Sq. Ft.	8.27 Sq. M

## UNIT 2

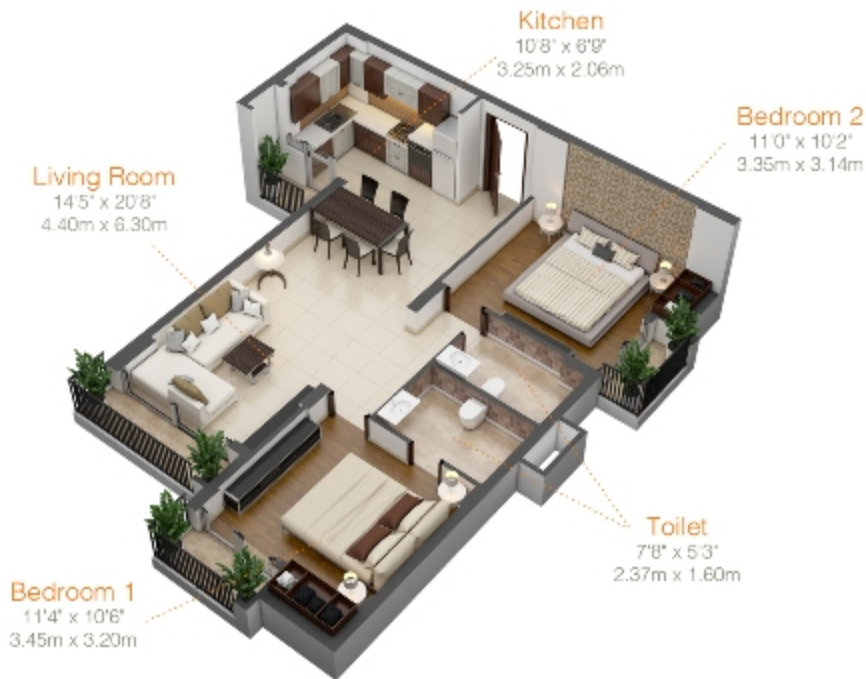

Saleable Area	1147 Sq. Ft.	106.56 Sq. M
Carpet Area	721.07 Sq. Ft.	66.99 Sq. M
Balcony Area	72.76 Sq. Ft.	6.76 Sq. M



# UNIT 4



Saleable Area	<b>1147 Sq. Ft.</b>	<b>106.56 Sq. M</b>
Carpet Area	779.41 Sq. Ft.	72.41 Sq. M
Balcony Area	90.09 Sq. Ft.	8.37 Sq. M



## UNIT 5



Saleable Area	1039 Sq. Ft.	96.53 Sq. M
Carpet Area	681.25 Sq. Ft.	63.29 Sq. M
Balcony Area	78.36 Sq. Ft.	7.28 Sq. M



## UNIT 6



Saleable Area	1083 Sq. Ft.	100.61 Sq. M
Carpet Area	692.01 Sq. Ft.	64.29 Sq. M
Balcony Area	78.36 Sq. Ft.	7.28 Sq. M

Particulars	Details
Living/Dining Flooring	Tiles
Bedrooms Flooring	Tiles
Wall Ceiling Finish	Oil Bound Distemper / Colour Wash
Toilets Wall Finish	Tiles up to 5' Oil Bound Distemper / Colour Wash
Toilets Flooring	Tiles
Kitchen Flooring	Tiles
Platform	Marble
Kitchen Wall Finish	Tiles up to 2 feet high above Marble counter & Oil bound distemper / Colour Wash in balance area
Others	Single Bowl Stainless Steel Sink
Balcony Flooring	Tiles
Window	MS Z-Section & Glass / Alu Steel & Glass
Door Frame / Doors	Hardwood / M.S / Fiber Door frames with Flush Door / Skin Door / Fiber Door
Common Area Flooring	Marble / Pavers
Lift Lobby	Marble / Tiles
Chinaware	Standard Fitting
C.P Fittings	Standard Fitting
Electrical	ISI marked products for wiring, switches and Circuits
Security	Gated Complex



