













Vijaya Nisarga



ENTRY : EAST
FLOOR : GROUND
APARTMENT NO : 013
SUPER BUILT-UP AREA (sqft) : 425 sqft

1 BHK GROUND FLOOR PLAN

ENTRY : WEST
FLOOR : GROUND
APARTMENT NO : 015
SUPER BUILT-UP AREA (sqft) : 440 sqft



KEY PLAN

**1 BHK (Ground Floor Plan)
425 sqft/440 sqft**

2 BHK
TYPICAL FLOOR PLAN



ENTRY : EAST

FLOOR : 1st, 2nd, 3rd

APARTMENT NO : 102, 202, 302

SUPER BUILT-UP AREA (sqft) : 1175 sqft



KEY PLAN

DISCLAIMER : THIS LEAFLET IS CONCEPTUAL IN NATURE AND BY NO MEANS A LEGAL OFFER. THE PROMOTERS HAVE THE RIGHT TO CHANGE, ALTER, DELETE OR ADD ANY SPECIFICATIONS MENTIONED HERE.

2 BHK (1st, 2nd & 3rd Floor Plan)
1175 sqft

3 BHK
TYPICAL FLOOR PLAN



ENTRY : NORTH
FLOOR : 1st, 2nd, 3rd
APARTMENT NO : 105, 205, 305
SUPER BUILT-UP AREA (sqft) : 1300 sqft

DISCLAIMER : THIS LEAFLET IS CONCEPTUAL IN NATURE AND BY NO MEANS A LEGAL OFFER. THE PROMOTERS HAVE THE RIGHT TO CHANGE, ALTER, DELETE OR ADD ANY SPECIFICATIONS MENTIONED HERE.



KEY PLAN

**3 BHK (1st, 2nd & 3rd Floor Plan)
1300 sqft**

Vijaya Nisarga



GROUND FLOOR PLAN



DISCLAIMER: THIS SEATLET IS CONCEPTUAL IN NATURE AND BY NO MEANS A LEGAL OFFER. THE PROMOTERS HAVE THE RIGHT TO CHANGE, ALTER, DELETE OR ADD ANY SPECIFICATIONS MENTIONED HERE.

Ground Floor Plan



LOCATION MAP



Vijaya Nisarga

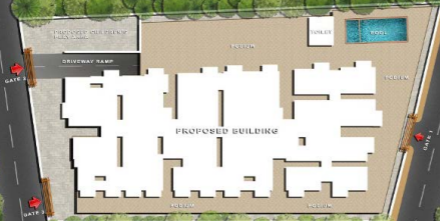

MASTERPLAN



Particulars	Details
Living/Dining Flooring	Tiles
Bedrooms Flooring	Tiles
Wall Ceiling Finish	Oil Bound Distemper / Colour Wash
Toilets Wall Finish	Tiles up to 5' Oil Bound Distemper / Colour Wash
Toilets Flooring	Tiles
Kitchen Flooring	Tiles
Platform	Marble
Kitchen Wall Finish	Tiles up to 2 feet high above Marble counter & Oil bound distemper / Colour Wash in balance area
Others	Single Bowl Stainless Steel Sink
Balcony Flooring	Tiles
Window	MS Z-Section & Glass / Alu Steel & Glass
Door Frame / Doors	Hardwood / M.S / Fiber Door frames with Flush Door / Skin Door / Fiber Door
Common Area Flooring	Marble / Pavers
Lift Lobby	Marble / Tiles
Chinaware	Standard Fitting
C.P Fittings	Standard Fitting
Electrical	ISI marked products for wiring, switches and Circuits
Security	Gated Complex

