

ABOVE AND BEYOND





Come discover why Pramuk MM Meridian makes a superb home for the entire family. Adults and children alike will be thrilled with all the facilities and unique construction advantages that have gone into the build.

Pramuk MM Meridian offers 25 floors of spacious 3-bedroom luxury apartments as well as 4-bedroom duplexes with the size and feel of a villa that make stylish and safer alternatives to owning an independent home. Superior quality finishes, basement car parking and a quiet and serene environment are all little additions that make life so much more bearable.

Each residential unit is Vastu compliant and detached from the common area by virtue of extending out from a central core - offering residents maximum privacy, a sense of spaciousness and a great view all around.

A full range of facilities are available for leisure pursuits, including two swimming pools, a well-equipped gymnasium, a modern clubhouse and a roof-top garden themed party area.



A home is a reflection of all that you are

3 BHK living and dining

Your home tells the story of your life.
It is an ode to all your achievements.
It represents every milestone you've crossed.
It symbolizes your arrival.
A home is a place of pride that tells the
world your story.
And your rise to the pinnacle of success.
That's why we've created Pramuk MM Meridian for you.
It is not just a home.

It is a status symbol.



Night view of Pramuk MM Meridian



A life of Luxury

Pramuk MM Meridian has been designed for the successful. And every facility, amenity and feature has been planned with utmost care. Whether you are entertaining guests or spending a quiet evening, rest assured you will have a great time!

Swimming pool at ground level



Step into your new world
Entrance Plaza



A grand welcome to a grand life

Entrance Lobby

Designed for your Lifestyle

After acquiring a taste for fine living, you wouldn't want anything but the best. We've kept this in mind while planning homes at Pramuk MM Meridian.

Living room duplex apartment





A room with a view
Dining & living duplex apartment



The duplexes have been created for those who love scaling new heights, every day.



The Master of your domain.
Bright, airy and large,
the master bedroom speaks your language.



Master Plan



UPPER FLOOR PLAN - ODD LEVEL



4 BHK DUPLEX UNITS 3 BHK UNITS COMMON AREA



LOWER FLOOR PLAN - EVEN LEVEL



4 BHK DUPLEX UNITS 3 BHK UNITS COMMON AREA



3 BHK TYPE 1

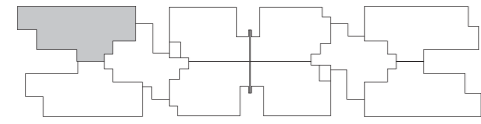

3 BHK TYPE 1 (N201)
SBA - 222 Sq.m / 2386 Sq.ft



3 BHK TYPE 3

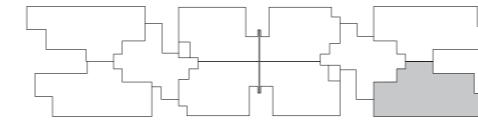

3 BHK TYPE 3 (S202)
SBA - 222 Sq.m / 2386 Sq.ft



3 BHK TYPE 2

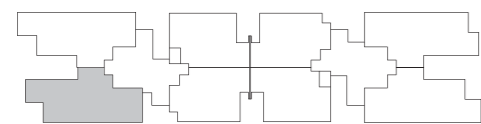

3 BHK TYPE 2 (N202)
SBA - 218 Sq.m / 2344 Sq.ft



3 BHK TYPE 4

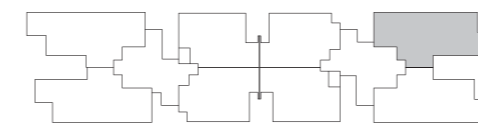

3 BHK TYPE 4 (S201)
SBA - 219 Sq.m / 2355 Sq.ft





UPPER LEVEL



UPPER LEVEL



LOWER LEVEL



LOWER LEVEL

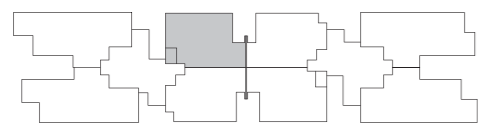

4 BHK TYPE 1 (N204)
SBA - 329 Sq.m / 3540 Sq.ft

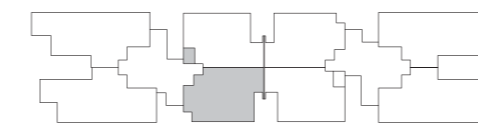

4 BHK TYPE 2 (N203)
SBA - 327 Sq.m / 3518 Sq.ft





UPPER LEVEL



UPPER LEVEL



LOWER LEVEL



LOWER LEVEL

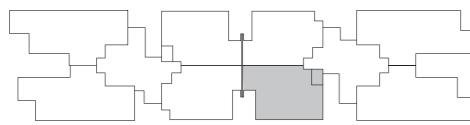

4 BHK TYPE 1 (S203)
SBA - 329 Sq.m / 3540 Sq.ft

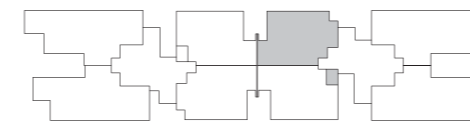

4 BHK TYPE 2 (S204)
SBA - 327 Sq.m / 3518 Sq.ft



Amenities

- Gym
- Spa and Sauna
- Meditation Hall
- Party Hall
- Sky Lounge
- Children Play Area
- Indoor Sports (Table Tennis, Billiards, Carom, Bridge, etc.)
- Two Swimming Pools
(One at Ground Level and another Infinity Pool on the Terrace)

Facilities

- Ample Car Parking
- Helipad
- Piped Gas
- 100% Power Back-up
- Round-the-clock Security

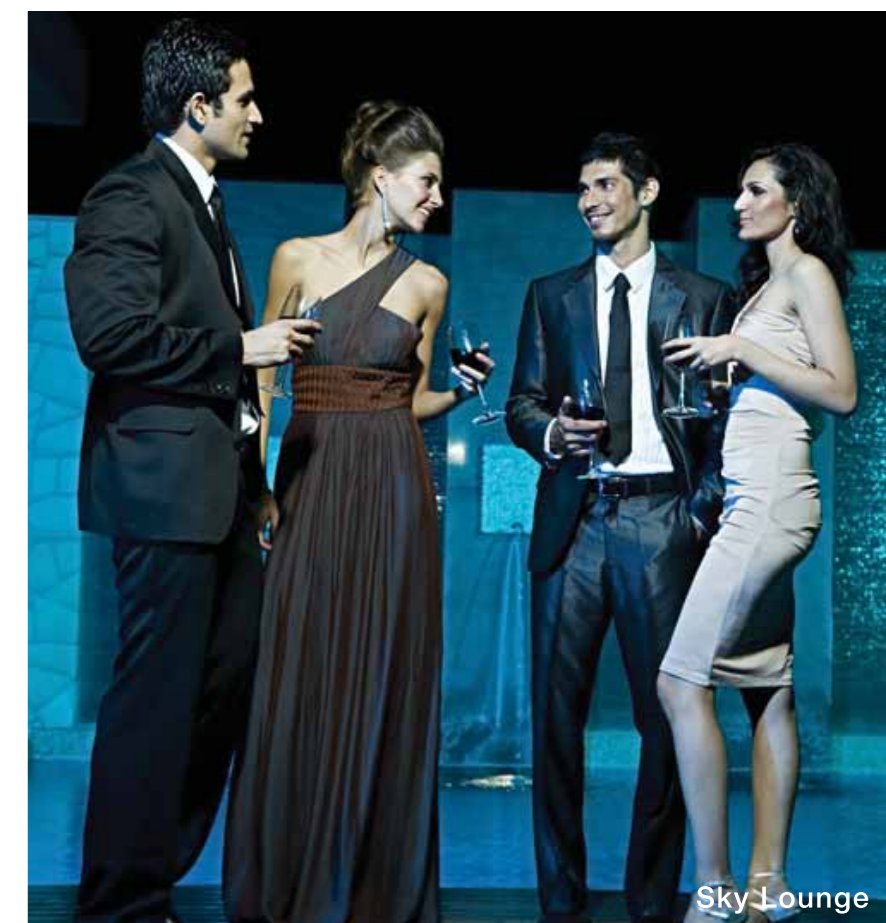
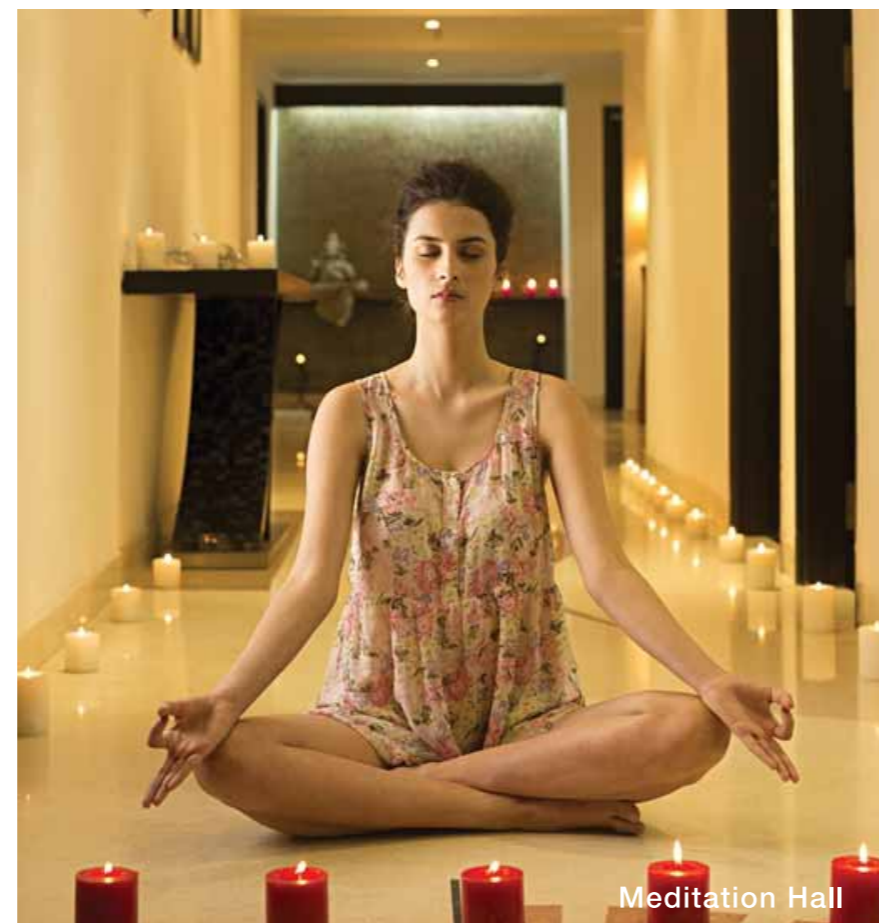

Sky Lounge

Right on top, high above the city, is the crowning glory of Pramuk MM Meridian. The Sky Lounge is a terrace with a difference. Complete with infinity pool and private partying areas, you get an ambience that is just incredibly elegant. A place where entertaining takes a whole new dimension.





Infinity pool on terrace



Swimming pool at ground level



Amphitheater



Lift Lobby



PRAMUK MM
MERIDIAN

PRAMUK MM
MERIDIAN

PRAMUK MM
MERIDIAN

Pramuk Infracon LLP

Pramuk was started over 15 years ago by two engineers who shared a dream of shaping the emerging urban landscape. Together, they created residences, institutional buildings, factories, infrastructure projects and much more. Each of these has been a reflection of their dedication, sincerity, quality-conscious approach and passion to excel.

Today, with their combined experience of over 70 years, they have a large number of completed residential properties to their name. Each one home to well connected, prominent citizens. Their recent project 'Pramuk Aqua Heights', located in Electronic City is a natural choice of professionals working in the area.

Pramuk sees each project they undertake like a series of pearls on a necklace. Each one brilliant and unique, but when viewed together - a stunning statement - a lifetime's achievement. So prepare to see more such beautiful homes and utilitarian infrastructure projects in the near future.



PRAMUK
INFRACON

Specifications

01. Structure:

RCC structure with block work / Wienerberger clay hollow block walls plastered, or concrete walls roof constructed using MIVAN technology

02. Car parking:

- 2-level basement car parking with entry and exit ramps
- Lower basement with mechanical stack parking and upper basement with single level car parking

03. Flooring:

- Living and dining areas – Imported marble flooring
- Bedrooms – Engineered wooden flooring / laminated wooden flooring
- Kitchen – Anti-skid vitrified flooring
- Balcony and toilet – Anti-skid ceramic tile / vitrified tile
- Toilet walls – Glazed ceramic / vitrified tile up to false ceiling height
- Ground floor / 1st floor entrance lobby – Imported marble / granite
- Upper floor, lobby area – Vitrified flooring
- Staircase – Granite
- Outside deck area – Outdoor concrete / ceramic tiles
- Terrace deck areas – Outdoor concrete / ceramic tiles
- Basement, 1 and 2 floors, ramps – Vacuum dewatered IPS floor

04. Doors:

- All apartment doors – 8'.0" high
- Main door – 3'.6" wide
- Bedroom doors – 3'.3" wide
- Toilet doors – 2'.10" wide
- All frames and shutters are compressed engineered wood, melamine polished with superior quality hardware. Doorframes are seasoned hard wood with architrave, flush shutters with veneer polished and provided with superior quality hardware

05. Windows:

- Powder coated aluminum windows, sliding and fixed in combination with mosquito mesh. Window lintel is 8'.0" high. Or alternatively, Fenesta / UPVC-like windows

- Living to balcony, UPVC sliding door with mosquito mesh
- Ventilators in toilets – openable and louvered aluminum frame
- Ventilators will have provision for exhaust fan

06. Toilet fixtures:

- Counter top with granite
- Duravit / Toto / Hindware or similar white-coloured sanitary fixtures
- Grohe / Hans Grohe / Kohler or similar C P fittings, basin mixer taps, single lever showers

07. Kitchen:

Provision for washing machine, dish washer, adequate heating points and provision for geyser in kitchen

08. Painting:

- Internal walls and ceilings – plastic emulsion paint
- External paint – superior quality cement paint / textured paint
- Enamel paint / polish for iron works

09. Electrical:

- All concealed conduits with superior quality wires and cables like Finolex
- Switches of superior quality
 - Adequate electrical points in all rooms with MCBs and one ELCB - each 3 BHK flat will be provided with 7 KVA power supply, 4 BHK flat will be provided with 10 KVA power supply
 - AC provision for all bedrooms
 - 100% DG power supply with energy meter for consumption (Both BESCO power and for DG power)
 - Telephone / cable TV point in bedrooms and living room
 - Common antenna with provision for multi-channel service providers

10. Balcony railings:

Glass with stainless steel railings

COMMON SPECIFICATIONS FOR THE BUILDING

01. Lifts:

Reputed brand, high speed lifts – 3 in each block. Of these, 2 are passenger lifts and one is a service lift

02. Fire suppression system:

Each flat will have fire sprinklers

03. Solid waste disposal:

Garbage chute is provided in each block, accessible from each floor

04. Reticulated gas supply:

Piped gas supply for each flat from a bank of gas cylinders, metered in each flat

05. Water supply:

Provision for round-the-clock water supply, separate for drinking from BWSSB and bore wells; water from sewage treatment plant for toilet flush

06. Power:

100% power back-up from DG supply, with individual energy meters for each flat; power back-up for common utilities like lifts, pumps, fire pumps, common lighting, stack car parking

07. Swimming pools:

2 pools are provided – one at the ground floor level above the car parking deck, and the other, an infinity pool on the terrace

08. For 4 BHK duplex flats:

- Maid's room with toilet, wash basin, tap and provision for geyser is provided
- Glazed tiles in toilet and ceramic tiles for flooring of the room and toilet
- 7'.0" high door with paint finish

09. Sports area:

- Indoor sports – pool, billiards and carom, TT, and bridge
- Gymnasium – air conditioned gym with sufficient equipment
- Wellness center – separate spa for men and women; massage, steam-room with toilets
- Meditation / Yoga room

10. Hotel-like entrance lobby:

Well-furnished entrance lobby with reception desk and visitors' seating

11. Amphitheater:

To watch plays and other cultural events

12. Party hall:

To cater to family parties, meetings etc., with a food serving counter and toilet

13. Office:

Office room, security cabin

14. Security system:

- CCTVs at various places like entrances, corridors, play areas
- The terrace and each apartment is provided with an intercom facility connected to the security and at the front reception desk

15. Landscaping:

Well-designed contemporary landscaping with water bodies, dry landscape, lawns, plants, shrubs; garden furniture is also provided

Location

Pramuk MM Meridian has been designed for those who need to be at the heart of all the action. It is located in 7th Block, Jayanagar – in a quiet neighborhood, yet in the middle of the city. It is well connected to places of work, malls, schools, hospitals and anything you might need. These homes are literally the center of your universe.

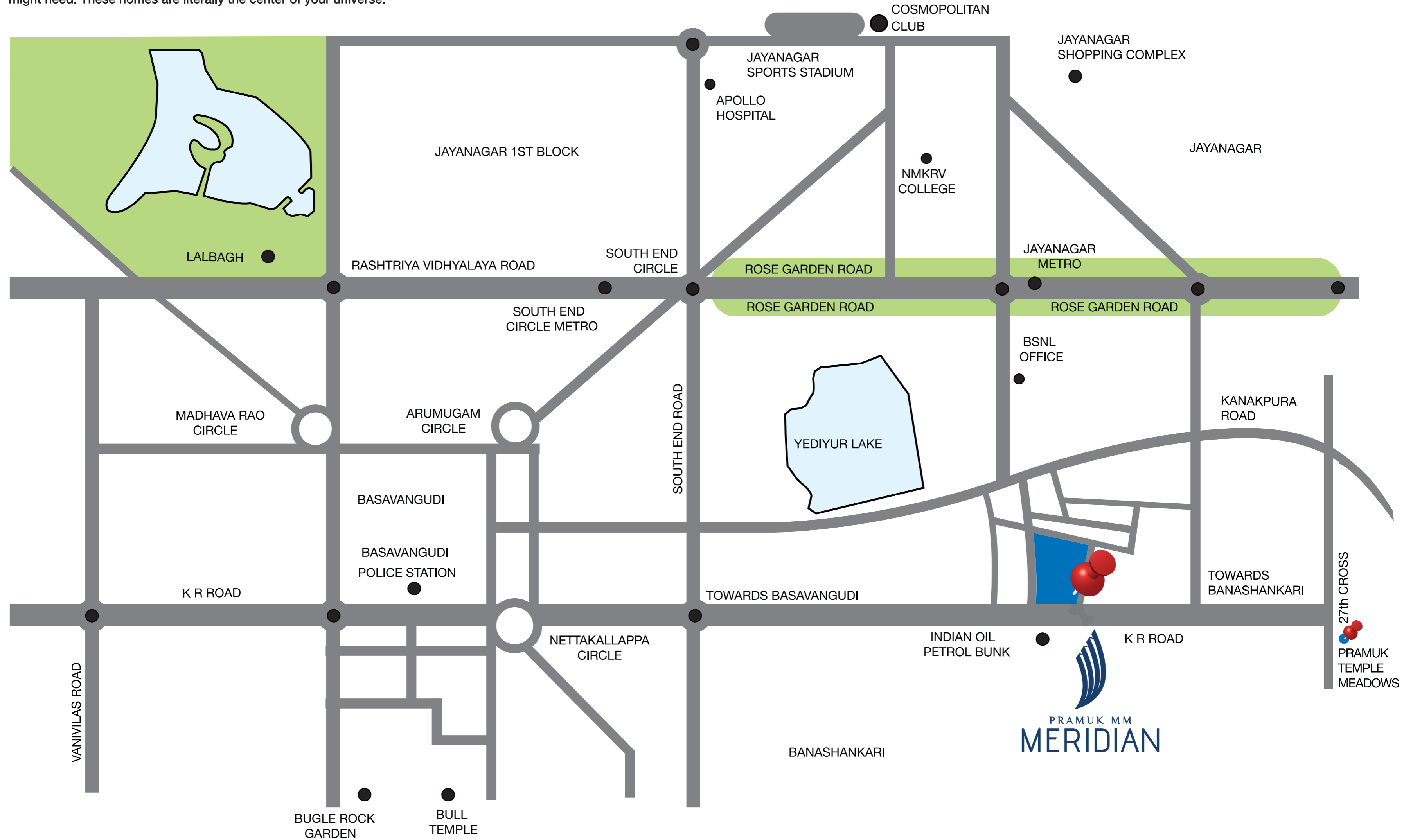
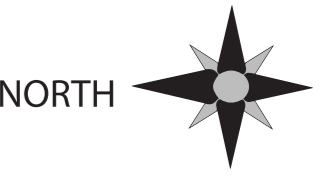



PRAMUK MM
MERIDIAN

www.pramukmeridian.com

Corporate Office

Pramuk Infracon LLP
#508, 9th Cross, Sadashivanagar
Bangalore 560 080

Project Office

Pramuk MM Meridian
46/1, KR Road, 7th Block, Jayanagar
Bangalore 560 082

Contact us at:

080-23616566 / 32323255

info@pramukmeridian.com

pramukprojects@hotmail.com

