

ATLANTE
MEASURED TO PERFECTION

ATLANTE

MEASURED TO PERFECTION

2 BHK Precise Homes
Near Bhumkar Chowk, Wakad

Perfection is a never-ending quest

Perfection. It's all about the articulate method that disciplines the creative madness. It is the fire within that burns the excessive, tones up the desirable and shapes up the final structure to exactitude.

Perfection is about reaching out to the ultimate - the zenith, the goal that has nothing higher above it.

'Atlante' is the essence of such unparalleled standard; a flawless creation perfected to the core.



MASTER LAYOUT











Legends

- 1. Swimming pool
- 2. Children's play area
- 3. Party lawn
- 4. Club house
- 5. Main entrance gate
- 6. Building A : Proposed development
- 7. Exit gate





Amenities

-  Club house / multipurpose hall
-  Party lawn
-  Gym
-  Open air amphitheatre
-  Swimming pool with attached baby pool
-  Indoor games
-  Yoga / aerobics area
-  Children's play area
-  Sitting pavilions

Eco friendly features :

- Solar water heater
- Rain water harvesting
- STP
- OWC
- Garbage chute

Other important features :

- Grand entrance gate
- 24 x 7 security with intercom
- Video door phone
- CCTV surveillance
- Shopping

Specifications

Structure :

- Strong RCC structure with aluminium formwork and earthquake resistant technology
- RCC frame structure

Flooring :

- 2X2 Vitrified flooring in entire flat
- Anti skid tiles in dry balcony & both the bathrooms

Kitchen :

- Granite kitchen platform with SS sink
- Designer dado tiles
- Washing machine plumbing & electrical provision in the dry balcony
- Provision for exhaust fan

Bathrooms :

- Premium sanitary & CP fittings
- Hot & cold mixer with overhead shower
- Provision for exhaust fan
- Provision for water geyser

Plastering / Painting:

- Gypsum finish surface to inner walls in entire flat
- Internal OBD paint
- Waterproof external wall paint
- High quality cement

Doors :

- All door fittings in stainless steel / brass with mortise lock
- Utility box at main door

Windows :

- Powder coated 3 track aluminium sliding windows with mosquito net
- MS safety grills for windows
- Sliding doors for terraces

Electrification :

- Fire retardant concealed copper wiring with MCB
- Adequate electrical point with premium modular sockets & switches
- Split AC point
- TV & Telephone point in living & master bedroom
- Provision for inverter

TYPICAL EVEN FLOOR

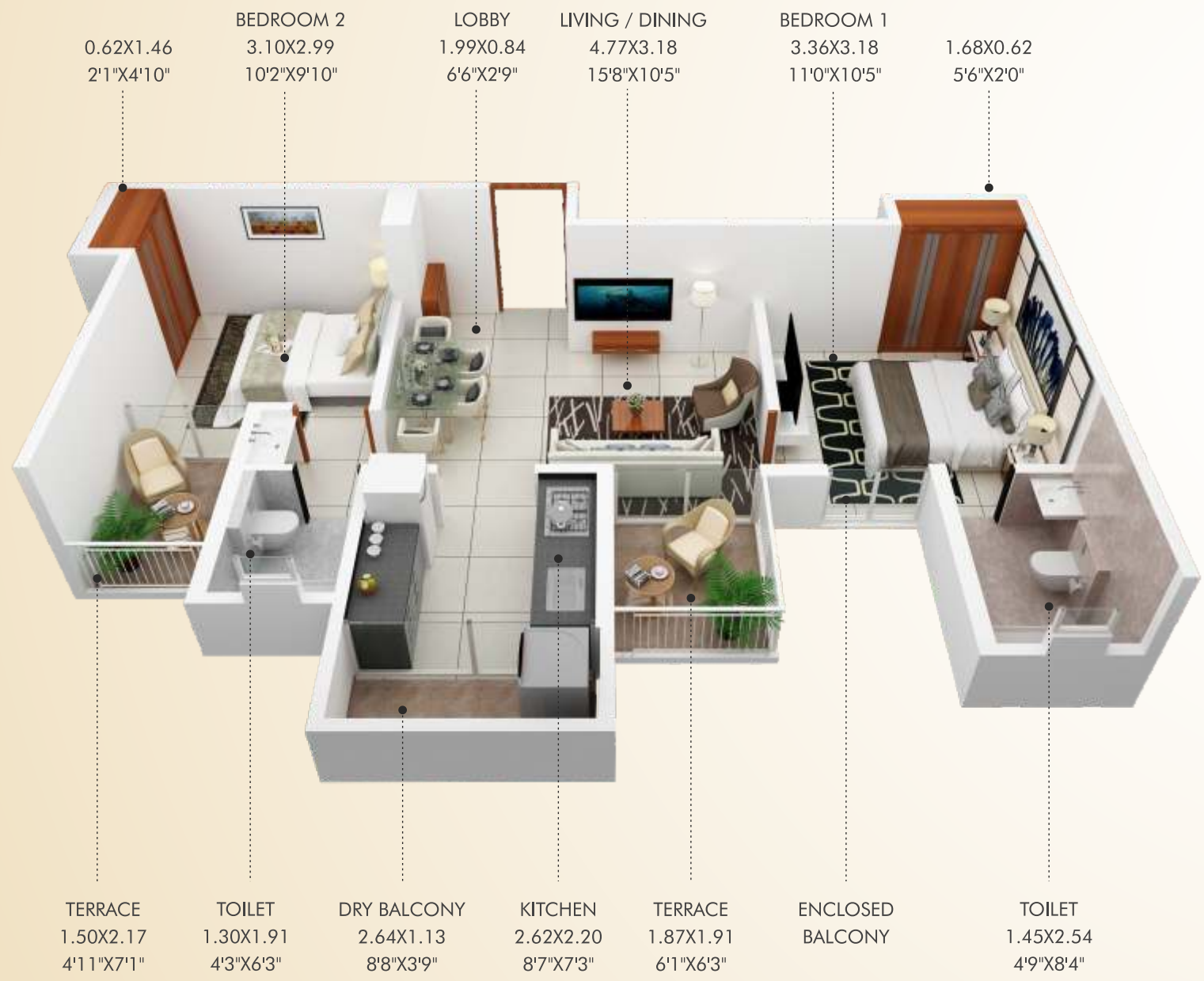

TYPICAL EVEN FLOOR



TYPICAL ODD FLOOR

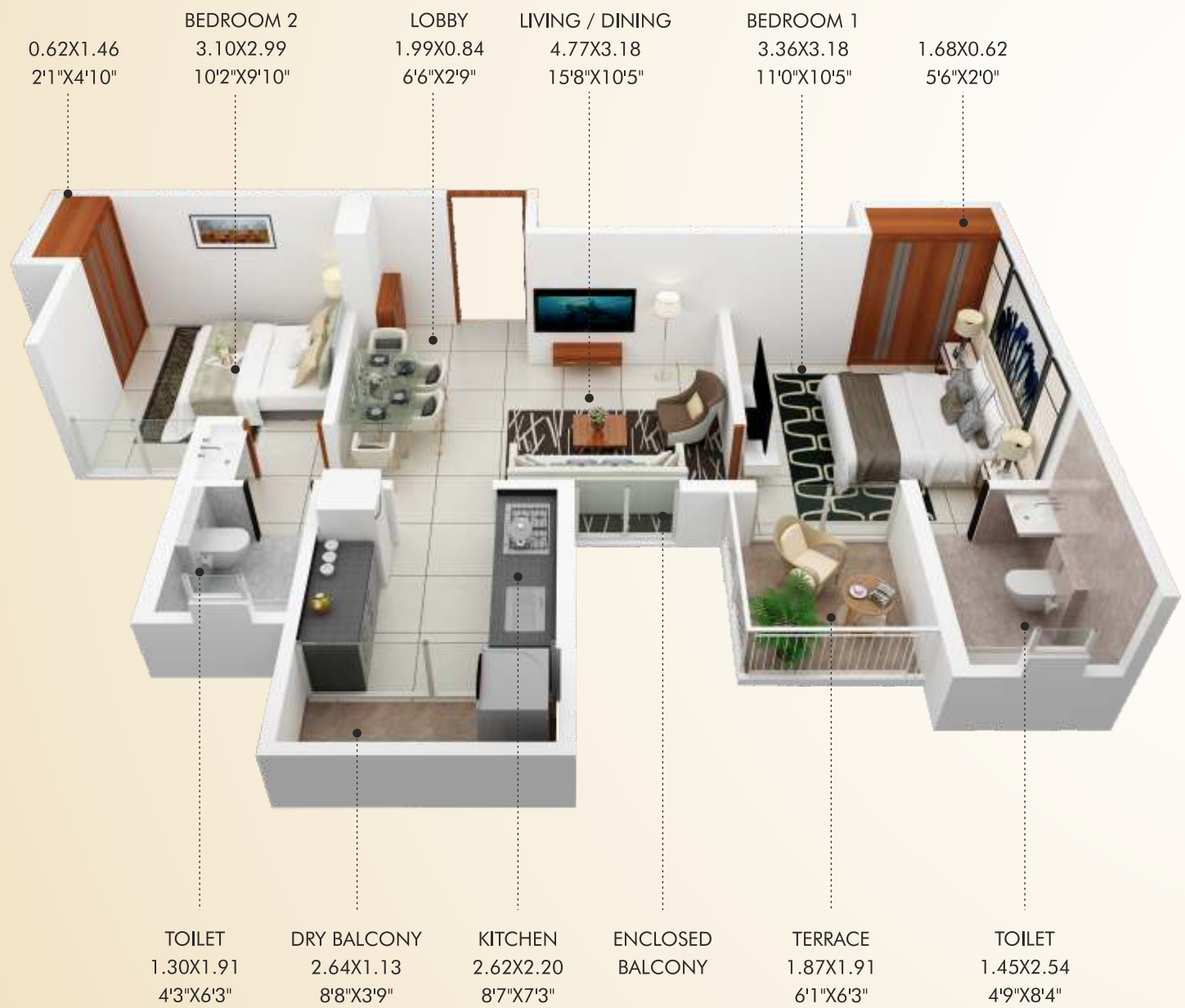

TYPICAL ODD FLOOR

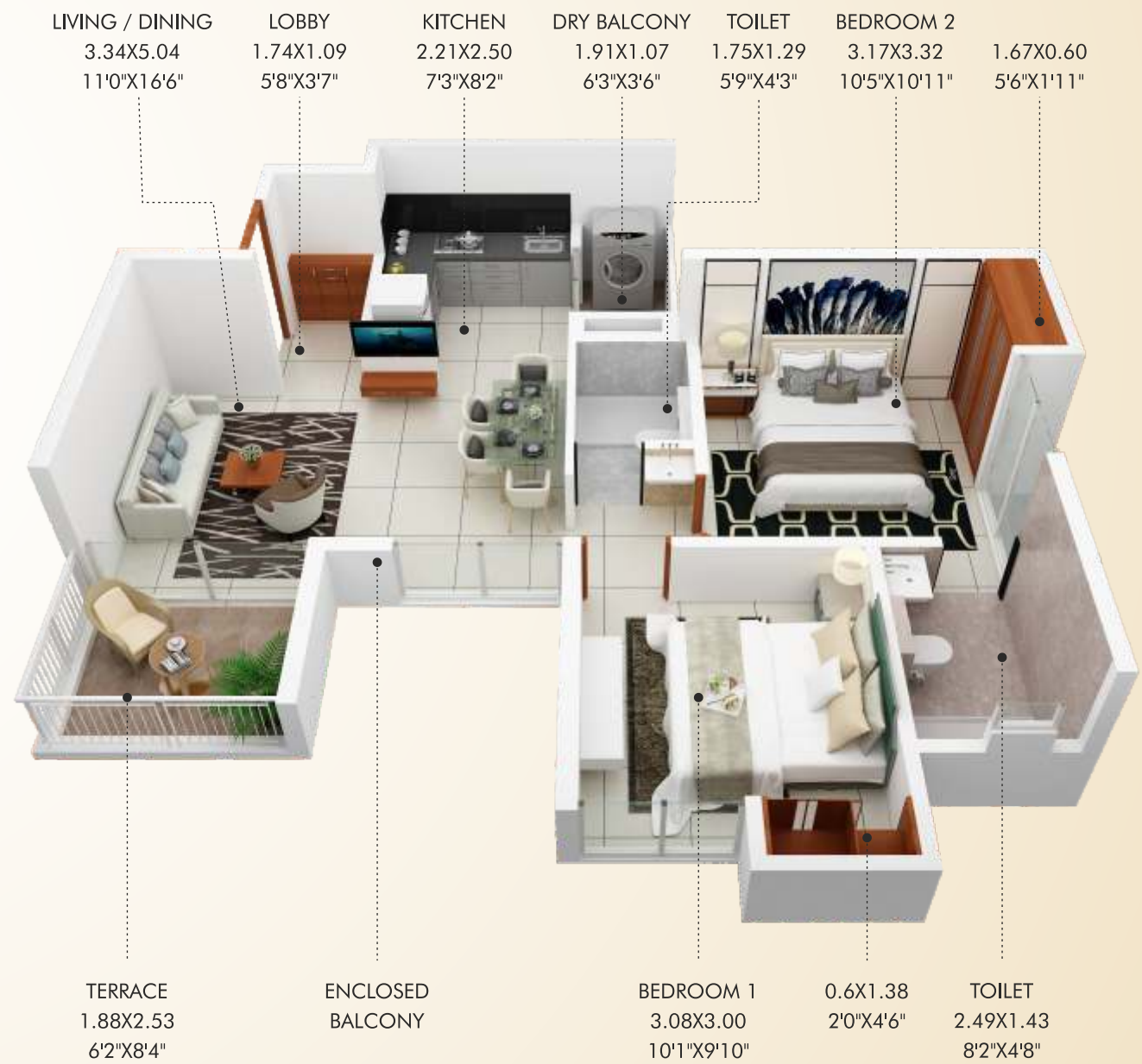



2 BHK Even Floor Area Statement

Flat no.	Carpet Area in Sq.Mtr.	Enclosed Balcony Area in Sq.Mtr.	Terrace Area in Sq.Mtr.	Dry Balcony Area in Sq.Mtr.	Total Carpet in Sq.Mtr.	Total Carpet in Sq.Ft
201, 204, 401, 404, 601, 604, 801, 804, 1001, 1004	50.71	6.46	4.59	2.04	63.80	686.74
202, 205, 402, 405, 602, 605, 802, 805, 1002, 1005	54.57	1.69	6.66	3.00	65.92	709.56
203, 206, 403, 406, 603, 606, 803, 806, 1003, 1006	50.97	6.45	4.59	2.07	64.08	689.76

2 BHK Odd Floor Area Statement

Flat no.	Carpet Area in Sq.Mtr.	Enclosed Balcony Area in Sq.Mtr.	Terrace Area in Sq.Mtr.	Dry Balcony Area in Sq.Mtr.	Total Carpet in Sq.Mtr.	Total Carpet in Sq.Ft
301, 304, 501, 504, 701, 704, 901, 904	50.27	6.47	4.59	2.04	63.37	682.11
302, 305, 502, 505, 705, 702, 905	53.95	1.62	3.4	3	61.97	667.05
303, 306, 503, 506, 703, 706, 903, 906	50.52	6.47	4.59	2.07	63.65	685.13



Nearby Locations

- Hinjawadi IT Park
Phase - 1 3.7 km
Phase - 2 6.4 km
Phase - 3 10 km
- Indira Institute 1 km
- Balewadi Sports Complex 4.1 km
- Mumbai-Pune Expressway 500 mtrs
- Sayaji Hotel 1.1 km
- Indira National School 1.2 km
- Akshara International School 1.4 km
- Aditya Birla Hospital 3.9 km
- Holiday Inn Hinjawadi Pune 3.3 km
- Dange Chowk 1.1 km
- Dr. D. Y. Patil Institute 700 mtrs
- Podar International School 25 mtrs



Credits -

Architecture -

Abhikalpan Architects

Plumbing Consultant -

Amit Infrastructure Consultant

Structural Consultant -

J+W Consultant

3D Renders -

Xpression Pixel Works

Legal Advisor -

Adv. Prasanna Darade

Communication Partner -

3 Dots Design

Electrical Consultant -

S S Zopate Consultant

Landscape Consultant -

Design Terra

Pyramid
Lifestyle

Building Spaces, Elevating Lifestyles

 **anshul**[®]
G R O U P
W O R K I N G T O G E T H E R

A joint venture with Mr. Deepak Jagtap & Mr. Nivrutti Nawale

Corporate Office : Pyramid Infraventure LLP,

Office No. 6, Shreeniwas Classic, Shambhu Vihar Society,

Above Corporation Bank, Main Baner Road, Pune - 411045

Call: 020 2729 3997 | www.pyramidlifestyle.com

Site Address : Opposite Akshar Elementa, near Sai Balaji Institute,

off Mumbai-Pune Expressway, Tathawade, Wakad, Pune - 411 033

Call: 90 7176 7176 | Email: sales@atlante.in | www.atlante.in



MAHARERA Reg. No.: P52100016663
<https://maharera.mahaonline.gov.in>

Disclaimer - The visuals & information contained in this brochure is indicative of the kind of development that is proposed. Subject to approval of the authorised or in interest of the continuing improvement. The promoters/developers reserve the right to change plans, specifications or features, without prior notice or obligation. This brochure is issued for guidance only & not constitute part of an offer or contract.