



akashparv

RISE ABOVE THE *Rest*



EXQUISITELY SCULPTED SPACES FOR  
*The Connoisseur*

akashparv  
RISE ABOVE THE REST

Playing by the rules is one thing.  
Making the rules is quite another.  
You belong to the second sort; a breed of self-made  
go-getters who don't think the sky is the limit...  
Ordinary is anathema to you.  
You aspire only for the best.  
And your home is certainly not an exception.

Akashparv is such an exclusive address that befits your  
success and status. It is a larger-than-life abode where  
you own a piece of the sky.

Welcome to the epic life deserved only by a chosen few.

SOARING LUXURY,  
TOWERING  
*Elegance*

Akashparv, As they say, is the gamechanger. Singular in concept as it is in location, this uber luxury property located in Kothrud annexe, pune, brings you hi-end terrace apartments that splendidly rise above the urban clutter. Contemporarily styled to live up to your high expectations, this three tower masterpiece sits on A sprawling 3-acre wide greenscape. This graceful landmark soaring up to 19 levels is the tallest structure in the entire locality. Being at the top, you are privileged to proudly admire Pune's skyline.



A NEW BENCHMARK IN  
*Opulence*

Akashparv brings you a choice of 3 & 4 BHK Ultra Luxury Apartments ranging from 1,867 to 1,967 sq.ft. and 2,500 to 3,000 sq.ft. respectively.

Spacious and uncluttered, your home embraces you with a tangible sense of freedom. Each of the three towers, resting on the 2-level stilt level parking foundation, soars 22 floors into the sky... by any reckoning, one of the highest residential developments in West Pune. with just two residences per floor.

Your home at Akashparv is a sublime showcase of peace, privacy and exclusivity.



# INDULGE IN AN *Exuberant Lifestyle*

## Evergreen Surroundings for Lifetime

At Akashparv, you will never be enshited by a concrete cluster; the project is endowed by 7000 acres of evergreen NDA premises in the neighborhood



## Designer Air-Conditioned Entrance lobby

Get a grand welcome by the richness of the beautifully designed air-conditioned lobby with access control.



## Safety & Security Systems

- Gas leak detector, Heat detector,
- Fire alarm & Detection System
- CCTV Surveillance Monitoring for common areas
- Telephone / Intercom, Guard Phone & Lobby Phone.
- Building Management Systems for monitoring common services.



## Grand Welcome

The impressive, elegant entrance gate with a boisterous waterfall at the side is the perfect red carpet welcome for you



## Jain Temple

An ideal place to pray and meditate in peace, the beautiful Jain temple is more than an eye-catcher; it is a symbol of harmony and an icon of lively community living.



## Energy Efficiency

- Energy saving T5 fixtures in the parking area with timer control.
- Eco- friendly LED lighting in common areas & external lighting.



## Landscaped Garden

The beautiful landscaped garden interspersed with water bodies and spread across an area of 1 acre is a stunning architectural highlight of Akashparv.



## Access Control

- Automatic boom barriers at main entrance
- Multipoint security for residences



## Ride Smoothly

With 2 high speed elevators for each building with 24 hours back-up, enjoy the perfect mix of style, sophistication & speed.



## Shopping Mode Easy

Convenience shopping within the project premises ensures your day-to-day needs are always within your easy reach



## Parking Plan

Park your cherished cars safety and systematically in the 3 floor high covered parking space for residence owners.



## Drop-off Lobby

Experience a sense of pride as you set down your luxury car at the opulent drop-off lobby



## Power on

With dedicated generator backup for each flat you don't ever have to worry about power cuts



## On-call services

Professionals and services (like doctor, laundry, florist, nursing etc) are just a call away !



INFINITELY  
*Incredible..!*

For those who live life on their own terms, it's the exceptional that strikes a chord... Akashparv is replete with bold lifestyle amenities that make living out-of-the-box – A real experience. Step on to the expansive terrace to be greeted by two pools – An infinity pool and a kids' pool. Placed at the zenith of the towers, these two pools Are part of a trendy, peaceful recreational area on the rooftop. As you watch the glistening skyline with a commanding eye, It's time to indulge in infinite bliss!





# *Tranquility* THAT INSPIRES

Tucked away in solitude and blessed with abundant greenery, AKASHPARV offers you a charming outdoor ambience. The cool breeze, the rustling of leaves and the melodious chirping of birds all work up a harmonic medley of sights and sounds. Just step out your cozy home get closer to nature.



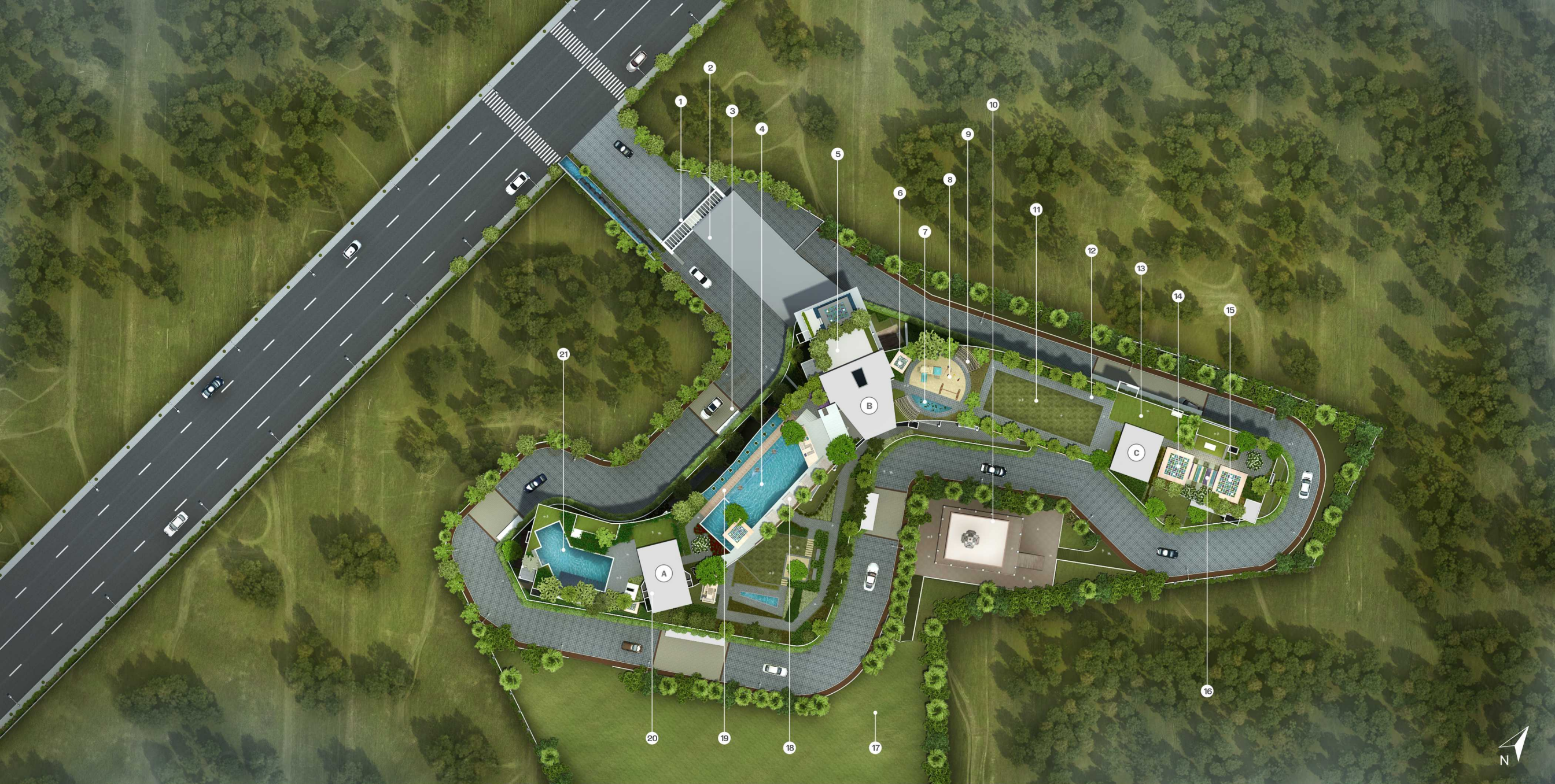

STEP ONTO THE  
*Skywalk!*

- |                                   |                                  |  |
|-----------------------------------|----------------------------------|--|
| ① Grand Entrance Gate             | ⑧ Children's play area           | ⑮ Yoga Gazebo                          |
| ② Commercial/Shopping Area        | ⑨ Mothers den                    | ⑯ Reflection Pool                      |
| ③ Drop Off Lobby                  | ⑩ Jain Temple                    | ⑰ Landscape Garden                     |
| ④ Infinity Edge Swimming Pool     | ⑪ Party greens for small parties | ⑱ Pool Deck Area                       |
| ⑤ Fully equipped modern gymnasium | ⑫ Pathway/Jogging Track          | ⑲ Floating Walkway                     |
| ⑥ Doll House                      | ⑬ Small Party Hall               | ⑳ Therapy Rooms & Spa                  |
| ⑦ Walk in fountain                | ⑭ Senior Citizens Den            | ㉑ Children Swimming Pool with Cascades |





THE LAST WORD IN  
*Luxury*

Indulgence takes on a new dimension at Akashparv.  
Cherish the graceful interplay of space and light,  
bask in the exuberance and immerse yourself in  
a peppy ambiance.



SOLITARY  
*Bliss*

With a serene location, enticing interiors and breathtaking views, you don't have to look hard to find some peace – it's there in almost every square feet.

Discover magic in every moment!



THE ART OF  
*Luxury  
Cooking*

Cook up a culinary extravaganza in the vivacious kitchen endowed with Top-of-the-line appliances like Modular Kitchen, adequate storage with built in hub-chimney & piped gas connection. The ergonomically designed and ornately furnished kitchen allows for easy, unrestricted movement.

# FITMENTS WITH A TOUCH OF *Class & luxury*



## Superior Flooring

- Imported marble flooring for living kitchen and dining areas
- Wooden flooring for master bedroom
- Imported 1mt X 1mt flooring for other bedrooms



## Automation

- Home Automation for Lighting control, AC control
- Device Connectivity - All automation devices can be controlled & monitored through iPad / Android devices



## Air Conditioning Systems

Daikin or equivalent air conditioning systems of appropriate capacity for all bedrooms in the apartment



## False Ceiling

False ceiling with concealed LED lights for the entire apartment for superior & elegant look



## Bathrooms

- Separate glass enclosed shower cubicles in all bathrooms
- Grohe / Kohler equivalent fixtures in all bathrooms
- Toto / Kohler wash basins & EWCS



## Painting

Superior Luster finish paints for internal walls



## Doors

- High Quality Veneer finished doors with high quality hardware fittings.
- Main Doors fitted with high quality locks.



## Windows

Smooth finish heavy duty UPVC windows better sound insulation & dust free homes



## Electrical

- Complete concealed fire resistant copper cabling
- T.V., Telephone and Internet point in all rooms
- Ample electrical points to fulfill all utilities



## Servant Rooms

Servant rooms (In selected flats)

# HIGH ON *Creativity*

An able team for an UPHILL task

Located in a unique topographical trifecta of hilly terrain, forest cover and plateaued landmass, Akashparv's naturally gifted topographical position presented a plethora of adaptation possibilities. A team of incisive creators – architecture prodigies and industry veterans in their own right – took up the challenge. The result was stupendous; Akashparv is a thorough testimony of ingenuity and innovation.

### Arch. Prakash Kulkarni (Project Architect)

We embraced and tackled this challenge comprehensively, by overturning hurdles into opportunities. Raised elevation resting on top of dedicated parking stilts to afford uninterrupted views at every level, fluid column and pillar styling to facilitate maximum ventilation, a contemporary structural approach to allow enhanced spatial utilization and aesthetic value, three-way open apartments with unrestricted views – the subliminal elements of the high life quotient have been imbued in this creation with deliberate precision – to curate a lifestyle that's unique in every sense.

### Arch. Mahesh Nampurkar (Project Landscape Architect)

A backdrop of hilly forest reserve land, generous green cover and the bay-like perched arrangement of the precincts enabled us the scope to distribute the towers equidistantly across the landscape, facilitating maximum breathing space for every section. The V-shaped, sweeping concave elevation has been carved such that it makes ample way for the billowing winds sweeping from the hill top. We have augmented the fertile cover to good effect, by laying equal emphasis on green zones. The first level residences have been equipped with an enveloping sunken garden courtyard – which covers the entire periphery of each tower. The echoscopes here have been curated thoughtfully, so as to strike an ideal balance between engineered dexterity and natural tranquility.

## Credits

### Project Architect

Ankur associates,  
Arch. Prakash Kulkarni,  
Pune

### Landscape Architect

Sumanshilp,  
Arch. Mahesh Nampurkar,  
Pune

### Interior Architect

Arch. Ashwin Lovekar,  
Lovekar Design Studio,  
Pune

### RCC Consultant

JW Consultant Pvt. Ltd.,  
Pune

### Legal Advisor

Adv. Kiran Kothadia  
Pune

Bankers



Disclaimer: The plans, specifications, images, brands & other details herein are only indicative & the Developer / Owner / Architect reserves the right to change any or all of these in the interest of the development. This printed material does not constitute an offer and / or a contract of any type between the Developer / Owner and the recipient. Any purchaser / lease of this development shall be governed by the terms and conditions of the Agreement for Sale / Lease entered into between the parties, and no details mentioned in this printed material shall in any way govern such transactions. Tolerance +/-2% is possible in the unit areas on account of design and construction variances.

# Location & Connectivity



- |            |                     |              |              |
|------------|---------------------|--------------|--------------|
| University | Education Institute | Petrol Pump  | Hospital     |
| Temple     | Golf Club           | Car Showroom | Popular Area |

## Site Address

S.No. 15, Chadani Chowk-Pashan Road, Bavdhan Kh., Pune.

## Key Distances

Chandani Chowk : 0 Min | Kothrud : 2 Min | Hinjewadi : 10 Min | University Circle : 10 Min | Deccan : 15 Min

# SOME OF OUR Creations

Venkatesh Sharada  
**Meghsparsh**



Site Address: Meghsparsh, S. No. 101/10, Mumbai-Banglore Highway, Ambegaon (Kh.), Pune.

**Spandan**  
Feel the pulse of contemporary living...



Site Address: Spandan, S. No. 117/1 Popular Nagar, Mumbai Pune Bypass, Warje, Pune

**TIME SQUARE**



Site Address: Times Square, C.T.S. No. 30, Bund Garden Road, Pune





akashparv



**Sharada Alliance**<sup>®</sup>  
PROMOTERS & BUILDERS  
*Creating Landmarks. Delivering Promises.*



**Shrikalp**  
Promoters & Builders



**ARHAM**  
LANDMARKS  
Buildings & Beyond

**Site Office :** S.No. 15, Chadani Chowk-Pashan Road, Bavdhan Kh., Pune.

**Call :** +91 8888 14 9000 / 8888 16 9000

**Website :** [www.aakashparv.com](http://www.aakashparv.com)

**Email :** [contact@akashparv.com](mailto:contact@akashparv.com)