



YOUR
DREAM HOME
IN KOCHI
JUST GOT A
STEP CLOSER

Thinking big has always been a passion of mine.

Scale and size play a big role in shaping the contours of my enterprises. The idea is to create not just India's best, but the World's best. Here too.

You will find that craving to scale up and achieve excellence that's truly world-class.





GOLD TOWER
KOCHI
THE GOLD STANDARD

The gold standard in living

Joyalukkas Lifestyle Developers proudly presents Gold Tower, a soaring, 22-storey skyscraper, with 24-carat luxury embedded in it. Everything about Gold Tower is truly world-class. The elevation, the amenities, the plans, the fixtures & fittings...everything at Gold Tower carries the stamp of universal excellence.

22 storeys+Amenities floor+Helipad

Designed by a team of internationally-reputed architects

Draws inspiration from the finest projects in the Far East and Middle East



Joyalukkas Joyalukkas Joyalukkas



Take a plunge into luxury



Plunge into the sparkling blue waters of the pool. Splash away your woes. Frolic in the company of your little ones. Enjoy every bit of the water world with gay abandon! Besides the sparkling pool, Gold Tower offers a splendid range of lifestyle facilities.

- Jogging track
- Landscaped gardens
- Banquet Hall
- Indoor Games Room for Kids



All about elegance

Elegance is a state of being. It's subtle, invisible and discreet. It's a soft whisper of evolved taste. It defines class and character. Gold Tower offers a medley of superlative features to create an unequalled ambience of class and elegance.

- 3.3 floor-to-floor height
- 3600 Sq.ft. spacious Lobby with Atrium
- Double Glazed French Windows



Turn into a masterchef

Gather together around this ultra stylish cuisine corner. In the new scheme of things, the kitchen is not just a place where one prepares tongue-tingling food. It's also a place for banter, chatter and guest entertainment.

- Provision for water heater and purifier fixing
- European-made kitchen cabinet with built-in hood
- Centralised Gas System



Health is wealth

Flex a muscle, stretch a leg, lift a weight...stay fit as a fiddle. A well-appointed health club with the most modern and premium equipment. Morning or evening, sweat it out in a chilled-out atmosphere.

- Health club
- Yoga / Meditation Deck



Reach the top

For the jetsetting league, here's the icing on the cake. A roof-top helipad with state-of-the-art landing facilities. So, when you want to fly in, just do it. Gold Tower is studded with a range of futuristic features.













- Provides the innovative FTTH (Fibre to the Home)
- Hi-Speed, 4 passenger elevators with a capacity to carry 12 people each.

LOCATION MAP



Distance from Joyalukkas Gold Tower to Prime locations (in Kms)

- ◆ Marine Drive - 7
- ◆ MG Road - 5.5
- ◆ Kaloor - 4.5
- ◆ Palarivattam - 2
- ◆ Palarivattam bypass junction - 1.5
- ◆ Airport - 26
- ◆ Aluva bridge - 15
- ◆ Kalamassery - 8
- ◆ Nippon Toyota Showroom - 7.5
- ◆ KIMS Hospital - 5.5
- ◆ Lulu mall - 4
- ◆ Oberon mall - 2.5
- ◆ Padamugal Junction - 1.3
- ◆ Infopark - 4.5
- ◆ Smart City - 6
- ◆ Holiday Inn Hotel - 3
- ◆ Gold Souk Shopping Mall - 5
- ◆ Vythilla Junction - 5.5
- ◆ White Fort Hotel - 8
- ◆ Crowne Plaza Hotel - 9
- ◆ Le Meridian - 9.5

- | | | |
|---|--|---|
|  Educational Institution |  Petrol Pump |  Airport |
|  Super Market |  Bank |  Stadium |
|  Health Club/Gym |  Church | |
|  Restaurant |  Mosque | |
|  Hospital |  Car Dealership | |



MASTER PLAN

TYPICAL FLOOR PLAN

(1st to 22nd)

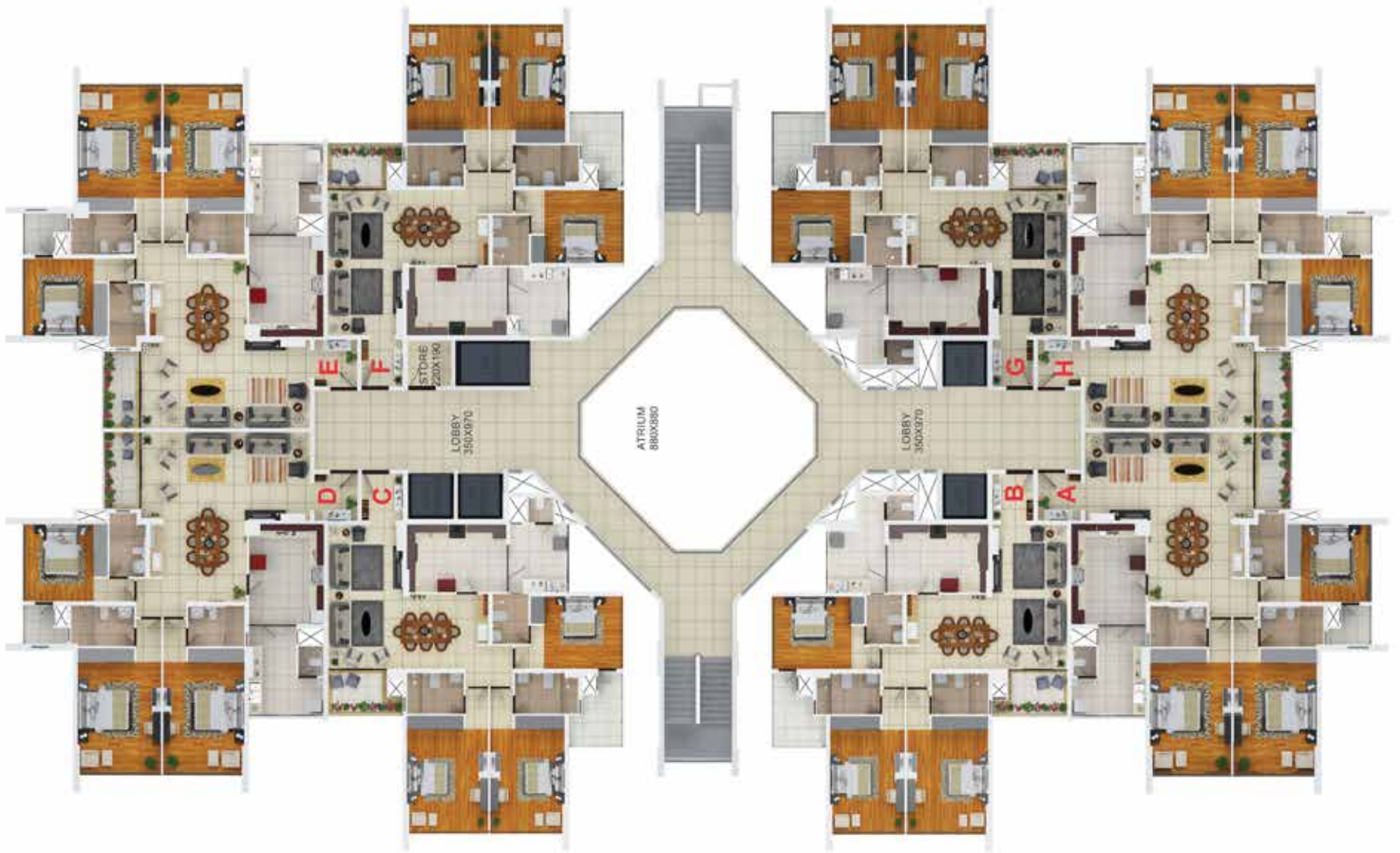

TYPE A

3 BHK : 2310 sq.ft.

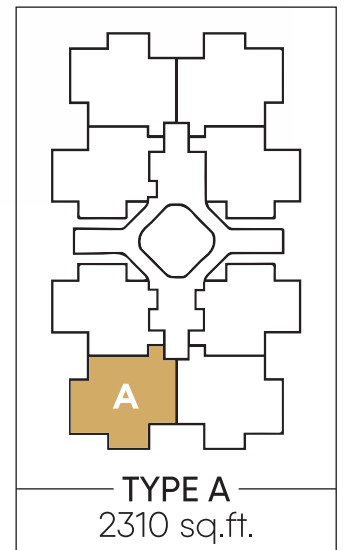
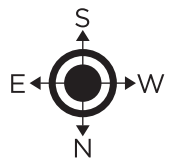

TYPE B

3 BHK : 2108 sq.ft.

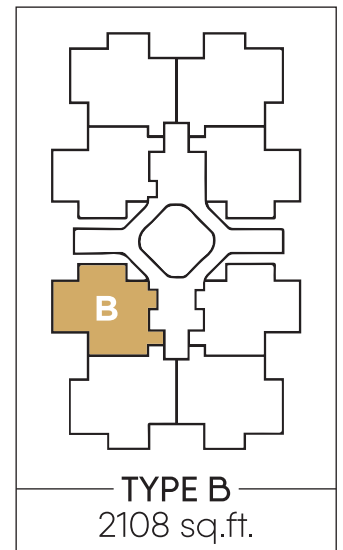
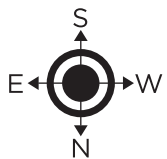

TYPE C

3 BHK : 2084 sq.ft.

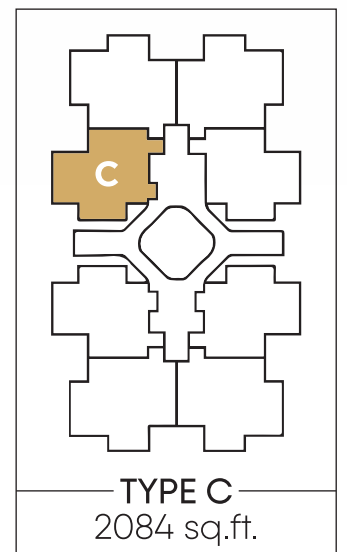
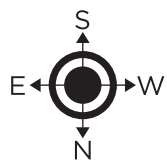

TYPE D

3 BHK : 2316 sq.ft.

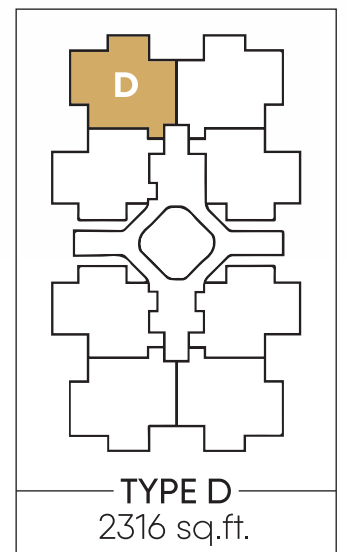
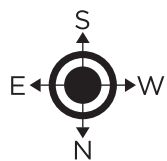

TYPE E

3 BHK : 2316 sq.ft.

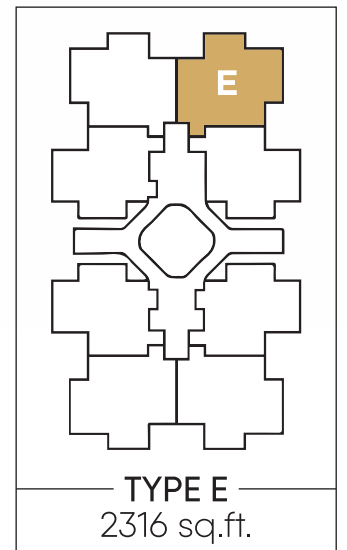
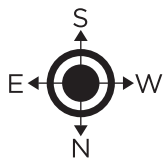

TYPE F

3 BHK : 2025 sq.ft.

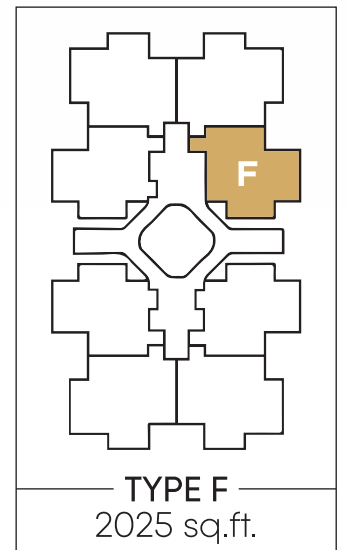

TYPE G

3 BHK : 2096 sq.ft.

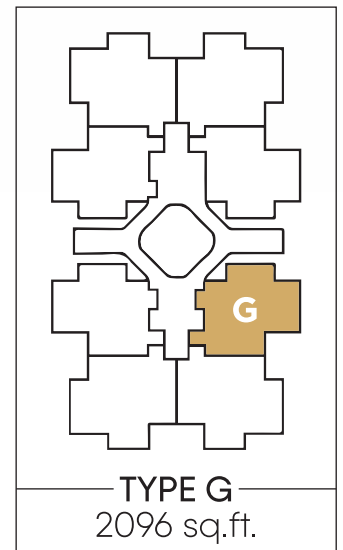
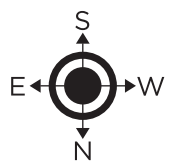

TYPE H

3 BHK : 2310 sq.ft.

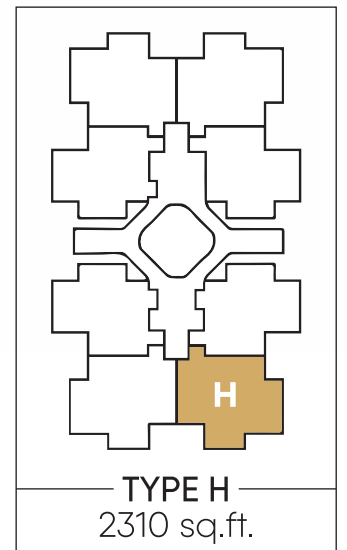
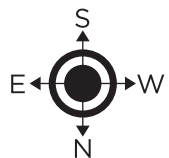

COMBINED FLOOR PLAN (TYPE A & H)

4 BHK : 4727 sq.ft.

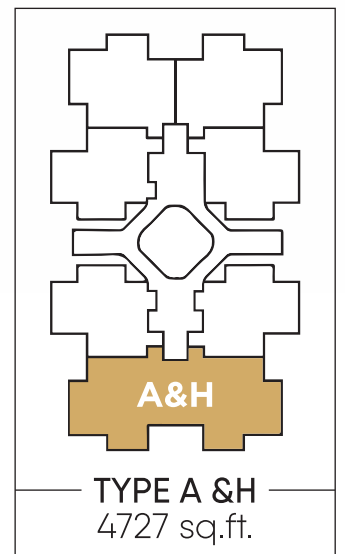
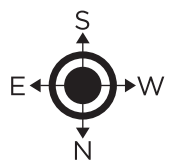



GOLD TOWER APARTMENT TYPES

SILVER (Standard Amenities)

1. Natural veneer doors with European-made superior quality locks and fixtures
2. Double-glazed toughened glass windows
3. Premium quality vitrified tiles in the living and dining area
4. Premium quality AC4 laminated wooden flooring in bedrooms
5. Three-phase power supply
6. Adequate light and power points with premium European-made modular switches and sockets
7. Semi-vitrified/ceramic wall clad designer toilets
8. Concealed plumbing system and provision for geyser
9. European-made CP fittings and sanitaryware
10. High-tech security system, provision for video door phone
11. CCTV cameras at all strategic locations
12. Advanced fire-fighting system as per government safety norms with automatic sprinkler system
13. Fire detection and fire alarm system
14. Centralised gas connection for all apartments
15. Premium quality plastic emulsion painted walls
16. FTTH facility
17. Generator back up for the essential points
18. SS hand rail with toughened glass in balconies
19. LED light fixtures
20. False ceiling with gypsum and metal grid
21. Air conditioning - plug in option for the VRF system

GOLD (Standard Amenities)

1. Natural veneer doors with European-made superior quality locks and fixtures
2. Double-glazed toughened glass windows
3. Premium quality glazed vitrified tiles in the living and dining area
4. Premium quality AC4 laminated wooden flooring in bedrooms
5. False ceiling with gypsum, wooden laminate and metal grids
6. Three-phase power supply
7. Adequate light and power points with premium European-made modular switches and sockets
8. Semi-vitrified/ceramic wall clad designer toilets
9. Concealed plumbing system and provision for geyser
10. European-made CP fittings and sanitaryware
11. Japanese-made VRF air-conditioning system
12. High-tech security system, imported video door phone
13. CCTV cameras at all strategic locations
14. Advanced fire-fighting system as per government safety norms with automatic sprinkler system
15. Fire detection and fire alarm system
16. Centralized gas connection for all apartments
17. Premium quality plastic emulsion painted walls
18. FTTH facility
19. Generator back up for the essential points
20. SS hand rail with toughened glass in balconies
21. LED light fixtures

PERGO

DURAVIT

hansgrohe

Schneider
Electric

TOSHIBA

MITSUBISHI
HEAVY INDUSTRIES, LTD.

HÄFELE

PROJECTS APPROVED BY LEADING BANKS



The midas touch

The Joyalukkas Group is a multi-billion dollar global conglomerate with a commanding presence in over 14 countries. Founded in 1987, the group has come a long way under its charismatic Chairman Mr. Joy Alukkas.

Today, the group has over 10 million customers and straddles businesses as diverse as retail, aviation and finance. It employs over 6,000 people in the UK, the UAE, Oman, Qatar, Bahrain, Kuwait, Saudi Arabia, India, Singapore and Malaysia.

The Joyalukkas Group's business interests include, Jewellery, Fashion & Silks, Luxury Air Charter-Joy Jets, Money Exchange-Joyalukkas Exchange, Malls-Mall of Joy, Reality-Joyalukkas Lifestyle Developers and Electronics-Joyalukkas Digital.

Joyalukkas has been hailed as the world's favourite jeweller and has bagged the coveted "Superbrand" status, four years in a row. The jewellery division of Joyalukkas has an impressive network of over 130 showrooms, spread across 14 countries. Joyalukkas Jewellery was the first jewellery retailer to receive the prestigious ISO 9001:2008 and 14001:2004 certifications.

The group also devotes considerable attention and resources to its CSR initiatives. The Joyalukkas Group spearheads numerous CSR activities aimed at protecting the environment and promoting livelihood. The Group is a firm believer in the principle of sustainable development.



Joyalukkas
Lifestyle developers

Joyalukkas Lifestyle Developers Pvt. Ltd., 2/144, Vazhakkala P.O, Kochi - 682030
email : sales@joyalukkasdevelopers.com, www.joyalukkasdevelopers.com

UAE: +971 56 1183847, +971 56 1183848, +971 56 1183849 | **OMAN:** +968 99452526, +968 99452545 | **KUWAIT:** +965 98002314, +965 98002315
BAHRAIN: +973 38896684, +973 38896685 | **SAUDI ARABIA:** +966 500021581, +966 500026581 | **QATAR:** +974 33150848, +974-33151724
SINGAPORE: : +65 97730917 | **MALAYSIA:** +60 167254725 | **UK:** +44 7917002848