

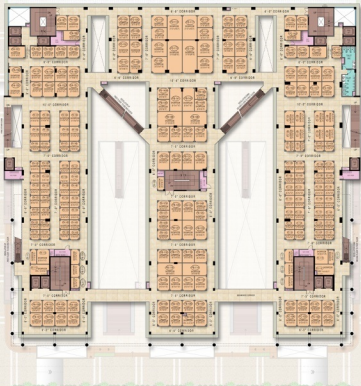

AN ARTISTIC IMPRESSION

\* TERMS & CONDITIONS APPLY







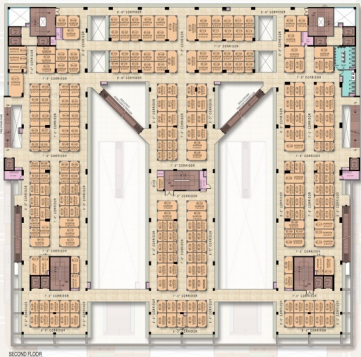





OFFICE NOS 53  
STUDIO APARTMENTS NOS 12

NO'S OF STUDIO  
APARTMENTS - 12



# GALAXY DIAMOND PLAZA PAYMENT PLAN

## OFFICE SPACES



### 50:50 PAYMENT PLAN

|                                    |                                  |
|------------------------------------|----------------------------------|
| At the time of Booking             | 10% of (BSP+PLC)                 |
| Within 45 Days                     | 40% of (BSP+PLC)                 |
| At the time of offer of Possession | 50% of (BSP+PLC) + OTHER CHARGES |

### DOWN PAYMENT PLAN

|                                    |                                 |
|------------------------------------|---------------------------------|
| At the time of Booking             | 10% of (BSP+PLC)                |
| Within 60 Days                     | 80% of (BSP+PLC)                |
| At the time of offer of Possession | 10% of (BSP+PLC)+ Other Charges |

V 6% Discount on Basic Sale Price.





# GALAXY DIAMOND PLAZA

## PRICE LIST

### OFFICE SPACE



#### OFFICE SPACE:

| Floors Details | B.S.P. (Per Sq. ft.) |
|----------------|----------------------|
| TENTH FLOOR    | Rs. 6,490/-          |

#### OTHER CHARGES A:

|                          |                     |
|--------------------------|---------------------|
| ROAD PLC- 130 MTR FACING | Rs. 200/- Per Sq.ft |
| ROAD PLC- 24 MTR FACING  | Rs. 100/- Per Sq.ft |
| CORNER PLC               | Rs. 200/- Per Sq.ft |
| ATRIUM FACING            | Rs. 150/- Per Sq.ft |
| ONE TIME LEASE RENT      | Rs. 150/- Per Sq.ft |
| IFMS                     | Rs. 100/- Per Sq.ft |

#### OTHER CHARGES B:

|                                     |                        |
|-------------------------------------|------------------------|
| POWER BACKUP INSTALLATION CHARGES   | Rs. 25,000/- (Per KVA) |
| ELECTRIC METER INSTALLATION CHARGES | Rs. 25,000/- (Per KVA) |

1 sq. mtr. = 10.764 sq.ft.

#### Note:-

- ✓ Payment shall be made via Cheque/Demand Draft in favour of "M/S ASTEROID SHELTERS HOMES PVT. LTD."
- ✓ All Specifications, Designs, Layout and Conditions are only indicative & subject to change at the description of the builder/ architect or any other competent authority.
- ✓ The terms and condition stated herein are only indicative and are subject to change. Detailed terms & conditions will be provided in the Builder- Buyer Agreement.
- ✓ Company reserves the rights to change the price and payment plans without notice. Price/ Payment Plan ruling on the date of booking shall be applicable. There will be no escalation in Basic Price for booked unit.
- ✓ Registration stamp duty, ECC, FFC, or any other legal charges levied by Govt. shall be payable by Allottee/ Applicant as per norms, at the time of offer of Possession.





# **GALAXY DIAMOND PLAZA**

## **PAYMENT PLAN**

### **RETAIL SPACE**



#### **50: 50 PAYMENT PLAN**

|   |                                 |
|---|---------------------------------|
| At the Booking                                    | 10% of (BSP+PLC)                |
| Within 30 Days                                    | 40% of (BSP+PLC)                |
| At the time of offer of Possession of Retail Mall | 50% of (BSP+PLC)+ Other Charges |

#### **90:10 PAYMENT PLAN**

|   |                                 |
|---|---------------------------------|
| At the Booking                                    | 10% of (BSP+PLC)                |
| Within 30 Days                                    | 80% of (BSP+PLC)                |
| At the time of offer of Possession of Retail Mall | 10% of (BSP+PLC)+ Other Charges |





# **GALAXY DIAMOND PLAZA**

## **PRICE LIST**

### **RETAIL SPACE**



| Floors Details             | B.S.P. (Per Sq. ft.) |
|----------------------------|----------------------|
| LOWER GROUND FLOOR (L.G.F) | Rs. 18,500/-         |
| GROUND FLOOR (G.F)         | Rs. 24,000/-         |
| FIRST FLOOR                | Rs. 17,500/-         |
| SECOND FLOOR               | Rs. 16,000/-         |
| THIRD FLOOR (DIAMOND)      | Rs. 30,000/-         |
| FOOD PLAZA (MULTI PLEX)    | Rs. 19,000/-         |

#### **Other Charges A:**

|                           |                |
|---------------------------|----------------|
| ROAD PLC - 130 MTR FACING | 10% of B.S.P.  |
| ROAD PLC - 24 MTR FACING  | 7.5% of B.S.P. |
| CORNER PLC                | 5% of B.S.P.   |
| ATRIUM FACING             | 2.5% of B.S.P. |

#### **Other Charges B:**

|                        |                        |
|------------------------|------------------------|
| SINKING FUND           | Rs. 25,000/-           |
| POWER BACKUP (PER KVA) | Rs. 25,000/-           |
| ONE TIME LEASE RENT    | Rs.150/- (Per Sq. ft.) |
| IFMS                   | Rs.100/- (Per Sq. ft.) |

1 sq. mtr. = 10.764 sq.ft.

#### **Note:-**

Payment shall be made via Cheque/Demand Draft in favour of "M/S ASTEROID SHELTERS HOMES PVT. LTD."

All Specifications, Designs, Layout and Conditions are only indicative & subject to change at the description of the builder/ architect or any other competent authority.

The terms and condition stated herein are only indicative and are subject to change. Detailed terms & conditions will be provided in the Builder- Buyer Agreement.

Company reserves the rights to change the price and payment plans without notice. Price/ Payment Plan ruling on the date of booking shall be applicable. There will be no escalation in Basic Price for booked unit.

Registration stamp duty, Electric/Water meter charges, IFMS, One Time Lease Rent, ECC, FFC, Power Back Up, Power Meter Charges or any other legal charges levied by Govt. shall be payable by Allottee/ Applicant as per norms, at the time of offer of Possession..



## GAUR CITY

G.H. - 01, Sector - 4, GNIDA

11 Km. From Kalindi Kunj  
7 Km. From Noida City Center Metro Station



<<---NH24

GNIDA--->>

Hindon River

Hindon River

FNG

FNG

Sector 121  
Noida

**Gaur Grandeur**  
Sector 119 - Noida

<<---To Sector-62

To Sector-78--->>



Fortis Hospital



Sai mandir

Metro Station  
City Centre



<<---To Nizamuddin

Express way--->>

Kalindi Kunj-->>