

SAI PROVISO ICON

ROADPALI - (SECTOR - 17)

MAHA RERA REGISTRATION No.: P52000023351

Iconic Living

RCC CONSULTANT:
ADHARSHILA CONSULTANTS

MEP CONSULTANT:
ANIL VERMA & ASSOCIATES

ARCHITECT:
ATUL PATEL ARCHITECT



Corp. Off.: 1201 / 1202, Bhoomiraj Costa-rica Commercial Complex,
Plot No. 1 & 1A, Sec. 18, Off Palm Beach Road, Sanpada, Navi Mumbai - 400 705.

Site Address: Plot No. 83, Sector - 17, Roadpali

Tel.: 022 6767 6666 / 98215 32717

Email: sales@proviso.in | **Web.:** www.proviso.in

Disclaimer: All plans, drawings, amenities, facilities etc. are subject to the approval of the respective authorities and would be changed, if necessary. The discretion remains with the developer. All rendering, floor plans, pictures and maps are the artist's conceptions and not actual depictions of the building, its walls, roadways or landscaping. This brochure is for guidance and not a legal document. This brochure should also not be reproduced, copied or made available to others in any form of transmission. The Design & specifications depicted in the brochure are subject to change without prior notice.



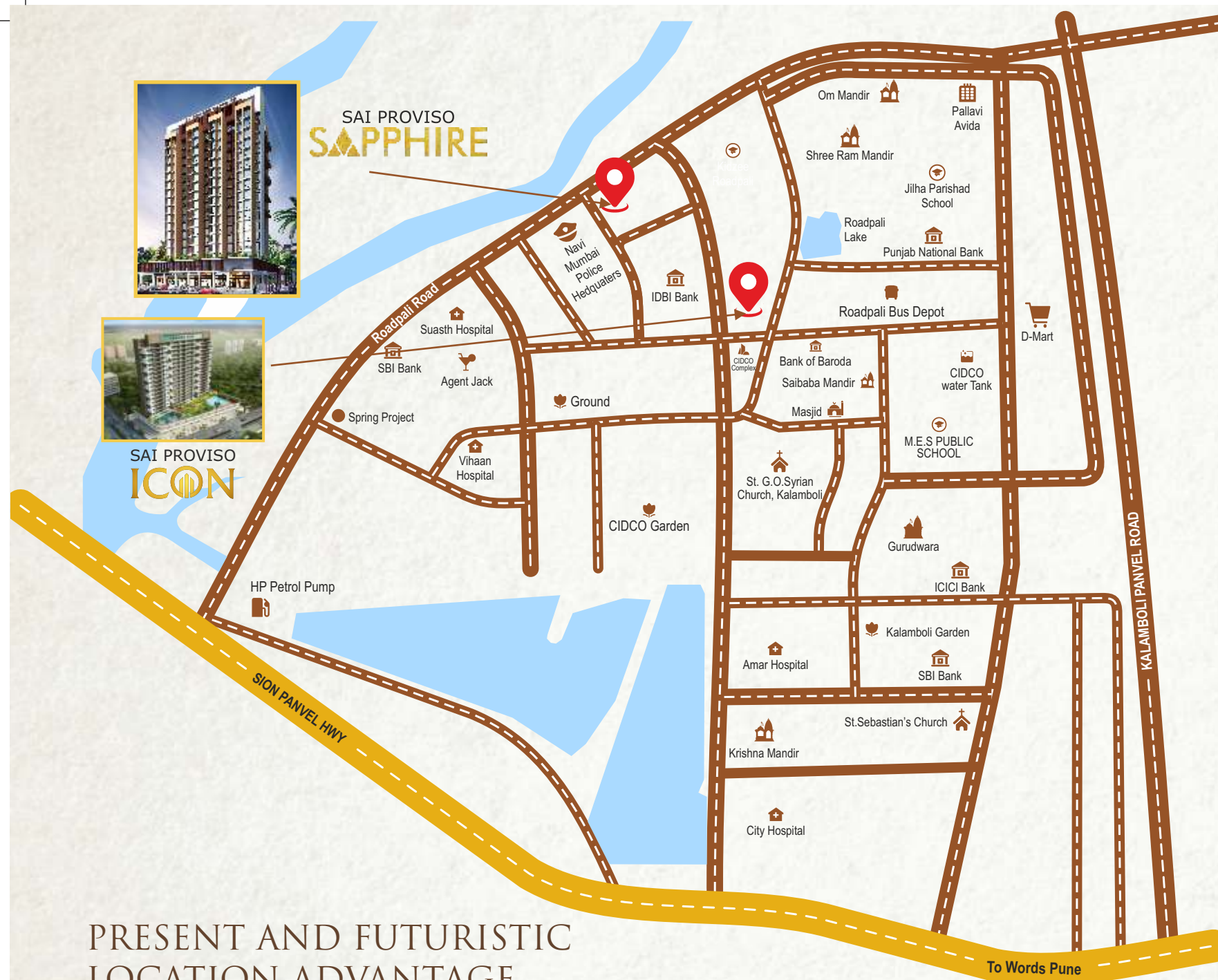

PRESENT AND FUTURISTIC LOCATION ADVANTAGE...

Sai Proviso ICON at Roadpali is a nerve connecting Navi Mumbai's landmark places like the Vashi, Kharghar, Taloja and many more. It is very close to all expediency which you could think off. Your daily chorus Shopping at the Malls, Marts, Commuting by Trains and Busses and futurist Metro stations and Airport. We can say a thing of commuting is joy for ever.

- Easy Connectivity to Railway Stations and Hospitals
- Connectivity Metro stations and Futuristic International Airport
- Connected to Mumbai Pune Expressway
- D-Mart's and Shopping Mall
- Easy connectivity Navi Mumbai Nodes (Vashi, Nerul, Kharghar, Taloja, Panvel and many more...)
- Easy Schools, Colleges, Engineering & Management Colleges
- Police Head Quarters
- Mansarovar & Kharghar railway station near by
- Kharghar metro station near by
- Sharing auto for railway station



Cherish Best of both the worlds...

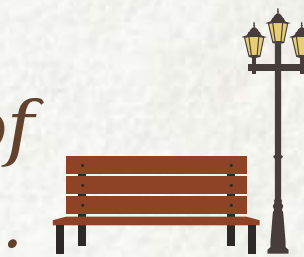

Sai Proviso ICON is an ultimate luxury and an ideal destination surrounded by host of convenience in one hand you have the daily expedience on the other hand you have the scenic beauty. This place is connected to the well developed locations in and around Navi Mumbai. ICON is a place where living would be meaningful without any compromise.



SAI PROVISO ICON

ROADPALI - (SECTOR - 17)



Majestic Looks, Iconic Landmark



Sai Proviso ICON majestic look is a state of the art complex with host of lifestyle amenities for everyone . It also boasts of complete security for your family in terms of 24/7 365 days CCTV and keyless entry to your homes. Fire alarm and fire fighting equipments, Back up power for the entire complex makes it a safe and confined complex for your family.



PROJECT HIGHLIGHTS



Sai Proviso ICON is a Residential and Commercial Project with two Towers of G+19 at Roadpali, Navi Mumbai. **At Sai Proviso ICON, 1 & 2 BHK** Spaces with all Modern Amenities are Designed to Meet your Aspiration,



Taste fully Designed, Unmatched Luxury

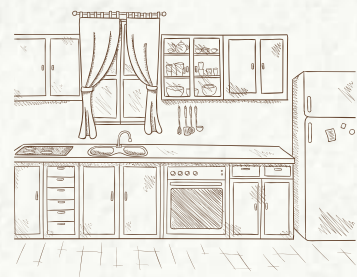

Sai Proviso ICON provides you with appealing luxury in all the rooms right from the flooring to the faucets. Tastefully designed leaves no room for compromise anymore.



SPECIFICATIONS



Doors:

- Best quality moulded designer doors

Flooring:

- High quality vitrified tiles

Windows:

- UPVC Sliding windows with granite sills

Walls:

- Internal Plastic paint for a splendid feel of walls
- False ceiling in living room for exquisite look
- Gypsum Finish

Kitchen:

- Granite kitchen platforms with S.S. Sink
- Provision of Aquaguard
- Exhaust fan

Bathroom:

- Full height Glazed tiles in bathroom / W.C
- Concealed plumbing with Jaguar or equivalent fitting
- Hot & Cold water mixer system in bathroom
- Geyser

Electricals:

- TV & Telephone points in living room and master bedroom
- AC Points & Conduits
- Internet provision for connectivity with the world

Terrace:

- Glass Railing in Terrace

Automation:

- Automated lighting

SAI PROVISO ICON

ROADPALI - (SECTOR - 17)



Luxurious inside & Convenient outside



PODIUM VIEW AMENITIES

- Sturdy and grand society main gate
- Good quality plaster paint on exterior of building
- Neatly interlocking paving in compound
- Grand Entrance Lobby
- Clubhouse, Swimming Pool and Kids Pool

Landscape Garden on Second Floor

- Air Conditioned Gymnasium
- Children Play area
- High Capacity elevators of reputed brand with power backup

Common Amenities

- Jogging Track
- Senior citizen Sit Out Corner
- Water Bodies & Fountains
- Gazebo
- Amphitheatre
- Indoor Games Room (Table Tennis, Chess, Carom Board etc.)
- Business Centre
- Party Lawn
- CCTV Surveillance
- Environmental Friendly Buildings
- Convenient Shopping Area
- Wi-Fi Availability in premises

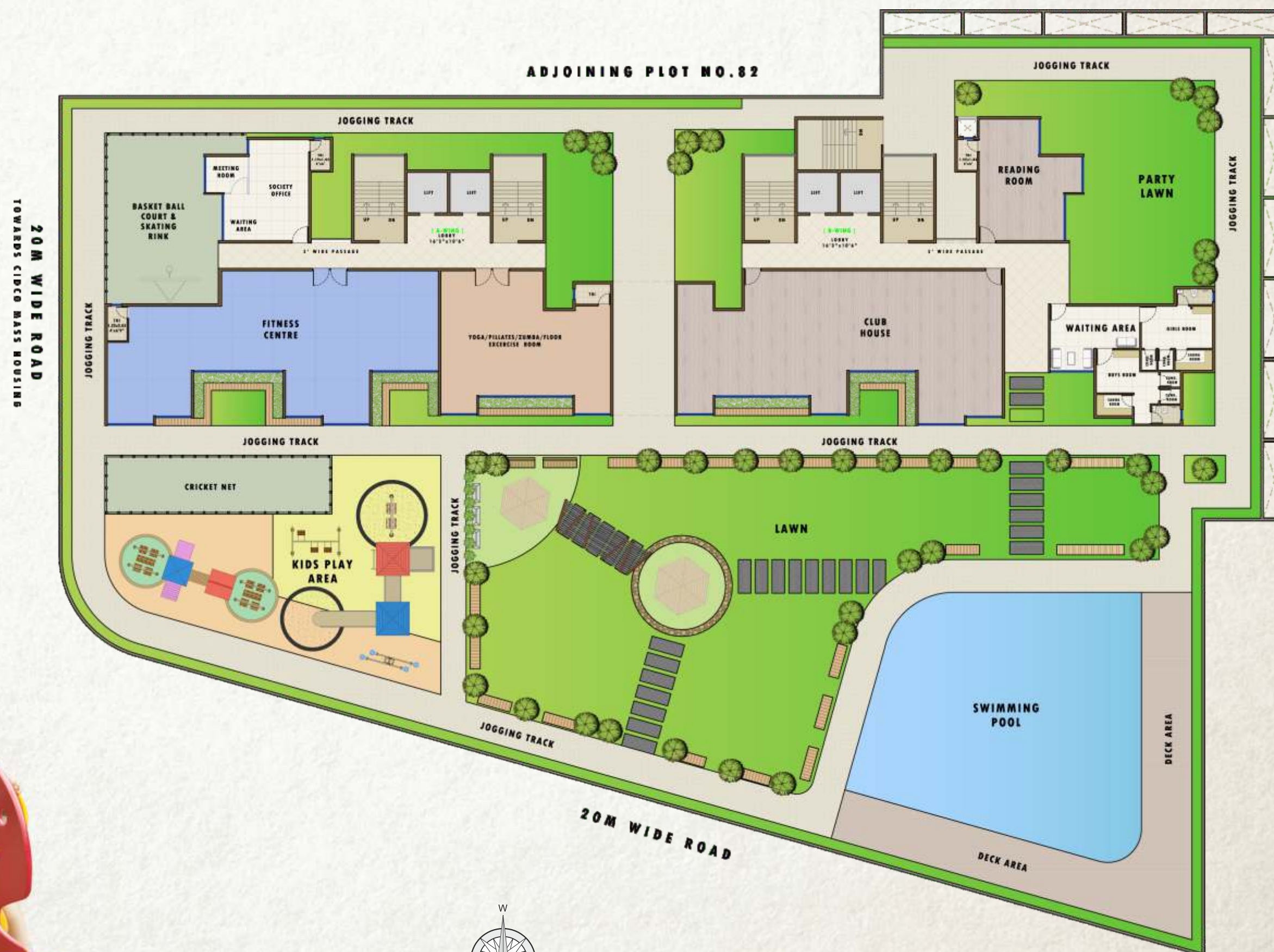

GROUND FLOOR

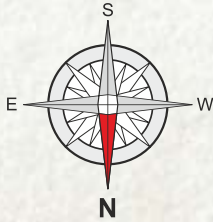

2ND FLOOR PODIUM (VIEW FROM THE FLAT)

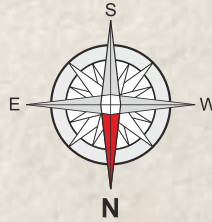

ADJOINING PLOT NO.82



ADJOINING PLOT NO.82



TYPICAL ODD FLOOR PLAN
3,5,7,9,13TH & 15TH FLOOR PLAN



TYPICAL EVEN FLOOR PLAN
4,6,10,12,16TH & 18TH FLOOR PLAN





Proviso group of Companies started in 1988, is a regional, full-service real estate development and management company.

After providing successful possession of 2,500 flats of 25 lac sqft. We are continuously growing in terms of Infra structure and real estate development.

Proviso's next plan of action is to provide around 2000 ready possession flats, spanning 20 lacs sqft in the next 4 years. Once we achieve this, we will go on to a next milestone of 4000 flats of 40 lacs sqft in next 6 years.

Our objective is to be a leader in commercial, retail and residential real estate. Since last 30 years, we serve our customer's needs and will consistently produce and manage developments of lasting value to the community.

We recognize the need to be flexible, entrepreneurial and aggressive, both as individuals and as a company. We believe in teamwork, innovation, professionalism and long-term decision-making. Our endeavour is to preserve quality, trust and enhance our reputation for integrity through all our actions. The vision of Proviso group is to achieve the highest possible standards of the real estate industry while establishing our organisation as the preferred real estate company within our market area.



ONGOING PROJECTS

SAI PROVISO SAPPHIRE
(Roadpali)

GREENWOODS
(Kharghar, Navi Mumbai)

SAI PROVISO COUNTY
(Shirdon, Panvel)

LEISURE TOWN
(Hadapsar, Pune)

SAI ORCHID
(Dombivali East)

UPCOMING PROJECTS

MAPLE WOODS AIROLI
(Airoli, Navi Mumbai)

MAPLE CASA LOMA
(Kiravli, Karjat)

SAI PROVISO LANDSCAPE
(Panvel, Raigad)

PROVISO RIVERSIDE
(Chikhale, Panvel)

COMPLETED PROJECTS

PROVISO COMPLEX
(Kharghar, Navi Mumbai)

GALAXY CARINA
(Kharghar, Navi Mumbai)

GALAXY NEBULA
(Kharghar, Navi Mumbai)

GALAXY ORION
(Kharghar, Navi Mumbai)

THE GALAXY
(Kharghar, Navi Mumbai)

PROVISO HILL PARK
(Kharghar, Navi Mumbai)

LAXMI TOWER
(Nerul, Navi Mumbai)

PROVISO TOWER
(Koparkhairane, Navi Mumbai)

PROVISO APARTMENT
(Kondhwa Khurd, Pune)

SAI PROVISO NAKSHATRA
(Koparkhairane, Navi Mumbai)

SAI PROVISO UTTARA
(Nerul, Navi Mumbai)

SAI PROVISO KRUTIKA
(Koparkhairane, Navi Mumbai)

SAI PROVISO POORVA
(Koparkhairane, Navi Mumbai)

GREEN VIEW
(Ulwe, Navi Mumbai)

SAI PROVISO DHANISHTA
(Koparkhairane, Navi Mumbai)

PROVISO GREEN
(Kharghar, Navi Mumbai)

PROVISO CORNER
(Ulwe, Navi Mumbai)

PROVISO HEIGHTS
(Ulwe, Navi Mumbai)

SAI PROVISO AASHLESHA
(Kharghar, Navi Mumbai)