



 PLOT NUMBER 10, THIRD FLOOR, SECTOR 44, GURUGRAM, HARYANA - 122002  
 CALL: 8010000777 | WEBSITE: WWW.JMSGROUP.CO.IN

\*Promoter has registered the Project- PRIME LAND under RERA vide HARERA No. 03 of 2021 RC/REP/HARERA/GGM/435/167/2021/03 dated 18/01/2021. The pictures, designs, facilities, plans, images, specification and other details herein are merely an indication for the purpose of depicting the appearance of the development at the project – "PRIME LAND". The visuals herein are for illustration and purely symbolic representation of the eventual development, whereas Plots etc. shall be sold and developed in the manner and form stated in the Buyer's Agreement. The content herein are purely for informational purpose, and customers are suggested not to make any bookings based on the imagery, details and descriptions currently available as the information on the hereof may not be comprehensive. The said information provided herein will not be construed as an advertisement. Any decision of buying or investing in the Project- "PRIME LAND" should be upon complete verification of all the details including area, services and other relevant terms independently with the authorized sales team/ Promoter. The Company and/or its directors, employees ("We") are not liable for any consequences of any action taken by you relying on the marketing/ promotional activity / brochures etc. We will under no circumstance be liable for any loss, expense or damage including, without limitation, indirect or consequential loss or damage, or any expense, loss or damage whatsoever arising from use, or loss of use, of data/information mentioned herein.



# PRIMELAND™

## SECTOR-95 A



# A LAND OF OPPORTUNITIES

JMS proudly introduces 'Primeland', the latest project by the most heralded debutants in realty space with a net worth of INR 900 Crores. The project comes under Haryana Government's Deen Dayal Jan Awas Yojana and is endowed with a mighty breathing area and natural landscaping bound to mesmerize the soul.



Artistic Impression

Designed by Mehta & Associates



WELCOME  
TO  
THE  
MODERN  
ARCHITECTURE

EMPOWERING PEOPLE WITH  
**A LANDMARK  
INVESTMENT**



Designed by Mehta & Associates

Artistic Impression



# DREAM HOME FOR TOMORROW



Primeland is perfectly located to become a brimming home space with its prime location and excellent amenities. The project is a valuable investment for the ones who would love to create their dream home in a beautiful environment.





# GENERATIONAL DECISION FOR TOMORROW



Primeland is a smart investment opportunity for those who would love to give their future generations a prime property. The project features a gamut of advantages and benefits that will create value and result in long-term returns.





# GREAT RETURNS FOR TOMORROW



Primeland offers a great investment platform that is strategically developed to maximize returns shortly. The buyers can rest assured that this property will fetch them incredible returns in the future with the utmost ease.





# AMENITIES

Make it big when you are at Primeland. Nestled in Sector-95A, Gurugram, Primeland boasts the best and tranquil lifestyle with a plethora of amenities within reach. Sink in to a secure and healthier living, relaxing contours covered with lush green areas and a quality living experience.

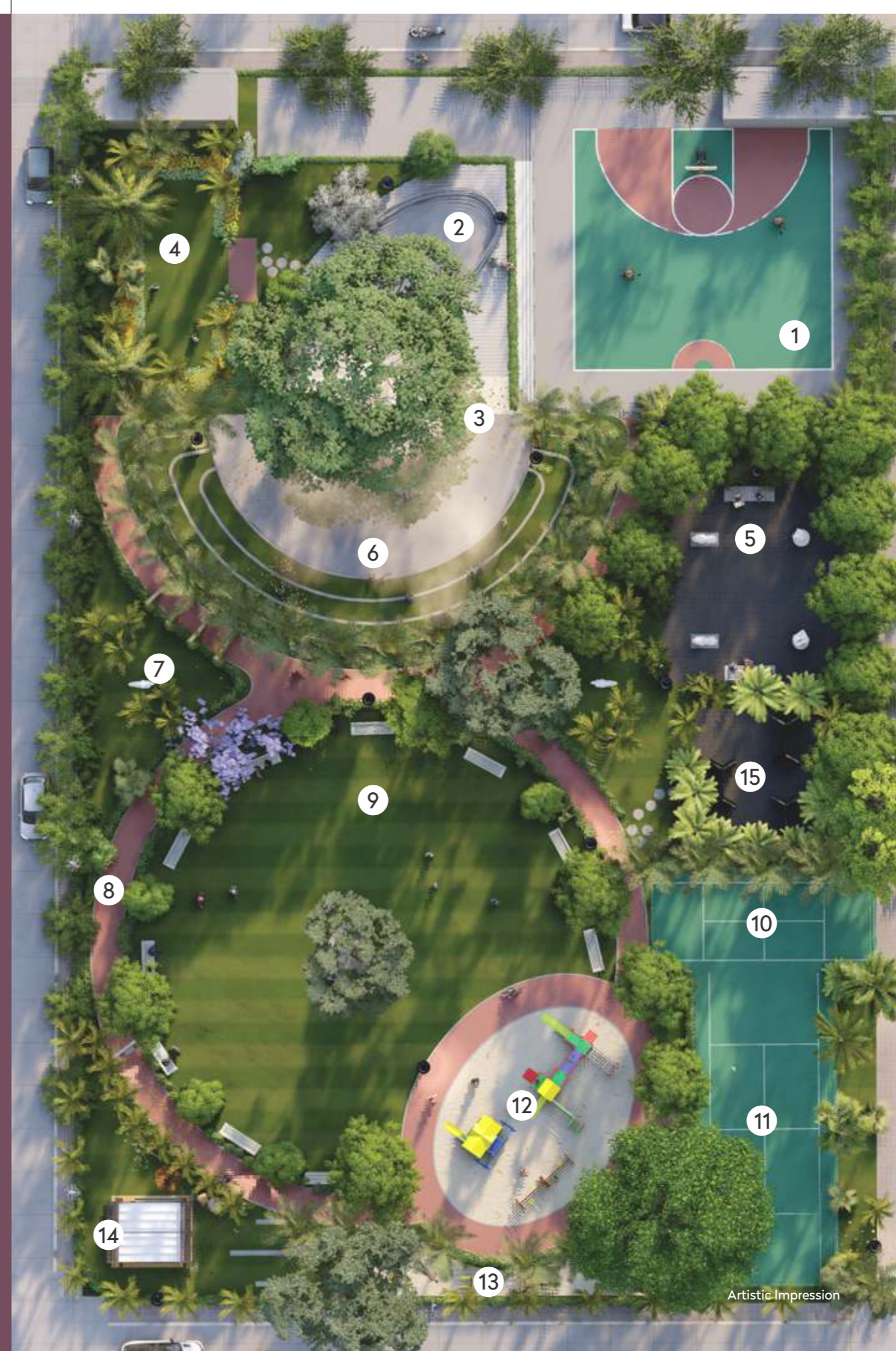

- 1 Half Basketball Court
- 2 Skating Rink
- 3 Stepping Stones
- 4 Palm Garden
- 5 Sculpture Garden
- 6 Open Air Amphitheater
- 7 Mounds
- 8 Walk Way
- 9 Celebration Greens/  
Party Lawn
- 10 Badminton Court
- 11 Volley Ball Court
- 12 Kid's Play Area
- 13 Open Gym
- 14 Tea Deck
- 15 Art Area

Designed by Mehta & Associates

Artistic Impression



# STEP INTO THE SECURE LIVING



Entrance/Exit  
Gate Plaza



CCTV Surveillance



Guard Room





# FILL YOUR DAY WITH A SPORTING EXPERIENCE



Cricket Pitch



Skating Ring



Basket Ball Court



Badminton Court



Volleyball Court



Joggers Park



Kid's Play Area





# A REFRESHING LIFESTYLE FOR A HEALTHIER LIVING



Meditation Area



Yoga Area



Open Gym





# RELAXING CONTOURS THAT CALLS FOR A WALK



Sculpture Garden



Party Lawn



Fragrance Garden



Reflexology Park



Tea Deck



Elders Zone



Palm Garden



Mound Over  
Sculptures

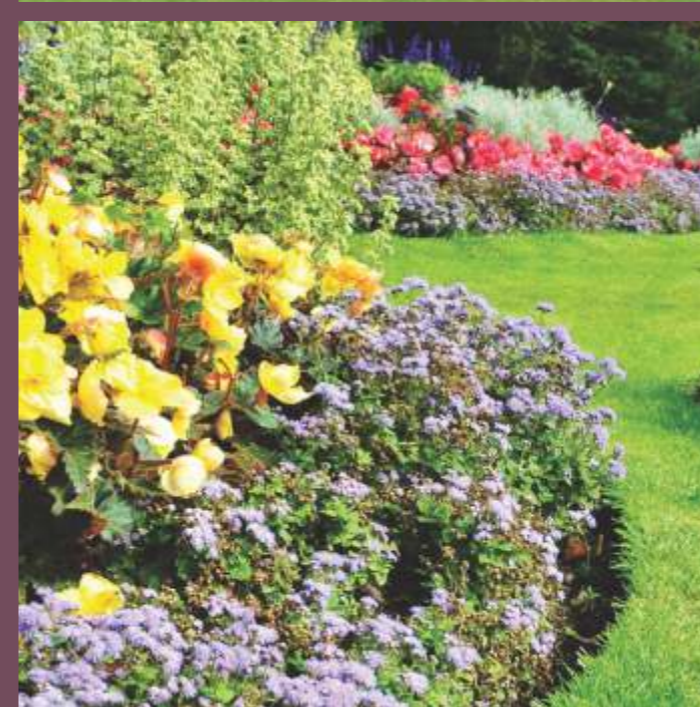



# PLOT PLANNING



Designed by Mehta & Associates



# The Advantages of Location

- Located on 75 meter wide road
- Accessibility from Delhi Airport
- Easy and smooth connectivity from Pataudi Road, Northern Peripheral Road, NH8 & KMP Expressway
- Close to Manesar & Kadipur Industrial Area
- Close to industrial units like Alcatel Lucent, Hero Moto Corp, Maruti, etc
- Educational Institution like SGT Group of Institutes, Sharda International School, Colonel's Public School, Yaduvanshi School are within close proximity
- Premium Residential colonies and commercial projects in close proximity such as Raheja, DLF, Sare, Ansal and Spaze



## LOCATION MAP







## Transforming Indian Real Estate

JMS Group is leading the Indian Real Estate Industry into the new age of experiential spaces in Gurgaon.

We combine innovative strategies with the latest engineering technologies to provide unrivaled customer service quality. The brand is driven and committed to sustain and empower India's real estate market while exploring opportunities worldwide.

JMS is one of Gurgaon's most trustworthy real estate developers, which delivers residential, commercial, retail, and school projects, using the accomplished exterior and interior architects to create an unparalleled boutique product.

JMS ensures only the very best for their customers, and to achieve the same, they have developed a rigorous set of tests, from the initial design plans to the finishing touches, so each project passes the highest quality standards.

**BEYOND CONSTRUCTION  
IT'S COMMITMENT**